

PART NUMBER	ITEM ① JACKSCREW	ITEM ② PIN
SEE TABLE I	JACKSCREW STEEL	MALE OR FEMALE COPPER ALLOY

DRAWING NO. 30-9530(SEE TABLE I)	
REVISIONS	
01	OFFICIAL RELEASE 11-12-09
	2009.12.1 10:28:20 Betty -0800'

<b>受控 CONTROLLED DOCUMENT</b>					
编号 P/N	30-9530	版本 Rev	01	日期 Rel'd Date	DEC 17,09

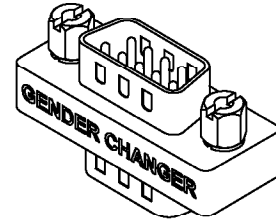
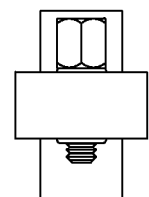
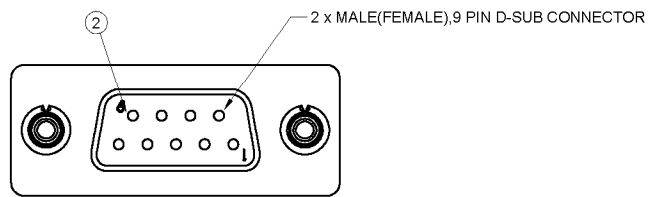
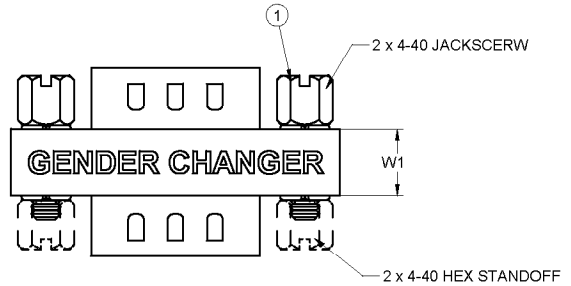
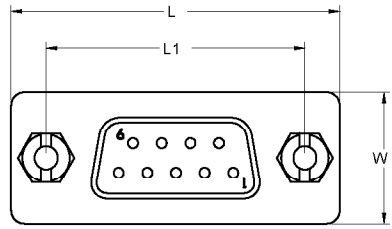

TABLE I

P/N	DESCRIPTION	W1	W	L1	L	Pin quantities	Hex standoff quantities
30-9530	SLIM GENDER CHANGER DB9 F/F	6.350	12.700	24.892	31.750	9	2
30-9531	SLIM GENDER CHANGER DB9 M/M	6.350	12.700	24.892	31.750	9	0
30-9532	SLIM GENDER CHANGER DB15 F/F	6.350	12.700	24.892	31.750	15	2
30-9533	SLIM GENDER CHANGER DB15 M/M	6.350	12.700	24.892	31.750	15	0
30-9534	SLIM GENDER CHANGER DB 25 F/F	5.842	12.954	46.990	53.340	25	2
30-9535	SLIM GENDER CHANGER DB 25 M/M	5.842	12.954	46.990	53.340	25	0

THIS DRAWING TO BE INTERPRETED PER ANSI Y 14.5M - 1984

**COMPANY CONFIDENTIAL**

NOTES:

1. DIELECTRIC WITHSTANDING VLLTAGE 1000VAC (FOR ONE MINUTE).
2. INSULATION RESISTANCE 1000MΩ MIN AT 500 VDC.
3. OPERATIONAL TEMPERATURE RANGE -55°C TO +105°C.
4. PACKAGING REQUIREMENT FOLLOWS ENGINEER DOCUMENT P/N 836-40200001XX

TOLERANCE UNLESS OTHERWISE SPECIFIED	DRAWN BY LINDA.WU	DATE 11-12-09
DECIMALS	CHECKED BY LINDA.WU	DATE 11-12-09
X	APPROVED BY	DATE
X.X	THOMAS	11-12-09
X.XXX	UM	mm
ANGLES	+ 0.5°	

**EMERSON**  
Network Power  
**Connectivity Solutions**

TITLE  
DBX,M(F)/M(F) GENDER CHANGER

THIS DRAWING WAS PRODUCED BY COMPUTER, DO NOT SCALE DRAWING OR UPDATE MANUALLY.

SHEET 1 OF 1	DRAWING NO. 30 9530 (SEE TABLE I)	SIZE C
-----------------	--------------------------------------	-----------