



CFM20 SERIES

20 WATT OPEN FRAME AC-DC MODULES



Features

- * Universal Input Range 85-264Vac
- * Efficiency to 81%
- * Industry Standard Pin Out
- * Meets EN55022 Class B
- * Continuous Short Circuit Protection
- * PCB Mountable Type is available

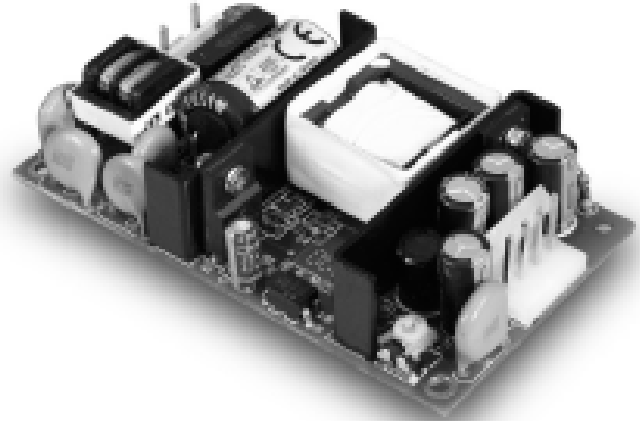

MODEL	OUTPUT VOLTAGE	MAX. LOAD	MIN. LOAD	RIPPLE & NOISE NOTE 1	VOLTAGE ACCURACY NOTE 2	LINE REGULATION NOTE 3	LOAD REGULATION NOTE 4	% EFF. (Typ.) NOTE 5
CFM2001S	5V	4400mA	0A	1%	±1%	±0.5%	±1%	72%
CFM2002S	12V	1800mA	0A	1%	±1%	±0.5%	±1%	79%
CFM2003S	15V	1400mA	0A	1%	±1%	±0.5%	±1%	80%
CFM2005S	24V	920mA	0A	1%	±1%	±0.5%	±1%	81%
CFM2007S	3.3V	4400mA	0A	50mV	±1%	±0.5%	±1%	66%
CFM2009S	9V	2450mA	0A	1%	±1%	±0.5%	±1%	76%

Specifications

INPUT SPECIFICATIONS:

Voltage 85~264Vac
 Frequency 47 to 63Hz
 Inrush Current 40A max. @230Vac
 Conducted EMI CISPR/FCC Class B
 Leakage Current 3.5mA max.

OUTPUT SPECIFICATIONS:

Holdup Time 16ms typ. @115Vac
 Short Circuit Protection Hiccup Mode (Auto Recovery)
 Over Voltage Protection TVS Component to Clamp
 Temperature Coefficient $\pm 0.05\%/^{\circ}\text{C}$

GENERAL SPECIFICATIONS:

Isolation Input to output = 4,242VDC
 Operating Temperature 0 ~ 70°C (see Derating Curve)
 Storage Temperature -20~85°C
 Humidity 93% RH max. Non condensing
 Cooling Natural Convection
 Switching Frequency 67KHz Typical
 MTBF MIL-HDBK-217F, GB, 25°C/115VAC 300K hrs min.
 Altitude 2000m
 Dimensions 3.501x2.000x0.906Inches (88.92x50.80x23.00mm)
 (CFM200XS-P) 3.501x2.000x1.000Inches (88.92x50.80x25.40mm)
 Weight 100g(0.22 Pounds)

SAFETY AND EMC:

Emission and Immunity EN55022 Class B
 EN61000-6-3, EN61000-3-2,
 EN61000-3-3
 EN55024, EN61204-3, EN61000-6-1
 Safety IEC60950-1, EN60950-1, UL60950-1

CFM20S Series Derating Curve

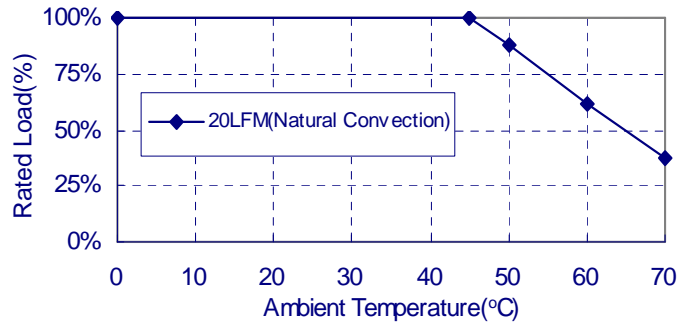

NOTE:

1. Add a 0.1uF ceramic capacitor and a 10uF E.L. capacitor to output for Ripple & Noise measuring @20MHz BW.
2. Voltage accuracy is set at 100% rated load and 25°C Ta.
3. Line regulation is measured from High Line to Low Line with full load.
4. Load regulation is measured from full to 10% load.
5. Typical efficiency at 230VAC and full load at 25°C.
6. Standard input and output connectors wafer with LONG CHU P3060 series and mate with MOLEX housing 5195 series or equivalent.
7. Model "CFM200XS-P": Connectors with pcb mountable type.

CFM20 Series

All Dimensions are in inches(mm)
 Tolerance:Inches:X.XXX±0.02
 Millimeters:X.XX±0.5

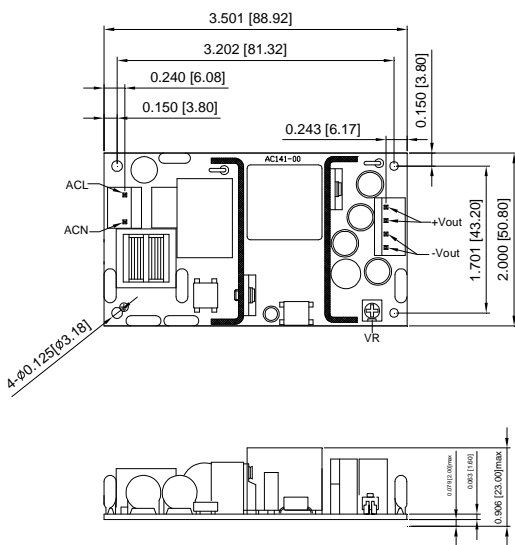

CFM20XS-P Series

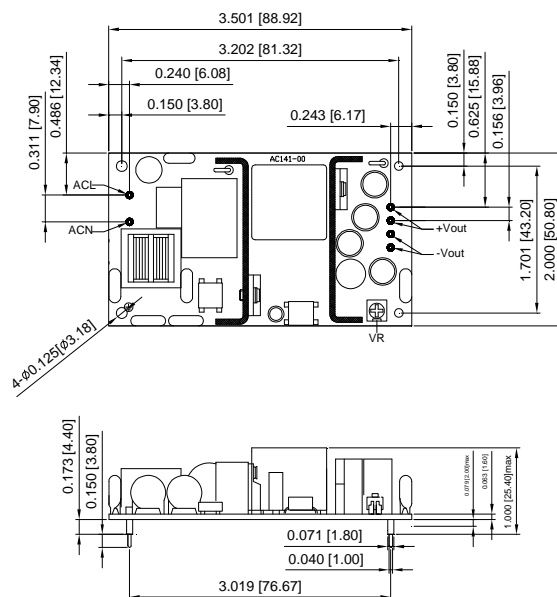

Typical at 25°C, nominal line and 75% load, unless otherwise Specified