

SYMBOL DEFINITION		MISSING SYMBOLS	
A DIMENSION WITHOUT AN INSPECTION REPORT SYMBOL DOES NOT REQUIRE INSPECTION. IT MAY BE CONTROLLED ON THE INDIVIDUAL COMPONENT DRAWING.	TOTAL NO OF INSPECTIONS REQUIRED	38	NO MISSING SYMBOL NUMBER
	LAST NO. USED	20	

DWG STATUS					REVISION HISTORY			AUTH	DR	APVD
DATE	STG	REV	W/P	CHG	ZONE					
29JUL02	R	04	-	-		REDRAWN TO PD & MAT'L SPEC WAS R0064366	228504	RH	RCH	RC
10SEP02	R	04	AA	-		4.75 +0.15/-0.35 WAS 4.75 +/-0.15	230162	RH	RCH	RC
12NOV02	R	04	AB	-		REVISED LOCK GRAPHICS	233537	RH	RH	ET

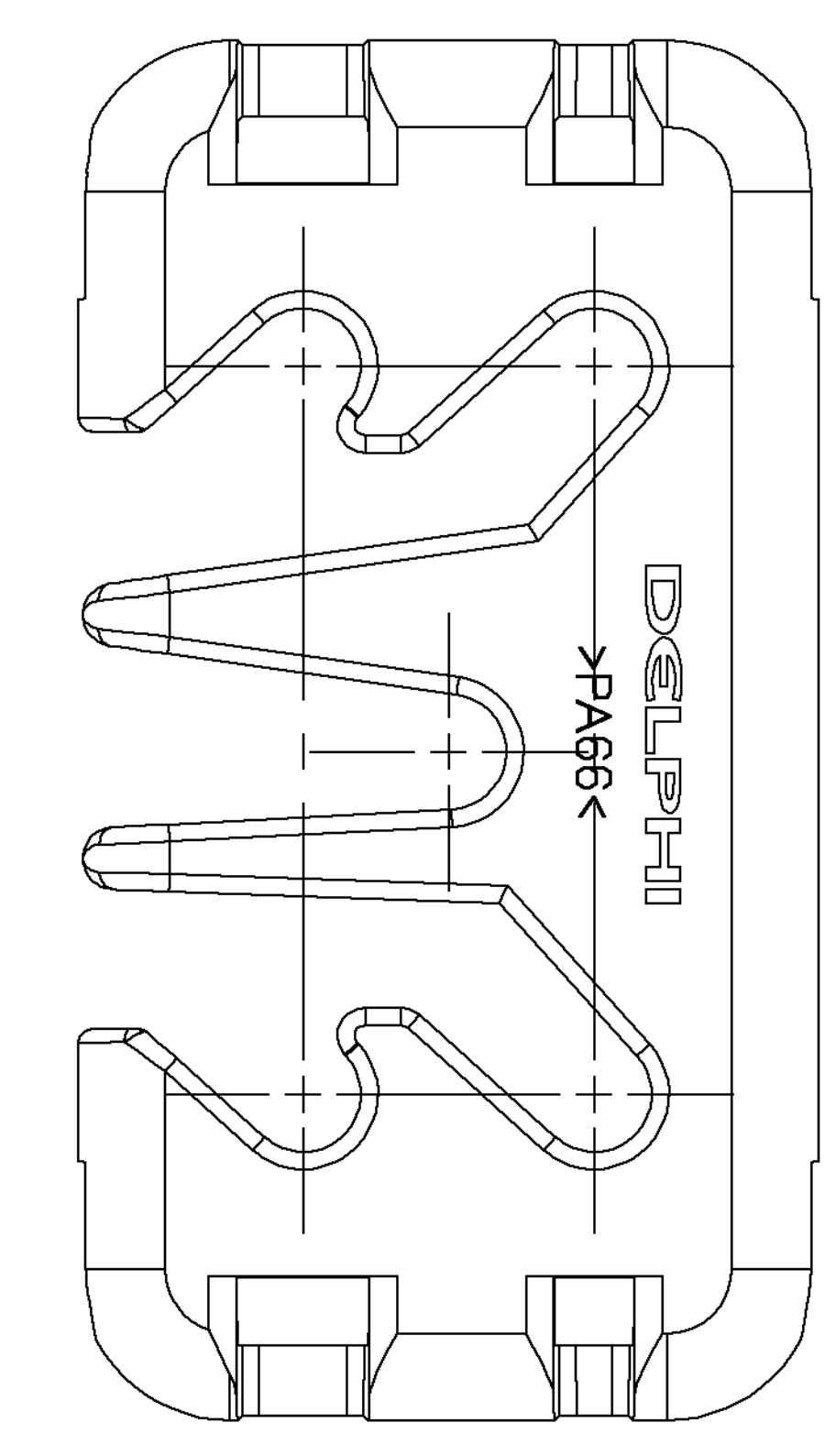
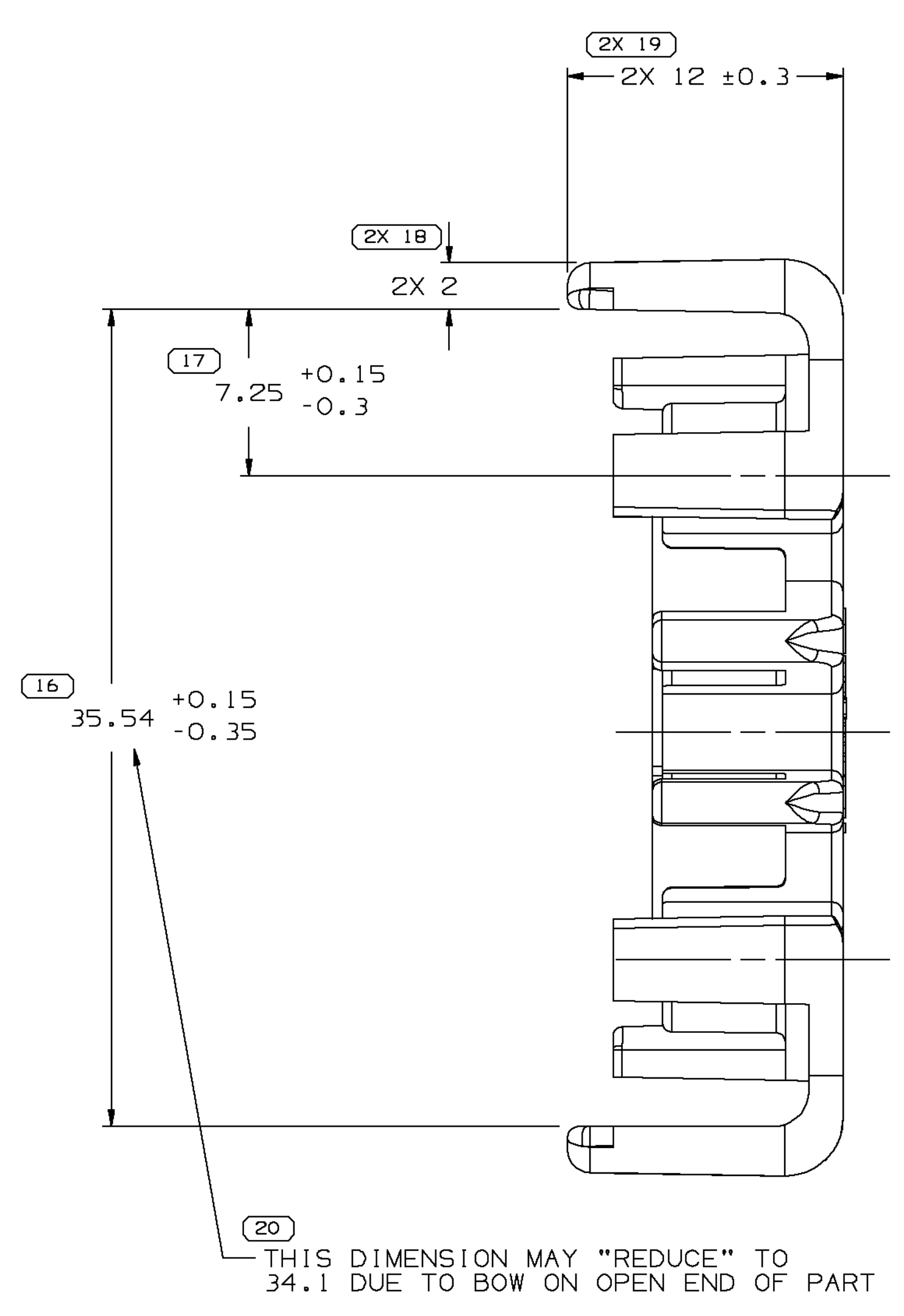
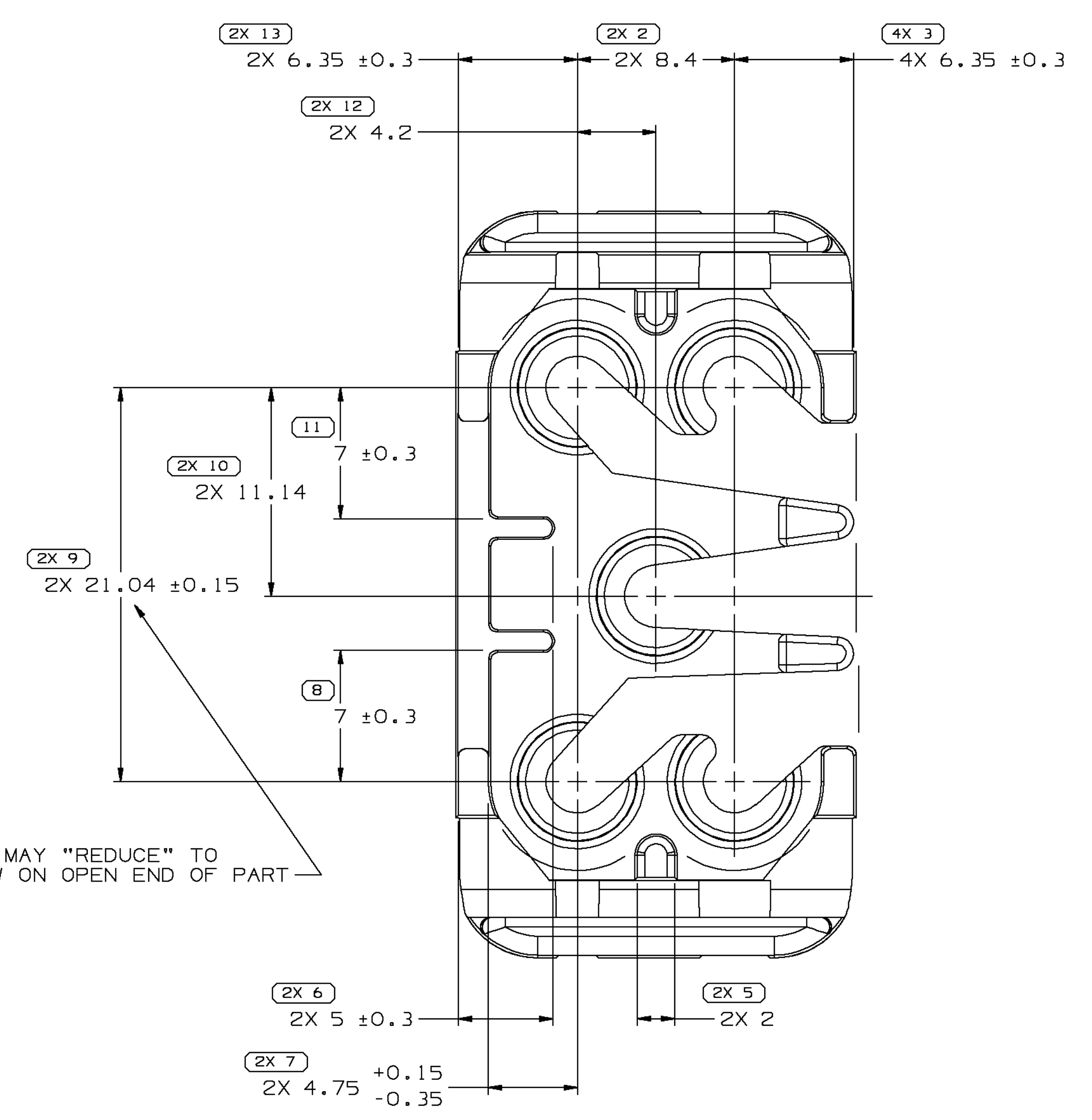
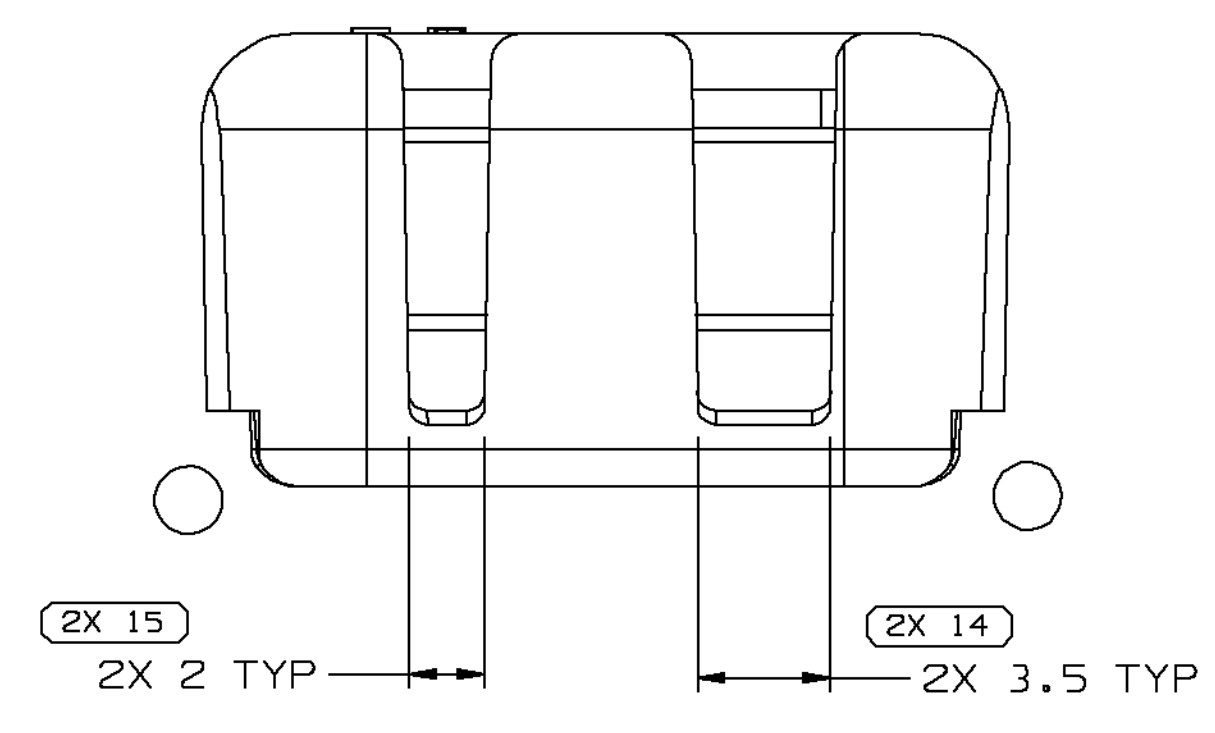

4 THIS DIMENSION MAY "REDUCE" TO 20.6 DUE TO BOW ON OPEN END OF PART

20 THIS DIMENSION MAY "REDUCE" TO 34.1 DUE TO BOW ON OPEN END OF PART

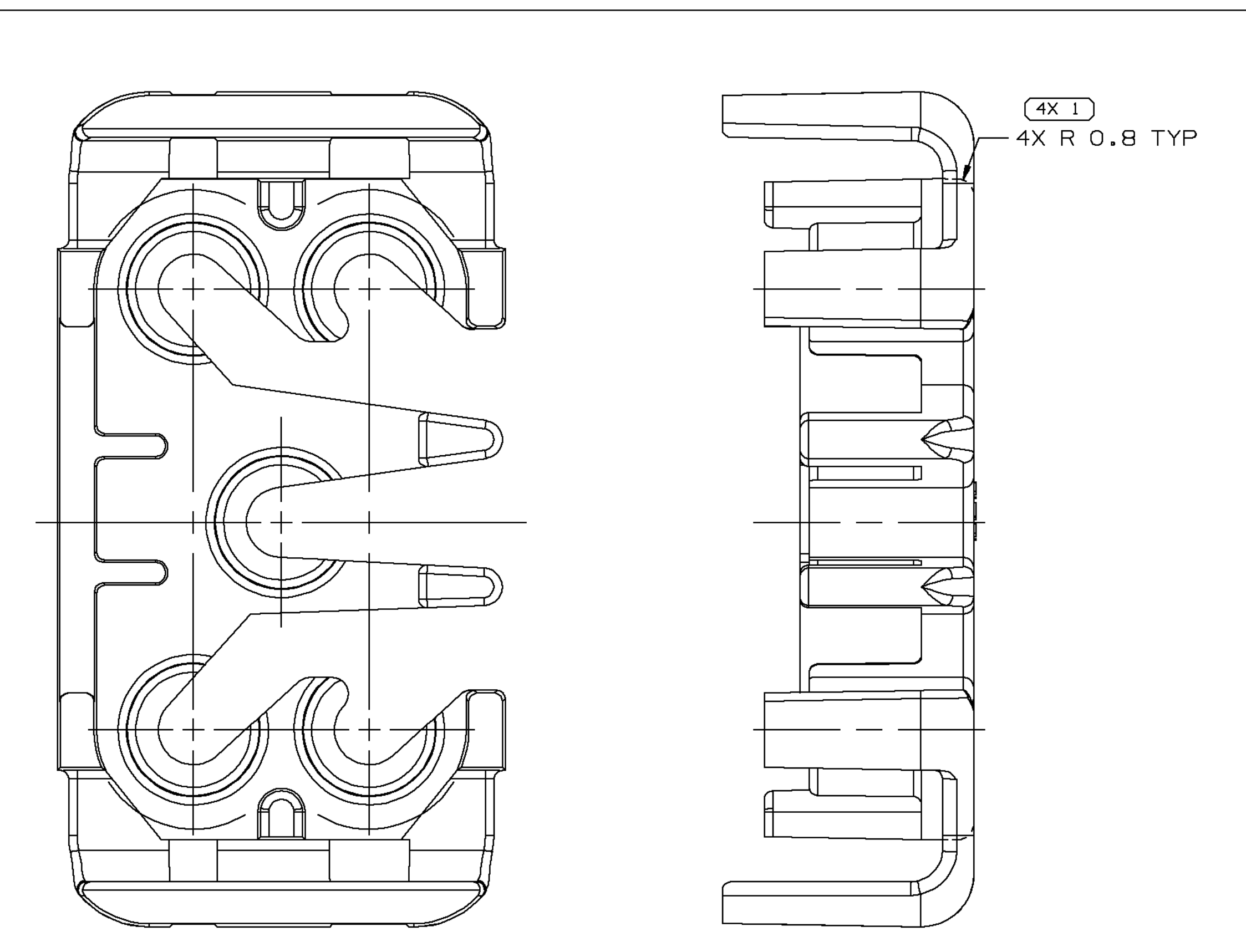

OPTIONAL CONSTRUCTION

NOTES

- UNLESS OTHERWISE SPECIFIED AND/OR INDICATED: DIMENSIONS ARE TO FACE OF VIEW SHOWN AND AUTOMATICALLY ROUNDED BY COMPUTER FOR INSPECTION (SEE MATH MODEL FOR PRECISE DIMENSIONS). FOR ALL OTHER DIMENSIONS NOT SHOWN BUT REQUIRED FOR TOOL BUILD, SEE MATH MODEL FOR PRECISE TOOL PATH DATA.
- MATERIAL RECYCLING CODE >PA66< PER SAE J1344. (1)X(0.1) RAISED CHARACTERS AS SHOWN TO BE LOCATED ON ANY EXTERIOR SURFACE. OPTIONAL CONSTRUCTION TO BE NO MATERIAL RECYCLING CODE.
- THIS PART IS NOT CONTROLLED FOR AUTOMATIC FEEDING.
- MATING COMPONENTS OR EQUIVALENT: CONN & SEAL ASM 12052813
- (1)X(0.1) RAISED DELPHI CORPORATE BRAND TO BE LOCATED ON ANY EXTERIOR SURFACE, PREFERABLY VISIBLE AT FINAL ASSEMBLY. OPTIONAL CONSTRUCTION TO BE "PED" OR NO LOGO.
- MAX CABLE DIAMETER THAT WILL FIT PART IS 3.13.

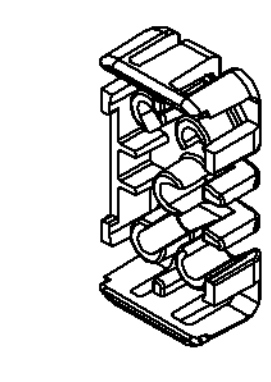

DELPHI
DELPHI PACKARD ELECTRIC SYSTEMS
WARREN, OH

OR	DATE
APVD1 R. HERMOSILLO	10SEP02
APVD2 R. CHACON	10SEP02
APVD3 R. CORZAS	12SEP02
APVD4	
APVD5	

MATERIAL: M3592025 PA66 HS 1M GRA MD
SUBSTANCES OF CONCERN AND RECYCLED CONTENT PER DELPHI 10949001

DRAWING NAME: TPA M/P 280
DRAWING NUMBER: 12052816

SHEET NO: 1 OF 1
SHEET REV: 1
REV: 1
DATE: 04 AB

UNLESS OTHERWISE SPECIFIED:
THIS DOCUMENT IS IN ACCORDANCE WITH ASME Y14.5M-1994 AS AMENDED BY THE 2003 DIMENSIONING AND TOLERANCING ADDENDUM - 1997. ALL GEOMETRIC TOLERANCES AND RELATED DATUMS APPLY TO ALL DIMENSIONS UNLESS OTHERWISE SPECIFIED.
MFGI DOES NOT APPLY WHEN RELATIONSHIP BETWEEN FEATURES IS ESTABLISHED BY ORIENTATION OR LOCATION TOLERANCES. SEPARATE POSITION CALLOUTS MAY BE BASED SEPARATELY, REGARDLESS OF DATUM REFERENCE.
ALL DIMENSIONS ARE IN MILLIMETERS.

DIMENSIONAL RANGE (MM)	TOLERANCE
FROM 0 TO 20	±0.15
20 TO 30	±0.2
30 TO 50	±0.3
50 TO 100	±0.4
100 TO 150	±0.5
150 TO 200	±0.6
200 TO 250	±0.8
250 TO 300	±1
300 TO 400	±1.2

CHART ET
TOLERANCE UNLESS OTHERWISE SPECIFIED
ANGULAR TOLERANCE ±2°

DO NOT SCALE
USE MATH DATA
UNIGRAPHICS