

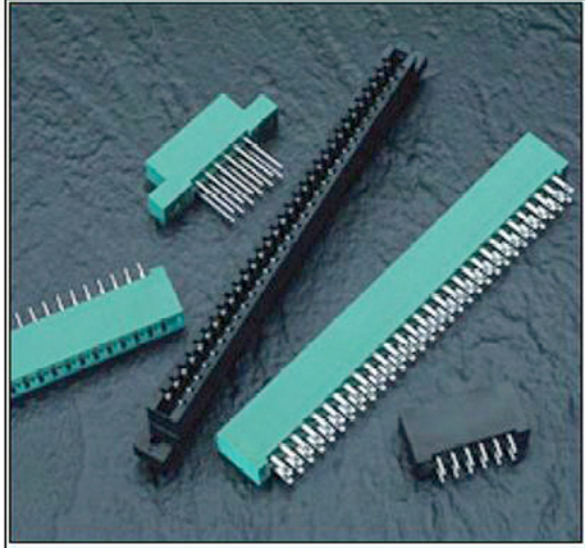

SERIES 337/387



Example Part Number 337 - 086 - 524 - 2 04

Series _____
 Total Number of Contacts _____
 Contact Code _____
 Contact Rows and Insulator Style _____
 Mounting Options _____

| Series | Insulator Colour |
|--------|------------------|
| 337 | Green |
| 387 | Black |

| Total Number of Contacts | Contact Rows |
|--------------------------|--------------|
| 006, 007, ..., 043 | Single Row |
| 012, 014, ..., 086 | Dual Row |

| Contact Code | Description & Tail Size | Tail Length "G" |
|--------------|---|-----------------|
| 500 | Wire Hole .050 x .025 (1.27 x 0.64) | .260 (6.60) |
| 520 | P.C. Tail .030 x .018 (0.76 x 0.46) | .175 (4.45) |
| 521 | P.C. Tail .025 Square (0.64 Square) | .150 (3.81) |
| 523 | P.C. Tail .025 Square (0.64 Square) | .390 (9.91) |
| 524 | P.C. Tail .018 Square (0.46 Square) | .175 (4.45) |
| 540 | Wire Wrap .025 Square (0.64 Square) | .560(14.22) |
| 541 | Wire Wrap .025 Square (0.64 Square) | .750(19.05) |
| 542 | Wire Wrap .025 Square (0.64 Square) | .645(16.38) |
| 544 | Wire Wrap .050 x .025 (1.27 x 0.64) | .750(19.05) |
| 555 | Extender Board Bend (Code 500 Contacts) | |
| 556 | Extender Board Bend (Code 520 Contacts) | |
| 558 | 90 Degree Bend (Code 541 Contacts) | |
| 559 | 90 Degree Bend (code 541 Contacts) | |
| 560 | Extender Board Bend (Code 523 Contacts) | |

| Contact Rows and Insulator Style | Description |
|----------------------------------|-------------------------------------|
| 1 | Single Row, Flush Mounting Lugs |
| 2 | Dual Row, Flush Mounting Lugs |
| 6 | Single Row, .170 (4.32) Offset Lugs |
| 8 | Dual Row, .170 (4.32) Offset Lugs |

| Mounting Options | Description |
|------------------|--------------------------------------|
| 01 | No Mounting Lugs |
| 02 | .128 (3.25) Dia. Mounting Holes |
| 03 | .116 (2.95) I.D. Floating Eyelets |
| 04 | .156 (3.96) Dia. Mounting Holes |
| 07 | M3-0.5 Metric Threaded Inserts |
| 08 | #4-40 Unified Threaded Inserts |
| 12 | .128 (3.25) Dia. Side Mounting Holes |
| 58 | .468 (11.89) Offset Card Guides |
| 78 | In-Line Card Guides |

Ordering Code Notes

- 1) All connector sizes up to 43 contacts single row / 86 contacts dual row are available upon request
- 2) The 500 contact code is standard in the 337 series only. Diallyl Phthalate insulator material will be supplied
- 3) For lugless connectors, code 01 mounting, specify contact rows codes 1 or 2
- 4) In-Line card guides are only available with offset mounting lugs

FEATURES

UL Recognized

.156 (3.96) Contact Spacing x .200 (5.08) Row Spacing

Accepts .062 (1.57) Nominal Thickness P.C. Board

High Profile Insulator Body, .600 (15.24)

Contact Termination Options include P.C Tail, Wire Hole, Wire Wrap, 90 Degree & Extender Board Bends

Single or Dual Row Configurations

Large Variety of Mounting Options, Flush or Offset Lugs

Pre-assembled Card Guides Available

Accepts Between Contact and In-Contact Polarizing Keys

SPECIFICATIONS

Insulator Material: Thermoplastic Polyester, UL 94V-0.

Contact Material: Copper, Nickel, Tin Alloy CA-725

Contact Plating: Gold on the Mating Area, Tin on the

Contact Tails, Nickel Underplate

Current Rating: 3 Amperes Continuous

Contact Resistance: 10 Milliohms Maximum

Dielectric Withstanding Voltage: 1800 V AC rms at Sea Level Between Adjacent Contacts

Insulation Resistance: 5000 Megohms Minimum

Operating Temperature: -65 to +105 Degrees C

Insertion Force: 16 oz (4.45 N) Maximum per Contact Pair when Tested with a .070 (1.78) Thick Gauge

Withdrawal Force: 1 oz (.28 N) Minimum per Contact Pair when Tested with a .054 (1.37) Thick Gauge

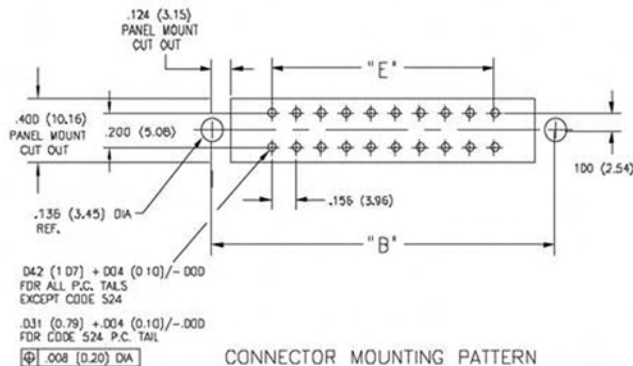
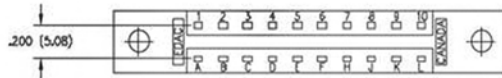
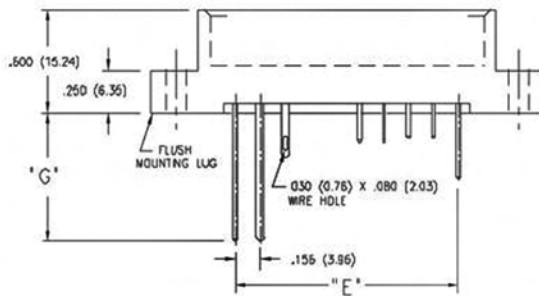
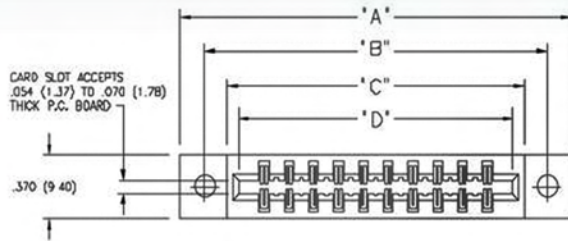

CONNECTOR MOUNTING PATTERN

BETWEEN CONTACT
POLARIZING KEY
P/N 306-240-318



IN-CONTACT
POLARIZING KEY
P/N 343-240-328

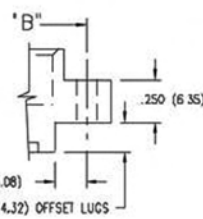

SINGLE ROW

DUAL ROW

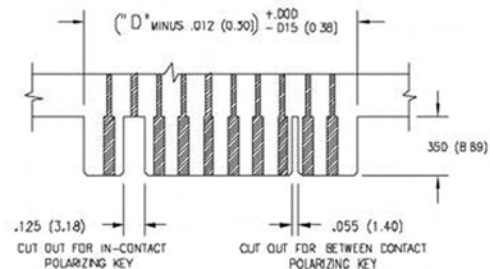
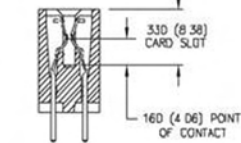
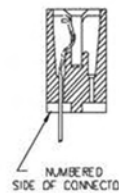

RECOMMENDED DAUGHTER BOARD

| NUMBER OF CONTACTS | | "A" | | "B" | | "C" | | "D" | | "E" | |
|--------------------|------|-------|----------|-------|----------|-------|----------|-------|----------|-------|----------|
| Single | Dual | Inch | (mm) | Inch | (mm) | Inch | (mm) | Inch | (mm) | Inch | (mm) |
| 6 | 12 | 1.842 | (46.79) | 1.532 | (38.91) | 1.246 | (31.65) | 1.100 | (27.94) | .780 | (19.81) |
| 10 | 20 | 2.466 | (62.64) | 2.156 | (54.76) | 1.870 | (47.50) | 1.724 | (43.79) | 1.404 | (35.66) |
| 12 | 24 | 2.778 | (70.56) | 2.468 | (62.69) | 2.182 | (55.42) | 2.036 | (51.71) | 1.716 | (43.59) |
| 15 | 30 | 3.246 | (82.45) | 2.936 | (74.57) | 2.650 | (67.31) | 2.504 | (63.60) | 2.184 | (55.47) |
| 18 | 36 | 3.714 | (94.34) | 3.404 | (86.46) | 3.118 | (79.20) | 2.972 | (75.49) | 2.652 | (67.36) |
| 22 | 44 | 4.338 | (110.19) | 4.028 | (102.31) | 3.742 | (95.05) | 3.596 | (91.34) | 3.276 | (83.21) |
| 25 | 50 | 4.806 | (122.07) | 4.496 | (114.20) | 4.210 | (106.93) | 4.064 | (103.23) | 3.744 | (95.10) |
| 26 | 52 | 4.962 | (126.03) | 4.652 | (118.16) | 4.366 | (110.90) | 4.220 | (107.19) | 3.900 | (99.06) |
| 28 | 56 | 5.274 | (133.96) | 4.964 | (126.09) | 4.678 | (118.82) | 4.532 | (115.11) | 4.212 | (106.98) |
| 31 | 62 | 5.742 | (145.85) | 5.432 | (137.97) | 5.146 | (130.71) | 5.000 | (127.00) | 4.680 | (118.87) |
| 33 | 66 | 6.054 | (153.77) | 5.744 | (145.90) | 5.458 | (138.63) | 5.312 | (134.92) | 4.992 | (126.80) |
| 36 | 72 | 6.522 | (165.66) | 6.212 | (157.78) | 5.926 | (150.52) | 5.780 | (146.81) | 5.460 | (138.68) |
| 43 | 86 | 7.614 | (193.40) | 7.304 | (185.52) | 7.018 | (178.26) | 6.872 | (174.55) | 6.552 | (166.42) |

Dimensions of Other Connector Sizes are Listed