

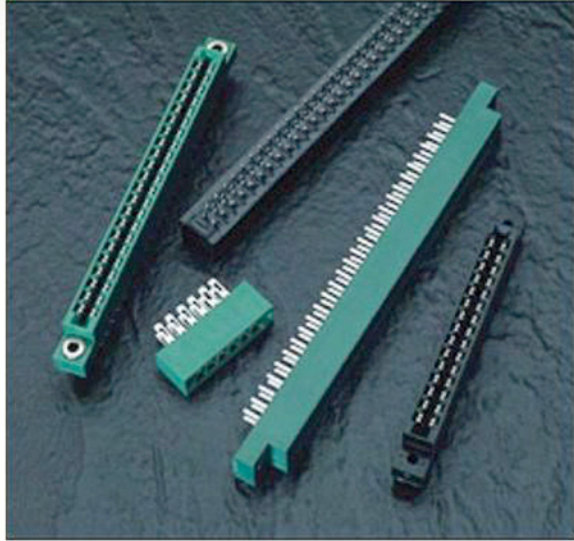

SERIES 306/316/356

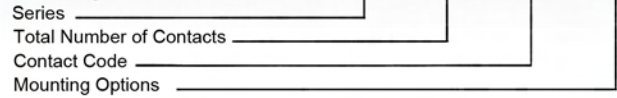

Example Part Number 306 - 022 - 521 - 178



| Series | Insulator Colour | Card Slot Length |
|--------|------------------|-----------------------------------|
| 306 | Green | Standard Length per MIL-C-21097 |
| 316 | Green | .020 (0.51) Shorter than Standard |
| 356 | Black | Standard Length per MIL-C-21097 |

| Total Number of Contacts | Contact Row |
|--------------------------|-------------|
| 006, 007, ... 043 | Centre Row |

| Contact Code | Description & Tail Size | Tail Length "G" |
|--------------|-------------------------------------|-----------------|
| 500 | Wire Hole .087 x .015 (2.21 x 0.38) | .282 (7.16) |
| 520 | P.C. Tail .046 x .015 (1.17 x 0.38) | .213 (5.41) |
| 521 | P.C. Tail .037 x .015 (0.94 X 0.38) | .125 (3.18) |

| Mounting Option | Description |
|-----------------|-----------------------------------|
| 101 | No Mounting Lugs |
| 102 | .128 (3.25) Dia. Mounting Holes |
| 103 | .116 (2.95) I.D. Floating Eyelets |
| 104 | .156 (3.96) Dia. Mounting Holes |
| 107 | M3-0.5 Metric Threaded Inserts |
| 108 | #4-40 Unified Threaded Inserts |
| 158 | .468 (11.89) Offset Card Guides |
| 168 | .344 (8.74) Offset Card Guides |
| 178 | In-Line Card Guides |

Ordering Code Notes

- 1) All connector sizes up to 43 contacts centre row are available upon request
- 2) For contacts with overall tin plating, change the first digit of the contact code from 5 to 4

FEATURES

- UL Recognized
- .156 (3.96) Contact Spacing with Single Row
- Accepts .062 (1.57) Nominal Thickness P.C. Board
- Low Profile Insulator Body, .460 (11.68)
- Contact Termination Options include P.C. Tail & Wire Hole
- Large Variety of Mounting Options
- Pre-assembled Card Guides Available
- Accepts Between Contact and In-Contact Polarizing Keys

SPECIFICATIONS

- Insulator Material: Thermoplastic Polyester, UL 94V-0
- Contact Material: Copper, Nickel, Tin Alloy CA-725
- Contact Plating: Gold on the Mating Area, Tin on the Contact Tails, Nickel Underplate
- Current Rating: 5 Amperes Continuous
- Contact Resistance: 10 Milliohms Maximum
- Dielectric Withstanding Voltage: 1800 V AC rms at Sea Level Between Adjacent Contacts
- Insulation Resistance: 5000 Megohms Minimum
- Operating Temperature: -65 to +105 Degrees C
- Insertion Force: 16 oz (4.45 N) Maximum per Contact when Tested with a .070 (1.78) Thick Gauge
- Withdrawl Force: 1 oz (0.28 N) Minimum per Contact when Tested with a .054 (1.37) Thick Gauge

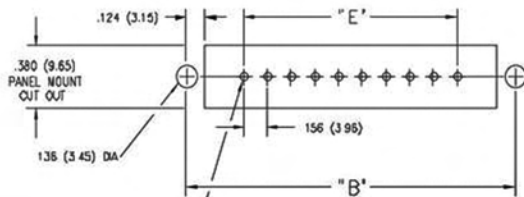
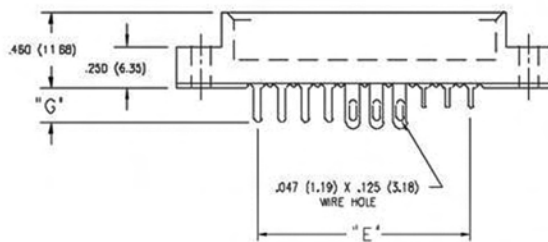
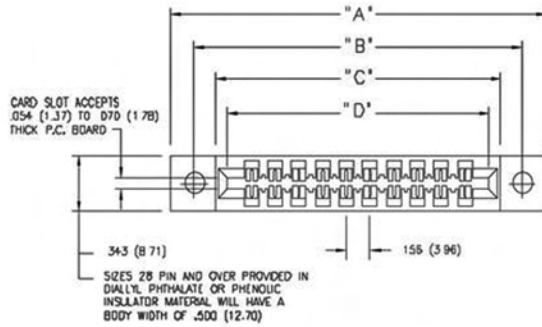

.050 (1.27) DIA +.004 (0.10) /-.000
FOR CODE 520 P.C. TAIL
.041 (1.04) DIA +.004 (0.10) /-.000
FOR CODE 521 P.C. TAIL
Φ .008 (0.20) DIA

CONNECTOR MOUNTING PATTERN

IN-CONTACT
POLARIZING KEY
P/N 338-240-328

BETWEEN CONTACT
POLARIZING KEY
P/N 306-240-318

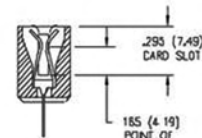

SECTION THROUGH CONTACT POSITION

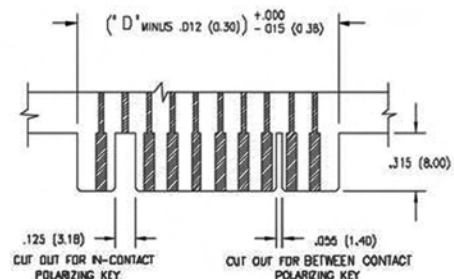

RECOMMENDED DAUGHTER BOARD

| NUMBER OF CONTACTS | "A" | | "B" | | "C" | | "D" | | "E" | | | |
|--------------------|-------|----------|-------|----------|-------|----------|----------------------|------------------|-------|----------|-------|----------|
| | Inch | (mm) | Inch | (mm) | Inch | (mm) | 306,356 Inch (mm) | 316 Inch (mm) | Inch | (mm) | | |
| Single | | | | | | | | | | | | |
| 6 | 1.842 | (46.79) | 1.532 | (38.91) | 1.246 | (31.65) | 1.100 | (27.94) | 1.080 | (27.43) | .780 | (19.81) |
| 8 | 2.154 | (54.71) | 1.844 | (46.84) | 1.558 | (39.57) | 1.412 | (35.86) | 1.382 | (35.36) | 1.092 | (27.74) |
| 10 | 2.466 | (62.64) | 2.156 | (54.76) | 1.870 | (47.50) | 1.724 | (43.79) | 1.704 | (43.28) | 1.404 | (35.66) |
| 12 | 2.778 | (70.56) | 2.468 | (62.69) | 2.182 | (55.42) | 2.036 | (51.71) | 2.016 | (51.21) | 1.716 | (43.59) |
| 15 | 3.246 | (82.45) | 2.936 | (74.57) | 2.650 | (67.31) | 2.504 | (63.60) | 2.484 | (63.09) | 2.184 | (55.47) |
| 18 | 3.714 | (94.34) | 3.404 | (86.46) | 3.118 | (79.20) | 2.972 | (75.49) | 2.952 | (74.98) | 2.652 | (67.36) |
| 22 | 4.338 | (110.19) | 4.028 | (102.31) | 3.742 | (95.05) | 3.596 | (91.34) | 3.576 | (90.83) | 3.276 | (83.21) |
| 25 | 4.806 | (122.07) | 4.496 | (114.20) | 4.210 | (106.93) | 4.064 | (103.23) | 4.044 | (102.72) | 3.744 | (95.10) |
| 28 | 5.274 | (133.96) | 4.964 | (126.09) | 4.678 | (118.82) | 4.532 | (115.11) | 4.512 | (114.60) | 4.212 | (106.98) |
| 30 | 5.596 | (141.88) | 5.276 | (134.01) | 4.990 | (126.75) | 4.844 | (123.04) | 4.824 | (122.53) | 4.524 | (114.91) |
| 36 | 6.522 | (165.66) | 6.212 | (157.78) | 5.926 | (150.52) | 5.780 | (146.81) | 5.760 | (146.30) | 5.460 | (138.68) |
| 40 | 7.146 | (181.51) | 6.836 | (173.63) | 6.550 | (166.37) | 6.404 | (162.66) | 6.384 | (162.15) | 6.084 | (154.53) |
| 43 | 7.614 | (193.40) | 7.304 | (185.52) | 7.018 | (178.26) | 6.872 | (174.55) | 6.852 | (174.04) | 6.552 | (166.42) |

Dimensions of Other Connector Sizes are Listed