

# 660-072 and 660-073 MIL-PRF-28876 Type Threaded Protective Covers

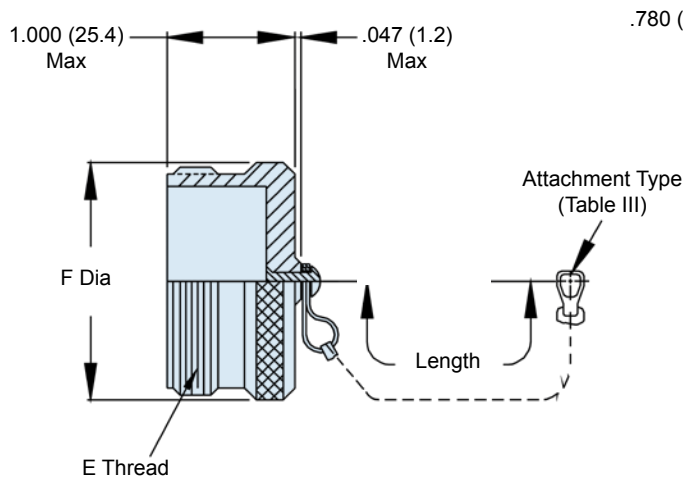

**660-072 Plug Cover**  
MIL-PRF-28876/10 Style

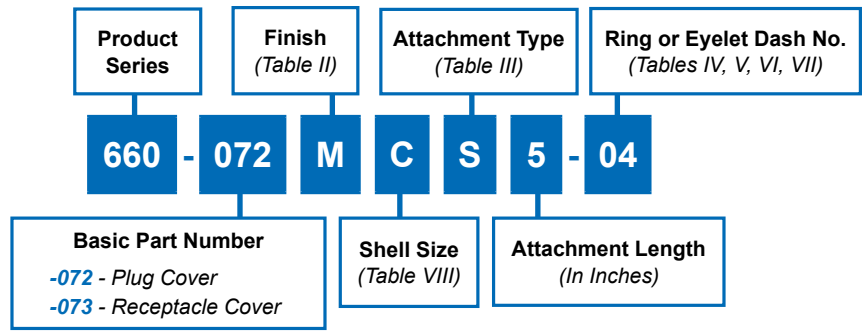
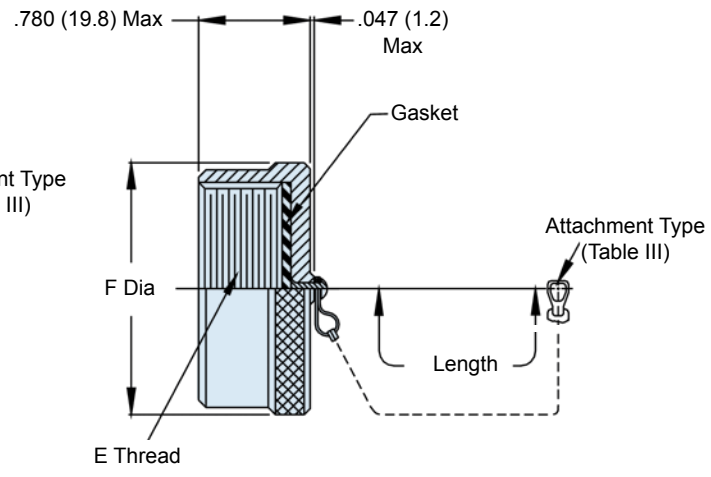

**660-073 Receptacle Cover**  
MIL-PRF-28876/15 Style

TABLE I: CONNECTOR SHELL SIZE			
Designator	Shell Size (Ref)	A Thread	B Dia Max
A	11	.750-.1P-.2L-DS	1.028 (26.1)
B	13	.875-.1P-.2L-DS	1.141 (29.0)
C	15	1.062-.1P-.2L-DS	1.263 (32.1)
D	17	1.125-.1P-.2L-DS	1.387 (35.2)
E	19	1.312-.1P-.2L-DS	1.513 (38.4)
F	23	1.500-.1P-.2L-DS	1.703 (43.5)
G	25	1.625-.1P-.2L-DS	1.825 (46.4)
H	29	1.812-.1P-.2L-DS	2.143 (54.4)
J	33	2.000-.1P-.2L-DS	2.329 (59.2)

TABLE II: FINISH		
SYM	MATERIAL	FINISH
<b>C</b>	Aluminum	Black Anodize
<b>M</b>	Aluminum	Electroless Nickel (Coupling Nut Electrodeposited)
<b>NF</b>	Aluminum	Olive Drab Cadmium over Electroless Nickel
<b>ZN</b>	Aluminum	Zinc-Nickel/Olive Drab over Electroless Nickel
<b>Z1</b>	Stainless Steel	Passivate

660-072 and 660-073  
MIL-PRF-28876 Typer  
Threaded Protective Covers



MIL-PRF-  
28876

C

**ROPE**  
(Types F, G, H, R, T, U)

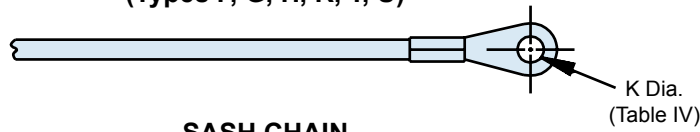

**SASH CHAIN**  
(Type S)

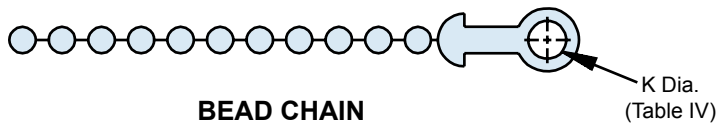
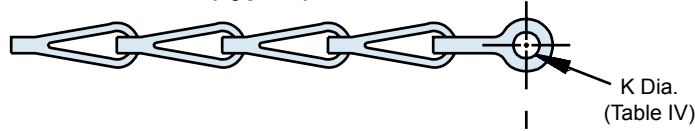

**BEAD CHAIN**  
(Type D)

**SPLIT RING - Style C**

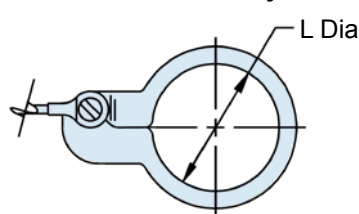

**SOLID RING - Style B**

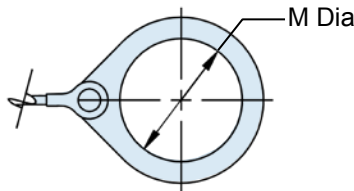

**SOLID RING - Style A**

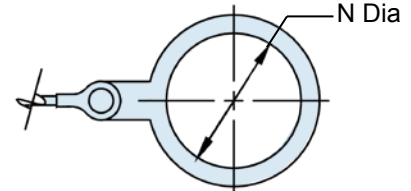

**TABLE V: SPLIT RING**

Dash No.	L Dia ±.015 (4.0)	Dash No.	L Dia ±.015 (4.0)
50	.425 (10.8)	74	1.625 (41.3)
52	.485 (12.3)	76	1.750 (44.5)
54	.640 (16.3)	78	1.220 (31.0)
56	.750 (19.1)	80	1.980 (50.3)
58	.890 (22.6)	82	2.060 (52.3)
60	1.015 (25.8)	84	2.235 (56.8)
62	1.095 (27.8)	86	2.310 (58.7)
64	1.130 (28.7)	88	2.475 (62.9)
66	1.250 (31.8)	90	2.655 (67.4)
68	1.350 (34.3)	92	2.810 (71.4)
70	1.390 (35.3)	94	3.045 (77.3)
72	1.485 (37.7)		

**TABLE VI: SOLID RING STYLE B**

Dash No.	M Dia ±.015 (4.0)	Dash No.	M Dia ±.015 (4.0)
08	.468 (11.9)	24	1.484 (37.7)
10	.593 (15.1)	25	1.577 (40.1)
12	.718 (18.2)	27	1.640 (41.7)
13	.765 (19.4)	28	1.687 (42.8)
14	.844 (21.4)	29	1.765 (44.8)
15	.890 (22.6)	30	1.890 (48.0)
16	.968 (24.6)	31	1.953 (49.6)
17	1.015 (25.8)	32	1.968 (50.0)
18	1.093 (27.8)	33	2.077 (52.8)
19	1.140 (29.0)	35	2.140 (54.4)
20	1.203 (30.6)	36	2.187 (55.5)
21	1.265 (32.1)	40	2.406 (61.1)
22	1.343 (34.1)	44	2.656 (67.5)
23	1.453 (36.9)	48	3.031 (77.0)

**TABLE VII: SOLID RING STYLE A**

Dash No.	N Dia ±.015 (4.0)	Dash No.	N Dia ±.015 (4.0)
095	.312 (7.9)	109	1.266 (32.2)
100	.391 (9.9)	209	1.312 (33.3)
101	.516 (13.1)	110	1.391 (35.3)
102	.583 (14.8)	210	1.391 (35.3)
103	.641 (16.3)	111	1.521 (38.6)
104	.708 (18.0)	211	1.536 (39.0)
105	.766 (19.5)	112	1.641 (41.7)
205	.788 (20.0)	113	1.766 (44.9)
106	.896 (22.8)	213	1.812 (46.0)
206	.907 (23.0)	114	1.891 (48.0)
107	1.016 (25.8)	214	1.938 (49.2)
207	1.025 (26.0)	115	2.078 (52.8)
108	1.141 (29.0)	116	2.406 (61.1)
308	1.188 (30.2)	117	2.510 (63.8)
208	1.203 (30.6)		

TABLE III: ATTACHMENT TYPE	
Sym	Attachment Type
D	Bead Chain, Cres., Passivate
F	Wire Rope, Nylon Jacket
G	Nylon Rope
H	Wire Rope, Teflon Jacket
N	No Attachment
R	Wire Rope, PVC Jacket
S	#8 Sash Chain, Cres., Passivate
T	Wire Rope, No Jacket
U	Wire Rope, Polyurethane Jacket with Terminal

TABLE IV: EYELET	
Dash No.	K Dia ±.010 (3.6)
01	.140 (3.6)
02	.182 (4.6)
03	.191 (4.9)
04	.197 (5.0)
05	.167 (4.2)
06	.125 (3.2)
07	.218 (5.5)
09	.156 (4.0)
00	No Eyelet

Metric dimensions (mm) are indicated in parenthesis.