

# AS85049/96 and M8528/3 Mounting Flange, 1/4 Perimeter

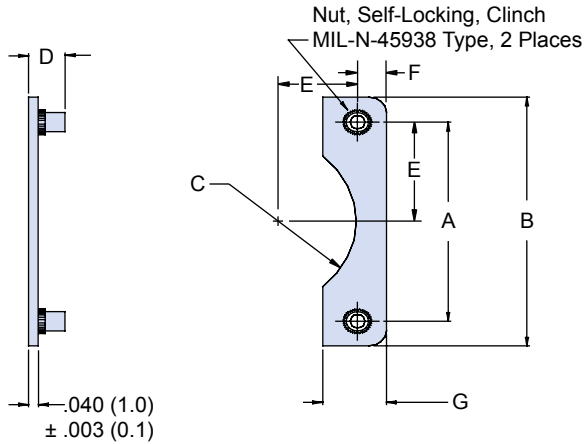

Miscellaneous  
Accessories



**M85049/96-24-A**

Basic Part No. \_\_\_\_\_  
Dash No. \_\_\_\_\_  
A = Primer Coat Required \_\_\_\_\_

**M8528/3-10-01**

Basic Part No. \_\_\_\_\_  
Dash No. \_\_\_\_\_  
Numerical designation 01 indicates corrosion resistant nuts are required. Omit for alloy steel nuts.

**TABLE I**

| Shell Size | Thread UNJC-3B | A<br>± .003 (0.1) | B<br>± .015 (0.4) | C<br>+ .015 (.4)<br>- .000 (.0) | D<br>± .030 (0.8) | E<br>± .005 (0.1) | F<br>(Ref)  | G<br>Max     |
|------------|----------------|-------------------|-------------------|---------------------------------|-------------------|-------------------|-------------|--------------|
| 3          | 4-40           | .625 (15.9)       | .925 (23.5)       | .300 (7.6)                      | .136 (3.5)        | .312 (7.92)       | .150 (3.81) | .310 (7.87)  |
| 7          | 4-40           | .719 (18.3)       | 1.016 (25.8)      | .298 (7.6)                      | .136 (3.5)        | .359 (9.12)       | .149 (3.78) | .308 (7.82)  |
| 8          | 4-40           | .594 (15.1)       | .891 (22.6)       | .296 (7.5)                      | .136 (3.5)        | .297 (7.54)       | .148 (3.76) | .306 (7.77)  |
| 10         | 4-40           | .719 (18.3)       | 1.016 (25.8)      | .298 (7.6)                      | .136 (3.5)        | .359 (9.12)       | .149 (3.78) | .308 (7.82)  |
| 12         | 4-40           | .812 (20.6)       | 1.109 (28.2)      | .296 (7.5)                      | .136 (3.5)        | .406 (10.31)      | .148 (3.76) | .306 (7.77)  |
| 14         | 4-40           | .906 (23.0)       | 1.203 (30.6)      | .296 (7.5)                      | .136 (3.5)        | .453 (11.51)      | .148 (3.76) | .306 (7.77)  |
| 16         | 4-40           | .969 (24.6)       | 1.266 (32.2)      | .298 (7.6)                      | .136 (3.5)        | .484 (12.29)      | .149 (3.78) | .308 (7.82)  |
| 18         | 4-40           | 1.062 (27.0)      | 1.390 (35.3)      | .328 (8.3)                      | .136 (3.5)        | .531 (13.49)      | .164 (4.17) | .338 (8.59)  |
| 19         | 4-40           | .906 (23.0)       | 1.203 (30.6)      | .296 (7.5)                      | .136 (3.5)        | .453 (11.51)      | .148 (3.76) | .306 (7.77)  |
| 20         | 4-40           | 1.156 (29.4)      | 1.510 (38.4)      | .354 (9.0)                      | .136 (3.5)        | .578 (14.68)      | .177 (4.50) | .364 (9.25)  |
| 22         | 4-40           | 1.250 (31.8)      | 1.640 (41.7)      | .390 (9.9)                      | .136 (3.5)        | .625 (15.88)      | .195 (4.95) | .400 (10.16) |
| 24         | 6-32           | 1.375 (34.9)      | 1.760 (44.7)      | .386 (9.8)                      | .153 (3.9)        | .687 (17.45)      | .193 (4.90) | .396 (10.06) |
| 25         | 6-32           | 1.500 (38.1)      | 1.859 (47.2)      | .358 (9.1)                      | .153 (3.9)        | .750 (19.05)      | .179 (4.55) | .368 (9.35)  |
| 27         | 4-40           | .969 (24.6)       | 1.266 (32.2)      | .298 (7.6)                      | .136 (3.5)        | .484 (12.29)      | .149 (3.78) | .308 (7.82)  |
| 28         | 6-32           | 1.562 (39.7)      | 2.000 (50.8)      | .438 (11.1)                     | .153 (3.9)        | .781 (19.84)      | .219 (5.56) | .448 (11.38) |
| 32         | 6-32           | 1.750 (44.5)      | 2.312 (58.7)      | .562 (14.3)                     | .153 (3.9)        | .875 (22.23)      | .281 (7.14) | .572 (14.53) |
| 36         | 6-32           | 1.938 (49.2)      | 2.500 (63.5)      | .562 (14.3)                     | .153 (3.9)        | .969 (24.61)      | .281 (7.14) | .572 (14.53) |
| 37         | 4-40           | 1.187 (30.1)      | 1.500 (38.1)      | .314 (8.0)                      | .136 (3.5)        | .593 (15.06)      | .157 (3.99) | .324 (8.23)  |
| 61         | 4-40           | 1.437 (36.5)      | 1.812 (46.0)      | .376 (9.6)                      | .136 (3.5)        | .718 (18.24)      | .188 (4.78) | .386 (9.80)  |

1. For complete dimensions see applicable Military Specification.
2. Metric dimensions (mm) are indicated in parentheses.