

Single Overall
EMI/RFI
Shield Termination

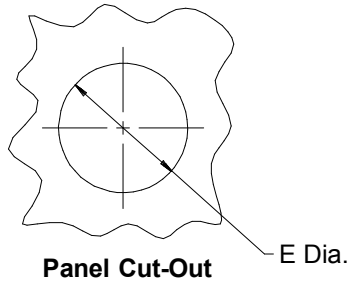
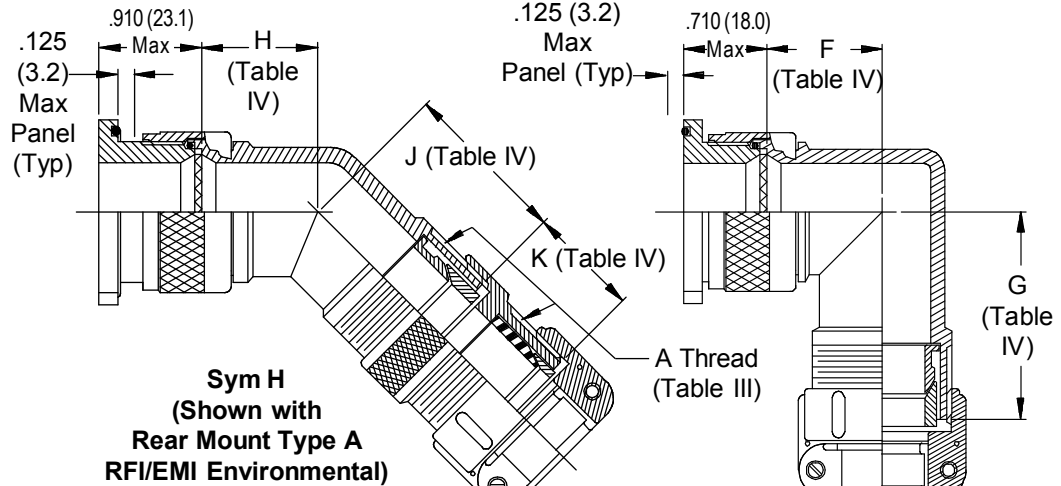
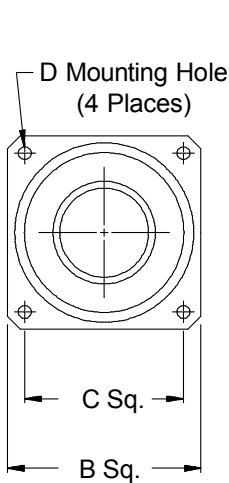
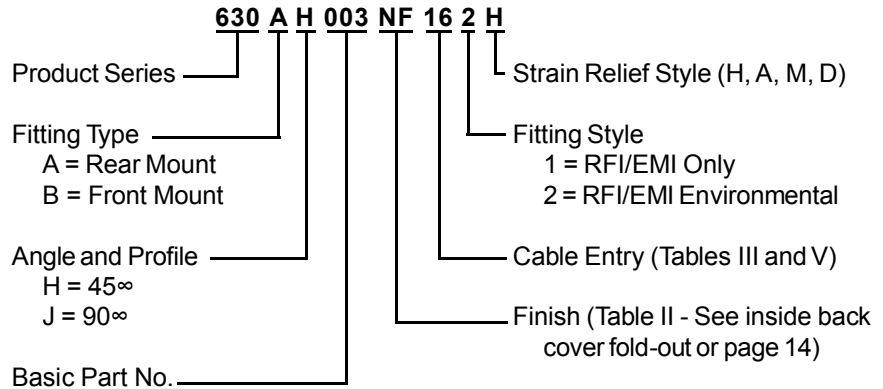

Sym H
 (Shown with
 Rear Mount Type A
 RFI/EMI Environmental)

Sym J
 (Shown With
 Front Mount Type B
 RFI/EMI Only)

STYLE H
 Heavy Duty
 (Table V)

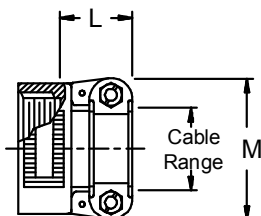

STYLE A
 Medium Duty
 (Table V)

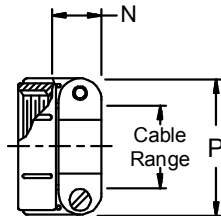

STYLE M
 Medium Duty
 (Table V)

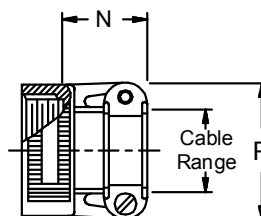

STYLE D
 Medium Duty
 (Table V)

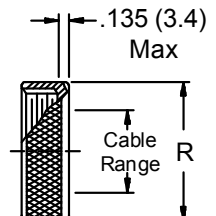

630-003
EMI/RFI Environmental Bulkhead Feed-Through
with Strain Relief
Front and Rear Panel Mount - 45° and 90°



TABLE III: CABLE ENTRY

Dash No.	Clamp Size	Cable Range		A Thread Unified	B Dim	C Sq. ± .010 (± .3)	D Dia		E Dia ± .010 (± .3)
		Min	Max				+ .015 (-0.000)	(+ .4) (-.0)	
01	03	.157 (4.0)	.250 (6.4)	1/2 -28	.885 (22.5)	.593 (15.1)	.120 (3.0)	.515 (13.1)	
03	04	.187 (4.7)	.312 (7.9)	5/8 -24	1.104 (28.0)	.812 (20.6)	.120 (3.0)	.640 (16.3)	
05	06	.281 (7.1)	.437 (11.1)	3/4 -20	1.197 (30.4)	.906 (23.0)	.120 (3.0)	.765 (19.4)	
07	08	.344 (8.7)	.562 (14.3)	7/8 -20	1.291 (32.8)	.968 (24.6)	.120 (3.0)	.890 (22.6)	
09	10	.375 (9.5)	.625 (15.9)	1 -20	1.385 (35.2)	1.062 (27.0)	.120 (3.0)	1.015 (25.8)	
11	12	.438 (11.1)	.750 (19.1)	1 3/16 -18	1.635 (41.5)	1.250 (31.8)	.120 (3.0)	1.202 (30.5)	
13	16	.625 (15.9)	.937 (23.8)	1 7/16 -18	1.760 (44.7)	1.375 (34.9)	.147 (3.7)	1.452 (36.9)	
15	20	.875 (22.2)	1.250 (31.8)	1 3/4 -18	2.010 (51.1)	1.562 (39.7)	.147 (3.7)	1.765 (44.8)	
17	24	1.000 (25.4)	1.375 (34.9)	2 -18	2.260 (57.4)	1.750 (44.5)	.173 (4.4)	2.015 (51.2)	
19	28	1.250 (31.8)	1.625 (41.3)	2 1/4 -16	2.510 (63.8)	1.938 (49.2)	.173 (4.4)	2.265 (57.5)	
21	32	1.437 (36.5)	1.875 (47.6)	2 1/2 -16	2.781 (70.6)	2.188 (55.6)	.173 (4.4)	2.515 (63.9)	
23	40	1.875 (47.6)	2.250 (57.2)	3 -16	3.281 (83.3)	2.625 (66.7)	.173 (4.4)	3.015 (76.6)	

TABLE IV: ELBOW DIMENSIONS

Dash No.	Clamp Size	F Max	G Max	H Max	J Max	K Max
01	03	.750 (19.1)	1.000 (25.4)	.639 (16.2)	.890 (22.6)	.670 (17.0)
03	04	.810 (20.6)	1.060 (26.9)	.664 (16.9)	.920 (23.4)	.670 (17.0)
05	06	.870 (22.1)	1.125 (28.6)	.688 (17.5)	.940 (23.9)	.670 (17.0)
07	08	.920 (23.4)	1.190 (30.2)	.705 (17.9)	.970 (24.6)	.670 (17.0)
09	10	.980 (24.9)	1.250 (31.8)	.732 (18.6)	.990 (25.1)	.670 (17.0)
11	12	1.080 (27.4)	1.330 (33.8)	.773 (19.6)	1.020 (25.9)	.670 (17.0)
13	16	1.200 (30.5)	1.480 (37.6)	.823 (20.9)	1.090 (27.7)	.670 (17.0)
15	20	1.480 (37.6)	1.781 (45.2)	1.041 (26.4)	1.322 (33.6)	.700 (17.8)
17	24	1.610 (40.9)	1.938 (49.2)	1.092 (27.7)	1.425 (36.2)	.700 (17.8)
19	28	1.720 (43.7)	2.045 (51.9)	1.138 (28.9)	1.475 (37.5)	.700 (17.8)
21	32	1.830 (46.5)	2.218 (56.3)	1.184 (30.1)	1.578 (40.1)	.820 (20.8)
23	40	2.080 (52.8)	2.594 (65.9)	1.287 (32.7)	1.802 (45.8)	.820 (20.8)

TABLE V: CABLE ENTRY

Dash No.	Clamp Size	L Max	M Max	N Max	P Max	R Max
01	03	---	---	.760 (19.3)	.843 (21.4)	.630 (16.0)
03	04	.780 (19.8)	.957 (24.3)	.760 (19.3)	.906 (23.0)	.755 (19.2)
05	06	.780 (19.8)	1.145 (29.1)	.760 (19.3)	1.093 (27.8)	.942 (23.9)
07	08	.780 (19.8)	1.332 (33.8)	.760 (19.3)	1.187 (30.1)	1.067 (27.1)
09	10	.780 (19.8)	1.332 (33.8)	.760 (19.3)	1.281 (32.5)	1.192 (30.3)
11	12	.811 (20.6)	1.551 (39.4)	.760 (19.3)	1.500 (38.1)	1.380 (35.1)
13	16	.905 (23.0)	1.770 (45.0)	1.073 (27.3)	1.719 (43.7)	1.535 (39.0)
15	20	1.092 (27.7)	2.113 (53.7)	1.323 (33.6)	2.062 (52.4)	1.848 (46.9)
17	24	1.124 (28.5)	2.363 (60.0)	1.323 (33.6)	2.312 (58.7)	2.255 (57.3)
19	28	1.399 (35.5)	2.770 (70.4)	1.572 (39.9)	2.719 (69.1)	2.505 (63.6)
21	32	1.399 (35.5)	3.020 (76.7)	1.572 (39.9)	2.969 (75.4)	2.755 (70.0)
23	40	---	---	1.572 (39.9)	3.531 (89.7)	3.255 (82.7)

1. Metric dimensions (mm) are indicated in parentheses.
2. Cable range is defined as the accommodations range for the wire bundle or cable. Dimensions shown are not intended for inspection criteria.