



# MS3180 and MS3181 Protective Plug and Receptacle Covers

**MATING CONNECTOR**  
**MIL-DTL-26482**

**Attachment Option**  
C = Chain  
N = Chain with Ring (MS3181 Only)  
R = Wire Rope

**Length**  
L = Chain or Rope Length of 5  
Inches (127.0 mm). Omit for  
Standard (See K in Table I)

**Prior Revision D Available:**

Finish is Cadmium Olive Drab

Attachment Option (Omit for None)  
C = Chain  
N = Chain with Ring (MS3181 Only)

**MS3180 - 12 C**

Basic Part Number  
MS3180 = Plug Cover  
MS3181 = Receptacle Cover

Shell Size

NOTE: prior revision parts will NOT carry the "JAN" marking

**MS3180 - 12 C A L**

Basic Part Number  
MS3180 = Plug Cover  
MS3181 = Receptacle Cover

Shell Size (Table I)

Finish  
A = Anodize

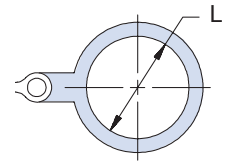
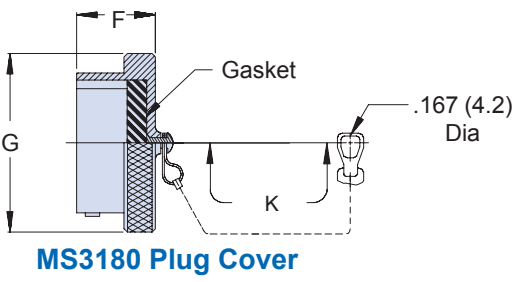

**MS3181 Optional Ring Attachment**

**TABLE I: Shell Size, Dimensions and Attachment**

Shell Size	F Max	G Dia Max	H Dia Max	J Max	K Standard Length (Inches)	L Min
8	.562 (14.3)	.719 (18.3)	.734 (18.6)	.562 (14.3)	3.00 (76.2)	.578 (14.7)
10	.562 (14.3)	.844 (21.4)	.859 (21.8)	.562 (14.3)	3.00 (76.2)	.703 (17.9)
12	.562 (14.3)	1.000 (25.4)	1.000 (25.4)	.562 (14.3)	3.50 (88.9)	.891 (22.6)
14	.562 (14.3)	1.125 (28.6)	1.125 (28.6)	.562 (14.3)	3.50 (88.9)	1.016 (25.8)
16	.562 (14.3)	1.250 (31.8)	1.250 (31.8)	.562 (14.3)	3.50 (88.9)	1.141 (29.0)
18	.562 (14.3)	1.375 (34.9)	1.375 (34.9)	.562 (14.3)	3.50 (88.9)	1.266 (32.2)
20	.625 (15.9)	1.500 (38.1)	1.500 (38.1)	.562 (14.3)	4.00 (101.6)	1.391 (35.3)
22	.625 (15.9)	1.625 (41.3)	1.625 (41.3)	.562 (14.3)	4.00 (101.6)	1.516 (38.5)
24	.658 (16.7)	1.750 (44.5)	1.750 (44.5)	.602 (15.3)	4.00 (101.6)	1.641 (41.7)

- APPLICATION NOTES**
1. Assembly identified with manufacturer's name and part number, space permitting.
  2. For complete dimensions, see the applicable Military Specification.
  3. Metric dimensions (mm) are in parentheses.

Dimensions in inches (millimeters) and are subject to change without notice.  
Mil-Spec Backshells and Accessories U.S. CAGE Code 06324