

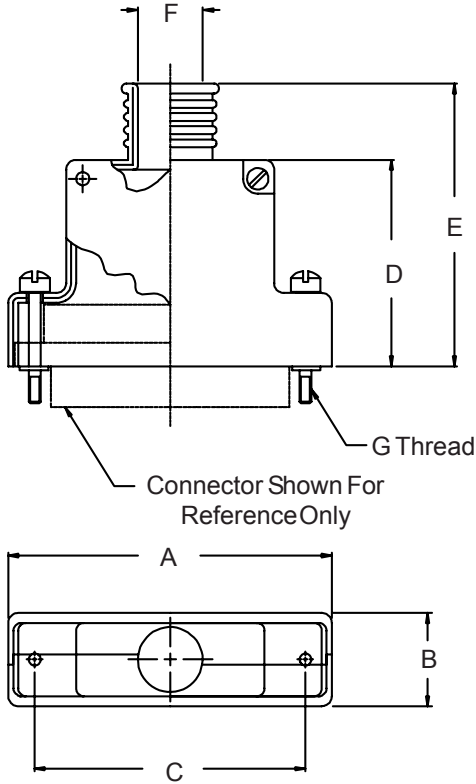

# 507-145 EMI/RFI Split Micro-D Banding Backshell



| HOW TO ORDER                                   |   |                      |                                  |  |
|--|---|----------------------|----------------------------------|--|
| Basic Part Number                              | Shell Plating *                                       | Shell Size (Table I) | Hardware Options *               | Band Option                                    |
| 507-145  | C - Black Anodize                                     | 09                   | Omit for (2) male fillister head | B  |
|  | E - Chem. Film  | 15                   |                                  |  |
|  | J - Gold Iridite Over Cadmium Over Electroless Nickel | 21                   | E - (2) extended jackscrew       | 600-057 Band Supplied - (Omit if Not Required) |
|  | M - Electroless Nickel                                | 25                   |                                  |  |
|  | NF - Cadmium, Olive Drab Over Electroless Nickel      | 31                   |                                  |  |
|  | Z2 - Gold   | 37                   | H - (2) male hex socket          |  |
|  |   | 51                   | F - (2) female jackpost          |  |
|  | 100   |                      |                                  |  |
| <b>Sample Part Number:</b>                     |   |                      |                                  |  |
| 507-145  | M   | 21                   | H                                | B  |
| <b>* SEE PAGE C-4 FOR COMPLETE INFORMATION</b> |   |                      |                                  |  |

TABLE I: DIMENSIONS

| SHELL SIZE | A Max        | B Max       | C ±.005 (0.1) | D ±.010 (0.3) | E ±.020 (.5) | F ±.005 (0.1) | G THREAD   |
|------------|--------------|-------------|---------------|---------------|--------------|---------------|------------|
| 09         | .915 (23.2)  | .450 (11.4) | .565 (14.4)   | .656 (16.7)   | .968 (24.6)  | .160 (4.1)    | 2-56 UNC-2 |
| 15         | 1.065 (27.1) | .450 (11.4) | .715 (18.2)   | .718 (18.2)   | 1.031 (26.2) | .190 (4.8)    | 2-56 UNC-2 |
| 21         | 1.215 (30.9) | .450 (11.4) | .865 (22.0)   | .750 (19.1)   | 1.062 (27.0) | .220 (5.6)    | 2-56 UNC-2 |
| 25         | 1.315 (33.4) | .450 (11.4) | .965 (24.5)   | .812 (20.6)   | 1.125 (28.6) | .260 (6.6)    | 2-56 UNC-2 |
| 31         | 1.465 (37.2) | .450 (11.4) | 1.115 (28.3)  | .843 (21.4)   | 1.156 (29.4) | .275 (7.0)    | 2-56 UNC-2 |
| 37         | 1.615 (41.0) | .450 (11.4) | 1.265 (32.1)  | .906 (23.0)   | 1.218 (30.9) | .285 (7.2)    | 2-56 UNC-2 |
| 51         | 1.565 (39.8) | .495 (12.6) | 1.215 (30.9)  | .968 (24.6)   | 1.281 (32.5) | .350 (8.9)    | 2-56 UNC-2 |
| 100        | 2.305 (58.5) | .540 (13.7) | 1.800 (45.7)  | 1.031 (26.2)  | 1.343 (34.1) | .490 (12.4)   | 4-40 UNC-2 |

Metric dimensions (mm) are indicated in parentheses.