

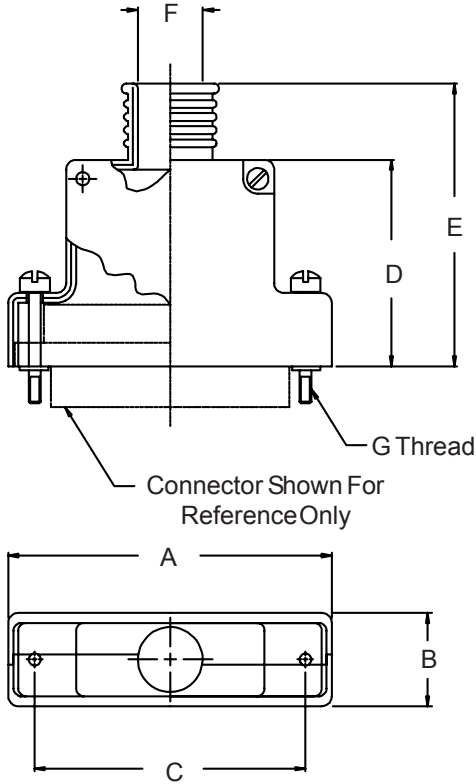

507-145 EMI/RFI Split Micro-D Banding Backshell



| HOW TO ORDER | | | | |
|----------------------------|---|----------------------|----------------------------------|--|
| Basic Part Number | Shell Plating * | Shell Size (Table I) | Hardware Options * | Band Option |
| 507-145 | C - Black Anodize | 09 | Omit for (2) male fillister head | B |
| | E - Chem. Film | 15 | | |
| | J - Gold Iridite Over Cadmium Over Electroless Nickel | 21 | E - (2) extended jackscrew | 600-057 Band Supplied - (Omit if Not Required) |
| | M - Electroless Nickel | 25 | | |
| | NF - Cadmium, Olive Drab Over Electroless Nickel | 31 | | |
| | Z2 - Gold | 37 | H - (2) male hex socket | |
| | | 51 | F - (2) female jackpost | |
| | 100 | | | |
| Sample Part Number: | | | | |
| 507-145 | M | 21 | H | B |

*** SEE PAGE C-4 FOR COMPLETE INFORMATION**

TABLE I: DIMENSIONS

| SHELL SIZE | A Max | B Max | C ±.005 (0.1) | D ±.010 (0.3) | E ±.020 (.5) | F ±.005 (0.1) | G THREAD |
|------------|--------------|-------------|---------------|---------------|--------------|---------------|------------|
| 09 | .915 (23.2) | .450 (11.4) | .565 (14.4) | .656 (16.7) | .968 (24.6) | .160 (4.1) | 2-56 UNC-2 |
| 15 | 1.065 (27.1) | .450 (11.4) | .715 (18.2) | .718 (18.2) | 1.031 (26.2) | .190 (4.8) | 2-56 UNC-2 |
| 21 | 1.215 (30.9) | .450 (11.4) | .865 (22.0) | .750 (19.1) | 1.062 (27.0) | .220 (5.6) | 2-56 UNC-2 |
| 25 | 1.315 (33.4) | .450 (11.4) | .965 (24.5) | .812 (20.6) | 1.125 (28.6) | .260 (6.6) | 2-56 UNC-2 |
| 31 | 1.465 (37.2) | .450 (11.4) | 1.115 (28.3) | .843 (21.4) | 1.156 (29.4) | .275 (7.0) | 2-56 UNC-2 |
| 37 | 1.615 (41.0) | .450 (11.4) | 1.265 (32.1) | .906 (23.0) | 1.218 (30.9) | .285 (7.2) | 2-56 UNC-2 |
| 51 | 1.565 (39.8) | .495 (12.6) | 1.215 (30.9) | .968 (24.6) | 1.281 (32.5) | .350 (8.9) | 2-56 UNC-2 |
| 100 | 2.305 (58.5) | .540 (13.7) | 1.800 (45.7) | 1.031 (26.2) | 1.343 (34.1) | .490 (12.4) | 4-40 UNC-2 |

Metric dimensions (mm) are indicated in parentheses.