

507-142 EMI/RFI Dual Entry Micro-D Banding Backshell

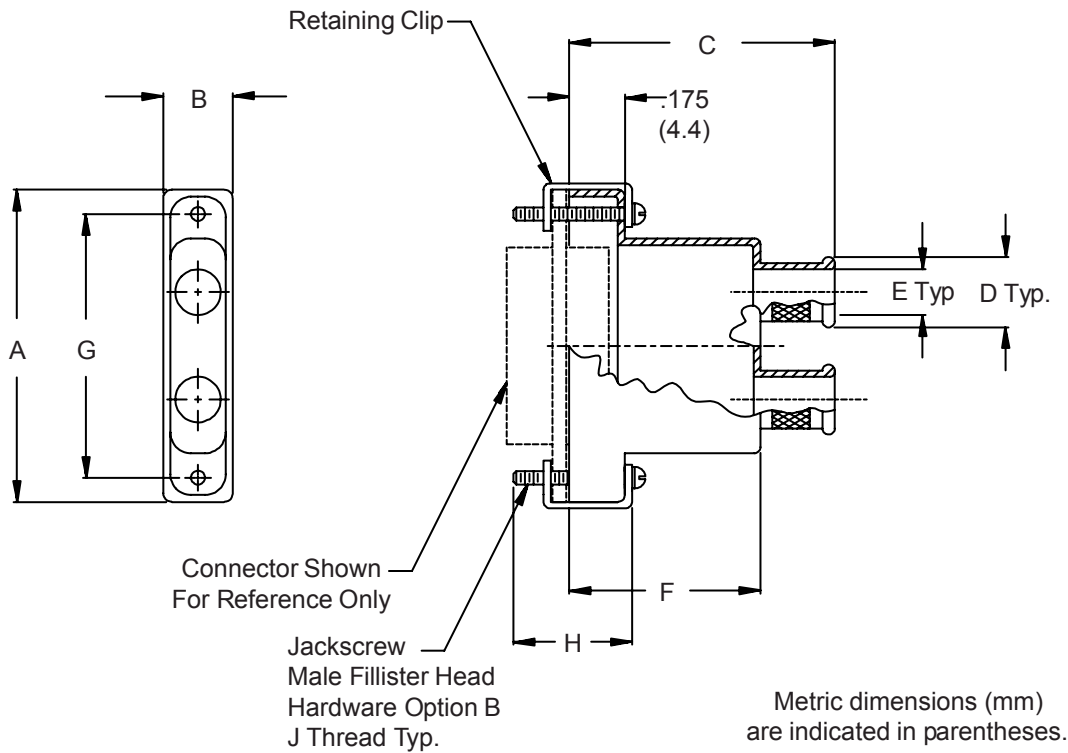

HOW TO ORDER

| Series | Basic Part Number | Shell Plating * | Shell Size (Table I) | Hardware Options * | Band Option |
|---|-------------------|---|---|---|--|
| 507 | 142 | C – Black Anodize E – Chem. Film J – Gold Iridite Over Cadmium Over Electroless Nickel M – Electroless Nickel NF – Cadmium, Olive Drab Over Electroless Nickel Z2 – Gold | 21 25 31 37 51 100 | B – (2) male fillister head E – (2) extended jackscrew H – (2) male hex socket F – (2) female jackpost | B Two 600-052 Bands Supplied (Omit if Not Required) |
| Sample Part Number: | | | | | |
| 507 | 142 | M | 21 | B | B |
| * SEE PAGE C-4 FOR COMPLETE INFORMATION | | | | | |

**507-142
EMI/RFI Dual Entry
Micro-D Banding Backshell**



MIL-DTL-83513
Micro-D

**See Part Number 500D001
(Page C-14) For Dual 45°
Entry Backshells**

Dual entry backshells provide two cable entries for branched cable assemblies and daisy chain applications. These backshells are designed for use with Glenair's EMI banding system.

- Two Cable Entries for Daisy Chain
- EMI Shielded
- One-Piece Machined Aluminum Construction
- Supplied with Mounting Hardware

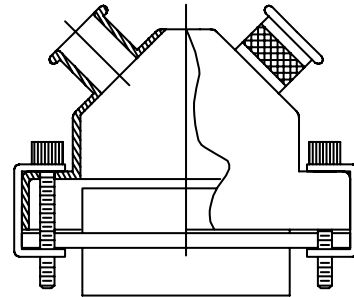

TABLE I: DIMENSIONS

| SHELL SIZE | A | B | C | D Dia | E Dia |
|------------|--------------|------------|--------------|-------------|-------------|
| 21 | 1.075 (27.3) | .34 (8.6) | 1.000 (25.4) | .281 (7.1) | .125 (3.2) |
| 25 | 1.175 (29.8) | .34 (8.6) | 1.060 (26.9) | .344 (8.7) | .188 (4.8) |
| 31 | 1.325 (33.7) | .34 (8.6) | 1.120 (28.4) | .406 (10.3) | .250 (6.4) |
| 37 | 1.475 (37.5) | .34 (8.6) | 1.160 (29.5) | .500 (12.7) | .344 (8.7) |
| 51 | 1.425 (36.2) | .38 (9.7) | 1.190 (30.2) | .469 (11.9) | .312 (7.9) |
| 100 | 2.160 (54.9) | .43 (10.9) | 1.250 (31.8) | .688 (17.5) | .500 (12.7) |

| SHELL SIZE | F | G | H | J THREAD |
|------------|-------------|--------------|-------------|------------|
| 21 | .560 (14.2) | .865 (22.0) | .438 (11.1) | 2-56 UNC-2 |
| 25 | .620 (15.7) | .965 (24.5) | .438 (11.1) | 2-56 UNC-2 |
| 31 | .680 (17.3) | 1.115 (28.3) | .438 (11.1) | 2-56 UNC-2 |
| 37 | .720 (18.3) | 1.265 (32.1) | .438 (11.1) | 2-56 UNC-2 |
| 51 | .750 (19.1) | 1.215 (30.9) | .438 (11.1) | 2-56 UNC-2 |
| 100 | .810 (20.6) | 1.800 (45.7) | .469 (11.9) | 4-40 UNC-2 |

Metric dimensions (mm) are indicated in parentheses.