

AS85049/105

Composite 90° RFI/EMI Shield-Sock Adapter with Detented or Non-Detented Self-Locking Coupling Nut

CONNECTOR DESIGNATOR:

| | |
|----------|---------------------------------|
| H | MIL-DTL-38999 Series III and IV |
|----------|---------------------------------|

| |
|---|
| Product Series and Basic Part Number |
|---|

| |
|-------------------------|
| Shell Size (Table I) |
|-------------------------|

| |
|-------------------|
| M85049/105 |
|-------------------|

| |
|-------------|
| - 11 |
|-------------|

| |
|----------|
| N |
|----------|

| |
|--|
| <i>N = Non-Detented Self-Locking (Omit for Detented Self-Locking) (See Note 6)</i> |
|--|

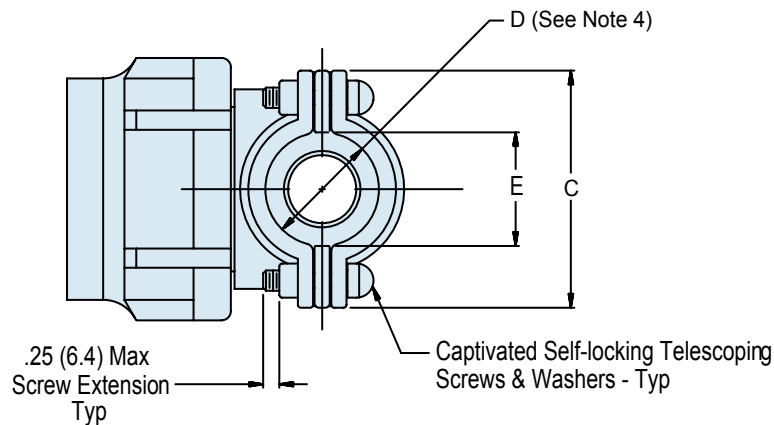
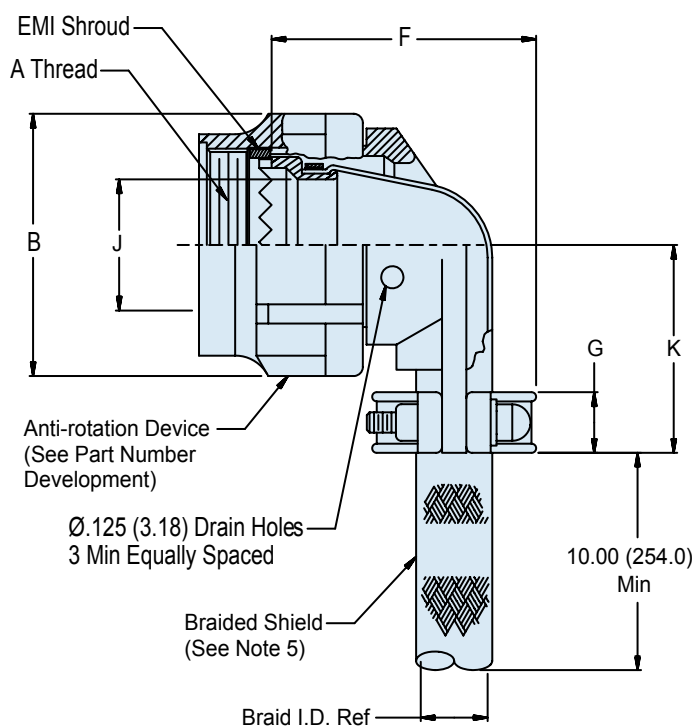
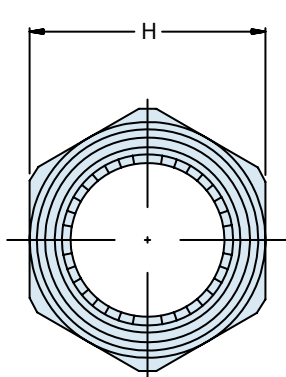

AS85049/105
Composite 90° RFI/EMI Shield-Sock Adapter
with Detented or Non-Detented Self-Locking Coupling Nut



TABLE I: Shell Size and Dimensions

| Shell Size | A Thread Class 2B | B Max | C Max | D ± .031 (0.79) See Note 4 | E Min | F Max | G ± .030 (0.76) | H Hex | J Min | K Max | Braid I.D. Ref | Screw Size |
|------------|-------------------|---------------|--------------|-------------------------------|--------------|---------------|-----------------|------------------------------|---------------|--------------|----------------|------------|
| 09 | M12 X 1 - 6H | .858 (21.79) | .98 (24.89) | .265 (6.73) | .229 (5.82) | 1.128 (28.65) | .375 (9.53) | .750/.736 (19.05/18.69) | .264 (6.71) | .94 (23.88) | .375 (9.53) | 4-40 |
| 11 | M15 X 1 - 6H | .984 (24.99) | 1.05 (26.67) | .310 (7.87) | .274 (6.96) | 1.168 (29.67) | .375 (9.53) | .875/.860 (22.23/21.84) | .390 (9.91) | 1.00 (25.40) | .375 (9.53) | 4-40 |
| 13 | M18 X 1 - 6H | 1.157 (29.39) | 1.20 (30.48) | .390 (9.91) | .354 (8.99) | 1.248 (31.70) | .406 (10.31) | 1.000/.980 (25.40/24.89) | .504 (12.80) | 1.12 (28.45) | .500 (12.70) | 6-32 |
| 15 | M22 X 1 - 6H | 1.280 (32.51) | 1.30 (33.02) | .506 (12.85) | .470 (11.94) | 1.368 (34.75) | .406 (10.31) | 1.125/1.100 (31.75/31.09) | .630 (16.00) | 1.19 (30.23) | .500 (12.70) | 6-32 |
| 17 | M25 X 1 - 6H | 1.406 (35.71) | 1.44 (36.58) | .591 (15.01) | .555 (14.10) | 1.448 (36.78) | .406 (10.31) | 1.250/1.224 (31.75/31.09) | .756 (19.20) | 1.37 (34.80) | .781 (19.84) | 6-32 |
| 19 | M28 X 1 - 6H | 1.516 (38.51) | 1.56 (39.62) | .661 (16.79) | .625 (15.88) | 1.528 (38.81) | .406 (10.31) | 1.375/1.348 (34.93/34.24) | .843 (21.41) | 1.44 (36.58) | .781 (19.84) | 6-32 |
| 21 | M31 X 1 - 6H | 1.642 (41.71) | 1.69 (42.93) | .744 (18.90) | .708 (17.98) | 1.648 (41.86) | .406 (10.31) | 1.500/1.469 (38.10/37.31) | .969 (24.61) | 1.56 (39.62) | 1.000 (25.40) | 6-32 |
| 23 | M34 X 1 - 6H | 1.768 (44.91) | 1.77 (44.96) | .826 (20.98) | .790 (20.07) | 1.688 (42.88) | .406 (10.31) | 1.625/1.581 (41.28/40.16) | 1.091 (27.71) | 1.69 (42.93) | 1.000 (25.40) | 6-32 |
| 25 | M37 X 1 - 6H | 1.890 (48.01) | 1.89 (48.01) | .896 (22.76) | .860 (21.84) | 1.758 (44.65) | .406 (10.31) | 1.750/1.690 (44.45/42.93) | 1.217 (30.91) | 1.81 (45.97) | 1.250 (31.75) | 6-32 |

Table II (Manufacturer's Option)

| Material | Finish |
|-----------------|------------------------|
| Aluminum Alloy | Iridite per AMS-C-5541 |
| Stainless Steel | Passivated |
| Copper | Tin Plate |

APPLICATION NOTES

- For complete dimensions see the applicable Military Specification.
- Metric dimensions (mm) are in parentheses.
- Glenair 600 Series backshell assembly tools are recommended for assembly and installation.
- Cable entry is measured with saddle bars closed and bottomed on clamp ears.
- For shield/splice termination use AS85049/93 split support ring.
- Detented self-locking has a positive audible detented coupling.
- Material/Finish:
 Clamp body, coupling nut, saddles - High grade engineering thermoplastic/N.A.
 Clamp hardware - CRES/passivated, silver plated, mfg option
 Anti-rotation device - Corrosion resistant material
 Braid - Copper/nickel plated
 Interface ring and shroud - Brass/nickel plated
 Braid retention device - See Table II