



Heyco® Double D Hole Plugs

For Mounting Holes with Flats

Multiple Locking Steps for Panel Thickness up to .125" (3,2 mm)

PANEL DIMENSIONS				PART NO.		DESCRIPTION	PART DIMENSIONS			
D		C		Black	White		A		B	
Mounting Hole Dia.	To Prevent Rotation	Mounting Hole Dia.	To Prevent Rotation			Head Diameter	Overall Height	in.	mm.	in.
.375	9,5	.345	8,8	2617	2618	DP 375*	.47	11,9	.41	10,3
.437	11,1	.390	9,9	2488	2489	DD 437-390	.53	13,5		
.500	12,7	.445	11,3	2491	2492	DD 500-445	.55	14,7		
.562	14,3	.530	13,5	2494	2495	DD 562-530	.66	16,7		
.625	15,9	.550	14,0	2497	2498	DD 625-550	.73	18,5		
.750	19,1	.625	15,9	2503	2504	DD 750-625	.92	23,4		
.875	22,2	.770	19,5	2509	2510	DD 875-770	1.02	25,8	.45	11,5
				2511	-	DD 875-770-9**	.94	23,8		
1.109	28,2	1.000	25,4	2717	2718	DD 1109-1000	1.22	30,9		
2.000	50,8	1.875	47,6	2959	2963	DD 2000-1875	2.17	55,1	.48	12,1

Standard colors black and white. Consult Heyco for other colors.

*On installation, DP 375 Locking Fingers must be aligned with Mounting Hole Flats.

**Smaller than standard Head Diameter, for clearance situations.

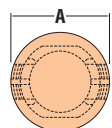

DD Series

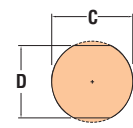
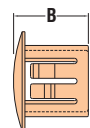

MOUNTING HOLE

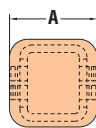

RP Series

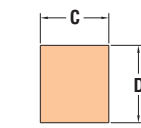

MOUNTING HOLE

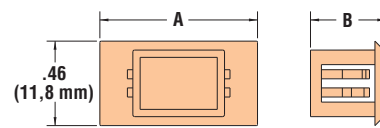

3299, 3388, 3389

Heyco® Rectangular Blanking & Connector Port Plugs

Multiple Locking Steps for Various Panel Thicknesses

Maximum Thickness	PANEL DIMENSIONS				PART NO.	DESCRIPTION	PART DIMENSIONS				
	Mounting Hole		C Length	D Width			Black	A Head Dimensions		B Overall Height	
in.	mm.	in.			mm.	in.		mm.	in.	mm.	in.
.025	0,64	.964	24,5	.964	24,5	13910	RP 245-245	1.06 x 1.06	26,9 x 26,9	.30	7,6
						13911	RB 245-245*	1.05 x 1.05	26,7 x 26,7		
.04	1,0	.27	6,9	.29	7,4	2512	RP 69-74	.37 x .37	9,4 x 9,4	.33	8,4
.10	2,5	.45	11,5	.51	13,9	1890	RP 115-130	.58 x .58	14,7 x 14,7	.40	10,2
.16	4,0	.69	17,5	.69	17,5	1892	RP 175-175	.83 x .83	21,1 x 21,1	.47	11,9

Rectangular Blanking Plugs

Maximum Thickness	C Length	D Width	PART NO.	DESCRIPTION	PART DIMENSIONS						
					A Head Dimensions	B Overall Height					
.14	3,5	.37	9,5	.51	13,0	3299	RP 95-130-1	.63	16,0	.41	10,5
						3388	RP 95-130	.87	22,0		
						3389	RP 95-260	1.38	35,0		

Connector Port Plugs

Standard color black.

*Bushing version of the above plug.

Material	Nylon 6/6
Certifications	UL Recognized under the Component Program of Underwriter Laboratories File E51579 (DD only)
Flammability Rating	94V-2
Temperature Range	-40°F (-40°C) to 221°F (105°C)

Quick Specs

- Blank unused rectangular panel holes.
- **PN 1890** - UR Recognized under the Component Program of Underwriters' Laboratories File E15331.
- **PN 1892** - UR Recognized under the Component Program of Underwriters' Laboratories File E51579 and CSA Certified by the Canadian Standards Association File 8919.