

CATALOG LISTING	
14XE65	
PAGE 1 OF 1	
6	
1 ISSUE	

REPLACES	
RELEASE NO.	PR-20454

CHECK	
CHECK	

REVISONS																							
A	C094968	TSM	04MAY99																				
B	204585	GRT	18 DEC 01																				

CHECK		CHECK		CHECK		CHECK		CHECK		CHECK		CHECK		CHECK		CHECK		CHECK		CHECK		CHECK	

TSM	04MAY99	JAF	04MAY99	04MAY99	04MAY99	04MAY99	04MAY99	04MAY99	04MAY99	04MAY99	04MAY99	04MAY99	04MAY99	04MAY99	04MAY99	04MAY99	04MAY99	04MAY99	04MAY99	04MAY99	04MAY99	04MAY99	04MAY99
PTC/CAD	2D																						
DRAWN																							

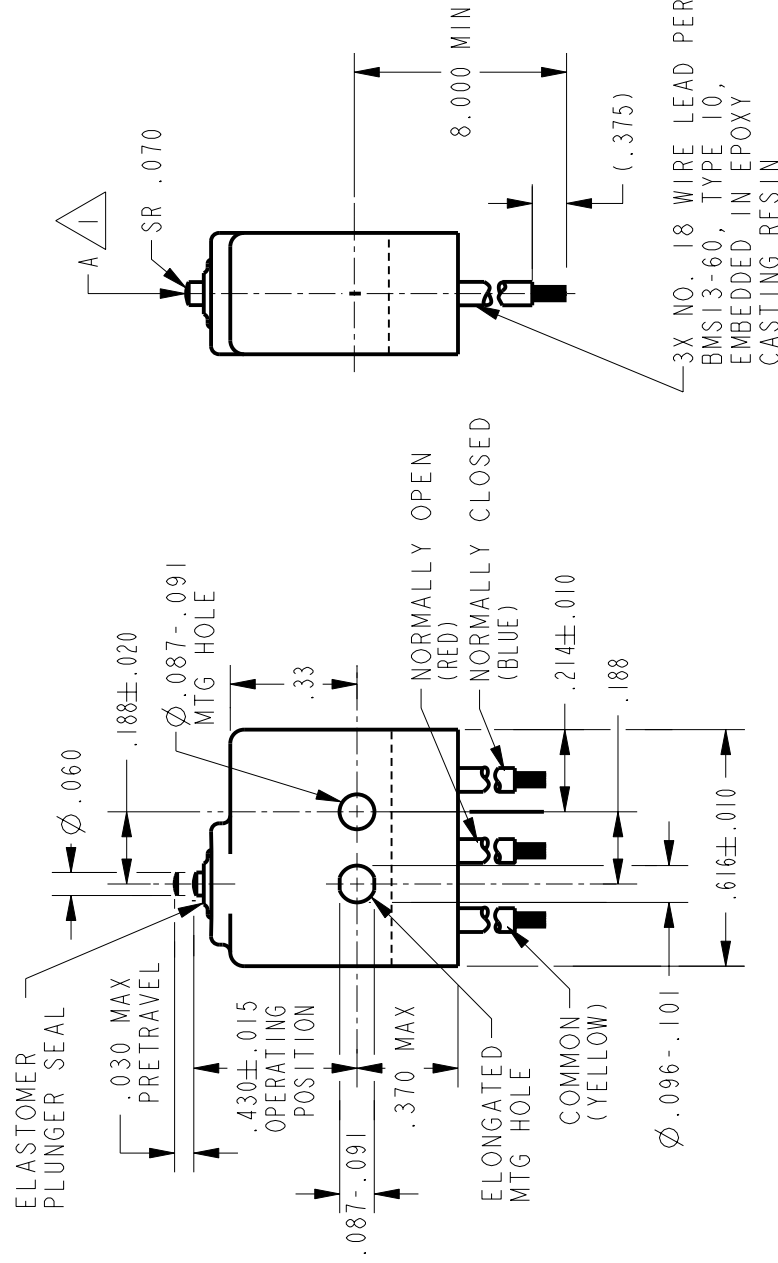
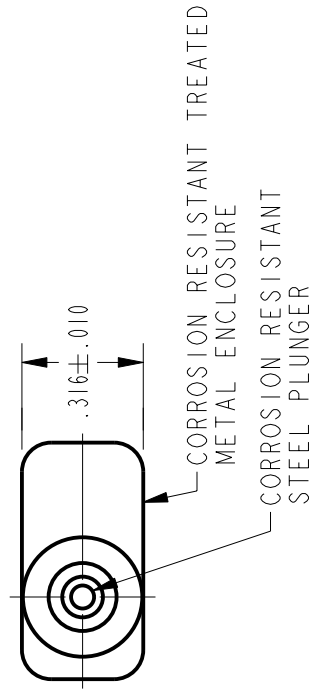

NOTES

- 1 ACTUATION IN LINE WITH ARROW "A" IS RECOMMENDED
- 2 WEIGHT OF SWITCH ONLY IS .16 OZ MAX. WEIGHT OF SWITCH WITH WIRE LEADS IS .75 OZ MAX
- 3 - FOR USE IN TEMPERATURE RANGE FROM MINUS -65° F TO PLUS +300° F
- 4 - WIRES ARE WELDED TO SWITCH TERMINALS

ANSI Y14.5M-1982 APPLIES

THIS DRAWING COVERS A PROPRIETARY ITEM AND IS THE PROPERTY OF MICRO SWITCH. A DIVISION OF HONEYWELL. THIS DRAWING IS NOT TO BE COPIED OR USED WITHOUT THE APPROVAL OF MICRO SWITCH.

THIRD ANGLE PROJECTION

CHARACTERISTICS	ELECTRICAL DATA	SCALE 2 : 1	DO NOT SCALE PRINT
OPERATING FORCE----- 9 OZ MAX	CONTACT ARRANGEMENT	UNLESS OTHERWISE SPECIFIED TOLERANCES ARE	
RELEASE FORCE----- 2 OZ MIN	S P D T	ONE PLACE (.0)	$\pm .030$
RELEASE TRAVEL----- .004 MIN	28 VOLTS DC RATING	TWO PLACE (.00)	$\pm .015$
DIFFERENTIAL TRAVEL----- .005 MAX	SEA LEVEL----- 4 AMP	THREE PLACE (.000)	$\pm .005$
OVERTRAVEL----- .004 MIN	INDUCTIVE----- 50,000 FT----- 2.5 AMP	ANGLES	\pm
	RESISTIVE----- SEA LEVEL----- 7 AMP	WEIGHT	$\frac{2}{2}$
	OVERTRAVEL----- 50,000 FT----- 7 AMP		