

TRANSISTOR MICA INSULATORS

Designers' Choice



- RAPID HEAT DISSIPATION • HIGH DIELECTRIC STRENGTH • NON-TOXIC • LOW COST • FROM STOCK

These precision stamped mica insulators provide good thermal conductivity (.009 watts per square inch per degree celsius per inch in thickness). Excellent thermal resistance 1100°F. Dielectric constant of 7 at 1000 Kilohertz.

ORDERING INFORMATION: Minimum quantity 100 pieces of an item.

MATERIAL SPECIFICATIONS: .003 thick mica is used for all the insulators on this page. Tolerance for thickness is plus or minus .001.

Modifications: Special thickness and other materials available on special order. Prompt quotations will be rendered.

FOR TO-3 CASES

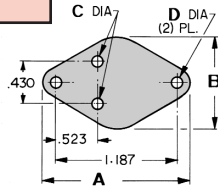
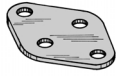

.003 THICK MICA

CAT.NO.	A	B	C	D
4651	1.625	1.093	.093	.166
4652	1.560	1.050	.203	.171
4653	1.655	1.063	.166	.166
4636	1.655	1.063	.052	.166
4644	1.655	1.063	.270	.166

FOR TO-36 CASES

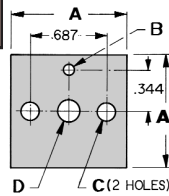

.003 THICK MICA

CAT.NO.	A	B	C	D
4655	1.125	.130	.187	.203
4656	1.250	.140	.156	.203

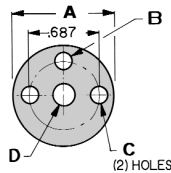

.003 THICK MICA

CAT.NO.	A	B	C	D
4657	1.062	.187	.187	.187
4659	1.187	.187	.187	.250

FOR TRANSISTOR CASES THREADED STUD

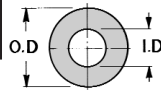

.003 THICK MICA

CAT. NO.	ID Inside Dia.	OD Outside Dia.	For Screw Size
4678	.120	.375	4
4679	.140	.375	6
4680	.171	.500	8
4681	.187	.625	10
4682	.265	.750	1/4
4683	.328	.875	5/16

INSULATORS FOR VARIOUS TO-3 CASES

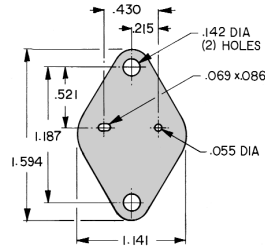

CAT. NO. 4662

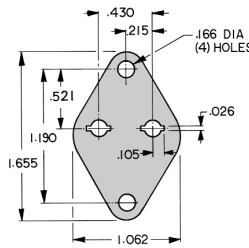

CAT. NO. 4667

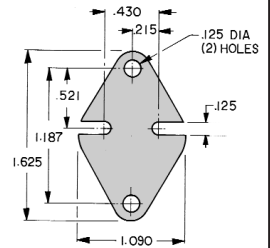

CAT. NO. 4674

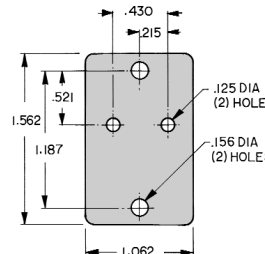

CAT. NO. 4661

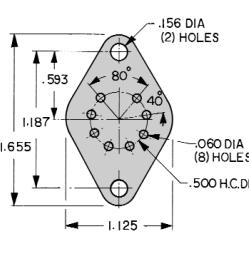

CAT. NO. 4658

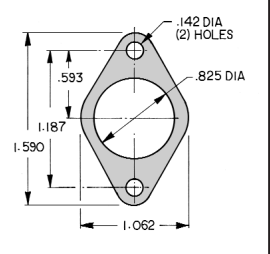

CAT. NO. 4660

INSULATORS FOR VARIOUS TO-66 CASES

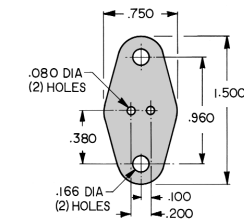

CAT. NO. 4664

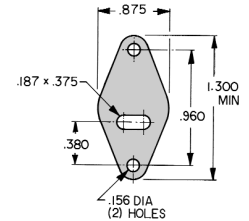

CAT. NO. 4665

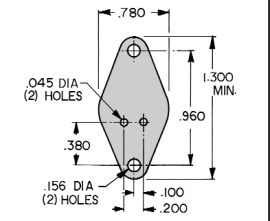

CAT. NO. 4666

PLASTIC CASE MICA INSULATORS

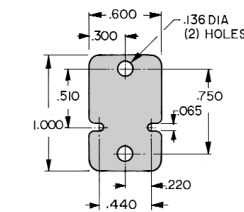

CAT. NO. 4663

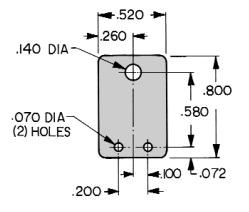

CAT. NO. 4671

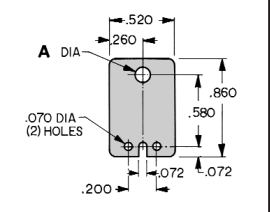

CAT. NO. 4672 .141

CAT. NO. 4673 .115

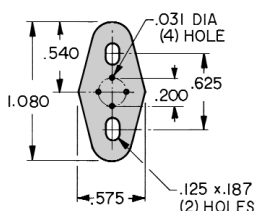

CAT. NO. 4637

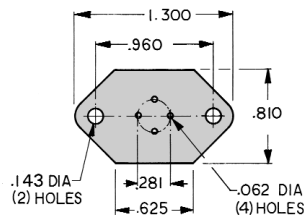

CAT. NO. 4640

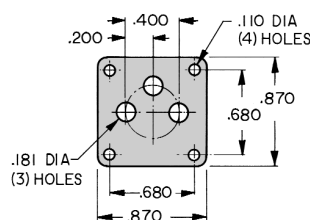

CAT. NO. 4669

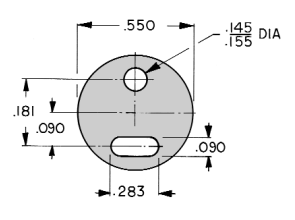

CAT. NO. 4668