

Modular Phone Plugs

154-UL6234, 154-UL6236

KOBICONN

Modular Phone Plugs

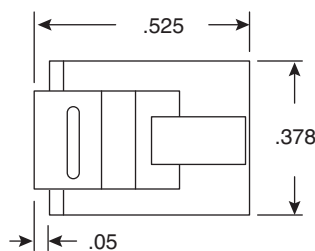
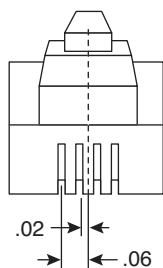
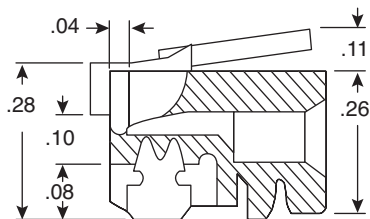
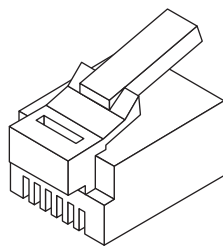

DIMENSIONS IN

SPECIFICATIONS

USOC Type:	RJ11 (154-UL6234); RJ12 (154-UL6236)
Western Electric Type:	623 (4 or 6 Conductor for telephone to wall use)
Color:	Clear
Positions-Contacts:	6-4 (154-UL6234); 6-6 (154-UL6236)
Housing Material:	Polycarbonate (pc)
Contact Blade:	High strength copper alloy
Contact:	8% phosphor alloy
Insulation Resistance:	250VAC (max.) @ 2A 500MΩ
Dielectric Withstand Voltage:	500VAC for 1 minute
Termination Resistance:	35mΩ (max.)
Tolerance:	.006
Cable-to-Plug Tensile Strength:	20 lbs. (89N) min.
Durability:	200 mating cycles
Operating Temperature:	-40°C to +125°C

Date Last Revised: 10-15-05

Available from Mouser Electronics
1-800-346-6873
www.mouser.com

KC-300630

154-UL6234, 154-UL6236