

Bullet Connectors

159-1612, 159-1615

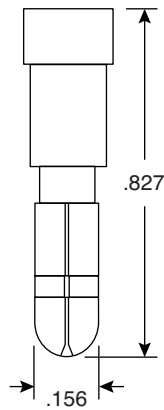

Bullet Connects

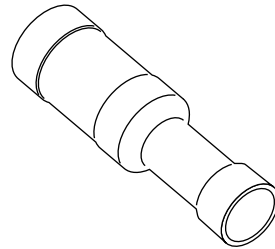
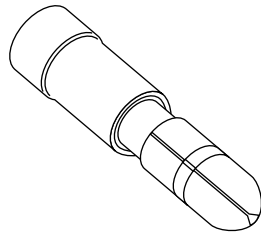

159-1615

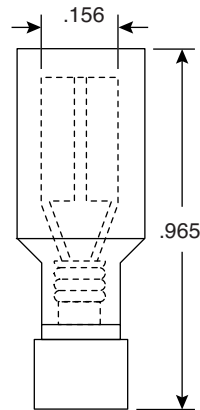

159-1612

Dimensions: In.

| SPECIFICATIONS | |
|----------------------|-------------------|
| Type: | Solderless |
| Wire range: | 16-14 AWG |
| Current rating: | 15A max. |
| Voltage rating: | 300V max. @ 75°C |
| Terminal material: | brass .016" thick |
| Insulation material: | vinyl |
| Insulation color: | blue |
| Temperature rating: | 75°C |

Date Last Revised: 6-27-05

Available from Mouser Electronics
1-800-346-6873
www.mouser.com

KC-300731

159-1612, 159-1615