

Bullet Connectors

159-1612, 159-1615

KOBI CONN

Bullet Connects

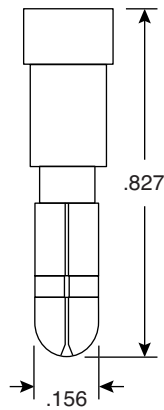
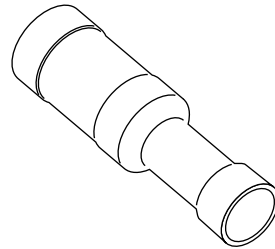
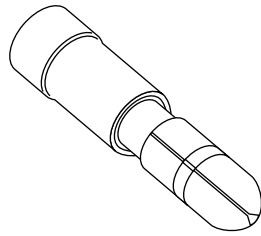

159-1615

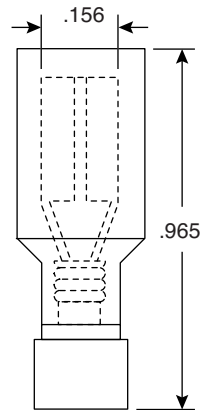

159-1612

Dimensions: In.

SPECIFICATIONS	
Type:	Solderless
Wire range:	16-14 AWG
Current rating:	15A max.
Voltage rating:	300V max. @ 75°C
Terminal material:	brass .016" thick
Insulation material:	vinyl
Insulation color:	blue
Temperature rating:	75°C

Date Last Revised: 6-27-05

Available from Mouser Electronics
1-800-346-6873
www.mouser.com

KC-300731

159-1612, 159-1615