

# 1/4" In-Line Phone Jacks

161-1203-EX, 161-1303-EX

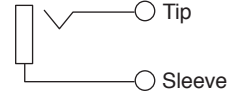

1/4" In-Line Phone Jacks

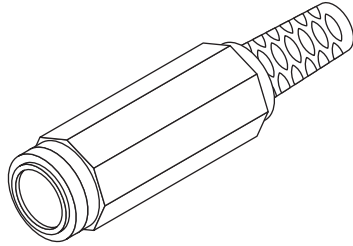

161-1203-EX  
Mono Jack

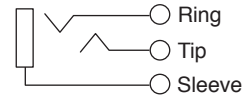
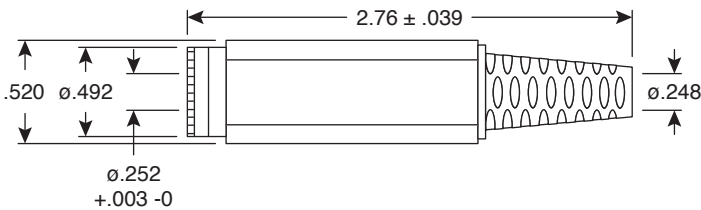

161-1303-EX  
Stereo Jack

**Dimensions: mm (In.)**  
(except where noted)

SPECIFICATIONS	
Type:	1/4" inline phone w/strain relief
Contact resistance :	50mΩ max.
Insulation resistance:	100MΩ min. @ 500VDC
Breakdown voltage:	500VAC for one minute
Insertion force:	1.5Kg~4Kg
Extraction force:	1Kg~2.5Kg
Life cycles:	3,000 cycles
Acceptable cable size:	ø6.0mm
Tip contact:	nickel plated phosphor bronze
Ring contact:	gold plated phosphor bronze
Sleeve contact:	nickel plated steel
Contact spring:	nickel plated piano wire
Body:	polyphenyleneoxide
Cap:	ABS resin
Strain relief:	PVC resin
Color:	black
RoHS Compliant by Exemption	

Date Last Revised: 12-9-05

Available from Mouser Electronics  
1-800-346-6873  
www.mouser.com

KC- 300843

161-1203-EX, 161-1303-EX