

Mini-Din Receptacles

161-2103, 161-2104

KOBICONN

Mini-Din Receptacles

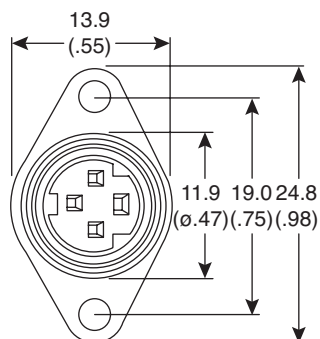
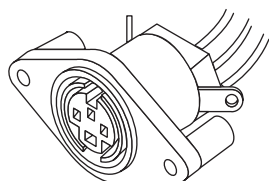

Dimensions: mm (In.)

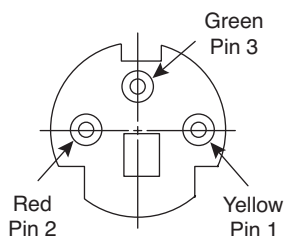
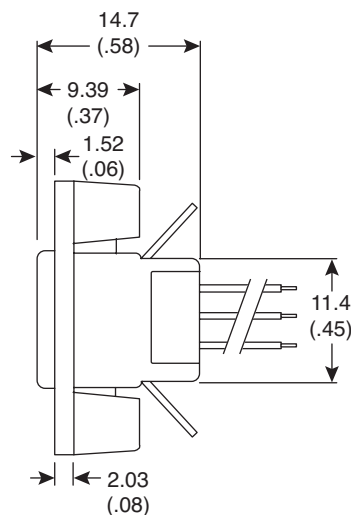

161-2103
3 Pin

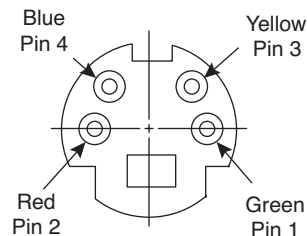

161-2104
4 Pin

SPECIFICATIONS

Type:	panel mount Mini-Din jacks w/leads
Rating:	100VAC 1A max., 12VDC 2A max.
Insulation resistance:	50mΩ min. @ 250VDC
Dielectric strength:	250VAC for 1 minute
Contact resistance:	30MΩ max.
Insertion force:	4.5Kg max.
Withdrawal force:	.9Kg ~ 3Kg
Dimension tolerance:	±.1mm (.004)
Mounting hole:	ø2.2mm (.08)
Wire gauge:	26AWG
Lead length:	200mm (7.87")
Screw size:	M2.6 x 8mm

Date Last Revised: 6-09-05

Available from Mouser Electronics
1-800-346-6873
www.mouser.com

KC-300693

161-2103, 161-2104