

D-Sub Connectors

152-5000 Series-E

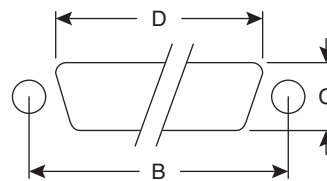

D-Sub Connectors

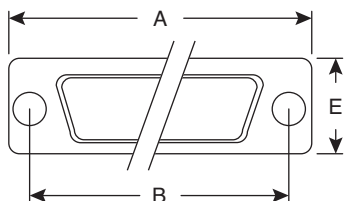
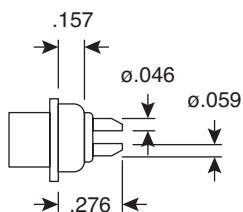
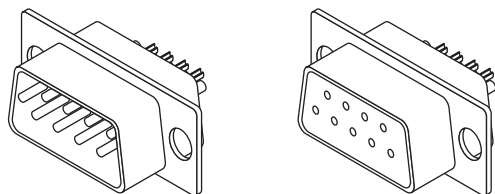

DIMENSIONS: in.

Panel Cut-Out
For Front of Panel Mounting

| Mouser Stock No. | Type | Contacts | A | B | C | D | E |
|------------------|------------|----------|------|------|------|------|------|
| 152-5109-E | Receptacle | 9 | 1.21 | .984 | .488 | .882 | .512 |
| 152-5009-E | Plug | | | | | | |
| 152-5115-E | Receptacle | 15 | 1.54 | 1.31 | .488 | 1.20 | .512 |
| 152-5015-E | Plug | | | | | | |
| 152-5125-E | Receptacle | 25 | 2.09 | 1.85 | .488 | 1.74 | .512 |
| 152-5025-E | Plug | | | | | | |
| 152-5137-E | Receptacle | 37 | 2.73 | 2.50 | .488 | 2.40 | .512 |
| 152-5037-E | Plug | | | | | | |
| 152-5150-E | Receptacle | 50 | 2.63 | 2.41 | .606 | 2.29 | .622 |
| 152-5050-E | Plug | | | | | | |

| SPECIFICATIONS | |
|------------------------|---|
| Type: | D-Sub w/solder cup terminals |
| Current rating: | 5A |
| Working voltage: | 500VAC or DC peak |
| Contact resistance: | < 5mΩ |
| Insulation resistance: | 10MΩ min. |
| Temperature range: | -55° ~ +125°C |
| Maximum wire size: | 20AWG |
| Shell: | steel with 3-5μ zinc plating over yellow chromate |
| Insulator: | 30% glass filled polyester, gray |
| Contacts: | machined gold plated over nickel copper alloy |
| RoHS Compliant | |

Date Last Revised: 01-25-08

Available from Mouser Electronics
1-800-346-6873 / www.mouser.com

KC-301229

152-5000-E Series