

IDC Flat Cable D-Sub Connectors

156-2709, 156-2715, 156-2725

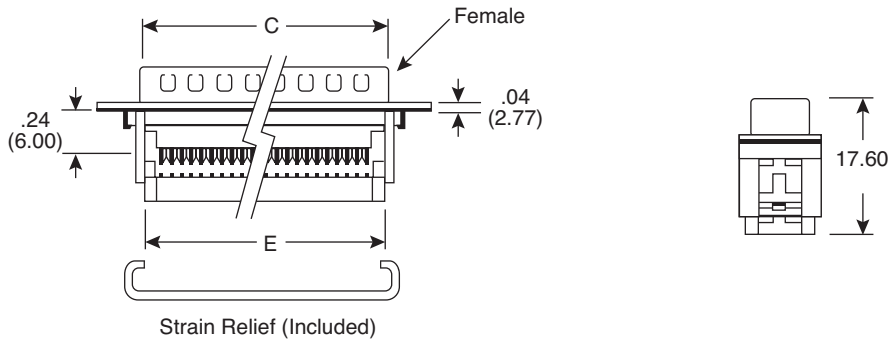

IDC Flat Cable D-Sub Connectors

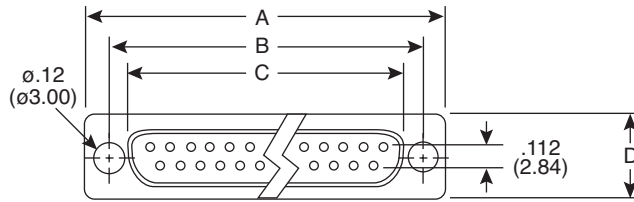
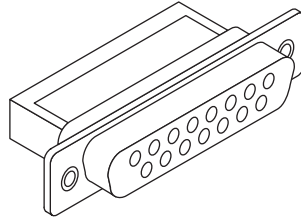

DIMENSIONS: mm (in.)

Mouser Stock No.	Pins	A	B	C	D
156-2709	9	30.81	24.88	16.33	12.50
156-2715	15	39.14	33.32	24.66	12.50
156-2725	25	53.04	47.04	38.38	12.50

SPECIFICATIONS	
Shell:	Steel Tin Plated
Insulator:	PBT & 30% Glass-fibre
Contact:	Phosphor bronze
Plating:	Selective gold plated over nickel
Current Rating:	1A (28 AWG)
Insulator Resistance:	1000M Ω Min. at 500V DC
Temperature:	-55°C ~ +105°C

Date Last Revised: 4-6-12

Available from Mouser Electronics
1-800-346-6873
www.mouser.com

KC-300962

156-2709, 156-2715, 156-2725