

# Push-Fit Control Knobs—Two Piece

## P102

Push-on version of the 10 mm collet knob series.

H 0/9 D4 W

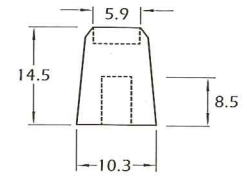
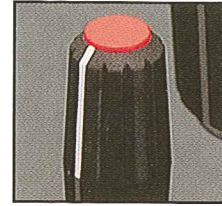

## P138

Single-color standard knob. Can be used as the top section with P139 to make a dual-concentric pair.

H 0 or 8/9 D6 or S6 N, S, or W

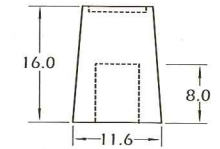
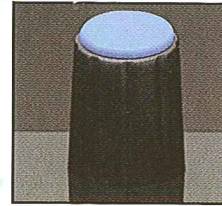

## P150

Push-on version of the 15 mm collet knob series.

H 0/9 D025 N, S, or W

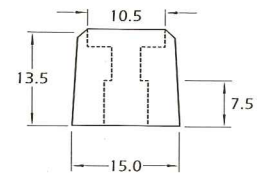
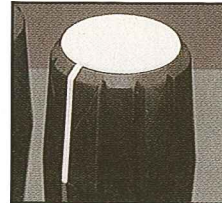

## P859

15 mm low-cost control knob.

H 0/NA D4, D6 or S6 N/A

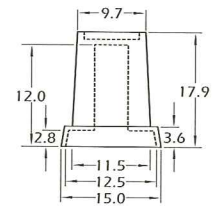
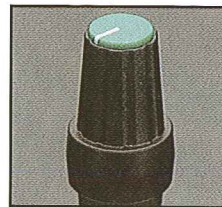

## P860

29 mm low-cost control knob.

H 0/NA D6 or D025 N/A

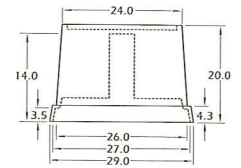
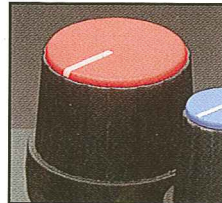

## P861

19 mm low-cost control knob.

H 0/NA D6, D025 or S6 N/A

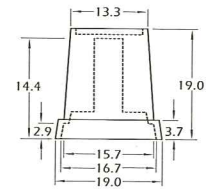
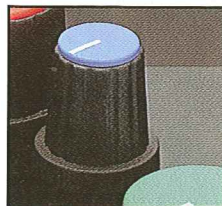

## P862

19 mm control knob with screw fixing.

H 0/NA R025, R6 or R4 (Screw fit) N/A

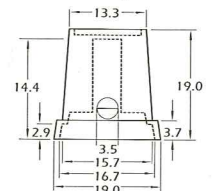
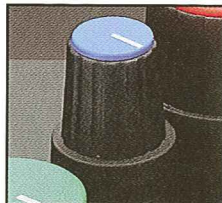

## P890

Low-profile 19 mm low-cost control knob.

H 0/NA D6 or S6 N/A

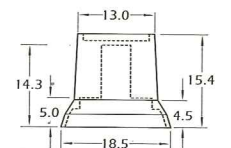

Ordering information for caps is on page 7.