

REV.	EGN NO.	DATE	SIGN	DESCRIPTION
D	LEN-080256	2010/08/20	Zhang Xing	Change Dimension.
E	LE31130099	2011/03/03	Jiang Jun Hua	Change Connector Material
F	LE31190026	2011/06/23	Tao-Cheng	Change Connector Material

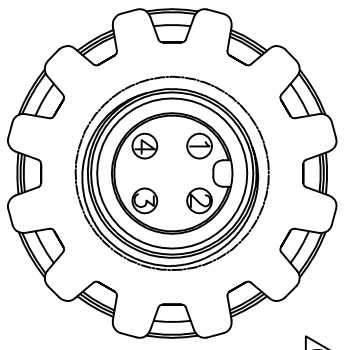
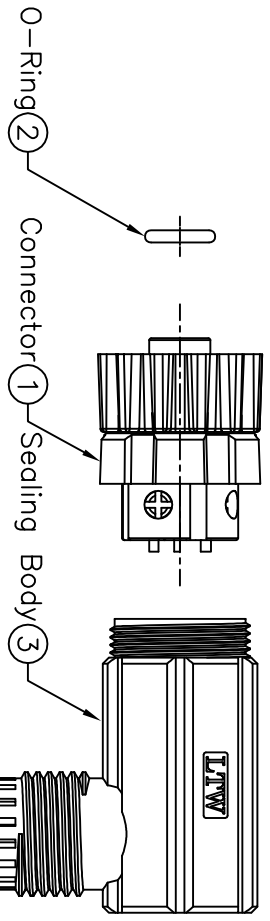
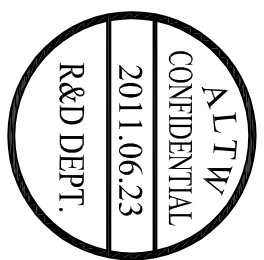
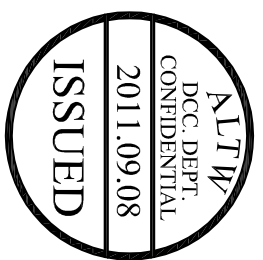
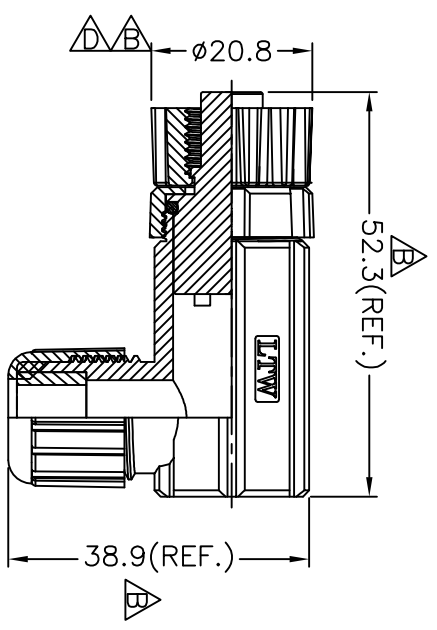
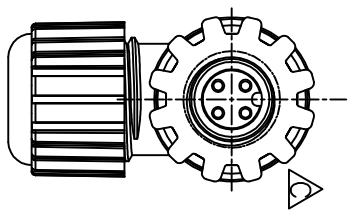

Pin Assignments
Front View

Note:
 * @Important Dimensions.
 * Waterproof Rate: IP67
 * Connector: M-PPE 540Z, Black
 * Pin: Copper Alloy, Gold Plated
 * O-Ring 1: Viton, Green
 * O-Ring 2: EPDM, Black
 * Holder: Nylon+GF, Black
 * Clamp Ring: Nylon 66, Black
 * Gasket: EPDM, Black
 * Sealing Nut: Nylon 66, Black
 * Nut: Nylon 66, Black
 * Seals For Cable OD $\phi 4.5\text{mm} \sim \phi 6.0\text{mm}$
 * Temperature Range: $-40^{\circ}\text{C} \sim +85^{\circ}\text{C}$.

UNIT:mm		TITLE		ITEM NO		DRAWN BY		DATE	
M12 Screw In Female Conn		4Pin A Code		12P-04BFFB-SR7001		Tao-Cheng		2011/06/23	
TOLERANCE		SCALE		DWG NO		CHECKED BY		DATE	
.X XX XXX ANGLES		Free		12P-04BFFB-SR7001		Micky		2011/06/23	
±0.25 ±0.1 ±0.05 ±1°		SIZE		CUSTOMER		APPROVED BY		DATE	
		A4		ALTW		Victor		2011/06/23	
		SHEET 1 OF 1							
		: Inspection Item							

Amphenol LTW
安費諾亮泰企業股份有限公司