

**DESCRIPTION: SCSI 1 FEMALE RIGHT ANGLE CONNECTOR/BACKSHELL KIT**

**A B C D**

36	DISCONTINUED			
50	3.780	2.538	1.325	.646
	96.00	64.47	33.65	16.40

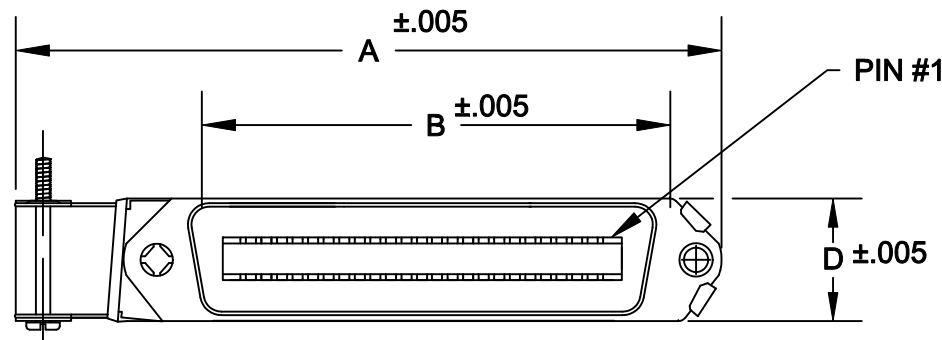
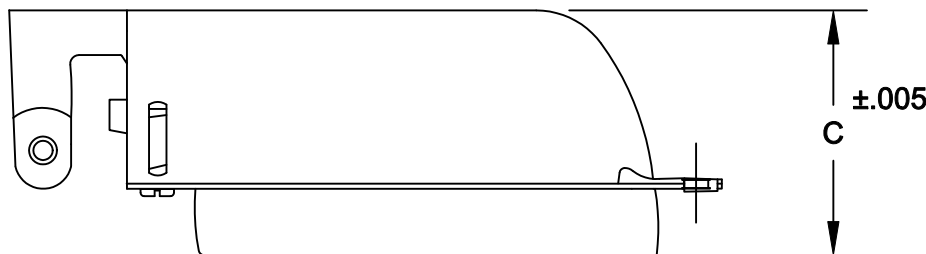

**KIT INCLUDES:  
SOLDER CUP CONNECTOR  
BACKSHELL/HARDWARE**

112-YYY-203L021

SERIES \_\_\_\_\_  
 POSITIONS \_\_\_\_\_  
 050 \_\_\_\_\_  
 GENDER \_\_\_\_\_  
 2 = FEMALE \_\_\_\_\_  
 TERMINATION \_\_\_\_\_  
 0 = SOLDER CUP \_\_\_\_\_  
 SHELL PLATING \_\_\_\_\_  
 3 = NICKEL \_\_\_\_\_  
 HARDWARE OPTIONS \_\_\_\_\_  
 02 = PIN #1 OPPOSITE CABLE ENTRY \_\_\_\_\_  
 PLATING OPTIONS \_\_\_\_\_  
 1 = GOLD FLASH \_\_\_\_\_

**MATERIALS:**

**INSULATOR: GLASS-FILLED THERMOPLASTIC  
UL RATED 94V-0**

**CONTACTS: COPPER ALLOY**

**SHELL: STEEL, NICKEL PLATED**

**CONTACT PLATING: GOLD FLASH IN THE MATING AREA  
BRIGHT TIN IN THE SOLDER AREA**

**RoHS COMPLIANT**

**ELECTRICALS:**

**CONTACT CURRENT RATING: 5 AMPS**

**DIELECTRIC WITHSTANDING VOLTAGE: AC 1200 R.M.S.**

**INSULATION RESISTANCE: 1000 mohms MINIMUM AT 500V DC**

**CONTACT RESISTANCE: 30 mOHMS MAXIMUM**

**OPERATING TEMPERATURE: -55°C TO +125°C**

**NOTE: PLEASE NOTE ORIENTATION OF CONNECTOR IN REGARDS TO  
CABLE ENTRY.**



THESE DRAWINGS AND SPECIFICATIONS ARE THE PROPERTY OF NorComp AND SHALL NOT BE REPRODUCED, COPIED OR USED AS THE BASIS FOR THE MANUFACTURE OF SALE OF APPARATUS WITHOUT WRITTEN PERMISSION.

**DRAWN:  
WAYNE ROBBINS**

**DATE:  
9-15-05**

**CHECKED:**

**DATE:**

**NorComp**

**SCALE:  
1:1**

**SHEET  
1 OF  
1**

**REV  
3**

**DWG NO. 112-YYY-203L021**