

THIS COPY IS PROVIDED ON A RESTRICTED BASIS AND IS NOT TO BE USED IN ANY WAY DETRIMENTAL TO THE INTERESTS OF PANDUIT CORP.

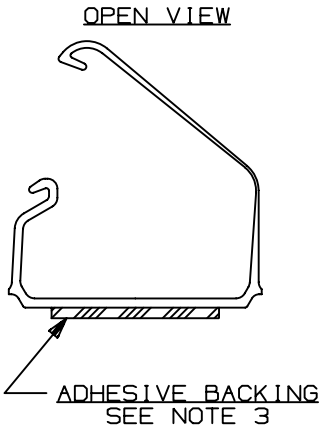

△K

△M

PART NAME	PANDUIT PART NUMBER (SEE NOTE 1)	LENGTH in. (mm.)	STATIC LOAD (SEE NOTE 2)	APPROX. WEIGHT
LATCHING DUCT	LD10**6-A	72.0±.09 (1829±2.3)	.61 lbs/in (10.9 g/mm)	.122 lbs/ft (.182 g/mm)
	LD10**8-A	96.0±.09 (2438±2.3)	.61 lbs/in (10.9 g/mm)	.122 lbs/ft (.182 g/mm)
	LD10**10-A	120.0±.09 (3048±2.3)	.61 lbs/in (10.9 g/mm)	.122 lbs/ft (.182 g/mm)
	LD10**2-A	78.74±.09 (2000.0±2.3)	.61 lbs/in (10.9 g/mm)	.122 lbs/ft (.182 g/mm)
	LD10**3-A	118.11±.09 (3000.0±2.3)	.61 lbs/in (10.9 g/mm)	.122 lbs/ft (.182 g/mm)

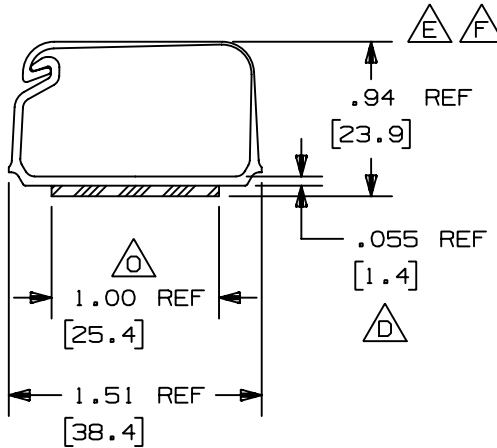

NOTES:

1. SEE CURRENT CATALOG FOR ADDITIONAL PART NUMBER SUFFIXES TO INDICATE COLOR AND OR PACKAGED QUANTITY.
2. PART IS DESIGNED TO SUPPORT MAXIMUM WEIGHT ON A CLEAN, DRY, SMOOTH SURFACE. THE SURFACE MUST BE PROPERLY PREPARED IN ACCORDANCE WITH PANDUIT RECOMMENDATIONS.
3. PRESSURE SENSITIVE FOAM .040 (1.0) THICK WITH PROTECTIVE LINER.
4. TO APPLY PART:
 - a. REMOVE PROTECTIVE LINER.
 - b. PLACE PART IN DESIRED LOCATION.
 - c. APPLY PRESSURE TO FLAT SURFACE OF PART.
5. DIMENSIONS IN PARENTHESES ARE METRIC.
6. NO WARRANTY, EXPRESSED OR IMPLIED, IS MADE BY PANDUIT WITH RESPECT TO ADHESIVE BOND PERFORMANCE, AMONG OTHER THINGS, THE CONDITIONS UNDER WHICH THESE MOUNTS MAY BE APPLIED AND/OR THE SURFACE TO WHICH THEY MAY BE APPLIED ARE BEYOND PANDUIT'S CONTROL.

△

CAD FILENAME/LAYERS D17832BA_DC_LD10_02A.PRT

11	06-12-03	JHEP	RMHI	O. REVISED TAPE WIDTH; 1.00 WAS 1.25	17832	RGRO	RGRO		
10	11-19-98	DW	HIW	N. REVISED NOTE 2 M. ADDED LD10**2-A AND LD10**3-A TO CHART	17832	HIW	HIW		
9	02-13-98	PM	HIW	L. FILE NAME WAS WPXD-LATCHING-DUCT_02.PRT K. REVISED CHART AND NOTES	17832	HIW	HIW		
-	-----	---	---	J. ADDED PARTS LD10**8-A AND LD10**10-A	-----	---	---		
8	07-30-97	RACB	HIW	I. REVISED NOTES H. REVISED REVISION SYMBOLS	17832	HIW	HIW		
-	-----	---	---	G. DELETED NON-STANDARD NOTE 4	-----	---			
-	-----	---	---	F. OMIT LATCHING CLIP LC10-A FROM DWG REFER TO 34348-2 FOR LATCH CLIP DWG	-----	---			
7	06-10-92	DW	CEF	E. REVISED NOTE 1 AND OMIT COLOR FROM DWG D. ADDED THICKNESS DIMENSION .055	17832	7			
REV	DATE	BY	CHK	DESCRIPTION	ECN	R	CUST	SUP	

PANDUIT		CORP. TINLEY PARK, ILLINOIS	
LATCHING DUCT (LD10)			
CUSTOMER DRAWING			
UNLESS OTHERWISE SPECIFIED, DIMENSIONAL TOLERANCES ARE: (.X) ± (.XXX) ± (.XX) ± ANGLES ±		UNLESS OTHERWISE SPECIFIED, ALL DIMENSIONS ARE GIVEN IN INCHES, THIRD ANGLE PROJECTION.	
DRAWN BY GDN	MAT'L: RIGID PVC (POLYVINYL CHLORIDE)	SCALE FULL	
DATE 11-19-82		DRAWING NO. SS-17832	DWG A
CHK'D HVP			SIZE