

THIS COPY IS PROVIDED ON A RESTRICTED BASIS AND IS NOT TO BE USED IN ANY WAY DETRIMENTAL TO THE INTERESTS OF PANDUIT CORP.

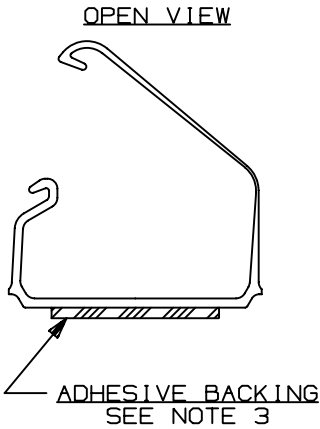

△K

△M

PART NAME	PANDUIT PART NUMBER (SEE NOTE 1)	LENGTH in. (mm.)	STATIC LOAD (SEE NOTE 2)	APPROX. WEIGHT
LATCHING DUCT	LD10**6-A	72.0±.09 (1829±2.3)	.61 lbs/in (10.9 g/mm)	.122 lbs/ft (.182 g/mm)
	LD10**8-A	96.0±.09 (2438±2.3)	.61 lbs/in (10.9 g/mm)	.122 lbs/ft (.182 g/mm)
	LD10**10-A	120.0±.09 (3048±2.3)	.61 lbs/in (10.9 g/mm)	.122 lbs/ft (.182 g/mm)
	LD10**2-A	78.74±.09 (2000.0±2.3)	.61 lbs/in (10.9 g/mm)	.122 lbs/ft (.182 g/mm)
	LD10**3-A	118.11±.09 (3000.0±2.3)	.61 lbs/in (10.9 g/mm)	.122 lbs/ft (.182 g/mm)

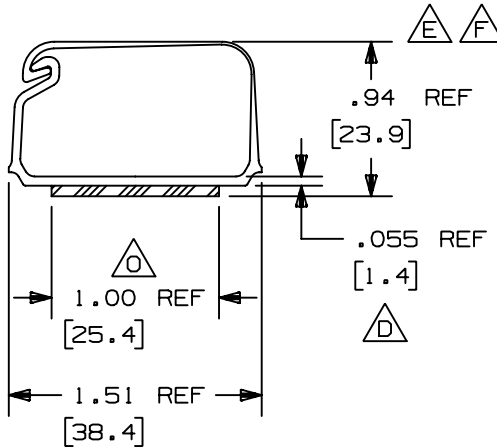

NOTES:

- SEE CURRENT CATALOG FOR ADDITIONAL PART NUMBER SUFFIXES TO INDICATE COLOR AND OR PACKAGED QUANTITY.
- PART IS DESIGNED TO SUPPORT MAXIMUM WEIGHT ON A CLEAN, DRY, SMOOTH SURFACE. THE SURFACE MUST BE PROPERLY PREPARED IN ACCORDANCE WITH PANDUIT RECOMMENDATIONS.
- PRESSURE SENSITIVE FOAM .040 (1.0) THICK WITH PROTECTIVE LINER.
- TO APPLY PART:
  - REMOVE PROTECTIVE LINER.
  - PLACE PART IN DESIRED LOCATION.
  - APPLY PRESSURE TO FLAT SURFACE OF PART.
- DIMENSIONS IN PARENTHESES ARE METRIC.
- NO WARRANTY, EXPRESSED OR IMPLIED, IS MADE BY PANDUIT WITH RESPECT TO ADHESIVE BOND PERFORMANCE, AMONG OTHER THINGS, THE CONDITIONS UNDER WHICH THESE MOUNTS MAY BE APPLIED AND/OR THE SURFACE TO WHICH THEY MAY BE APPLIED ARE BEYOND PANDUIT'S CONTROL.

△

CAD FILENAME/LAYERS D17832BA\_DC\_LD10\_02A.PRT

11	06-12-03	JHEP	RMHI	O. REVISED TAPE WIDTH; 1.00 WAS 1.25	17832	RGRO	RGRO		
10	11-19-98	DW	HIW	N. REVISED NOTE 2 M. ADDED LD10**2-A AND LD10**3-A TO CHART	17832	HIW	HIW		
9	02-13-98	PM	HIW	L. FILE NAME WAS WPXD-LATCHING-DUCT_02.PRT K. REVISED CHART AND NOTES	17832	HIW	HIW		
-	-----	---	---	J. ADDED PARTS LD10**8-A AND LD10**10-A	-----	---	---		
8	07-30-97	RACB	HIW	I. REVISED NOTES H. REVISED REVISION SYMBOLS	17832	HIW	HIW		
-	-----	---	---	G. DELETED NON-STANDARD NOTE 4	-----	---	---		
-	-----	---	---	F. OMIT LATCHING CLIP LC10-A FROM DWG REFER TO 34348-2 FOR LATCH CLIP DWG	-----	---	---		
7	06-10-92	DW	CEF	E. REVISED NOTE 1 AND OMIT COLOR FROM DWG D. ADDED THICKNESS DIMENSION .055	17832	7			
REV	DATE	BY	CHK	DESCRIPTION	ECN	R	CUST	SUP	

PANDUIT

CORP. TINLEY PARK, ILLINOIS

LATCHING DUCT (LD10)

CUSTOMER DRAWING

UNLESS OTHERWISE SPECIFIED,  
DIMENSIONAL TOLERANCES ARE:  
(.X) ± (.XXX) ±  
(.XX) ± ANGLES ±

UNLESS OTHERWISE SPECIFIED,  
ALL DIMENSIONS ARE GIVEN  
IN INCHES, THIRD ANGLE PROJECTION.

DRAWN BY: GDN  
DATE: 11-19-82  
CHK'D: HVP

MAT'L: RIGID PVC (POLYVINYL CHLORIDE)

SCALE: FULL

DRAWING NO.: SS-17832  
DWG SIZE: A