

THIS COPY IS PROVIDED ON A RESTRICTED BASIS AND IS NOT TO BE USED IN ANY WAY DETRIMENTAL TO THE INTERESTS OF PANDUIT CORP.

PANDUIT P/N	WEIGHT
CSC**-X	.02 LB/10 PCS (89 G/10 PCS)

NOTES:

1. SEE CURRENT CATALOG FOR ADDITIONAL PART NUMBER SUFFIXES TO INDICATE COLOR AND OR PACKAGE QUANTITY.
2. SCREW COVER HAS A TEXTURED SURFACE AND BLENDS IN WITH THE FACEPLATES FOR IMPROVED AESTHETICS. FOR OUTLET IDENTIFICATION, ADHESIVE LABELS CAN BE APPLIED TO THE INSIDE OF THE SCREW COVER.
3. CAN BE USED WITH SELECT PANDUIT FACEPLATES.
4. DIMENSIONS IN PARENTHESIS ARE IN METRIC.

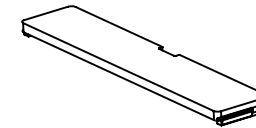
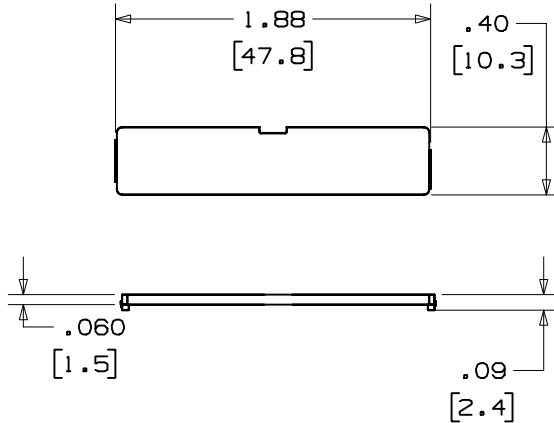

CAD FILENAME/LAYERS D35544BX_CSC_C_00B.PRT

PANDUIT CORP. TINLEY PARK, ILLINOIS

FACEPLATE AND SURFACE
BOX SCREW COVER (CSC**-X)
CUSTOMER DRAWING

UNLESS OTHERWISE SPECIFIED,
DIMENSIONAL TOLERANCES ARE:
(.X) ± (.XXX) ± .010 (.3)
(.XX) ± .03 (.8) ANGLES ±

UNLESS OTHERWISE SPECIFIED,
ALL DIMENSIONS ARE GIVEN
IN INCHES, THIRD ANGLE PROJECTION.

REV	DATE	BY	CHK	DESCRIPTION	ECN	CHK	CUST	SUP
1	11-12-99	JSP		A. REVISED NOTE 3.	35544-22			
R	10-21-96	JBA	CEF	RELEASED TO PRODUCTION.	35544-22	CEF		

DRAWN BY JBA	MAT'L: ABS	SCALE NONE
DATE 10-21-96		DRAWING NO. 35544-22
CHECKED BY CEF		DWG A SIZE