

THIS COPY IS PROVIDED ON A RESTRICTED BASIS AND IS NOT TO BE USED IN ANY WAY DETRIMENTAL TO THE INTERESTS OF PANDUIT CORP.

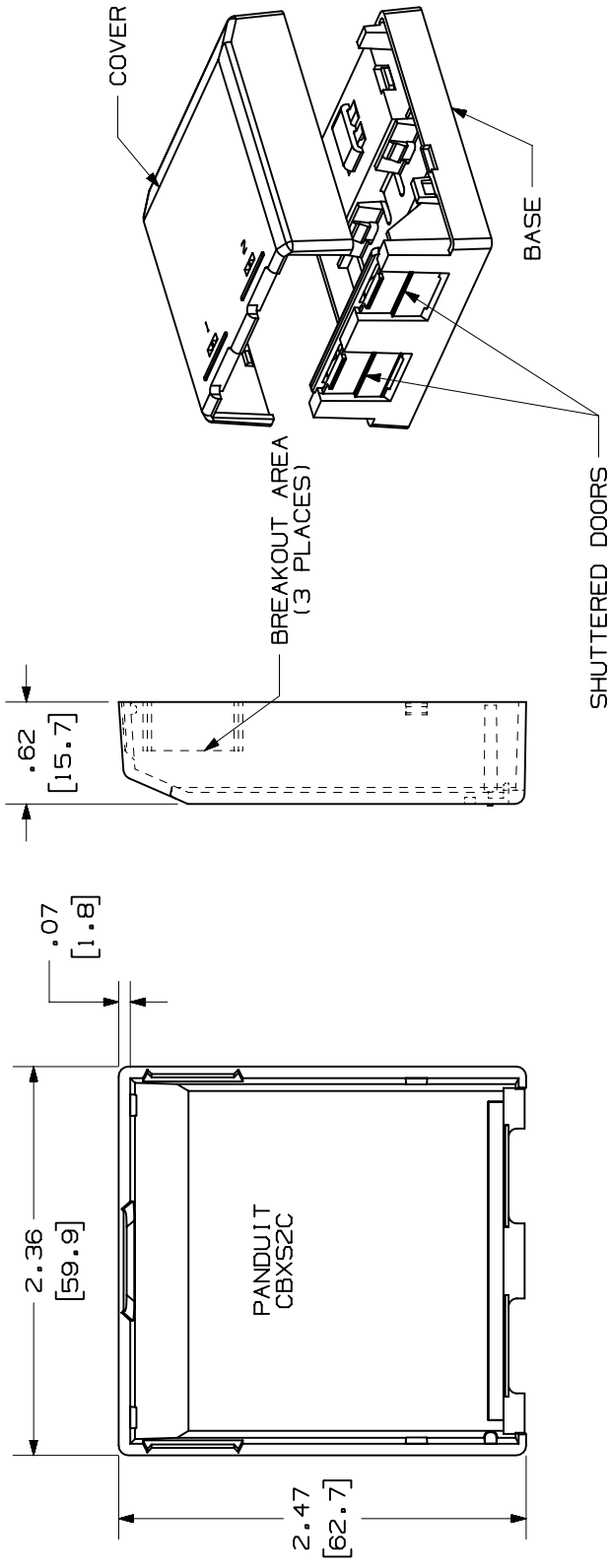

CAD FILENAME/LAYERS

M00800AA_DC_05A.PRT

PANDUIT

CORP. TINLEY PARK, ILLINOIS

MINI-COM 2 POSITION
SHUTTERED BOX (CBXS2C**)
CUSTOMER DRAWING

UNLESS OTHERWISE SPECIFIED,
DIMENSIONAL TOLERANCES ARE:
(.X) ± .03 (.8) ANGLES ±
(.XX) ± .010 (.3)
(.XXX) ± .010 (.3)
IN INCHES, THIRD ANGLE PROJECTION.

DRAWN BY JSP
DATE 12-5-00
CHECKED BY

MAT'L: ABS

SCALE NONE

REV	DATE	BY	CHK	DESCRIPTION	ECN	CHK	CUST	SUP
R	12-5-00	JSP		SEE SHEET 1 OF 2	00800-14			
DRAWING NO. 00800-14					DWG			
SHEET 2 OF 2					A			
					SIZE			

THIS COPY IS PROVIDED ON A RESTRICTED BASIS AND IS NOT TO BE USED IN ANY WAY DETRIMENTAL TO THE INTERESTS OF PANDUIT CORP.

PANDUIT P/N	WEIGHT
CBXS2**-A	.53 LB/10 PCS (242.5 g/10 PCS)

- NOTES:**
- SEE CURRENT CATALOG FOR ADDITIONAL PART NUMBER SUFFIXES TO INDICATE COLOR AND OR PACKAGE QUANTITY.
 - SEE CATALOG FOR A COMPLETE LIST OF PARTS APPLICABLE FOR USE WITH THIS PART.
 - DIMENSIONS IN PARENTHESES ARE IN METRIC.
 - ALSO INCLUDED WITH BOX:
 - (2) PLTIM-M PAN-TY
 - (1) STRIP OF 1.00" X .75" FOAM TAPE FOR MOUNTING
 - BASE HAS 1 POCKET FOR OPTIONAL MAGNET (CSBM-X)
 - BREAKOUTS DESIGNED TO ACCEPT LD5/LDPS RACEWAY. (DOES NOT ENTER BOX.)

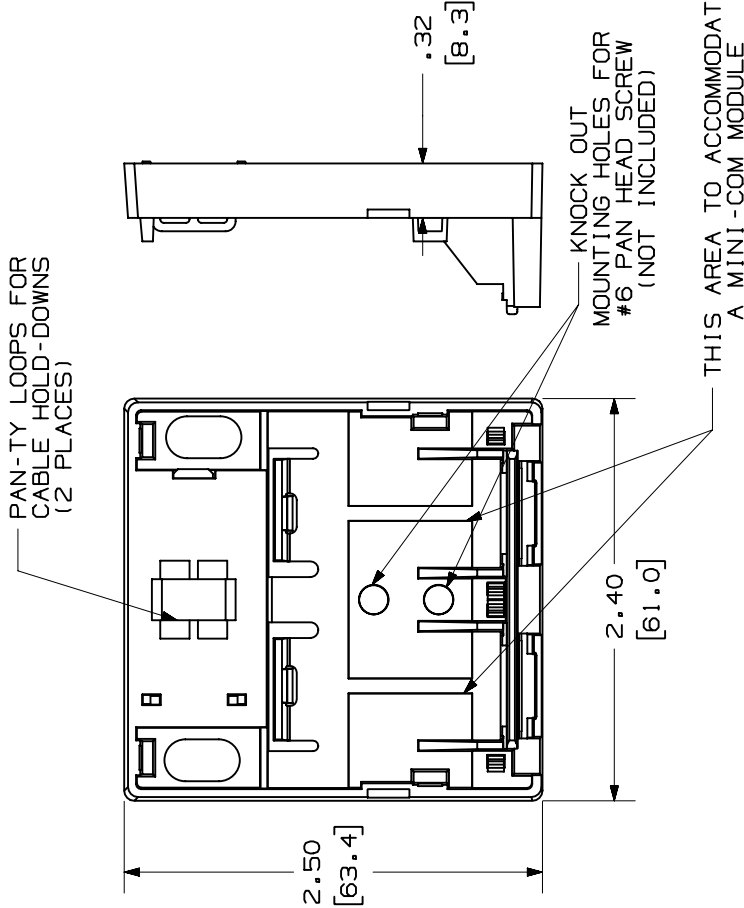

CAD FILENAME/LAYERS

M00800AA_DC_05A.PRT

PANDUIT

CORP. TINLEY PARK, ILLINOIS

MINI-COM 2 POSITION
SHUTTERED BOX (CBXS2**-A)

CUSTOMER DRAWING

UNLESS OTHERWISE SPECIFIED,
DIMENSIONAL TOLERANCES ARE:
(.X) ± .010 (.3)
(.XX) ± .03 (.8) ANGLES ±

UNLESS OTHERWISE SPECIFIED,
ALL DIMENSIONS ARE GIVEN
IN INCHES, THIRD ANGLE PROJECTION.

DRAWN BY: JSP
DATE: 12-5-00
CHECKED BY:

MAT'L:

SCALE: NONE

BOX: ABS
DOORS: HIPS

DWG NO. 00800-14
SHEET 1 OF 2
Dwg SIZE A

REV	DATE	BY	CHK	ECN	CHK	CUST	SUP	DESCRIPTION
R	12-5-00	JSP		00800-14				RELEASED TO PRODUCTION.