

SERIES	PAGE	SERIES	PAGE
LT1 	F01	SPL-10 	F13
LT2 	F02	ELTSM-4, ELTSK-5 SMT (4.5 x 4.5, 5.2 x 5.2)	F14
LT4 	F03	ELTS*W-6 Washable (6.2 x 6.3)	F15
LT5 	F04	ELTS(G)L, F-6 Thinner (6.2 x 6.3)	F16
DTR Regular, SMT	F05	ELTS(*)-6 6.2 x 6.2	F17
WTS Water-proof (10 x 10)	F06	ELTS(*)-2 12 x 12	F17
WTM Washable (10 x 10)	F07	ELTSX-6 SMT (6.2 x 6.2)	F19
WTML Illuminated (10 x 10)	F08	ELTSMC-6 SPDT (6.2 x 6.4)	F19
SPL6 	F09	ELTS(*)3 Regular, SMT (3.5 x 6.0, 7 x 2.5)	F20

SPECIFICATIONS

CONTACT RATING: 100mA max, 42 VAC/DC
 MECHANICAL LIFE: 1,000,000 cycles
 CONTACT RESISTANCE: 100mΩ max. (initial)
 INSULATION RESISTANCE: 1,000MΩ min.
 DIELECTRIC STRENGTH: 2,000VAC
 OPERATION FORCE: 3N ± 0.75N max

MATERIALS

SWITCH HOUSING: PBT/PA46 (UL94 V-0)
 TRANSPARENT ACTUATOR: PC (UL94 V-0)
 ACTUATOR: ABS
 CONTACT: Stainless, Au version tin-plated
 TERMINALS: Brass, Au version tin-plated
 TERMINAL SEAL: Epoxy



INDEX

TOGGLE

ROCKER

SLIDE

PUSH BUTTON

DIP

TACT

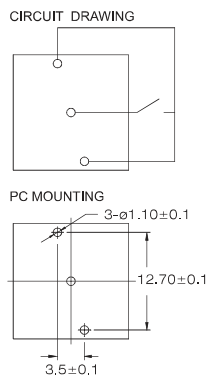
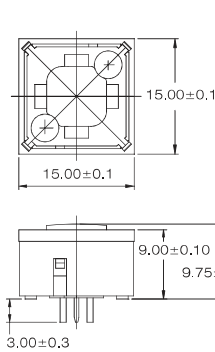
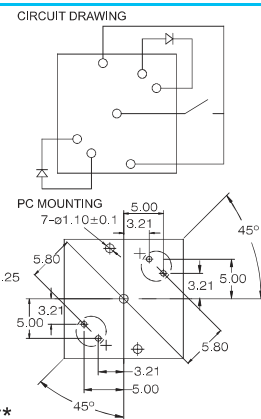
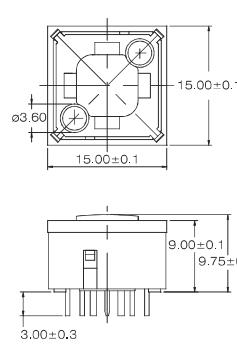
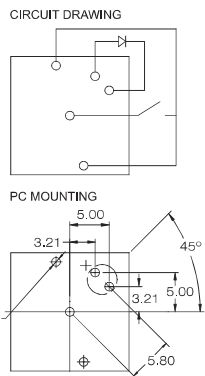
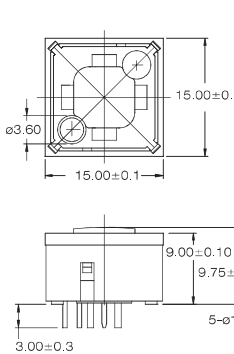
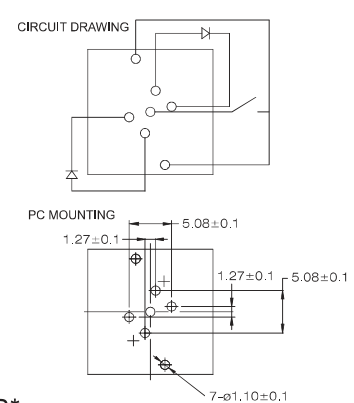
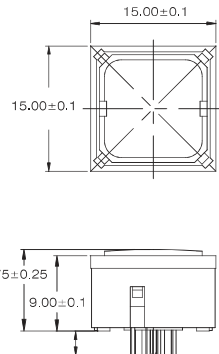
LT1-15-A0

LT1-15-A2**

LT1-15-A1*

LT1-15-B*
HOW TO ORDER

 LT1 - 19 - HT - A0 - - - -

LT1 Series
 Size:
 19: 19 x 19mm
 15: 15 x 15mm

HT material:
 = none
 HT= High temperature

Actuator:
 Transparent actuator

LED quantity:
 0 : no LED
 1 : one LED
 2 : two LED

LED Color:
 1 : white
 3 : red
 5 : yellow
 6 : green
 7 : blue

Another LED Color:
 1 : white
 3 : red
 5 : yellow
 6 : green
 7 : blue

RoHS code:
 H: RoHS Compliant

Contact material:
 : Au version tin-plated
 Q : silver plated

 LT1 - 19 - HT - B1 - - / - -

LT1 Series
 Size:
 19: 19 x 19mm
 15: 15 x 15mm

HT material:
 HT= High temperature

Actuator:
 Color panel actuator

Actuator color:
 1 : white
 3 : red
 5 : yellow
 6 : green
 7 : blue

LED quantity:
 = standard (the actuator is as same as the color of LED)
 0 : no LED
 1 : one LED
 2 : two LED (the actuator is not as same as the color of LED)

RoHS code:
 H: RoHS Compliant

Contact material:
 : Au version tin-plated
 Q : silver plated

Another LED Color:
 =standard
 1 : white 3 : red
 5 : yellow 6 : green
 7 : blue

LED color:
 =standard
 1 : white 3 : red
 5 : yellow 6 : green 7 : blue

LT2

SPECIFICATIONS

CONTACT RATING: 100mA, 42VAC / DC
MECHANICAL LIFE: 1,000,000 cycles
CONTACT RESISTANCE: 100mΩ max. (initial)
INSULATION RESISTANCE: 1,000MΩ min.
DIELECTRIC STRENGTH: 2,000VAC
OPERATION FORCE: 3N±0.75N max.

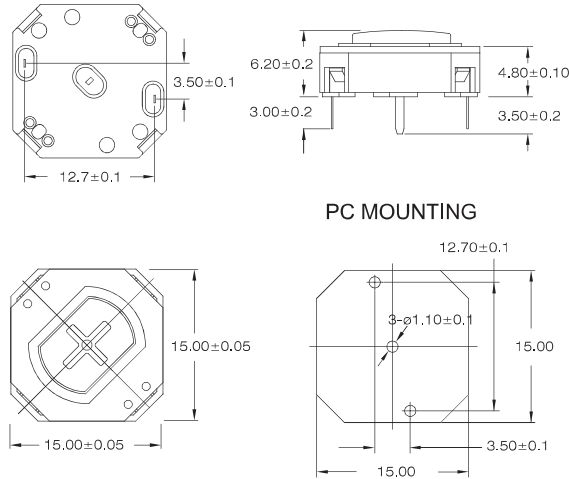
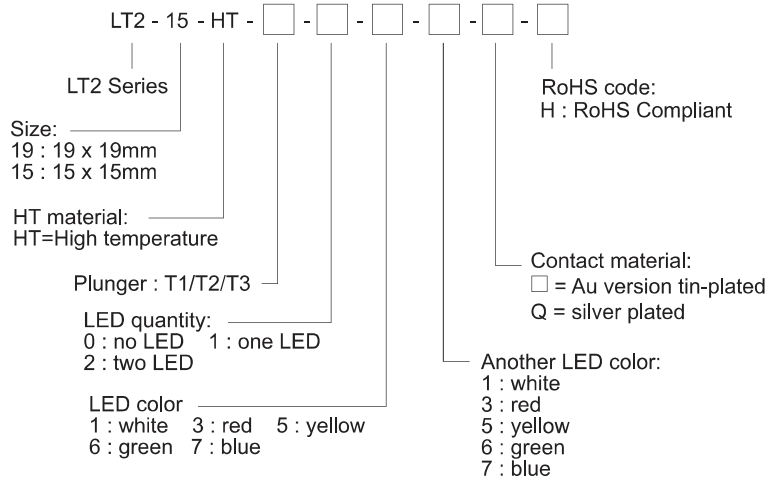
HOW TO ORDER

LT3

SPECIFICATIONS

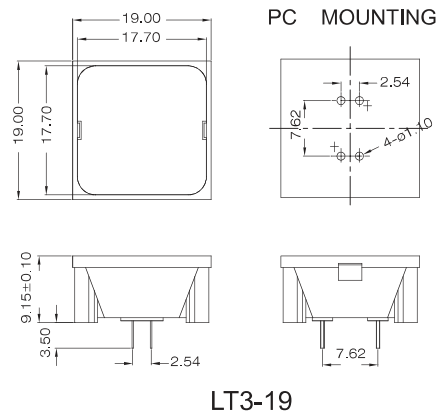
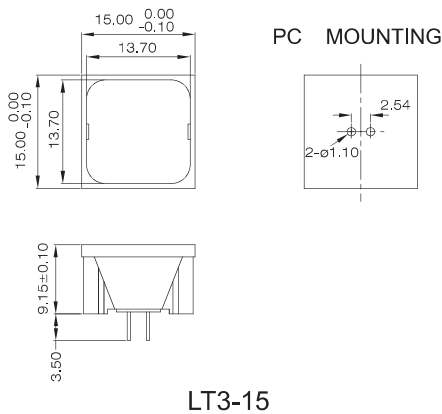
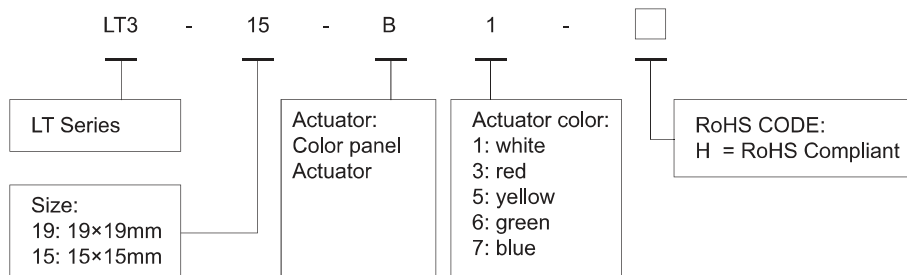
DIMENSIONS: 15 x 15 mm, 19 x 19 mm
OVERALL HEIGHT: 9.7 mm
ILLUMINATION: Fully illuminated 1 LED
WAVE SOLDERING: 240°C max.

HOW TO ORDER

LT4

SPECIFICATIONS

CONTACT RATING: 100mA, 42VAC/DC
 MECHANICAL LIFE: 1,000,000 cycles
 CONTACT RESISTANCE: 100mΩ max.(initial)
 INSULATION RESISTANCE: 1,000MΩ min.
 DIELECTRIC STRENGTH: 1,500VAC
 OPERATING TEMPERATURE: -25°C to +70°C

INDEX

TOGGLE

ROCKER

SLIDE

PUSH BUTTON

DIP

TACT

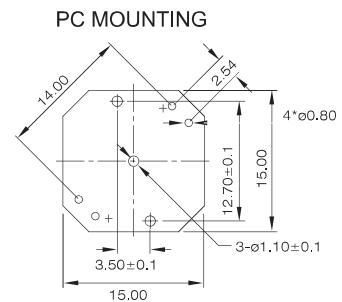
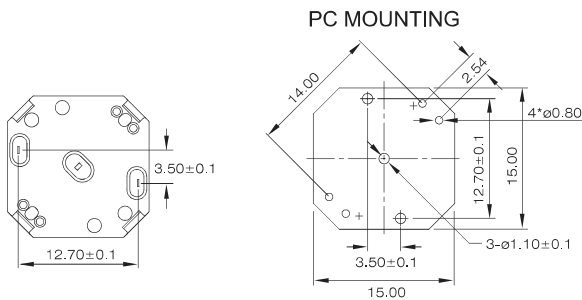
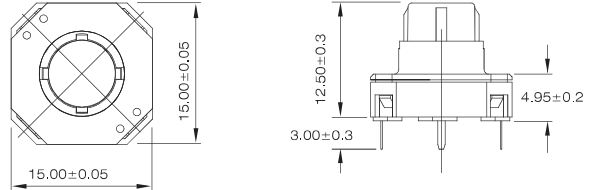
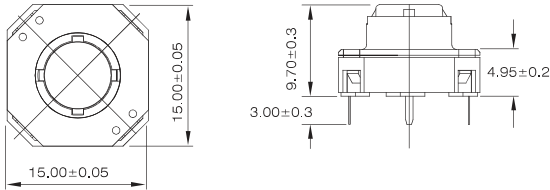
LT4-15-1
LT4-15-2
HOW TO ORDER

 LT4 - 15 - HT - - - - - -

LT Series

size:

19: 19×19mm

15: 15×15mm

HT Material:

HT = HIGH Temperature

Height:

1: 9.7 mm

2: 12.5 mm

RoHS CODE:

H =RoHS Compliant

Another LED Color:

1:white

3: red

5: yellow

6: green

7: blue

LED Color:

1:white

3: red

5: yellow

6: green

7: blue

LED quantity:

0: no LED

1: one LED

2: two LED

LED Size :

A: φ 3mm LED

B: 2mm LED

LT5

SPECIFICATIONS

CONTACT RATING: 100mA max, 42 VAC/DC
MECHANICAL LIFE: 1,000,000 cycles
CONTACT RESISTANCE: 100mΩ max. (initial)
INSULATION RESISTANCE: 1,000MΩ min.
DIELECTRIC STRENGTH: 2,000VAC
OPERATION FORCE: 3N ± 0.75N max

MATERIALS

SWITCH HOUSING: PBT/PA46 (UL94 V-0)
TRANSPARENT ACTUATOR: PC (UL94 V-0)
ACTUATOR: ABS
CONTACT: Stainless, Au version tin-plated
TERMINALS: Brass, Au version tin-plated
TERMINAL SEAL: Epoxy

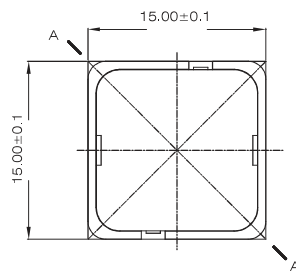
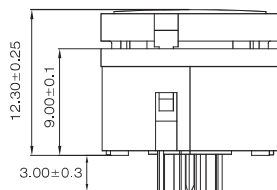
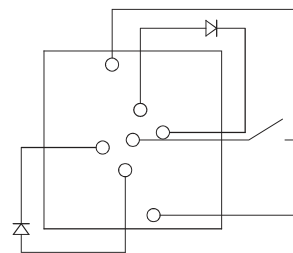
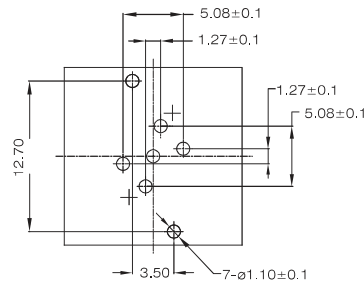
CIRCUIT DRAWING

PC MOUNTING

HOW TO ORDER

LT5 - 15 - HT - B 1 - □ - □ / □ - □ - □

LT Series

Size:
 15: 15×15mm
 19: 19×19mm

HT Material:
 = none
 HT = HIGH Temperature

Actuator:
 Color panel Actuator

Actuator color:
 1: white
 3: red
 5: yellow
 6: green
 7: blue

LED quantity:
 = standard
 (the actuator is as same as the color of LED)
 0: no LED
 1: one LED
 2: two LED
 (the actuator is not as same as the color of LED)

Another LED color:
 = standard
 1: white 3: red
 5: yellow 6: green
 7: blue
 66L: pure green high lightness

LED color:
 = standard
 1: white 3: red
 5: yellow 6: green
 7: blue
 66L: pure green high lightness

RoHS CODE:
 H = RoHS Compliant

Contact material:
 = Au version tin- plated
 Q = silver plated

DTR-8



SPECIFICATIONS

CONTACT RATING: AC/DC 42 V, 100mA
 MECHANICAL LIFE: 1,000,000 cycles
 CONTACT RESISTANCE: 100mΩ max.(initial)
 INSULATION RESISTANCE: 1,000MΩ min. 100VDC
 DIELECTRIC STRENGTH: 250VAC/1 min.
 OPERATING TEMPERATURE: -40°C to +80°C

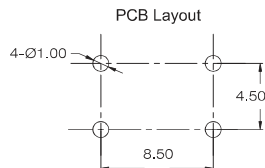
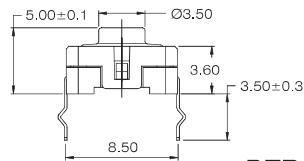
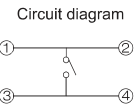
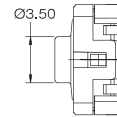
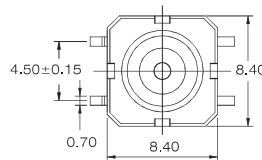
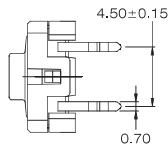
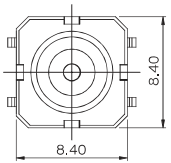

DTR-8-7-C

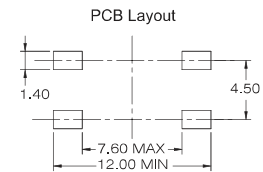
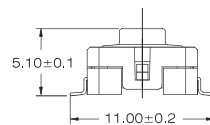

DTR-8-7-M

HOW TO ORDER

DTR - - - - - - - -
 DUSTPROOF TACT SWITCH SIZE OPERATION FORCE HEIGHT TERMINAL CAP PACKAGE RoHS code:

8 = 8.4x8.4

7: 250 gf

= 5.00mm
 = 6.60mm

C: P.C TYPE
 C1: P.C TYPE
 M: SMT TYPE

Plunger:
 = without plunger
 T1: (Total height 9.75)
 T2: (Total height 12.55)

= standard: Tube
 T/R = Tape & Reel

H = RoHS Compliant

DTR-12



SPECIFICATIONS

CONTACT RATING: AC/DC 42 V, 100mA
 MECHANICAL LIFE: 1,000,000 cycles
 CONTACT RESISTANCE: 100mΩ max.(initial)
 INSULATION RESISTANCE: 1,000MΩ min. 100VDC
 DIELECTRIC STRENGTH: 250VAC/1 min.
 OPERATING TEMPERATURE: -40°C to +80°C

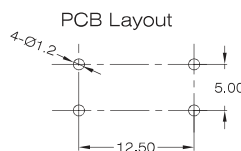
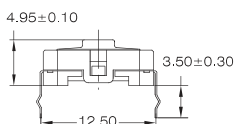
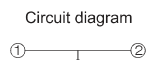
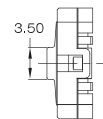
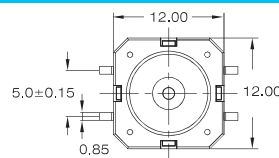
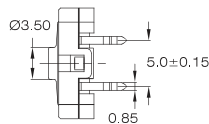
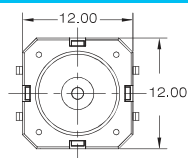

DTR-12-6-C

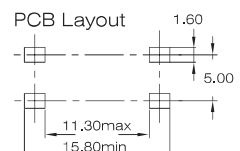
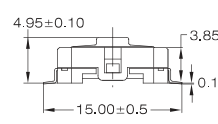

DTR-12-6-M

HOW TO ORDER

DTR - - - - - - - -
 DUSTPROOF TACT SWITCH SIZE OPERATION FORCE HEIGHT TERMINAL CAP PACKAGE RoHS code:

12=12x12

6: 360gf
 8: 680gf
 9: 970gf

= 4.95mm
 = 6.30mm

C: P.C TYPE
 C1: P.C TYPE
 M: SMT TYPE

Plunger option:
 = without plunger
 T1 = Total height 9.7
 T2 = Total height 12.5

= standard: Tube
 T/R = Tape & Reel

H: RoHS Compliant

SPECIFICATIONS

RATING: 50mA, 12VDC
ELECTRICAL LIFE: 160g, 260g : 1,000,000 cycles
 400g : 100,000 cycles
CONTACT RESISTANCE: 100mΩ max
INSULATION RESISTANCE: 100MΩ min. 500VDC
DIELECTRIC STRENGTH: 500VAC/1 min
OPERATING FORCE: 160±50g, 260±70g, 400 +100/-20g

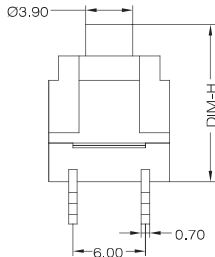
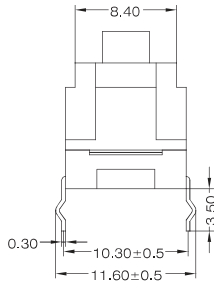
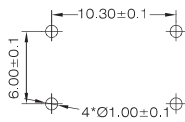
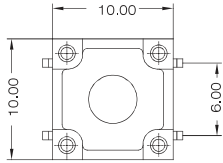
P.C.B LAYOUT

22.75mm
13mm
DIM-H

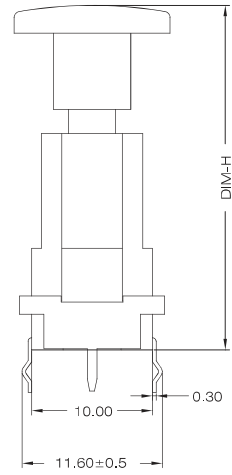
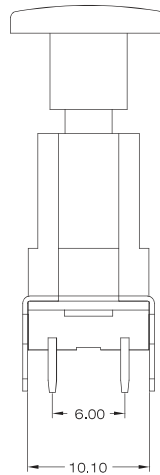
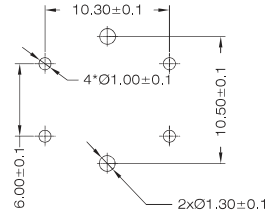
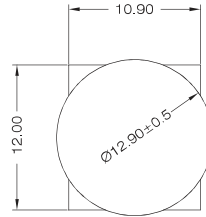
WTS-10--*-1/ WTS-10-**-*-2**
P.C.B. LAYOUT

33.7mm
28.5mm
DIM-H

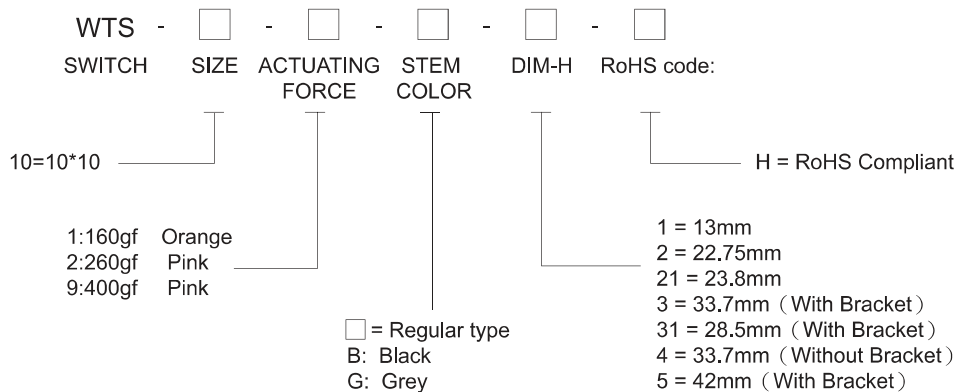
WTS-10--*-3/ WTS-10-**-*-31**
HOW TO ORDER

WTM



SPECIFICATIONS

- CONTACT RATING: 50mA, 24 VDC
- ELECTRIC LIFE: 1,000,000 cycles
- CONTACT RESISTANCE: 50mΩ max. (initial)
- INSULATION RESISTANCE: 10MΩ min. 100VDC
- DIELECTRIC STRENGTH: 250VAC/ 1 min.
- OPERATION TEMPERATURE: -40°C to +160°C



INDEX

TOGGLE

ROCKER

SLIDE

PUSH BUTTON

DIP

TACT

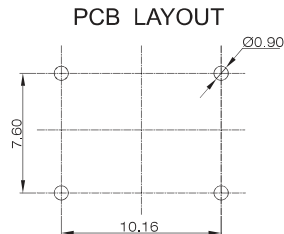
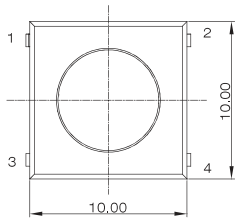
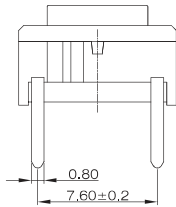
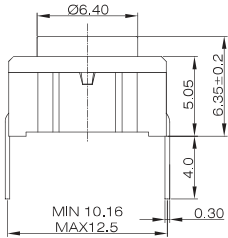

CIRCUIT

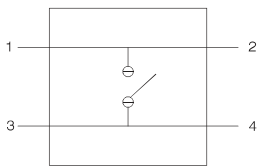

WTM-10-1-C

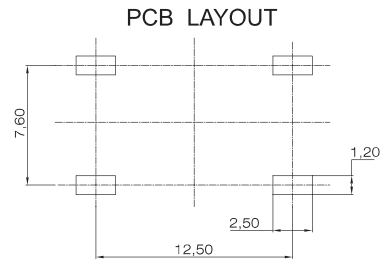
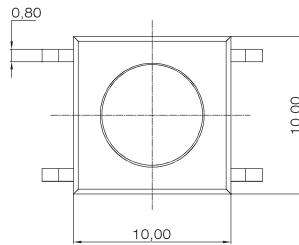
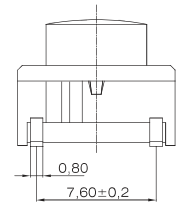
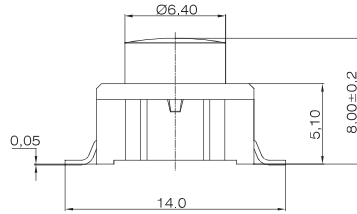

CIRCUIT

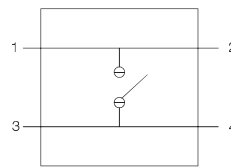

WTM-10-2-M

HOW TO ORDER

WTM - - - - - - - - - - - -

SWITCH SIZE DIM-H COLOR OF BUTTON TERMINAL OF SUPPORT CAP COLOR OF BUTTON CAP PATTERN COLOR OF SUPPORT BRACKET RoHS code PACKING

- 10 = 10*10
- 1 = 6.4mm
2 = 8.0mm
3 = 10.4mm
- = black
1 = white
3 = red
- M = SMT TYPE
C = P.C TYPE

- = gray
2 = black
3 = red
5 = yellow
6 = green
7 = blue

- = package
B = Standard :Tube
T/R = Tape & Reel
- H = RoHS Compliant
- = gray
3 = red
5 = yellow
6 = green
7 = blue

- T0 : without cap
- T1 : without hole cap
- T2 : With hole cap
- T3 : with fan-shaped cap

- = none
- B =
- G = ESC
- J =
- K =



SPECIFICATIONS

CIRCUIT: SPST
 CONTACT RATING: 50mA
 VOLTAGE RATING: 12VDC
 DIELECTRIC WITH STANDING VOLTAGE: 250 VAC for 1 minute
 CONTACT RESISTANCE: 100mΩ max. (initial)
 INSULATION RESISTANCE: 100MΩ min.
 OPERATION LIFE: 1,000,000 cycles min.
 SOLDERING SPECIFICATION: 260°C for 3 seconds

SPL6B

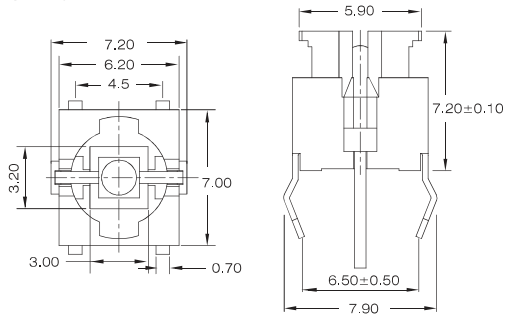

SPL6C

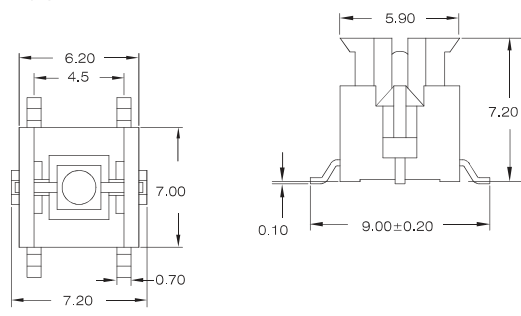

CIRCUIT DIAGRAM

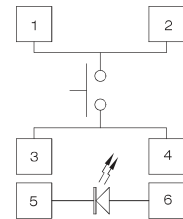

PCB LAYOUT

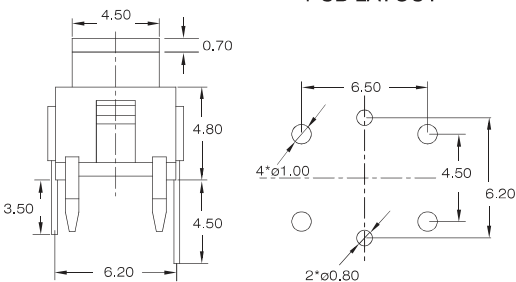

PCB LAYOUT

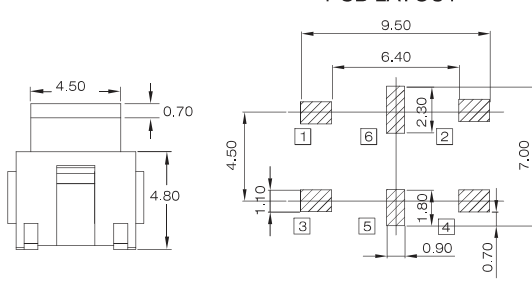

CAP OPTION

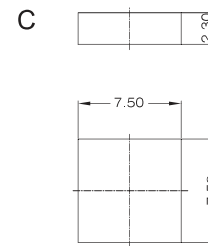
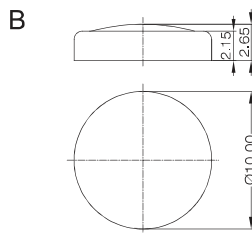
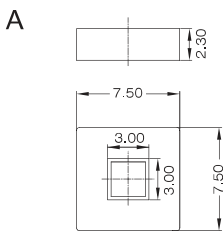

HOW TO ORDER

SPL6

SWITCH OPERATION **FORCE** **LED COLOR/ KINDS** **Frame/ Color** **CAP MODEL** **CAP COLOR** **PACKAGE STYLE** **RoHS CODE**

B = Regular Type
 B1= DIP Type (LED pitch differs from B Type)
 C = SMT Type
 C1=SMT Type (LED outward)
 C2= SMT Type (LED outward, Lead pitch 10.0, total height 7.8)

Operation Force
 1= 100gf
 2= 160gf
 12=180gf
 3= 260gf

= without led
 1 = WHITE
 3 = RED
 36=RED \ GREEN
 4 = ORANGE
 5 = YELLOW
 56=YELLOW \ GREEN
 6 = GREEN
 63=GREEN \ RED
 66=PURE GREEN
 7 = BLUE
 73=BLUE \ RED
 74 = BLUE \ ORANGE
 75=BLUE \ YELLOW

2=BLACK
 9=GREY

= Without Frame
 1 = With Frame

= NORMAL
 L= HIGHLIGHT
 N=ADD ZENER

= without cap
 A=
 B=
 C=
 D= with film

= bag
 T/R= Tape & Reel

H=RoHS Compliant

1=WHITE
 2=BLACK
 3 = RED
 5 = YELLOW
 6 = GREEN
 7 = BLUE



SPL6BL



SPECIFICATIONS

- CIRCUIT: SPST
- CONTACT RATING: 50mA
- VOLTAGE RATING: 12VDC
- DIELECTRIC WITH STANDING VOLTAGE: 250 VAC for 1 minute
- CONTACT RESISTANCE: 100mΩ max. (initial)
- INSULATION RESISTANCE: 100MΩ min.
- OPERATION LIFE: 1,000,000 cycles min.
- SOLDERING SPECIFICATION: 260°C for 3 seconds

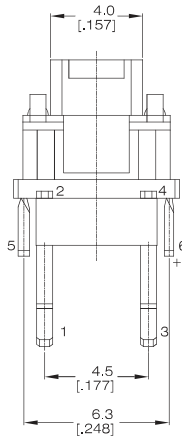
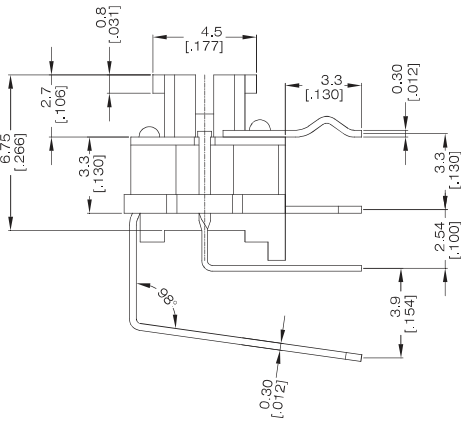
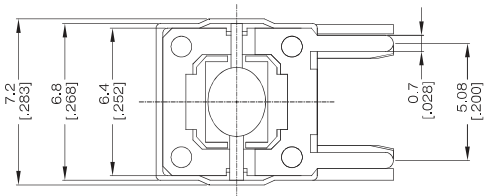

PCB LAYOUT

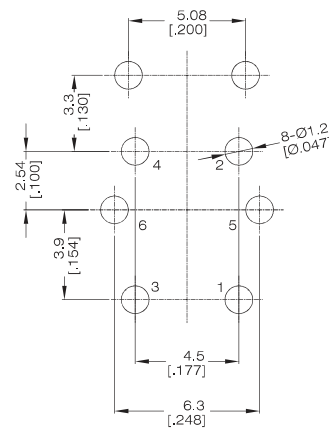

CIRCUIT

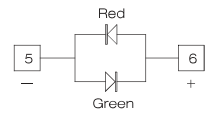
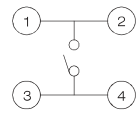

SPL6BL-2-36-H

HOW TO ORDER

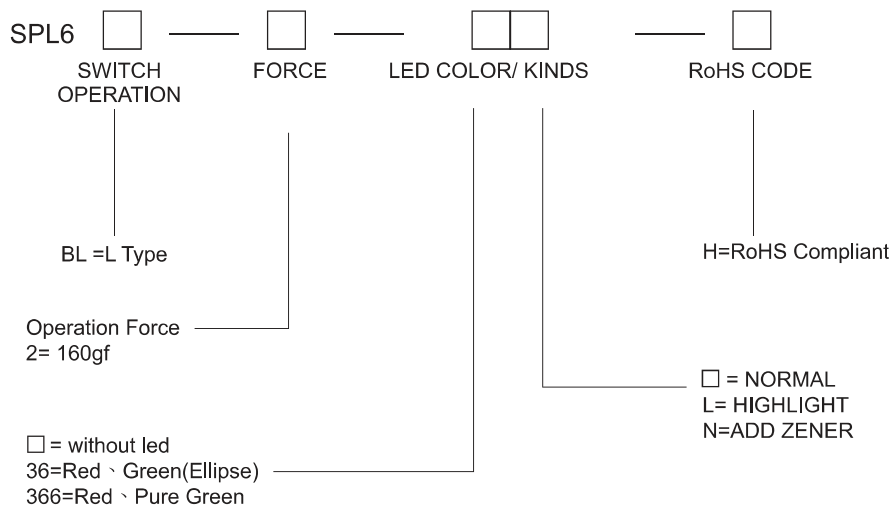



SPECIFICATIONS

- CIRCUIT: SPST
- CONTACT RATING: 50mA
- VOLTAGE RATING: 12VDC
- DIELECTRIC WITH STANDING VOLTAGE: 250VAC for 1 minute
- CONTACT RESISTANCE: 100Ω max.(initial)
- INSULATION RESISTANCE: 100MΩ min.
- OPERATION LIFE: 300,000 cycles
- SOLDERING SPECIFICATION: 260°C for 5 seconds

INDEX

TOGGLE

ROCKER

SLIDE

PUSH BUTTON

DIP

TACT

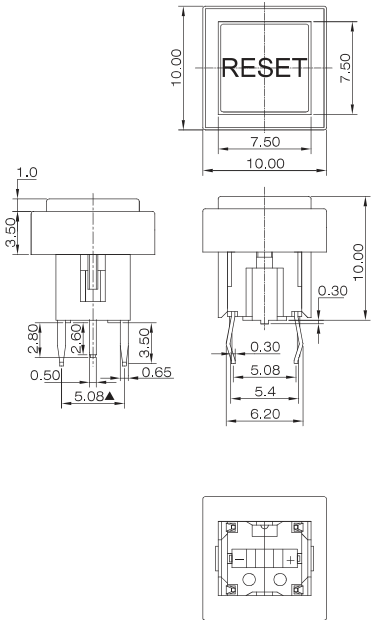

SPL6D-B-*-*-1*-A

CIRCUIT

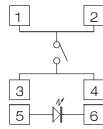

PCB LAYOUT

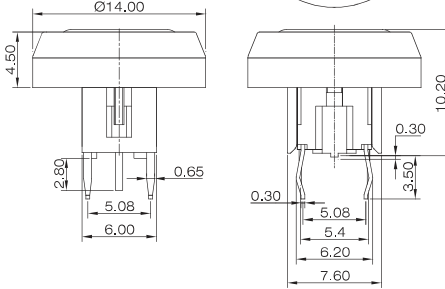
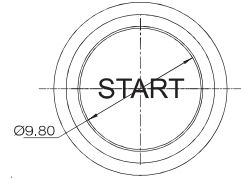
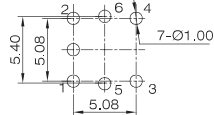

CIRCUIT

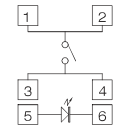

PCB LAYOUT

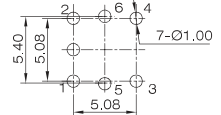

SPL6D-B-*-*-1*-B2

HOW TO ORDER

SPL6D	<input type="checkbox"/>	<input type="checkbox"/>	<input type="checkbox"/>	<input type="checkbox"/>	<input type="checkbox"/>	<input type="checkbox"/>	<input type="checkbox"/>	<input type="checkbox"/>
Switch	Terminal	Operation / Stem Force	LED / Kinds Color	Frame / Color	Cap Type	Color	Cap Pattern	RoHS
6*6 Illuminated tact switch	B = DIP Type C = SMT Type	1 = 100gf 2 = 160 gf 3 = 260 gf	<input type="checkbox"/> = Without LED 1 = White LED 3 = Red LED 4 = Orange LED 5 = Yellow LED 6 = Green LED 7 = Blue LED 57 = Yellow Blue LED 75 = Blue yellow LED	2 = Black 9 = Grey	<input type="checkbox"/> = Without Cap A = Square A1 = Square (With Hole) B = Round (7mm) B1 = Round (8mm) B2 = Round (10mm)	1 = White 2 = Black 3 = Red 9 = Grey	<input type="checkbox"/> = none A = RESET B = (Cathode is on the left.) B1 = (90° Cathode is on the left.) B2 = (180° Cathode is on the left.) B3 = (270° Cathode is on the left.) C = (Cathode is on the left.) D = START E = F = G = ESC	H = RoHS Compliant
<input type="checkbox"/> = Round A = Square			<input type="checkbox"/> = NORMAL N=ADD ZENER	<input type="checkbox"/> = Without Frame 1 = With Frame				

SPL6R



SPECIFICATIONS

- CIRCUIT: SPST
- CONTACT RATING: 10mA
- VOLTAGE RATING: 12VDC
- DIELECTRIC WITH STANDING VOLTAGE: 250VAC for 1 minute
- CONTACT RESISTANCE: 500Ω max.(initial)
- INSULATION RESISTANCE: 100MΩ min.
- OPERATION LIFE: 100,000 cycles
- SOLDERING SPECIFICATION: 260°C for 3 seconds

CONDUCTIVE RUBBER CONTACT

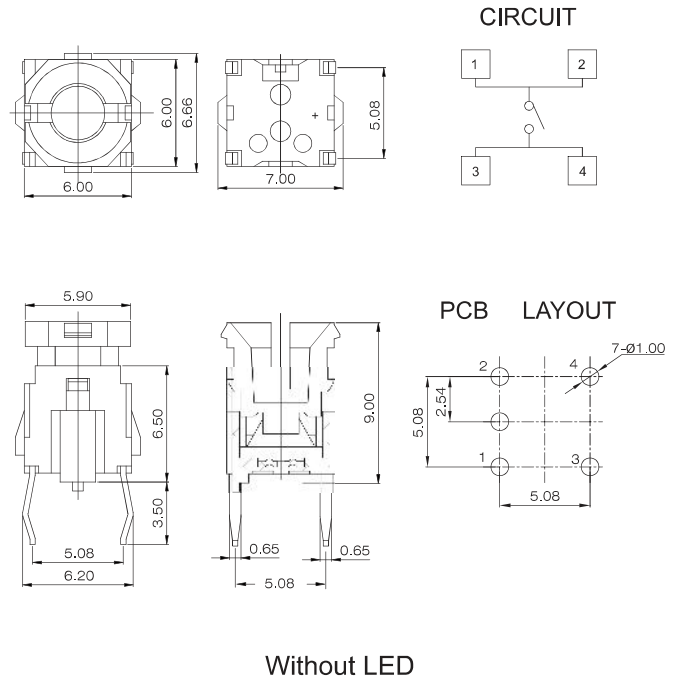
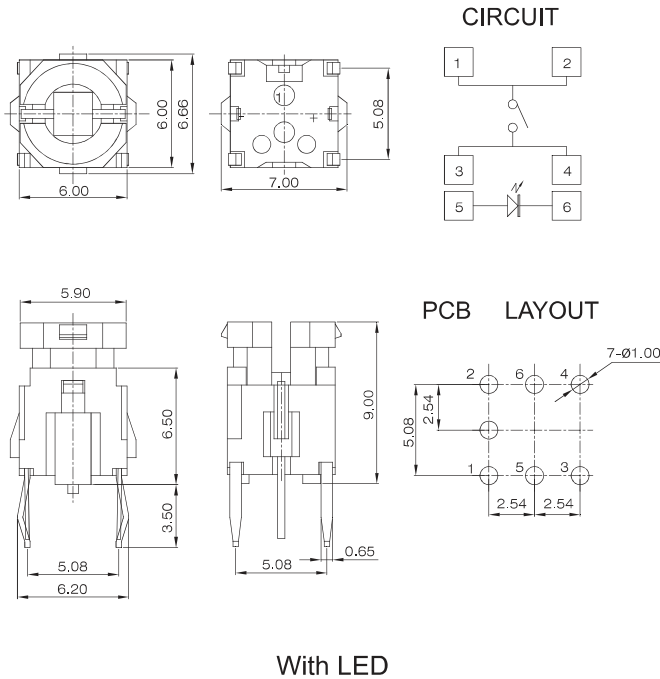

HOW TO ORDER

SPL6R — B — — — —

Switch Terminal Operation Force LED Color Package RoHS code

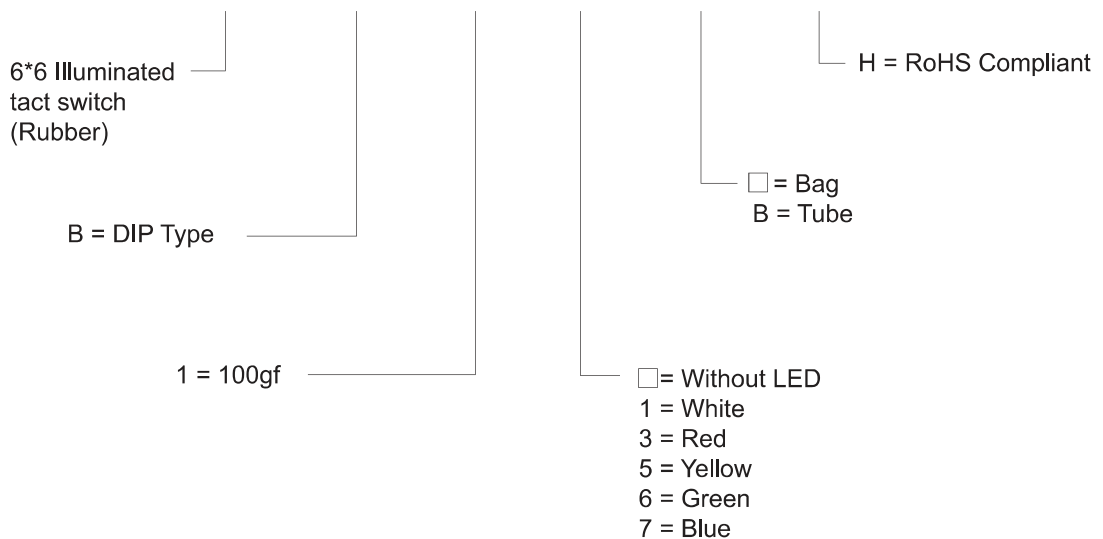

FEATURE

1. Performing the text variations by LED colors.
2. Long operation life, above 1,000,000 times.
3. Sealed construction, dust-proof type.

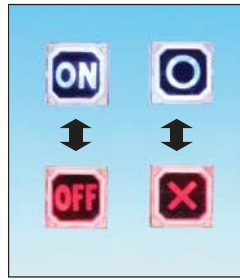

SPECIFICATIONS

CONTACT RATING: 50mA, 24VDC
 OPERATION LIFE: 1,000,000 cycles
 CONTACT RESISTANCE: 100mΩ max.(initial)
 INSULATION RESISTANCE: 100MΩ min.
 DIELECTRIC STRENGTH: 500VAC
 OPERATING TEMPERATURE: -25°C to +80°C

DIMENSION

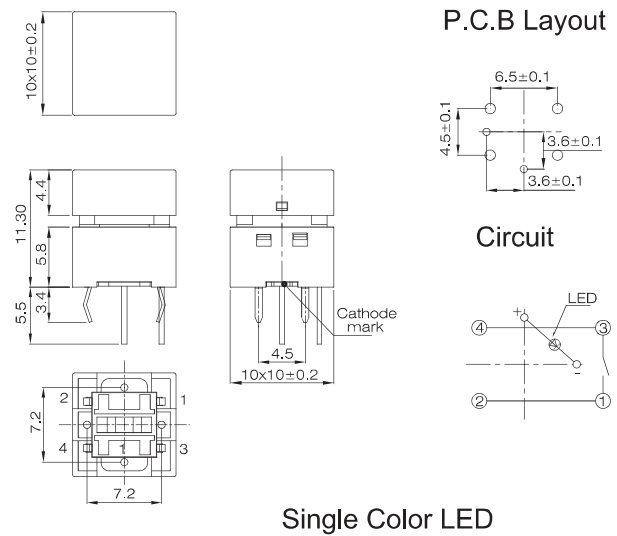
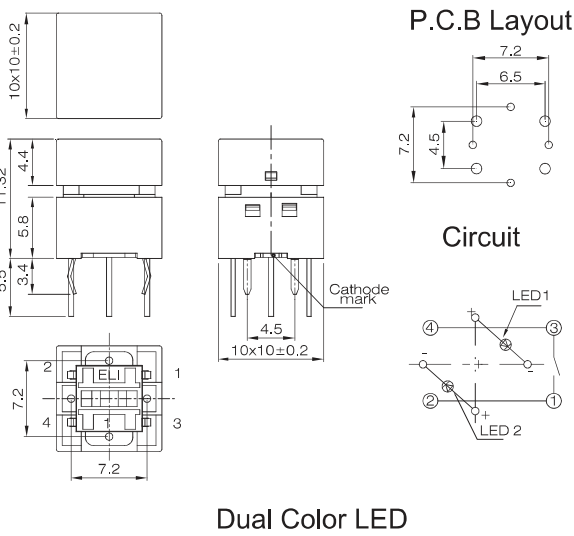

HOW TO ORDER

SPL — 10 — □ — □ — □ / □ — □ — □

Cap Size 10*10

Operation Force

No. of LEDs

LED 1 color

LED 2 color

Cap Style and Content

RoHS code

- 1 = 100gf
- 2 = 160 gf
- 3 = 260 gf

- = Without LED
- 1 = 1
- 2 = 2

- = Without LED
- 1 = White
- 3 = Red
- 4 = Orange
- 5 = Yellow
- 6 = Green
- 7 = Blue

- = Without LED
- 1 = White
- 3 = Red
- 4 = Orange
- 5 = Yellow
- 6 = Green
- 7 = Blue

H = RoHS Compliant

No content	
0 = Transparent	
1 = White	
2 = Black	
3 = Red	
5 = Yellow	
6 = Green	
7 = Blue	
M1 = Matte white cover (The Number is optional)	
Have Text Combination	
Text Combination	Color
F1 = " OFF "+ " ON "	36
	37
F2 = " 切 "+ " 入 "	36
	37
F4 = " X "+ " O "	36
	37
F6 = " ↑ "	/
F7 = " △ "+ " △ "	36
	37

SPECIFICATIONS

ELECTRICAL LIFE : 500,000 cycles min, for
 ELTS□W-69, 67, 65, 64
 100,000 cycles min. for
 ELTS□W-66, 68

CONTACT RESISTANCE: 100mΩ max
 INSULATION RESISTANCE: 100MΩ min. 500VDC
 DIELECTRIC STRENGTH: 250VAC/1 min
 OPERATION FORCE:
 360±90gf, Transparent(T), ELTS□W-65,67,69
 260±70gf, Red(R), ELTS□W-64, 65, 67, 69
 180±50gf, Brown(N), ELTS□W-64, 65, 67, 69
 160±50gf, Brown(N), ELTS□W-66
 160±50gf, Silver(S), ELTS□W-68

STORAGE TEMPERATURE: -30°C to +80°C
 CONTACT ARRANGEMENT: 1 pole 1 throw

MATERIALS

COVER - Stainless steel.
 BASE - UL94V-0 Nylon High-Temp. Thermoplastic(Black)
 CONTACT DISC - Phosphor bronze with silver cladding
 TERMINAL - Brass with silver cladding

ITEM NO.	ELTSMW-66N ELTSHW-66N	ELTSMW-68S ELTSHW-68S	ELTS(H)MW-69,67,65,64N (R) 69, 67T
STEM	High- Temp. Thermoplastic Nylon UL 94V-0 Color: Brown(N), 160gf	None	None
ADHESIVE TAPE	Resin-based	Resin-Based	None
METAL STEM	Brass with Nickel plated	Brass with Nickel Plated Color: Silver (S), 160gf	None
SEALED RUBBER	None	None	Silicone Rubber

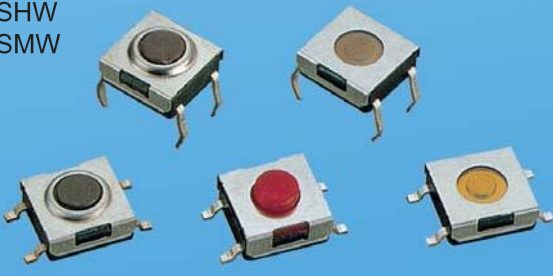
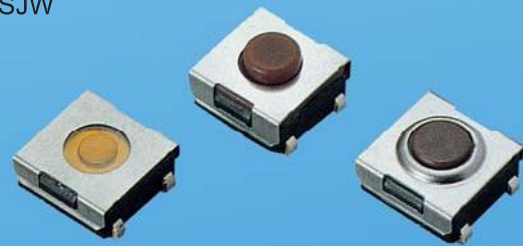
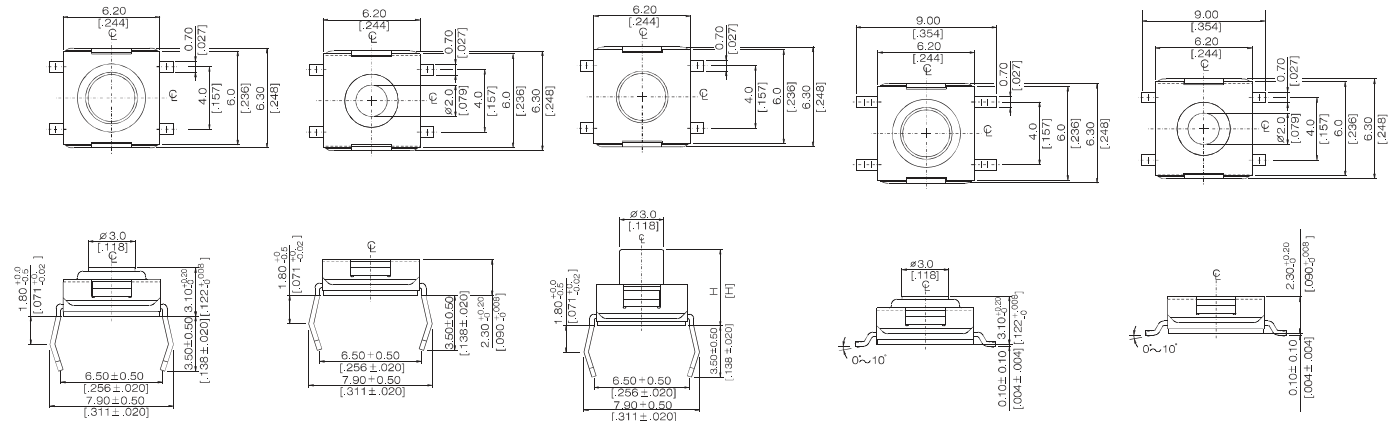
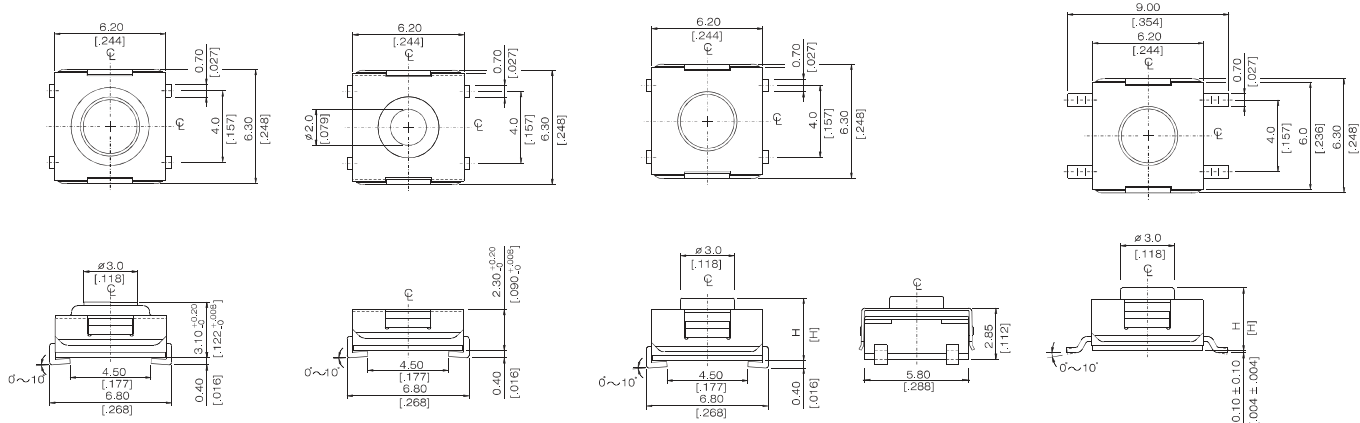
**ELTSHW
ELTSMW**

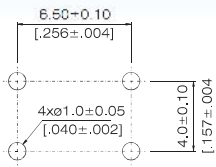
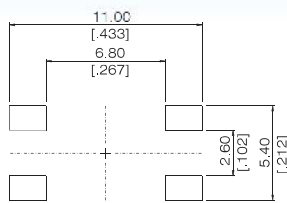
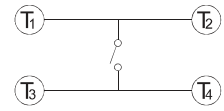
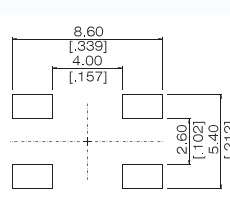
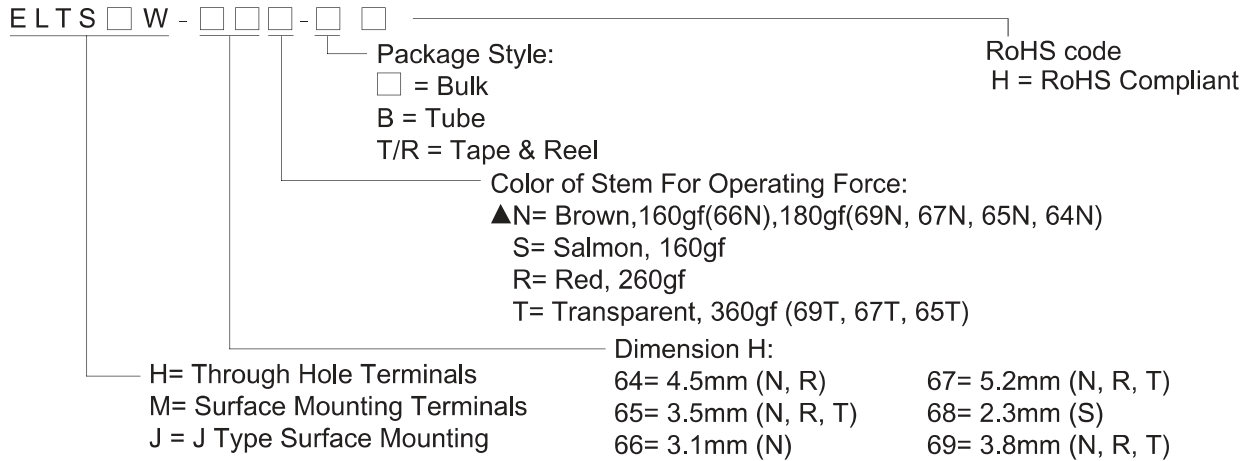
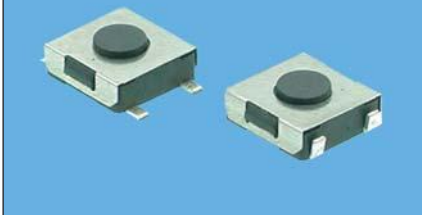
ELTSJW

DIMENSIONS
ELTSHW-66
ELTSHW-68
ELTSHW-69,67,65,64
ELTSMW-66
ELTSMW-68

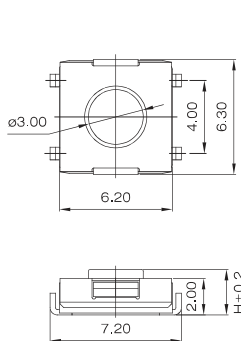
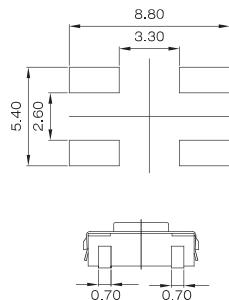
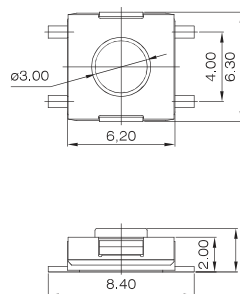
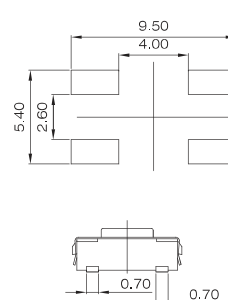
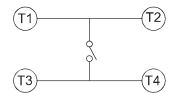
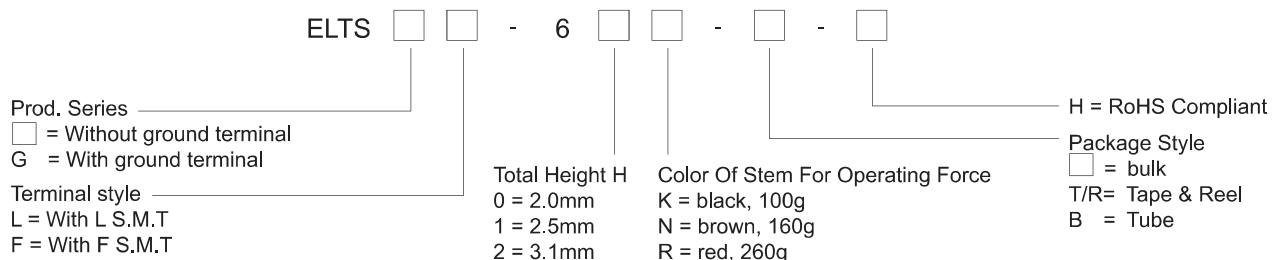
ELTSJW-66
ELTSJW-68
ELTSJW-69,67,65,64
ELTSMW-69,67,65,64

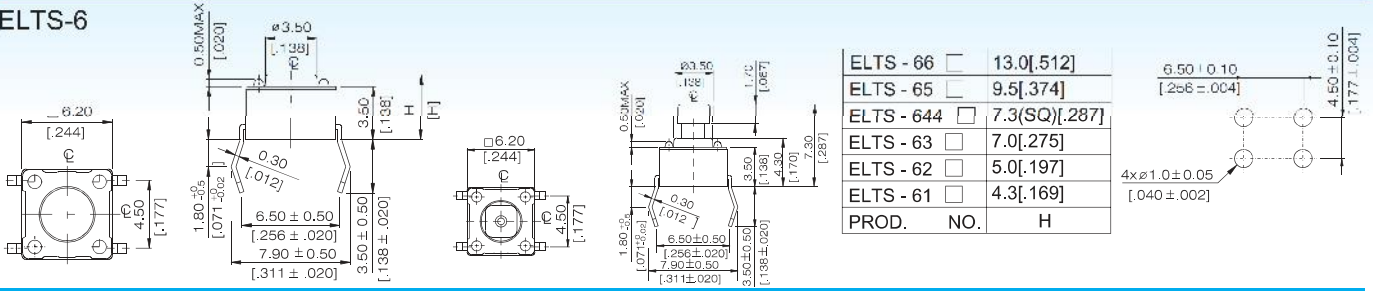
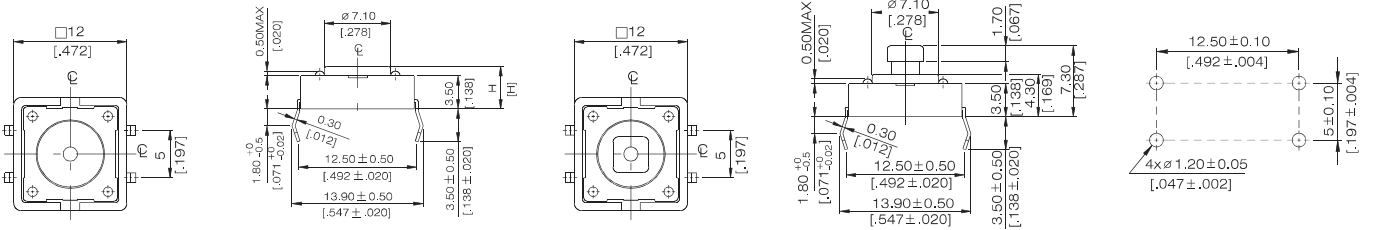
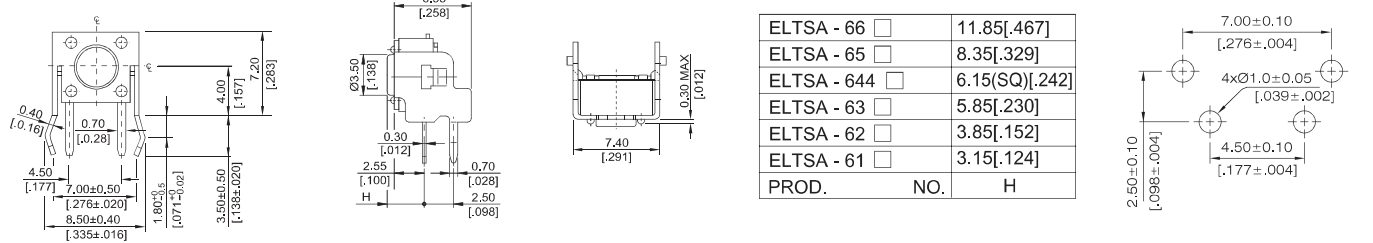
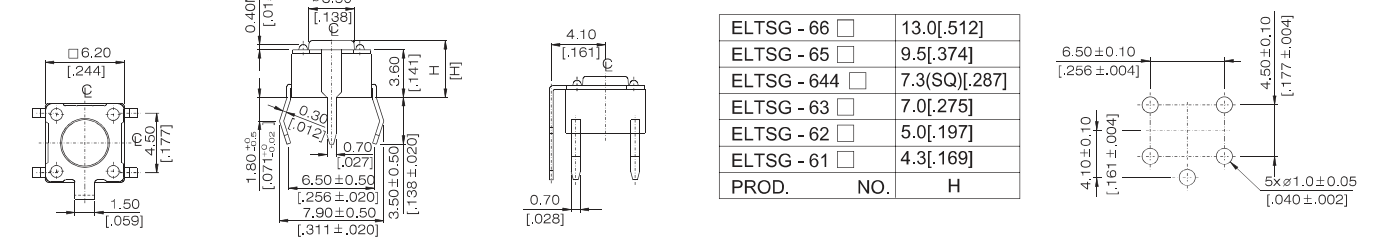
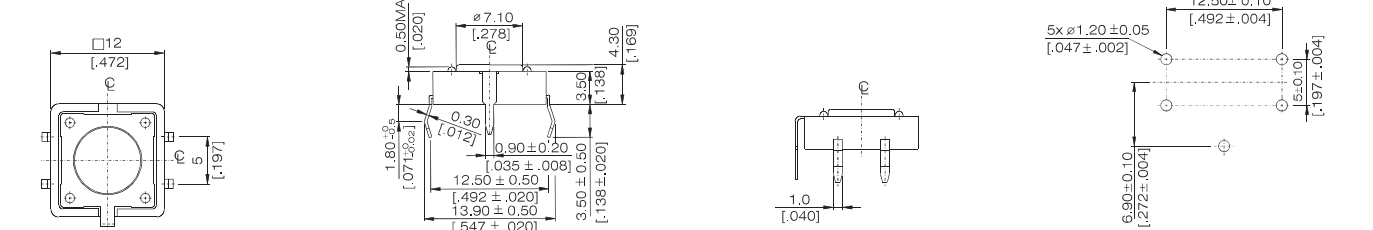
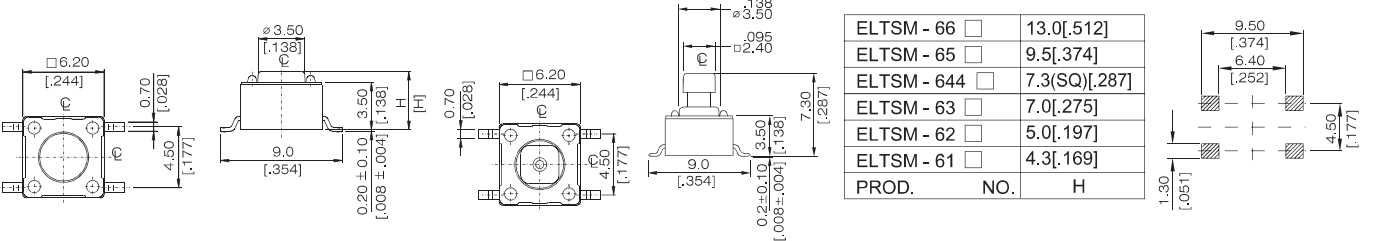
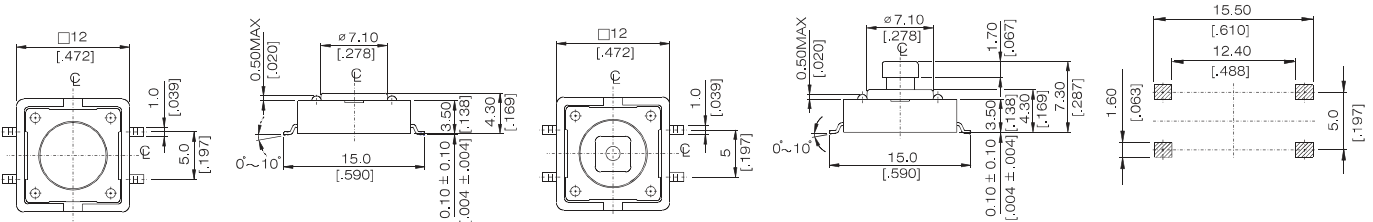
P.C.B. LAYOUT
CIRCUIT
ELTSHW-6

ELTSMW-6

ELTSJW-6

HOW TO ORDER

ELTS(G)L, F-6

SPECIFICATIONS

RATING: 50mA, 12VDC
ELECTRICAL LIFE: 1,000,000 cycles
CONTACT RESISTANCE: 100mΩ max
INSULATION RESISTANCE: 100MΩ min. 500VDC
DIELECTRIC STRENGTH: 250VAC/1 min
OPERATION FORCE: 100gf, 160gf, 260gf

DIMENSIONS
ELTSL-6

P.C.B. LAYOUT

ELTSF-6

P.C.B. LAYOUT

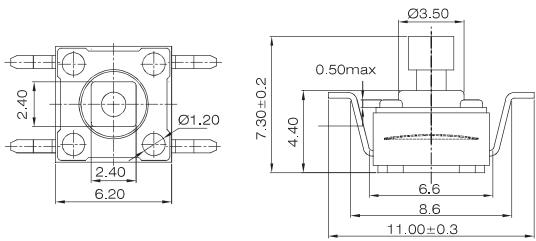
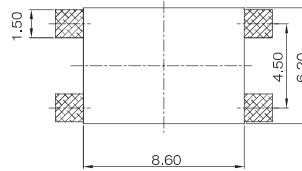
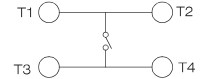
CIRCUIT

HOW TO ORDER

ELTS-6

ELTS-2

ELTSA-6

ELTSG-6

ELTSG-2

ELTSM-6

ELTSM-2



SPECIFICATIONS

RATING: 50mA, 12VDC
ELECTRIC LIFE: 100,000 cycles
CONTACT RESISTANCE: 100Ω max.
INSULATION RESISTANCE: 100MΩ min. 500VDC
DIELECTRIC STRENGTH: 500VAC/1 min.
OPERATION FORCE: 100gf, 160gf, 260gf

P.C.B. LAYOUT

CIRCUIT

HOW TO ORDER

ELTSX - 6 44 K - **B** - **H**

SMT Type Tactile Switch: _____
Prod Size: 6=6.2×6.2mm
Dimension H: 44: 7.3mm
Color Of Stem For Operation Force:
 K=Black, (100gf)
 N=Brown, (160gf)
 R=Red, (260gf)

=Regular Type:
 K = 100gf
 N = 160gf
 R = 260gf

Package Style:
 B=Tube
 T/R=Tape & Reel

H= RoHS compliant

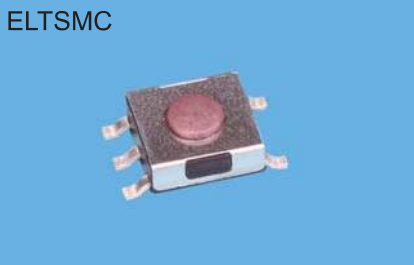
SPECIFICATIONS

RATING: 50mA, 12VDC
ELECTRICAL LIFE: 100,000 cycles
CONTACT RESISTANCE: 100mΩ max
INSULATION RESISTANCE: 100MΩ min. 250VDC
DIELECTRIC STRENGTH: 250VAC/1 min
OPERATION FORCE: 100gf, 160gf, 260gf

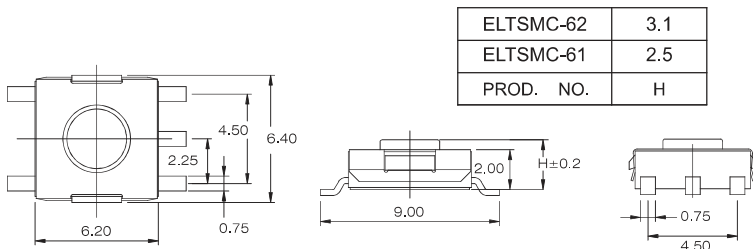
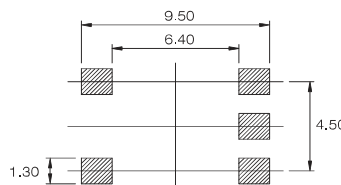
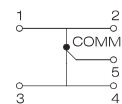
P.C.B LAYOUT

CIRCUIT

HOW TO ORDER

ELTSMC - 6 1 - K - - **H**

Function: SPDT, ON-ON
Height:
 1 = 2.5mm
 2 = 3.1mm
Color Of Stem For Operation Force (standard type):
 K = Black 100g
 N = Brown 160g
 R = Red 260g

= Bag
 T/R = Tape & Reel

Operation Force: (non-standard type)
 = Regular type
 K = 100g
 N = 160g
 R = 260g

H= RoHS compliant

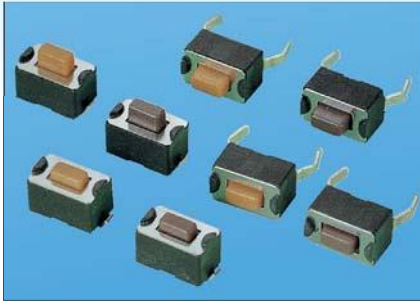
SPECIFICATIONS

RATING: 50mA, 12VDC
ELECTRICAL LIFE: 50,000 cycles for 160gf, 320gf,
 30,000 cycles for 260gf, 520gf
CONTACT RESISTANCE: 100mΩ max
INSULATION RESISTANCE: 100MΩ min. 500VDC
DIELECTRIC STRENGTH: 250VAC/1 min
OPERATION FORCE : 160gf, 260gf, 320gf, 520gf
STORAGE TEMPERATURE: -30°C to +80°C

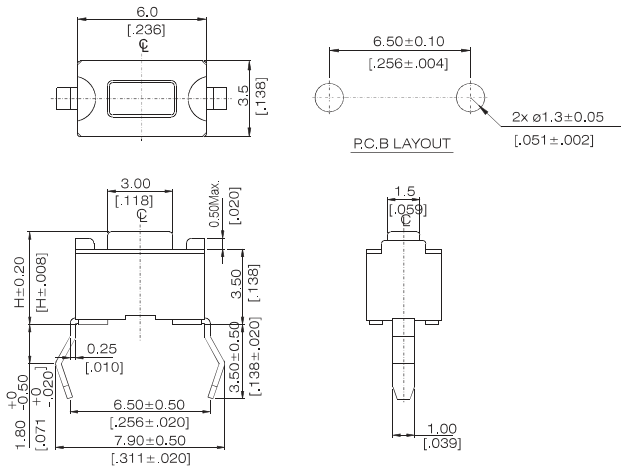
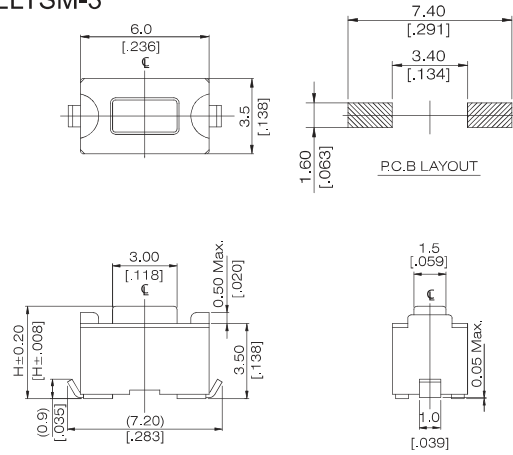
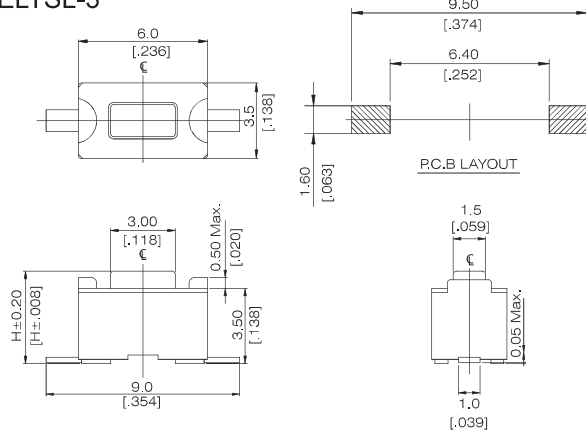
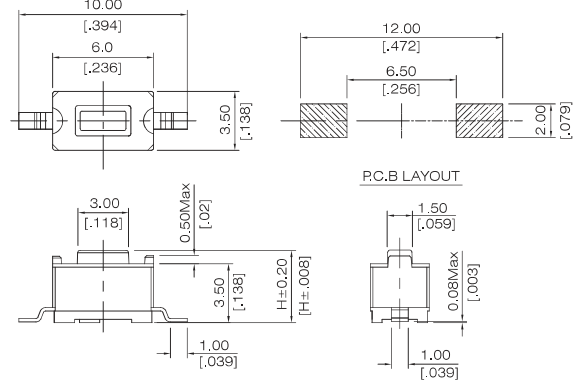
DIMENSIONS
ELTS-3

ELTSM-3

ELTSL-3

ELTSF-3

CIRCUIT

HOW TO ORDER

ELTS □ - □ □ □ - □ □ □

- : Through Hole
- M : S.M.T/J-bend outward
- L : S.M.T/Flat
- F : S.M.T/Gull-wing

Prod. SIZE: 3= 3.5 X 6

Dimension H:
 1= 4.3mm
 2= 5.0mm

RoHS code
 H= RoHS Compliant

Package:
 □ : Bag (THT Only)
 B : Tube Package
 T/R: Tape & Reel

Operating Force:
 N= 160gf
 R= 260gf
 S= 320gf
 Y= 520gf

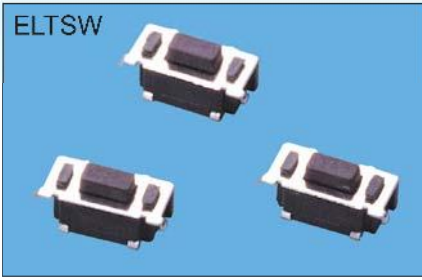
ELTSW

SPECIFICATIONS

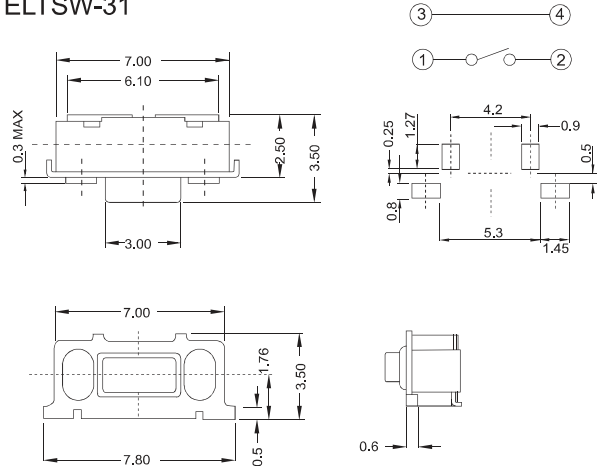
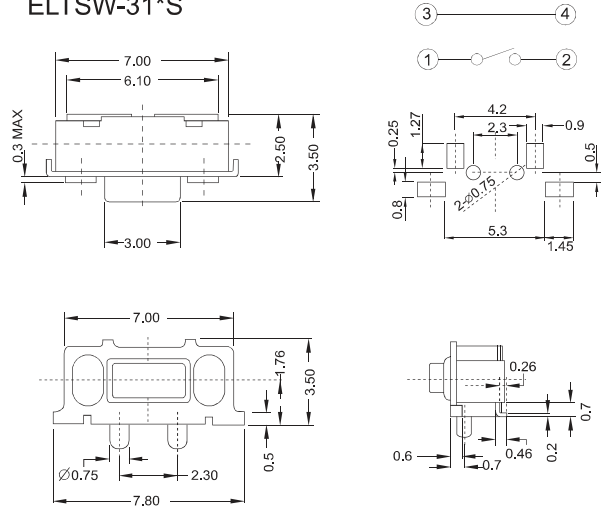
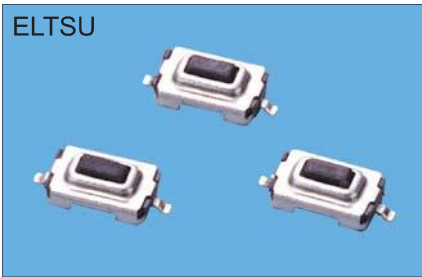
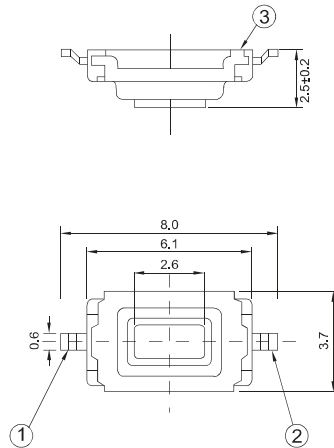
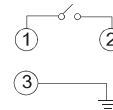
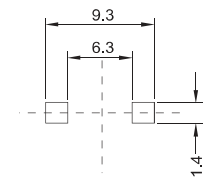
RATING: 50mA, 12VDC
 ELECTRICAL LIFE: 30,000~50,000 cycles
 CONTACT RESISTANCE: 100mΩ max
 INSULATION RESISTANCE: 100MΩ min. 100VDC
 DIELECTRIC STRENGTH: 250VAC/1 min
 OPERATION FORCE: 260 ± 70g (only for ETSU-3)
 160 ± 50g
 STORAGE TEMPERATURE: -30°C to +80°C
 CONTACT ARRANGEMENT: 1 pole 1 throw

DIMENSION
ELTSW-31

ELTSW-31*S

ELTSU

ELTSU-31

Circuit Diagram

P.C.B Layout

HOW TO ORDER

ELTS — 3 1 — —

Package Style:
 T/R: Tape & Reel

: None pilot
 S : Base with pilot (only for ELTSW-3)

Operation Force:
 N = 160g
 R = 260g (only for ELTSU-3)

Dimension H:

Code	ELTSU-3	ELTSW-3
1	2.5	3.5

U = Surface Mounting Type
 W = Slide Push Type

RoHS code
 H= RoHS Compliant