



## 4mm Fixed Shroud Plug

Part Number:- 125037  
 Standard Colours. Red Black Green Blue Yellow White  
 Features Accepts cable up to 4.5 mmØ.

IEC 61010 Rating.  
 Measurement Category. 1000V CAT III/600V CAT IV  
 Current Rating. 20 Amp  
 Insulation Category. Double/Reinforced.  
 Pollution Degree. Two (2)

Silvertronic confirm that the product(s) listed have been designed, manufactured and tested to and are therefore fully compliant to:

### IEC61010-031:2002 (First Edition) + Amd. 1:2008.

Together with the corresponding UL and CSA Standards, and are subject of a CB Scheme report. All products marked as per IEC requirements. UL and CSA marking upon request.

All testing carried out by independent third party test house and CB Test Laboratory,

**MET Laboratories Inc.** Baltimore MD 21230 USA

The product(s) also meet the requirements of the Low Voltage Directive and where applicable comply with HSE GS.38.

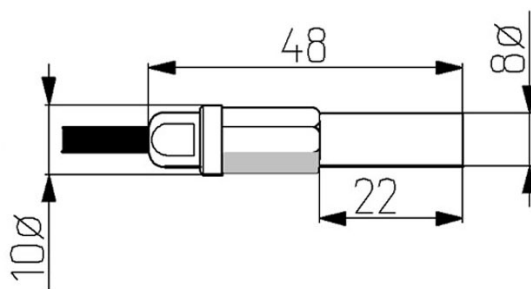

### ASSEMBLY INSTRUCTIONS

- 
- APPLY SOLDER (EXCESSIVE HEAT MAY DAMAGE TIP)
1. PREPARE CABLE AND TIN BARE END
  2. PUSH CABLE THROUGH SCREW CAP AND COLLET. NOTE CORRECT ORIENTATION
  3. PUSH CABLE INTO CONTACT AND APPLY SOLDER TO CONTACT BUCKET
  4. PUSH CONTACT ASSEMBLY INTO BODY AND TIGHTEN SCREW CAP