

## 3A to 60A, 250VAC EMI Filters

### Features

- ◆ High Voltage Pulse Attenuation
- ◆ DIN Rail Mount Option (Up 30A)
- ◆ Low Earth Leakage Current Option (Up to 30A)
- ◆ Conforms to UL, CSA and EN Safety Agency Certifications



| Specifications               |    |   |                                       |                                       |                                       |                                       |
|------------------------------|----|---|---------------------------------------|---------------------------------------|---------------------------------------|---------------------------------------|
| Model                        |    | RSAN-2003<br>RSAN-2003D<br>RSAN-2003L                       | RSAN-2006<br>RSAN-2006D<br>RSAN-2006L | RSAN-2010<br>RSAN-2010D<br>RSAN-2010L | RSAN-2016<br>RSAN-2016D<br>RSAN-2016L | RSAN-2020<br>RSAN-2020D<br>RSAN-2020L |
| Rated Voltage (AC, DC)       | V  | 250V  |                                       |                                       |                                       |                                       |
| Rated Current                | A  | 3A  | 6A                                    | 10A                                   | 16A                                   | 20A                                   |
| Withstand Voltage            | V  | Terminals to Case: 2500VAC (1 Minute)                       |                                       |                                       |                                       |                                       |
| Isolation Resistance         | MΩ | 100MΩ minimum (500VDC, 1 Minute)                            |                                       |                                       |                                       |                                       |
| Leakage Current (max)        | A  | RSAN-20xx 1mA; RSAN20xxL 10uA (250VAC, 60Hz)                |                                       |                                       |                                       |                                       |
| DC Resistance (total)        | mΩ | 250   | 110                                   | 40                                    | 20                                    | 10                                    |
| Model                        |    | RSAN-2030<br>RSAN-2030D<br>RSAN-2030L                       | RSAN-2040                             | RSAN-2050                             | RSAN-2060                             |                                       |
| Rated Voltage (AC, DC)       | V  | 250V  |                                       |                                       |                                       |                                       |
| Rated Current                | A  | 30A   | 40A                                   | 50A                                   | 60A                                   |                                       |
| Withstand Voltage            | V  | Terminals to Case: 2500VAC (1 Minute)                       |                                       |                                       |                                       |                                       |
| Isolation Resistance         | MΩ | 100MΩ minimum (500VDC, 1 Minute)                            |                                       |                                       |                                       |                                       |
| Leakage Current (max)        | A  | RSAN-20xx 1mA; RSAN20xxL 10uA (250VAC, 60Hz)                |                                       |                                       |                                       |                                       |
| DC Resistance (total)        | mΩ | 6   | 6                                     | 4                                     | 3                                     |                                       |
| Operating Temperature        | °C | -25 to +85°C (Derate above 55°C, see derating curve)        |                                       |                                       |                                       |                                       |
| Storage Temperature          | °C | -25 to +85°C  |                                       |                                       |                                       |                                       |
| Safety Agency Certifications | -  | UL1283, CSA C22.2 No.8, EN60939                             |                                       |                                       |                                       |                                       |
| Weight                       | g  | 170g to 870g model dependant (See weights chart on website) |                                       |                                       |                                       |                                       |
| Warranty                     | yr | 1 Year  |                                       |                                       |                                       |                                       |

| Options                                   |            |
|---|------------|
| Chassis Mount & Standard Leakage Current  | RSAN-20xx  |
| DIN Rail Mount & Standard Leakage Current | RSAN-20xxD |
| Chassis Mount & Low Leakage Current       | RSAN-20xxL |

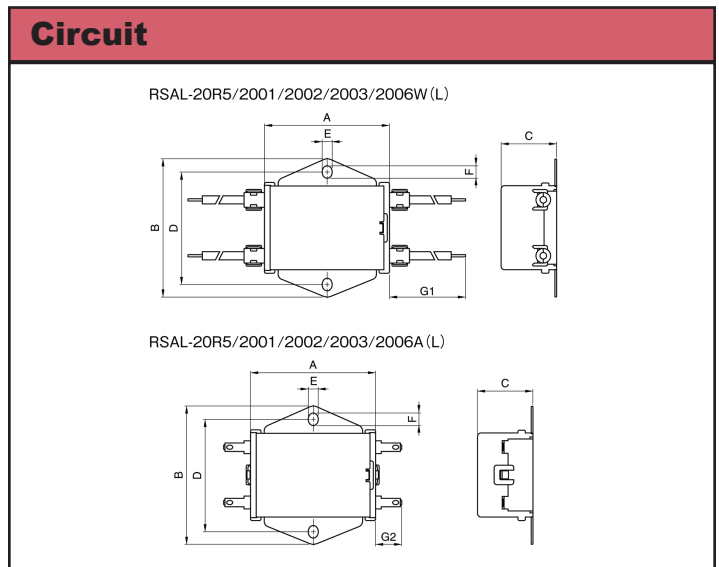
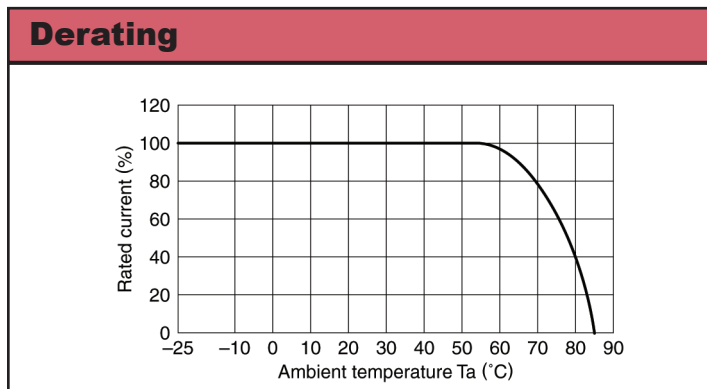

## Outline Drawing

RSAN-2003/2006/2010/2016/2020/2030

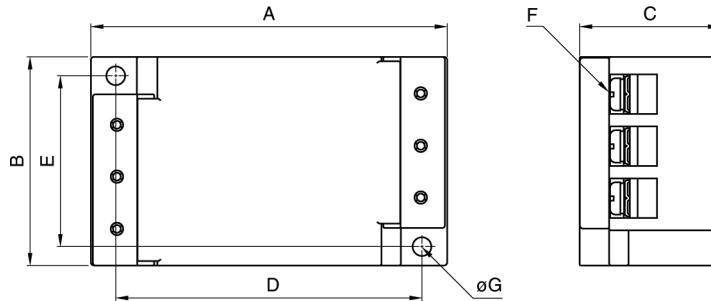

RSAN-2040/2050/2060

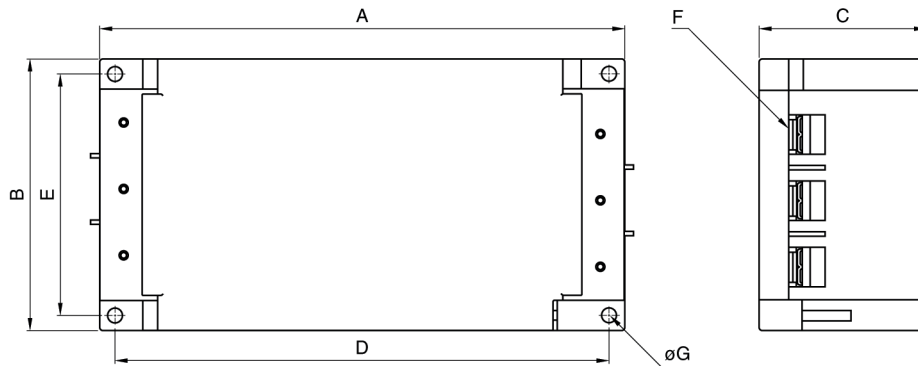

Dimensions in mm

| Part No.  | A   | B  | C  | D   | E  | F  | $\phi$ G | Recommended clamping torque |
|-----------|-----|----|----|-----|----|----|----------|-----------------------------|
| RSAN-2003 | 87  | 52 | 35 | 75  | 43 | M4 | 4.5      | 1.27N · m                   |
| RSAN-2006 |     |    |    |     |    |    |          |                             |
| RSAN-2010 |     |    |    |     |    |    |          |                             |
| RSAN-2016 |     |    |    |     |    |    |          |                             |
| RSAN-2020 |     |    |    |     |    |    |          |                             |
| RSAN-2030 |     |    |    |     |    |    |          |                             |
| RSAN-2040 | 170 | 90 | 54 | 160 | 80 | M5 | 4.5      | 2.5N · m                    |
| RSAN-2050 |     |    |    |     |    |    |          |                             |
| RSAN-2060 |     |    |    |     |    |    |          |                             |
|           |     |    |    |     |    |    |          |                             |

For Additional Information, please visit  
[us.tdk-lambda.com/lp/products/r-series.htm](http://us.tdk-lambda.com/lp/products/r-series.htm)

