

Contact 10036 Specification

Insertion Loss: 6.4GHz at -1dB

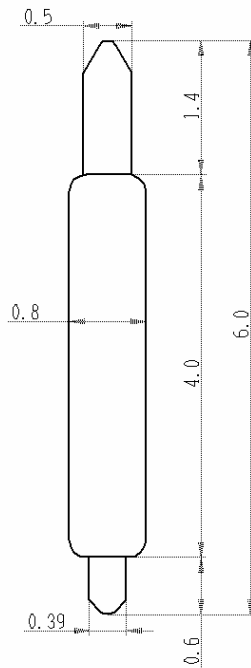

Return Loss: -9.5dB at 6.4GHz



Mechanical:

Min. Pitch:	1.0mm
Recommended Travel:	0.65mm
Typical Spring Force:	30g @0.65mm
Maximum Travel:	34g @0.9mm
Contact Life:	300K insertions
Operating Temp.:	-55 to 150°C

Electrical:

Resistance:	< 100 mΩ
Current Rating:	2A
Insertion Loss:	6.4 GHz at -1dB *
Return Loss:	-9.5dB at 6.4GHz *
Self Inductance:	1.80nH
Mutual Inductance:	0.29nH
Self Capacitance:	0.99pF
Mutual Capacitance:	0.24pF

* Pin Alignment: GSG

Data are reference only and subject to change.

Yamaichi Electronics USA Inc.
475 Holger Way San Jose, CA 65134
Tel:408-715-9100 www.yeu.com