

# CONTACT 3164 YEU Specification

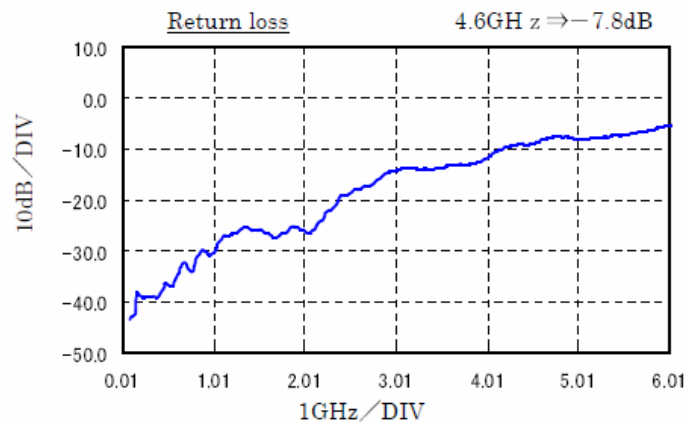
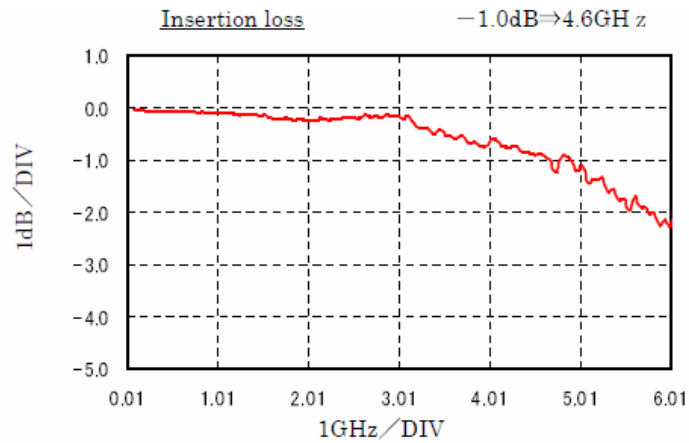
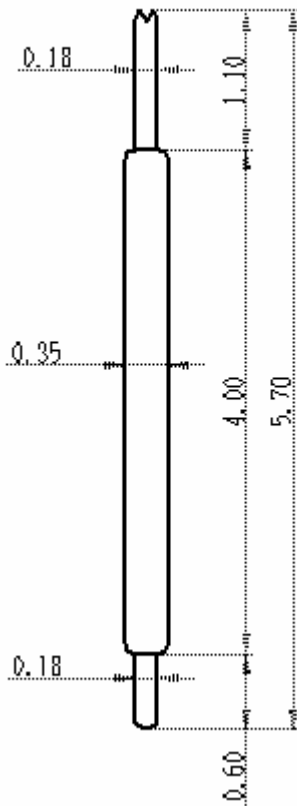

Min. Pitch: 0.5mm  
 Recommended Travel: 0.65mm  
 Typical Spring Force: 25g @0.65mm  
 Contact Life: 300K insertions  
 Operating Temp.: -55 to 125°C

**Electrical:**

Resistance: < 100 mΩ  
 Current Rating: 1.36A  
 Insertion Loss: 4.6 GHz at -1dB \*  
 Return Loss: -7.8dB at 4.6GHz \*  
 Self Inductance: 1.34nH  
 Mutual Inductance: 0.31nH  
 Self Capacitance: 0.58pF  
 Mutual Capacitance: 0.14pF

\* Pin Alignment: GSG

Data are reference only and subject to change.

Yamaichi Electronics USA Inc.  
 475 Holger Way San Jose, CA 95134  
 Tel:408-715-9100 www.yeu.com