

BOXER-6841M-A5

Vision System Fanless Embedded Box PC with 6th/ 7th Generation Intel® Core™ Desktop / Xeon® server-grade Processor and 2 PCIe(x8) + PCIe (x1)

Front View

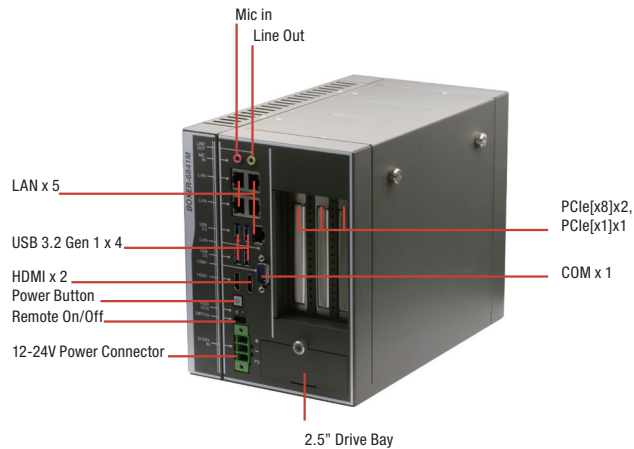

Rear View



Features

- Support 6th / 7th Core-i desktop and Xeon® server-grade processor, Max 73W.
- Intel® C236 PCH
- Easy Installation design for expand slot
- Support PCIe[x8] x2, PCIe[x1] x1
- Support frame grabber card
- Fanless system



Specifications

System	
CPU	6th / 7th Generation Intel® Core™-i desktop and Xeon® server grade processor -Intel® Core™ i7-6700TE, 2.4 GHz -Intel® Core™ i5-6500TE, 2.3 GHz -Intel® Core™ i3-6100TE, 2.7 GHz -Intel® Core™ i7-7700, 3.6 GHz -Intel® Core™ i7-7700T, 2.9 GHz -Intel® Core™ i3-7101TE, 3.4 GHz -Intel® Xeon® E3-1268L v5, 2.40 GHz -Intel® Xeon® E3-1275 v6, 3.80 GHz
Chipset	Intel® C236 PCH
System Memory	DDR4 ECC or Non-ECC SODIMM, up to 32GB
Display Interface	HDMI type A x 2 for HDMI v1.4b
Storage Device	2.5" Drive Bay x 2
Ethernet	RJ-45 x 5 for GbE (Intel i211AT x 4, i219LM x 1)
I/O	2 pin Remote Power on/off connector Power ON/OFF Switch x 1 HDMI 1.4b x 2 Audio x 2 (MIC-in, Line-out) USB 3.2 Gen 1 x 4 DB-9 x 1 for RS-232/422/485 3 pin DC Power input x 1 (+, -, GND)
Expansion	Full-size Mini card x 2 (USB, w/ 1 SIM slot) PCIe [x8] x 2 Extension card size limit: 114.55mm(H) x 192mm (L) PCIe [x1] x 1
Indicator	Power LED x 1, HDD active LED x 1
OS Support	Skylake S Windows® 10, Windows® 10 IoT, Windows® 8.1, Windows® Embedded Standard 8, Windows® 7, Windows® Embedded Standard 7, Ubuntu 16.04.2 Kabylake Windows® 10, Windows® 10 IoT, Ubuntu 16.04.2
Power Supply	
Power Requirement	DC-In 12-24V - CPU = 35W: 120W Adapter - 35W < CPU ≤ 73W: 240W Adapter
Mechanical	
Mounting	Wallmount
Dimensions (W x H x D)	6.10" x 7.87" x 10.24" (155mm x 200mm x 260mm)
Gross Weight	12.75 lb (5.8 kg)
Net Weight	9.9 lb (4.5 Kg)
Environmental	
Operating Temperature	-4°F ~131°F (-20°C ~ 55°C) according to IEC60068-2 with 0.5m/s airflow (TDP 35W Processor) -4°F ~113°F (-20°C ~ 45°C) according to IEC60068-2 with 0.5m/s airflow (TDP 73W Processor)
Storage Temperature	-4°F ~ 176°F (-40°C ~ 80°C)
Storage Humidity	5 ~ 95% @ 40°C, non-condensing
Anti-Vibration	Random, 1Grm, 5~500Hz, Anti-vibration design
Anti - Shock	—
Certification	CE/FCC class A

Dimension

Unit: mm

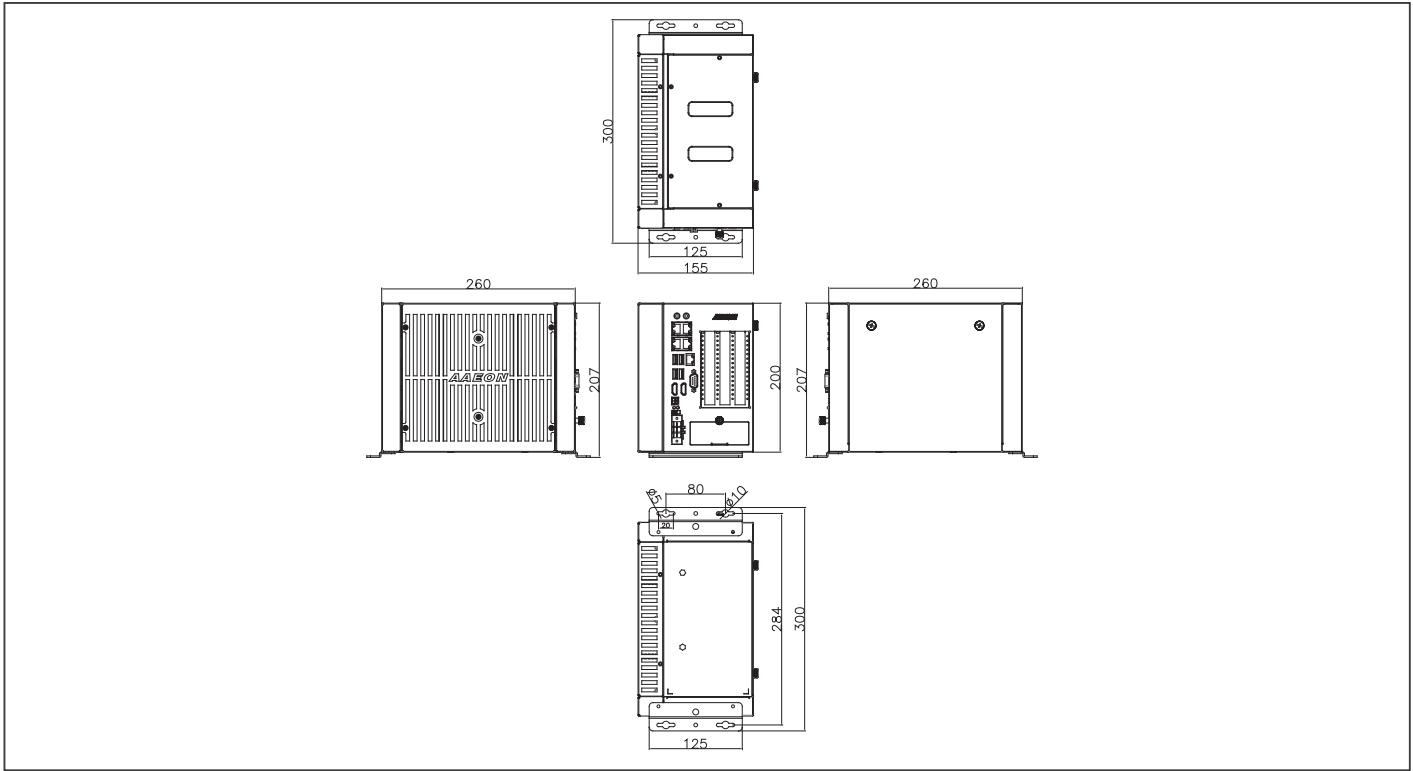

Ordering Information

Part Number	CPU	PCH	LAN	USB 3.2 Gen 1	RS-232/422/485	RS-232	Digital I/O	Audio	Storage	Display	Expansion	Mounting	Power	Operation temp.
BOXER-6841M-A5-1010	—	C236	5	4	1	—	—	MIC-in, Line-out	2.5" Drive Bay x 2	HDMI x2	Full-size Minitcard x2, PCIe[x8] x2, PCIe[x1]x1	Wallmount	DC-In 12-24V - CPU = 35W: 120W Adapter - 35W < CPU ≤ 73W: 240W Adapter	-20°C ~ 55°C with 0.5m/s airflow (TDP 35W Processor) -20°C ~ 45°C with 0.5m/s airflow (TDP 73W Processor)

Packing List

- Wallmount Bracket x 2
- 3 Pin DC-in Power Connector x 1
- Screw Package x 1
- Thermal Pad Package x 1
- BOXER-6841M-A5

Optional Accessories

- **1255901209**
120W Power Adapter
- **1255902400**
240W Power Adapter
- **1702031802**
Power Cord (US type)
- **1702031803**
Power Cord (European Type)
- **170203180E**
Power Cord (Japanese Type)
- **9741238H00**
WiFi Module & Antenna
- **9741EG25G0**
4G Module & Antenna (for global)
- **9741EC25A0**
4G Module & Antenna (for USA-AT&T)
- **9741EC25V0**
4G Module & Antenna (for USA-Verizon)
- **M046841140**
Main heatsink cover

X-ON Electronics

Largest Supplier of Electrical and Electronic Components

Click to view similar products for [Ethernet Modules](#) category:

Click to view products by [Aaeon](#) manufacturer:

Other Similar products are found below :

[I350T4V2](#) [GX-OD1612](#) [TDKEZW3](#) [I350T2V2](#) [V23993-USB1029A](#) [I350T2V2BLK](#) [FC6A-PH1](#) [EM-ETH-GATEWAY-IFS](#) [EK1122](#)
[EL1018](#) [EL1809](#) [EL2622](#) [EL2904](#) [EL6021](#) [EL6224](#) [EL6631](#) [EL9011](#) [EL9100](#) [KL1002](#) [KL1104](#) [KL2602-0010](#) [KL3208-0010](#) [KL6821](#)
[KL9100](#) [KL9200](#) [X710T2L](#) [RY9012A0000GZ00#002](#) [X710T4LBLK](#) [7000-14561-7960150](#) [7000-44711-7960300](#) [7000-44711-7960750](#)
[7000-44711-7961000](#) [7000-74711-4780150](#) [7000-89701-7910500](#) [7000-P6241-P060500](#) [2352903-2](#) [BOXER-6614-A1M-1110](#) [ED-593](#) [WC-](#)
[PD13C033I-1](#) [EL2809-0015](#) [WC-PD30A012C](#) [NS8](#) [NS2](#) [NS4](#) [USR-K3](#) [USR-K2](#) [USR-TCP232-E2](#) [WC-PD13S120B](#) [WC-PD13C012S](#)
[WC-PD07H012C](#)