



TUBE LIQUID COLD PLATE

Aavid Standard Tube Liquid Cold Plates feature tubes mechanically locked into an extruded metal frame. These cold plates are lightweight due to lower plate mass making them ideal for weight sensitive applications. They are extremely cost effective and easy to customize.

PART NUMBER

418101U00000G – Unfinished
418201U00000G – Unfinished
418301U00000G – Unfinished
See below for measurements

AVAILABLE OPTIONS

- *Finishes:* Unfinished, AavSHIELD, AavSHIELD³
- *Tube Material:* Stainless Steel or Cupronickel tubing of the same inside diameter
- *Length/Width:* Custom lengths available – See Custom Design Example and Guidelines



FEATURES & BENEFITS:

- Lower Manufacturing Costs
- Leak Free Joints
- Enhanced Thermal Performance

TUBE COLD PLATE PRODUCT SPECIFICATIONS

Property	Details
Plate Details	Extruded, Aluminum
Tube Details	Copper 9.5mm (0.375") O.D. x 8mm (0.032") wall
Epoxy	Aluminum filled, high thermal conductivity
Standard Finish	Unfinished Standard

418101U00000G - MEASUREMENTS

Measurement	in	mm
Plate Width	5	127
Plate Length	7	178
Full Tube & Plate Length	14.5	368.3

418201U00000G - MEASUREMENTS

Measurement	in	mm
Plate Width	5	127
Plate Length	12	305
Full Tube & Plate Length	19.5	495.3

418301U00000G - MEASUREMENTS

Measurement	in	mm
Plate Width	5	127
Plate Length	24	610
Full Tube & Plate Length	31.5	800.1

MECHANICAL

Dimensions are shown in mm (in)

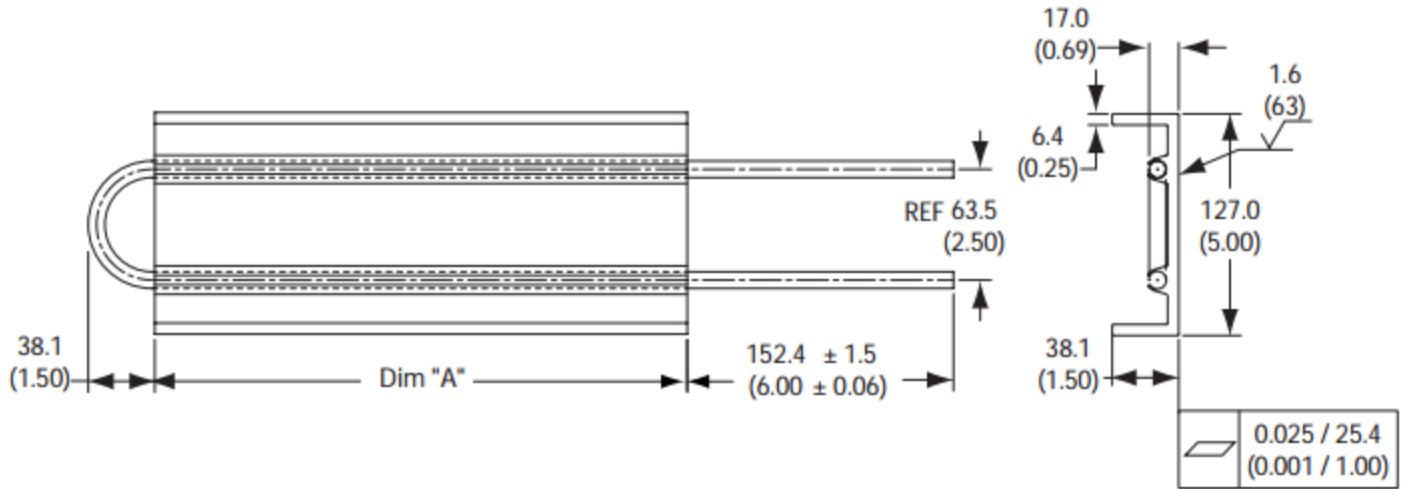
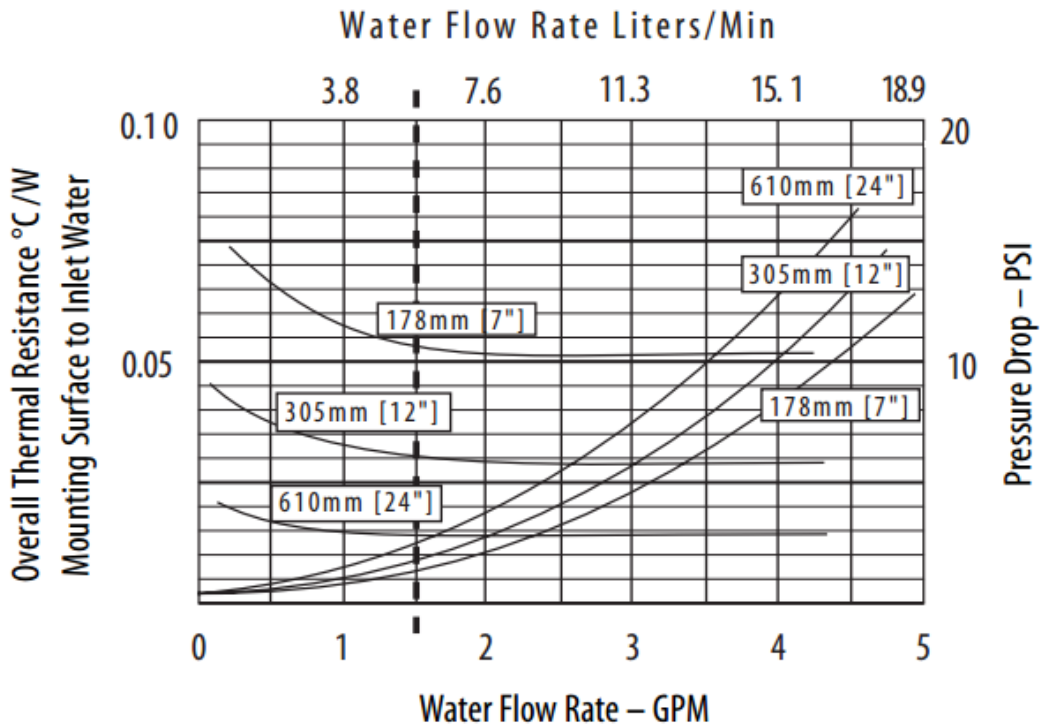

Figure 1

PERFORMANCE

Testing was performed using 100% Pure Water



CUSTOM DESIGN EXAMPLE AND GUIDELINES

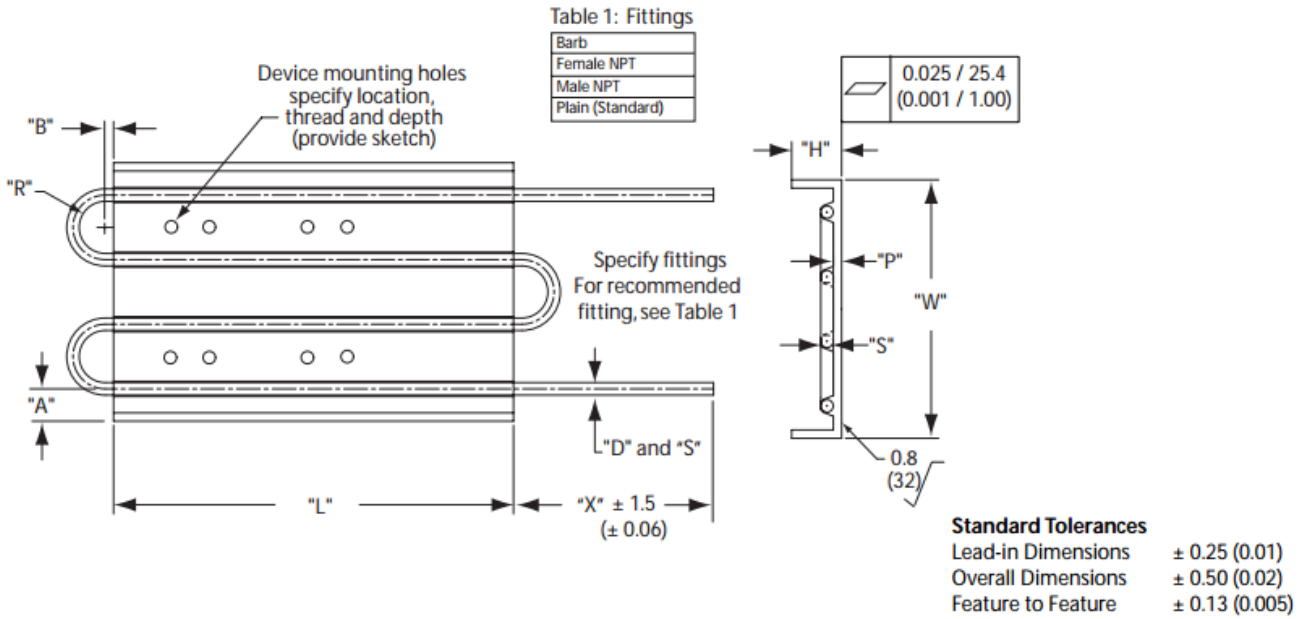

Dim	Description	Min	Max
A	Tube to edge	12.0 (0.50)	
B	Center line of tube radius to plate	3.0 (0.12)	
H	Flange height	25.4 (1.00)	76.2 (3.00)
L	Plate length	25.4 (1.00)	711.2 (28.00)
P	Plate thickness	6.4 (0.25)	25.4 (1.00)
R	Tube bend radius measured at centerline (Copper only)*	1 x Dim D	
S	Tube wall thickness	0.8 (0.032)	
D	Tubing diameter	6.4 (0.25)	25.4 (1.00)
W	Plate width	50.8 (2.00)	307.8 (12.00)
X	Tube Extension	24.4 (1.00)	254.0 (10.00)

Aavid reserves the right to make changes to the products or information contained herein without notice. No liability is assumed as a result of their use or applications. For additional information, please contact Aavid directly.

X-ON Electronics

Largest Supplier of Electrical and Electronic Components

Click to view similar products for [Heat Sinks](#) category:

Click to view products by [Aavid](#) manufacturer:

Other Similar products are found below :

[581102B00000G](#) [656-15ABPE](#) [657-20ABPNE](#) [7020B-TC12-MTG](#) [73452PPBA](#) [7G0011A](#) [PF720G](#) [A22-4026](#) [HAH10L](#) [1542616-1](#) [HS-2506-F1](#) [HS-87M0-F2](#) [218-40CTE3](#) [231-69PAB-15V](#) [25-7520](#) [SW50-4G](#) [231-75PAB-13V](#) [231-75PAB-15V](#) [253-122ABE-22](#) [PSC22CB](#) [CLP212SG](#) [CLP-7701G](#) [HAA083](#) [HAF10L](#) [HAQ10T](#) [D10100-28](#) [TO5-002D](#) [BDN183CBA01](#) [3-21053-4](#) [32438](#) [TX0506-1B](#) [TX1806B](#) [LAE66A3CB](#) [WA-DT2-101E](#) [511-3U](#) [73381PPBA](#) [73403PPBA](#) [7G0047C](#) [COMX-440-HSP](#) [510-12M](#) [D10650-40T5](#) [V8511 Y](#) [APF40-40-13CB/A01](#) [780653U04500G](#) [ATS-54310K-C2-R0](#) [FK 216 CB SA](#) [FK 231 SA 220](#) [648-51AB](#) [657-20ABPESC](#) [2341BG](#)