

Board Level Cooling – High Power Extruded 5320



BOARD LEVEL COOLING – High Power Extruded 5320

High Power Extruded 5320 is a series of dual radial board level heat sinks designed to cool TO-220 and TO-220-single gauge devices. Representative image only.

ORDERING INFORMATION

| Part Number | Device Type |
|---------------|-----------------------------|
| 532602B00000G | TO-220 |
| 532602B02500G | TO-220, TO-220-single gauge |
| 532702B02500G | TO-220, TO-220-single gauge |
| 532802B00000G | TO-220, TO-220-single gauge |
| 532802B02500G | TO-220, TO-220-single gauge |



HEAT SINK DETAILS

| Property | Details |
|----------------------------|-----------------------|
| Material | Aluminum |
| Finish | Black Anodize |
| Device Attachment Options | Requires Mounting Kit |
| Thermal Interface Material | - |

| Property | Details |
|------------------------------|-------------------|
| Heat Sink Width (mm) | 41.91 |
| Heat Sink Length (mm) | 25.40 |
| Heat Sink Height (mm) | See "H" Dim below |
| Heat Sink Mounting Direction | Vertical |

MECHANICAL & PERFORMANCE

Drawing dimensions are shown in mm, (in)

| Part Number | "H" Dim | "X" Dim | "Y" Dim | "Z" Dim |
|---------------|---------|---------------|--------------|--------------|
| 532602B00000G | 38.10 | 12.70 (0.50) | 0.79 (0.031) | 2.67 (0.105) |
| 532602B02500G | 38.10 | 12.70 (0.50) | - | 2.67 (0.105) |
| 532702B02500G | 50.80 | 12.65 (0.498) | - | 2.67 (0.105) |
| 532802B00000G | 63.50 | 12.70 (0.50) | 0.79 (0.031) | 2.67 (0.105) |
| 532802B02500G | 63.50 | 12.70 (0.50) | - | 2.67 (0.105) |

Part Numbers: 532602B00000G and 532802B00000G

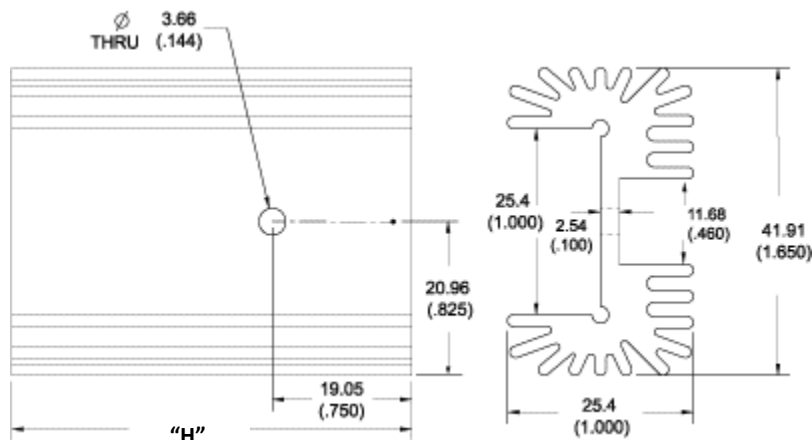

Board Level Cooling – High Power Extruded 5320

Part Numbers: 532602B02500G,
532702B02500G, 532802B02500G

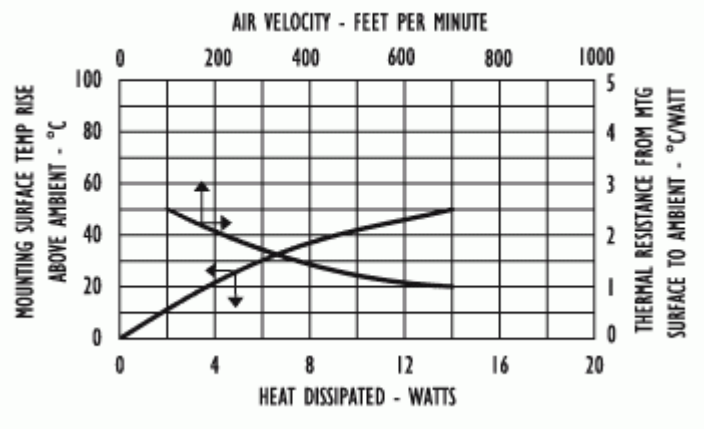
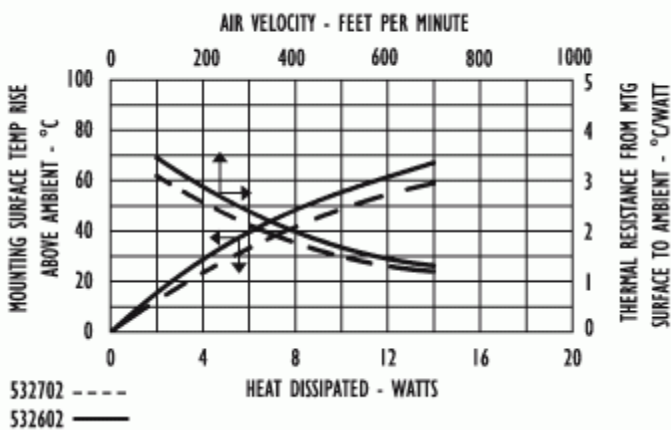
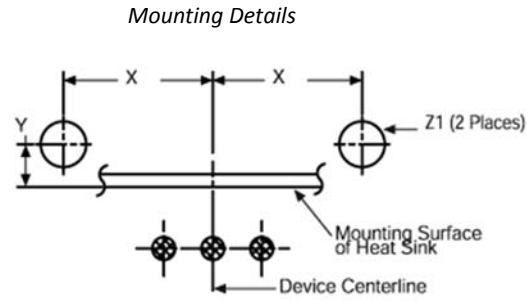
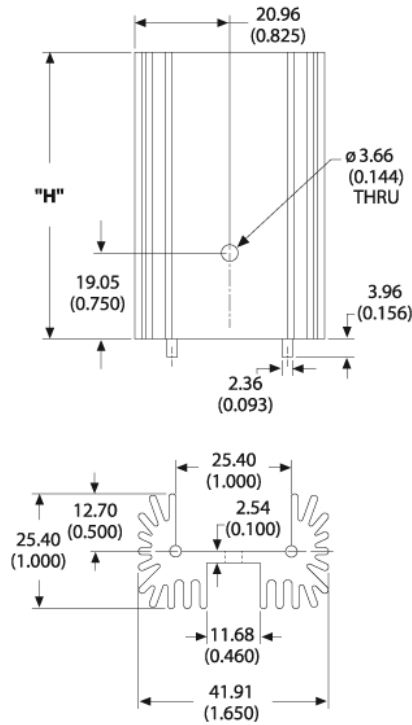

X-ON Electronics

Largest Supplier of Electrical and Electronic Components

Click to view similar products for [Heat Sinks](#) category:

Click to view products by [Aavid](#) manufacturer:

Other Similar products are found below :

[581102B00000G](#) [656-15ABPE](#) [657-20ABPNE](#) [7020B-TC12-MTG](#) [73452PPBA](#) [7G0011A](#) [PF720G](#) [A22-4026](#) [HAH10L](#) [HF20](#) [1542616-1](#)
[HS-2506-F1](#) [HS-87M0-F2](#) [218-40CTE3](#) [25-7520](#) [SW50-4G](#) [253-122ABE-22](#) [PSC22CB](#) [CLP212SG](#) [CLP-7701G](#) [HAA083](#) [HAF10L](#)
[HAQ10T](#) [D10100-28](#) [TO5-002D](#) [BDN183CBA01](#) [3-21053-4](#) [32438](#) [TX0506-1B](#) [TX1806B](#) [LAE66A3CB](#) [WA-DT2-101E](#) [511-3U](#)
[73381PPBA](#) [73403PPBA](#) [7G0047C](#) [COMX-440-HSP](#) [510-12M](#) [D10650-40T5](#) [V8511 Y](#) [APF40-40-13CB/A01](#) [780653U04500G](#) [ATS-](#)
[54310K-C2-R0](#) [FK 216 CB SA](#) [FK 231 SA 220](#) [648-51AB](#) [657-20ABPESC](#) [2341BG](#) [679-25AG](#) [FK225 SA L1](#)