

Board Level Cooling – High Power Extruded 5320



BOARD LEVEL COOLING – High Power Extruded 5320

High Power Extruded 5320 is a series of dual radial board level heat sinks designed to cool TO-220 and TO-220-single gauge devices. Representative image only.

ORDERING INFORMATION

Part Number	Device Type
532602B00000G	TO-220
532602B02500G	TO-220, TO-220-single gauge
532702B02500G	TO-220, TO-220-single gauge
532802B00000G	TO-220, TO-220-single gauge
532802B02500G	TO-220, TO-220-single gauge



HEAT SINK DETAILS

Property	Details
Material	Aluminum
Finish	Black Anodize
Device Attachment Options	Requires Mounting Kit
Thermal Interface Material	-

Property	Details
Heat Sink Width (mm)	41.91
Heat Sink Length (mm)	25.40
Heat Sink Height (mm)	See "H" Dim below
Heat Sink Mounting Direction	Vertical

MECHANICAL & PERFORMANCE

Drawing dimensions are shown in mm, (in)

Part Number	"H" Dim	"X" Dim	"Y" Dim	"Z" Dim
532602B00000G	38.10	12.70 (0.50)	0.79 (0.031)	2.67 (0.105)
532602B02500G	38.10	12.70 (0.50)	-	2.67 (0.105)
532702B02500G	50.80	12.65 (0.498)	-	2.67 (0.105)
532802B00000G	63.50	12.70 (0.50)	0.79 (0.031)	2.67 (0.105)
532802B02500G	63.50	12.70 (0.50)	-	2.67 (0.105)

Part Numbers: 532602B00000G and 532802B00000G

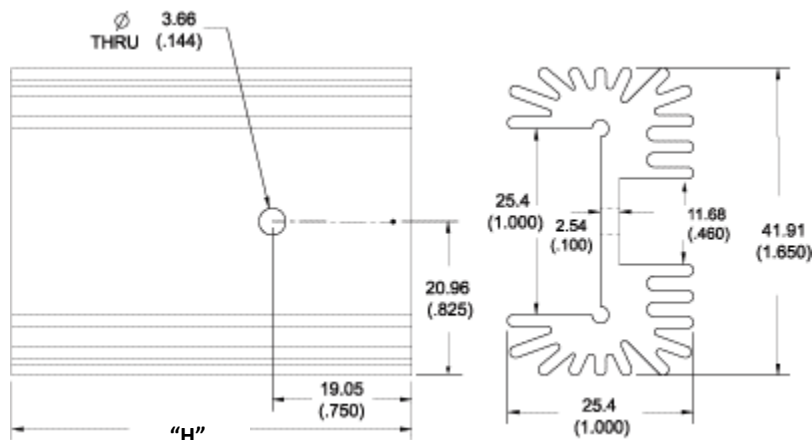

Board Level Cooling – High Power Extruded 5320

Part Numbers: 532602B02500G,
532702B02500G, 532802B02500G

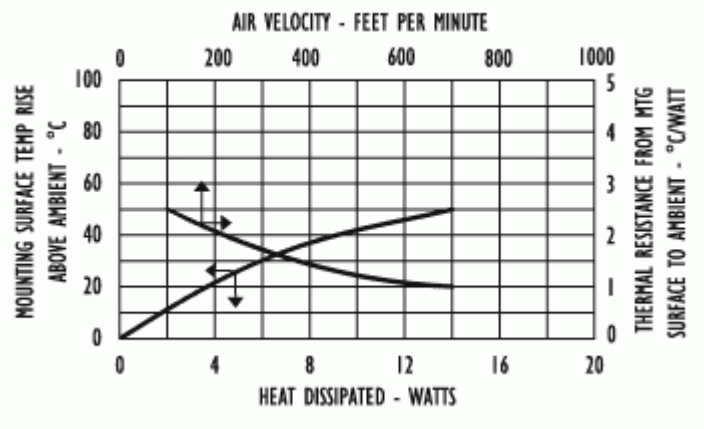
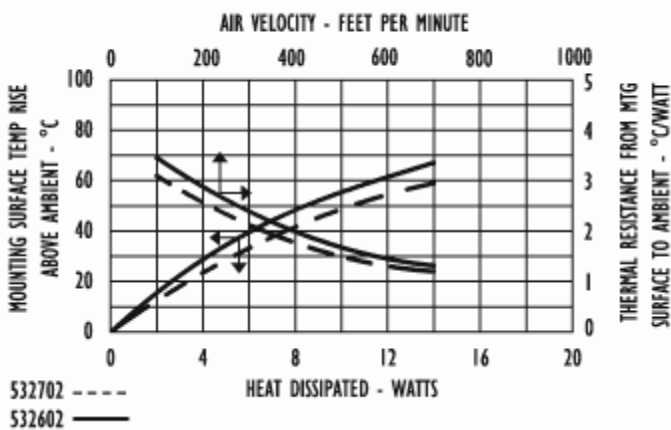
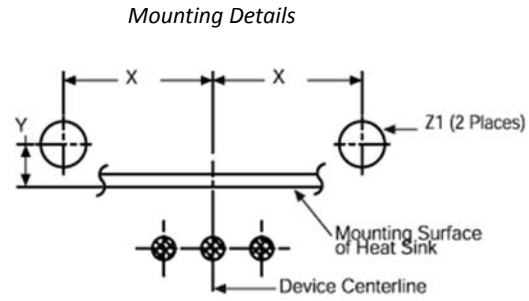
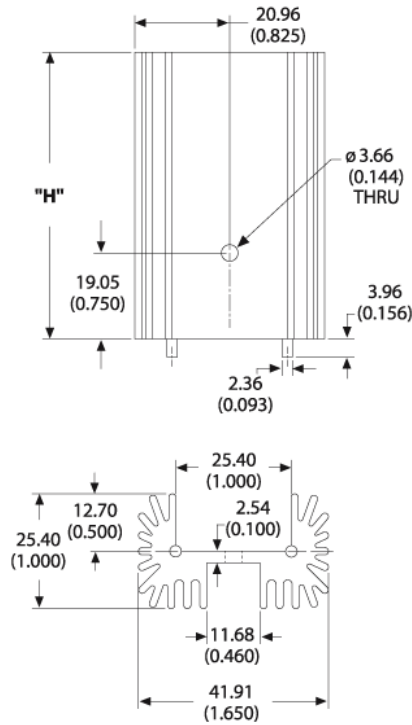

X-ON Electronics

Largest Supplier of Electrical and Electronic Components

Click to view similar products for [Heat Sinks](#) category:

Click to view products by [Aavid](#) manufacturer:

Other Similar products are found below :

[581102B00000G](#) [630-35ABT3](#) [656-15ABPE](#) [657-20ABPNE](#) [73452PPBA](#) [7721-13NG](#) [7G0011A](#) [FI306/SE](#) [PF720G](#) [A22-4026](#) [120-1873-007](#) [HAH10L](#) [1542256-2](#) [1542026-1](#) [1542616-1](#) [HS-2506-F1](#) [HS-87M0-F2](#) [218-40CTE3](#) [25-7520](#) [188854F00000G](#) [F-QB-F1](#) [APA501-60-003](#) [253-122ABE-22](#) [PSC22CB](#) [CLP-201](#) [CLP212SG](#) [CLP-7701G](#) [HAA072](#) [HAA083](#) [HAF10L](#) [HAQ10T](#) [D10100-28](#) [TO5-002D](#) [513101B02500G](#) [BDN183CBA01](#) [531202B0000](#) [HS-56M0-C1](#) [3-21053-4](#) [TX0506-1B](#) [TX1806B](#) [336614B-00000](#) [V2004X](#) [LAE66A3CB](#) [WA-DT2-101E](#) [511-3U](#) [017177](#) [530510B00000G](#) [6110BG](#) [73381PPBA](#) [73403PPBA](#)