



BOARD LEVEL COOLING – Channel 6030

Channel 6030 is a series of channel board level heat sinks designed to cool TO-220 and TO-220-single gauge devices. Representative image only



ORDERING INFORMATION

Part Number	Device Type
6030D(COPPER)G	TO-220, TO-220-single gauge
6030B-TTG	TO-220, TO-220-single gauge

HEAT SINK DETAILS

Property	Details
Material	Copper
Finish	Tin Plated, Black Paint
Device Attachment Options	Requires Mounting Kit
Thermal Interface Material	-

Property	Details
Heat Sink Width (mm)	25.40
Heat Sink Length (mm)	12.70
Heat Sink Height (mm)	29.97
Heat Sink Mounting Direction	Vertical

MECHANICAL & PERFORMANCE

Drawing dimensions are shown in mm, (in)

Part Number	"X" Dim	"Y" Dim	"Z" Dim
6030D(COPPER)G	12.07 (0.475)	8.26 (0.325)	0.64 (0.025)
6030B-TTG	8.89 (0.350)	0.64 (0.025)	2.54 (0.100)

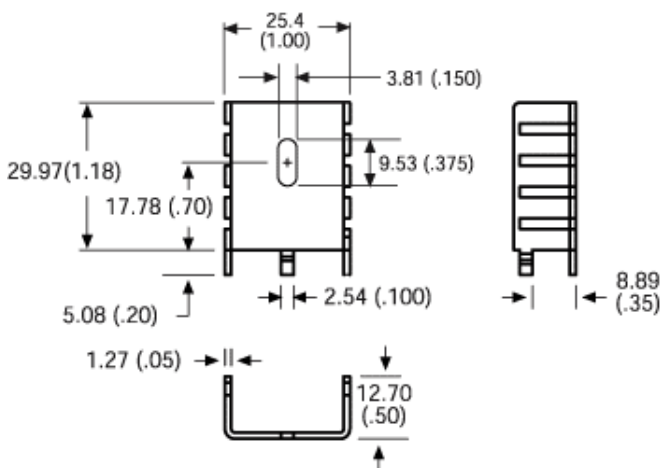

Mounting Details:

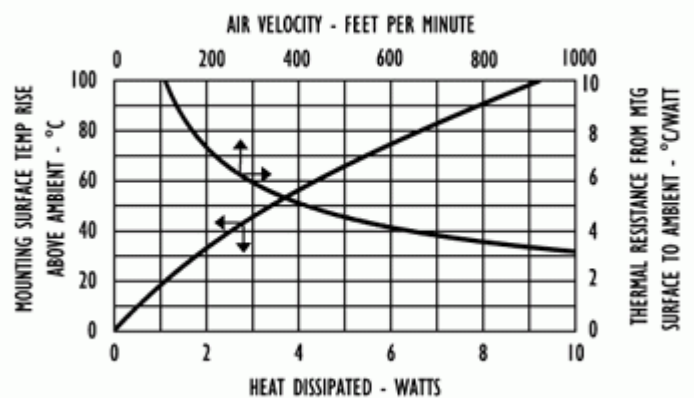
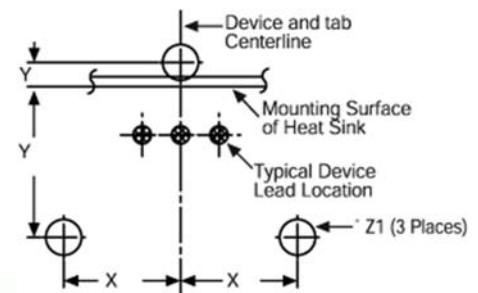

X-ON Electronics

Largest Supplier of Electrical and Electronic Components

Click to view similar products for [Adafruit Accessories](#) category:

Click to view products by [Aavid manufacturer](#):

Other Similar products are found below :

[3015](#) [3209](#) [2998](#) [3561](#) [2974](#) [3182](#) [3290](#) [2755](#) [3560](#) [3562](#) [2503](#) [3011](#) [3597](#) [3048](#) [2776](#) [3299](#) [2973](#) [2922](#) [2868](#) [2958](#) [2860](#) [2836](#) [2686](#)
[2968](#) [2972](#) [2969](#) [2871](#) [2851](#) [2873](#) [2895](#) [3610](#) [2939](#) [3568](#) [2869](#) [2866](#) [3551](#) [2858](#) [2855](#) [3590](#) [3447](#) [3353](#) [2744](#) [3585](#) [3584](#) [3552](#) [3484](#)
[2865](#) [2782](#) [3577](#) [FLUKE FL-45 EX](#)