

# ML9

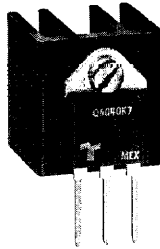

Model  $R_{\theta}$  ( $^{\circ}\text{C}/\text{W}$ )  
ML9-----13.2



AIR VELOCITY  
m/sec 0 1.0 2.0 3.0 4.0 5.0  
ft/min 0 200 400 600 800 1000

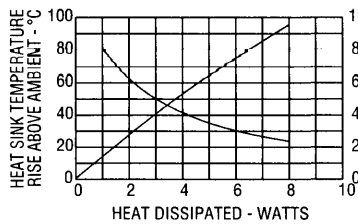

THERMAL RESISTANCE FROM  
HEAT SINK TO AMBIENT -  $^{\circ}\text{C}/\text{WATT}$

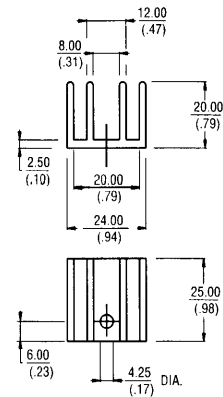

# 6296/6300 Series, ML 97 Series



Model	Dim. A mm (inches)	Dim. B mm (inches)	Dim. C mm (inches)	$R_{\theta}$ ( $^{\circ}\text{C}/\text{W}$ )	Notes
6296B	-- 25.40 (1.000)	-- 21.59 (.850)	-- 3.81 (.150)	-- 4.7	▲
6298B	-- 38.10 (1.500)	-- 21.59 (.850)	-- 3.81 (.150)	-- 3.9	▲
ML97/1	-- 38.10 (1.500)	-- 21.59 (.850)	-- 3.60 (.142)	-- 3.9	○
6299B	-- 50.80 (2.000)	-- 21.59 (.850)	-- 3.81 (.150)	-- 3.6	▲
ML97/1.5	-- 50.80 (2.000)	-- 21.59 (.850)	-- 3.60 (.142)	-- 3.6	○
6300B	-- 63.50 (2.500)	-- 21.59 (.850)	-- 3.81 (.150)	-- 3.1	▲
ML97/2	-- 63.50 (2.500)	-- 21.59 (.850)	-- 3.60 (.142)	-- 3.1	○

Model	Dim. A mm (inches)	Dim. B mm (inches)	Dim. C mm (inches)	$R_{\theta}$ ( $^{\circ}\text{C}/\text{W}$ )
6298B-2*	-- 38.10 (1.500)	-- 18.29 (.720)	--- 3.81 (.150)	--- 3.9
6299B-2*	-- 50.80 (2.000)	-- 18.29 (.720)	--- 3.81 (.150)	--- 3.6
6300B-2*	-- 63.50 (2.500)	-- 18.29 (.720)	--- 3.81 (.150)	--- 3.1

\* Available, but not normally stocked.

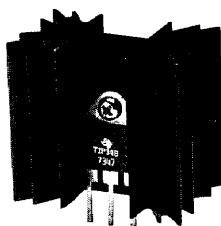

▲ 6298B

AIR VELOCITY  
m/sec 0 1.0 2.0 3.0 4.0 5.0  
ft/min 0 200 400 600 800 1000

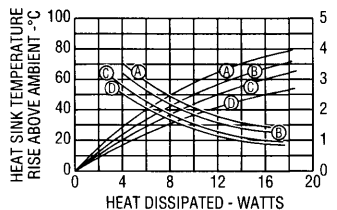

▲ 6296B B 6298B C 6299B D 6300B  
○ ML97/1 ML97/1.5 ML97/2

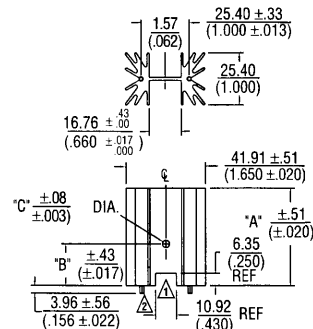

Notes: To order optional solderable roll pin with shoulder for the 6296 Series, add "P2" after model number, e.g. 6298B-P2. Shoulder is  $1.27 + .38/- .13$  ( $.050 + .015/- .005$ ) thick. These parts are also available without roll pins: 6292B is 38.10mm (1.5") tall without roll pins, 6293B is 50.80mm (2.0") tall without roll pins, and 6294B is 63.50mm (2.5") tall without roll pins. Tolerances are  $\pm .25$  (.010) unless otherwise specified. The Productivity Enhancements shown in the circles above are for use with the 6296 Series only.

- ▲ 6.35 (.250) x 10.92 (.430) notch on these parts only.
- ▲ Solderable roll pin (P1) standard as shown.

# ML33



Model  $R_{\theta}$  ( $^{\circ}\text{C}/\text{W}$ )  
ML33-----8.5

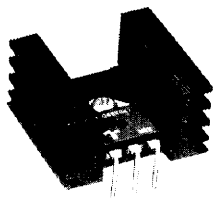

AIR VELOCITY  
m/sec 0 1.0 2.0 3.0 4.0 5.0  
ft/min 0 200 400 600 800 1000

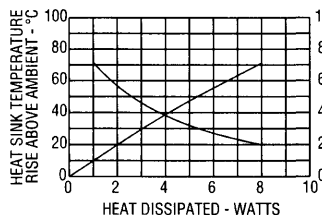

THERMAL RESISTANCE FROM  
HEAT SINK TO AMBIENT -  $^{\circ}\text{C}/\text{WATT}$

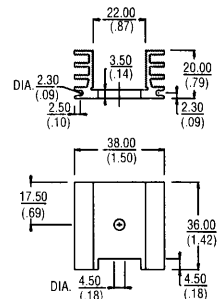

▲ B34

## X-ON Electronics

Largest Supplier of Electrical and Electronic Components

*Click to view similar products for [Heat Sinks](#) category:*

*Click to view products by [Aavid](#) manufacturer:*

Other Similar products are found below :

[581102B00000G](#) [630-35ABT3](#) [656-15ABPE](#) [657-20ABPNE](#) [7020B-TC12-MTG](#) [73452PPBA](#) [7721-13NG](#) [7G0011A](#) [FI306/SE](#) [PF720G](#)  
[A22-4026](#) [120-1873-007](#) [HAH10L](#) [HF20](#) [1542256-2](#) [1542026-1](#) [1542616-1](#) [HS-2506-F1](#) [HS-87M0-F2](#) [218-40CTE3](#) [25-7520](#)  
[188854F00000G](#) [F-QB-F1](#) [APA501-60-003](#) [253-122ABE-22](#) [PSC22CB](#) [CLP-201](#) [CLP212SG](#) [CLP-7701G](#) [HAA072](#) [HAA083](#) [HAF10L](#)  
[HAQ10T](#) [D10100-28](#) [TO5-002D](#) [513101B02500G](#) [BDN183CBA01](#) [531202B0000](#) [HS-56M0-C1](#) [3-21053-4](#) [TX0506-1B](#) [TX1806B](#)  
[336614B-00000](#) [V2004X](#) [LAE66A3CB](#) [WA-DT2-101E](#) [511-3U](#) [017177](#) [530510B00000G](#) [6110BG](#)