



# 5SDF 63X0400

## High Frequency Welding Diode

### Properties

- High forward current capability
- Low forward and reverse recovery losses
- High operational reliability

### Applications

- Welding equipment
- High current application up to 10 kHz

### Key Parameters

$V_{RRM}$	=	400	V
$I_{FAVm}$	=	6 266	A
$I_{FSM}$	=	44 000	A
$V_{TO}$	=	0.962	V
$r_T$	=	0.036	m $\Omega$

### Types

	$V_{RRM}$
<b>5SDF 63X0400</b>	<b>400 V</b>
Conditions:	$T_j = -40 \div 190 \text{ }^\circ\text{C}$ , half sine waveform, $f = 50 \text{ Hz}$

### Mechanical Data

$F_m$	Mounting force	$22 \pm 2 \text{ kN}$
$m$	Weight	0.14 kg
$D_s$	Surface creepage distance	4 mm
$D_a$	Air strike distance	4 mm

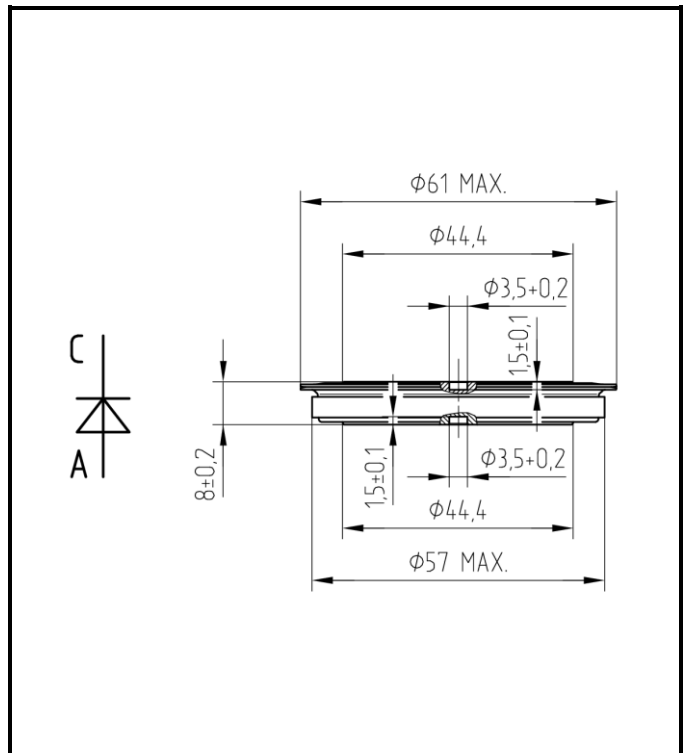

Fig. 1 Case



ABB s.r.o.

Novodvorska 1768/138a, 142 21 Praha 4, Czech Republic

tel.: +420 261 306 250, <http://www.abb.com/semiconductors>

<b>Maximum Ratings</b>			<b>Maximum Limits</b>	<b>Unit</b>
$V_{RRM}$	<b>Repetitive peak reverse voltage</b> $T_j = -40 \div 190 \text{ }^\circ\text{C}$		<b>400</b>	<b>V</b>
$I_{FAVm}$	<b>Average forward current</b>	$T_c = 85 \text{ }^\circ\text{C}$	<b>6 266</b>	<b>A</b>
		$T_c = 110 \text{ }^\circ\text{C}$	<b>5 120</b>	
$I_{FRMS}$	<b>RMS forward current</b>	$T_c = 85 \text{ }^\circ\text{C}$	<b>9 843</b>	<b>A</b>
		$T_c = 110 \text{ }^\circ\text{C}$	<b>8 042</b>	
$I_{RRM}$	<b>Repetitive reverse current</b> $V_R = V_{RRM}$		<b>200</b>	<b>mA</b>
$I_{FSM}$	<b>Non repetitive peak surge current</b> $V_R = 0 \text{ V}$ , half sine pulse	$t_p = 8.3 \text{ ms}$	<b>47 000</b>	<b>A</b>
		$t_p = 10 \text{ ms}$	<b>44 000</b>	
$\int I^2 dt$	<b>Limiting load integral</b> $V_R = 0 \text{ V}$ , half sine pulse	$t_p = 8.3 \text{ ms}$	<b>9 168 000</b>	<b>A<sup>2</sup>s</b>
		$t_p = 10 \text{ ms}$	<b>9 680 000</b>	
$T_{jmin} - T_{jmax}$	<b>Operating temperature range</b>		<b>- 40 ÷ 190</b>	<b>°C</b>
$T_{stgmin} - T_{stgmax}$	<b>Storage temperature range</b>		<b>- 40 ÷ 190</b>	

Unless otherwise specified  $T_j = 190 \text{ }^\circ\text{C}$

<b>Characteristics</b>		<b>Value</b>			<b>Unit</b>
		<i>min</i>	<i>typ</i>	<i>max</i>	
$V_{T0}$	<b>Threshold voltage</b>			<b>0.962</b>	<b>V</b>
$r_T$	<b>Forward slope resistance</b> $I_{F1} = 5\,000 \text{ A}$ , $I_{F2} = 15\,000 \text{ A}$			<b>0.036</b>	<b>mΩ</b>
$V_{FM}$	<b>Maximum forward voltage</b> $I_{FM} = 5\,000 \text{ A}$			<b>1.140</b>	<b>V</b>
$Q_{rr}$	<b>Recovered charge</b> $I_{FM} = 2\,000 \text{ A}$ , $di/dt = -30 \text{ A}/\mu\text{s}$ , $V_R = 50 \text{ V}$			<b>180</b>	<b>μC</b>

Unless otherwise specified  $T_j = 190 \text{ }^\circ\text{C}$

Thermal Parameters			Value	Unit
$R_{thjc}$	Thermal resistance junction to case	double side cooling	10	K/kW
		single side cooling	20	
$R_{thch}$	Thermal resistance case to heatsink	double side cooling	5	K/kW
		single side cooling	10	

**Transient Thermal Impedance**

Analytical function for transient thermal impedance

$$Z_{thjc} = \sum_{i=1}^4 R_i (1 - \exp(-t / \tau_i))$$

Conditions:  
 $F_m = 22 \pm 2$  kN, Double side cooled

Correction for periodic waveforms

180° sine:	1.0 K/kW
180° rectangular:	0.9 K/kW
120° rectangular:	1.4 K/kW
60° rectangular:	2.3 K/kW

$i$	1	2	3	4
$\tau_i$ (s)	0.2900	0.1400	0.0270	0.0011
$R_i$ (K/kW)	2.3300	4.8000	2.0000	0.8700

Fig. 2 Dependence transient thermal impedance junction to case on square pulse

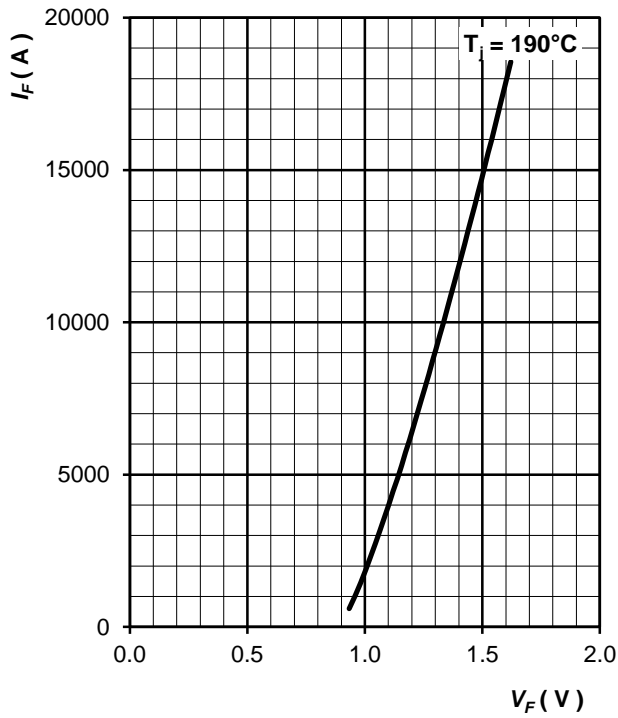

Fig. 3 Maximum forward voltage drop characteristics

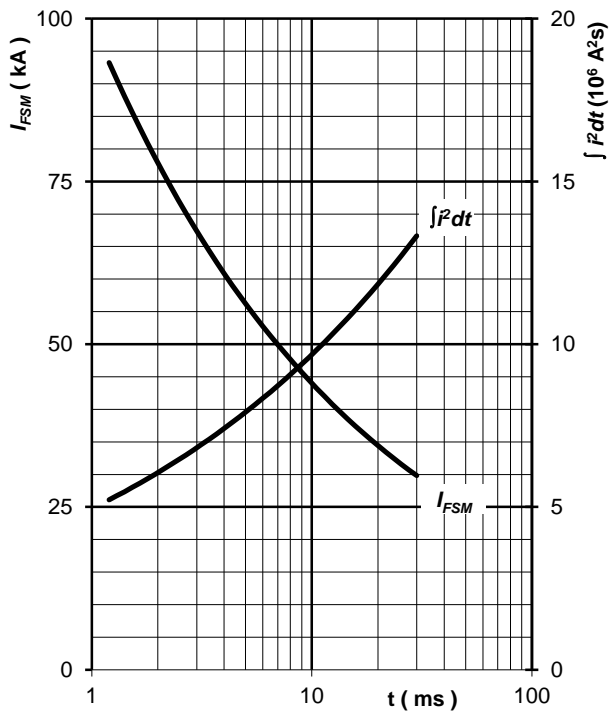

Fig. 4 Surge forward current vs. pulse length, half sine wave, single pulse,  $V_R = 0 \text{ V}$ ,  $T_j = T_{jmax}$

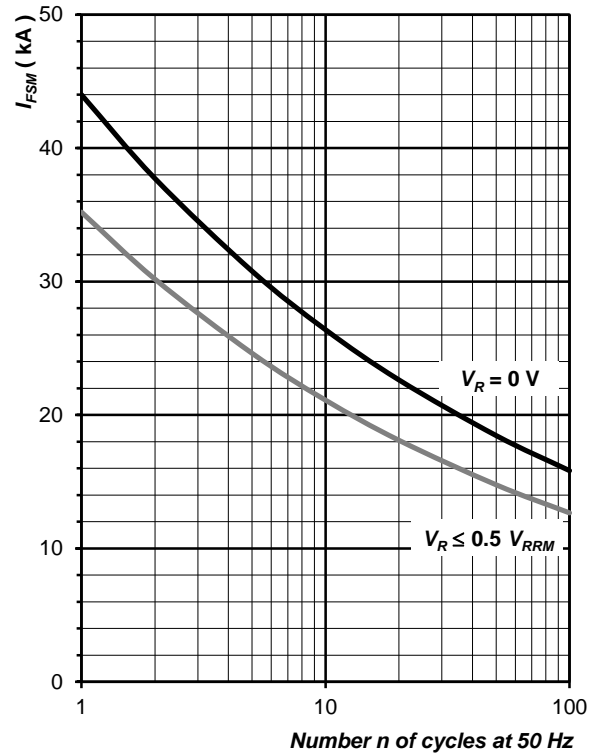

Fig. 5 Surge forward current vs. number of pulses, half sine wave,  $T_j = T_{jmax}$

ABB s.r.o., Novodvorska 1768/138a, 142 21 Praha 4, Czech Republic

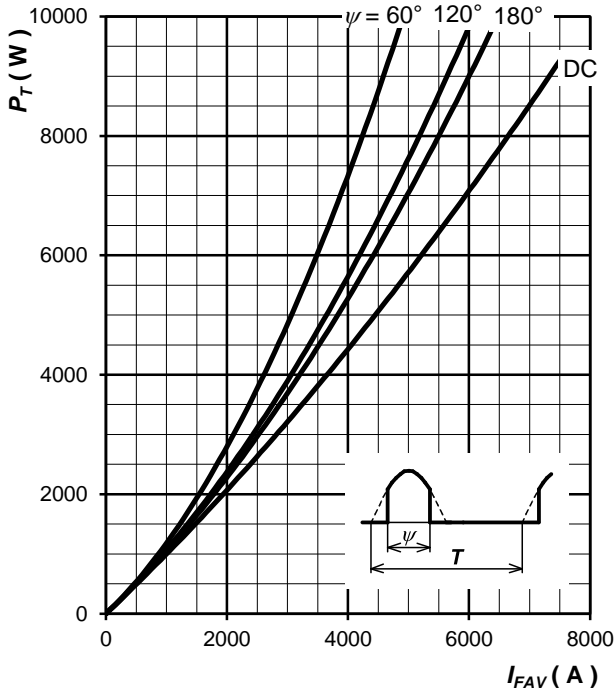

Fig. 6 Forward power loss vs. average forward current, sine waveform,  $f = 50 \text{ Hz}$ ,  $T = 1/f$

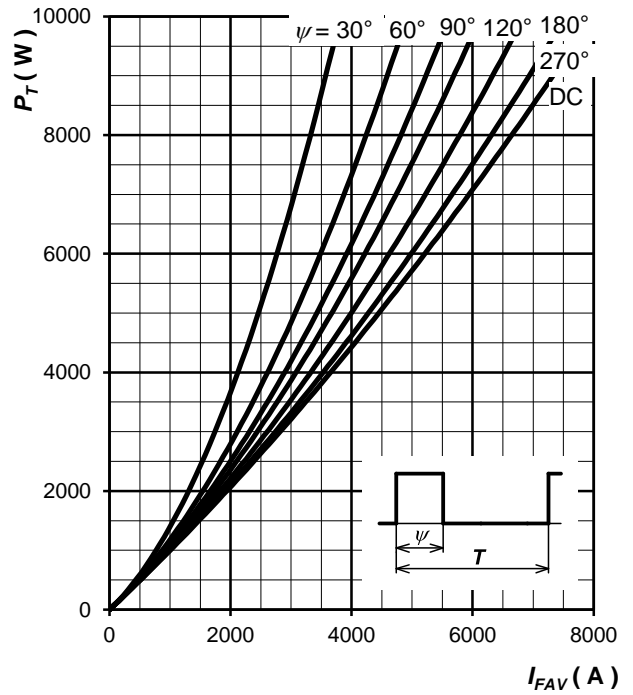

Fig. 7 Forward power loss vs. average forward current, square waveform,  $f = 50 \text{ Hz}$ ,  $T = 1/f$

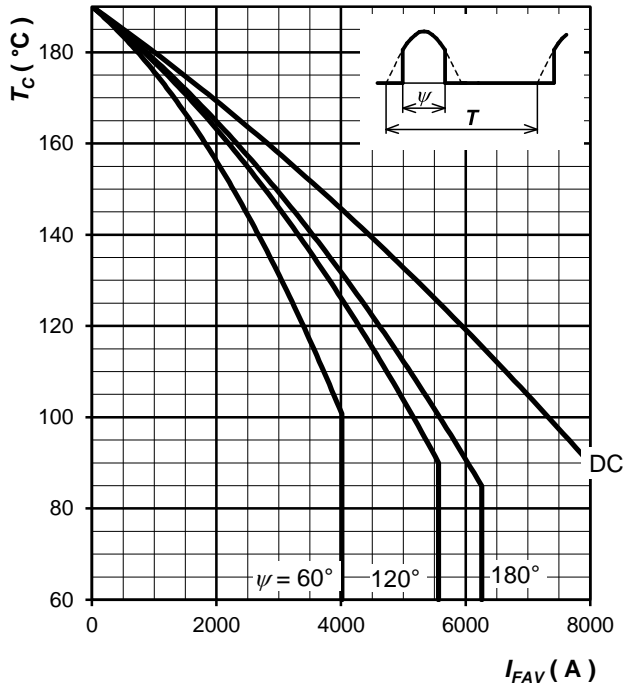

Fig. 8 Max. case temperature vs. aver. forward current, sine waveform,  $f = 50 \text{ Hz}$ ,  $T = 1/f$

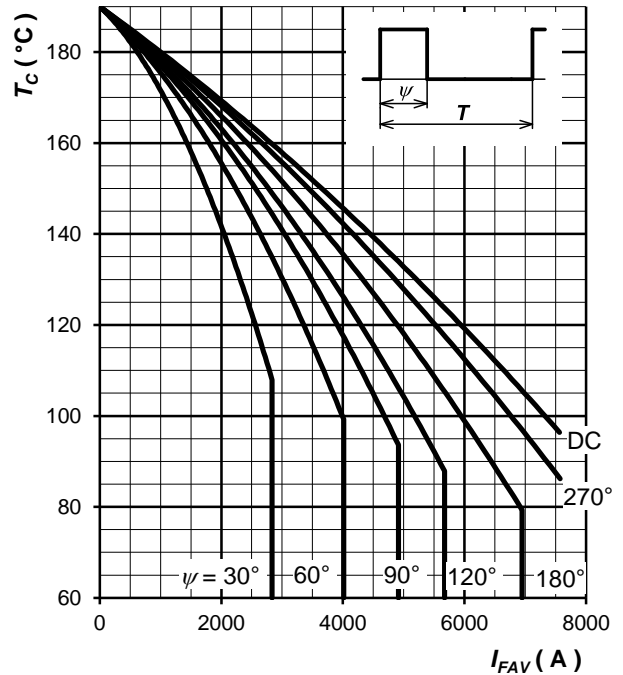

Fig. 9 Max. case temperature vs. aver. forward current, square waveform,  $f = 50 \text{ Hz}$ ,  $T = 1/f$

Note 2: Figures number 6 ÷ 9 have been calculated without considering any forward and reverse recovery losses. They are valid for  $f = 50$  or  $60 \text{ Hz}$  operation.

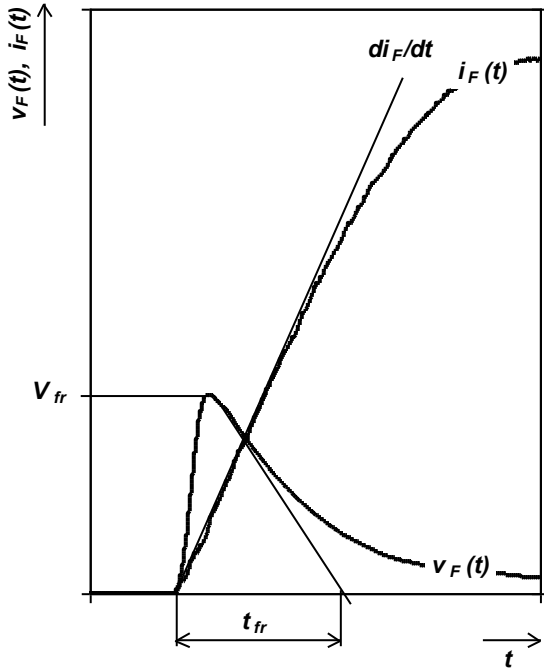

Fig. 10 Typical forward recovery voltage waveform when the diode is turned on with high  $di_F/dt$

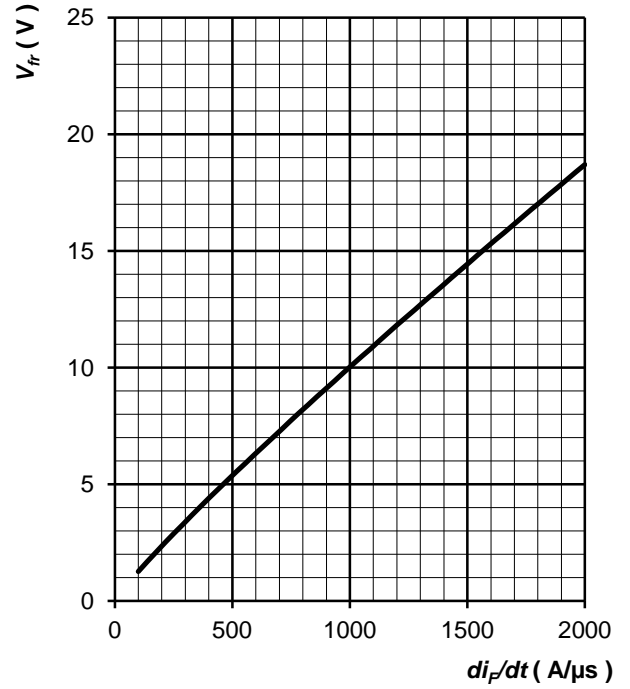

Fig. 11 Max. forward recovery voltage vs. rate of rise forward current, trapezoid pulse,  $T_j = T_{jmax}$ ,  $t_{fr} \leq 10 \mu s$

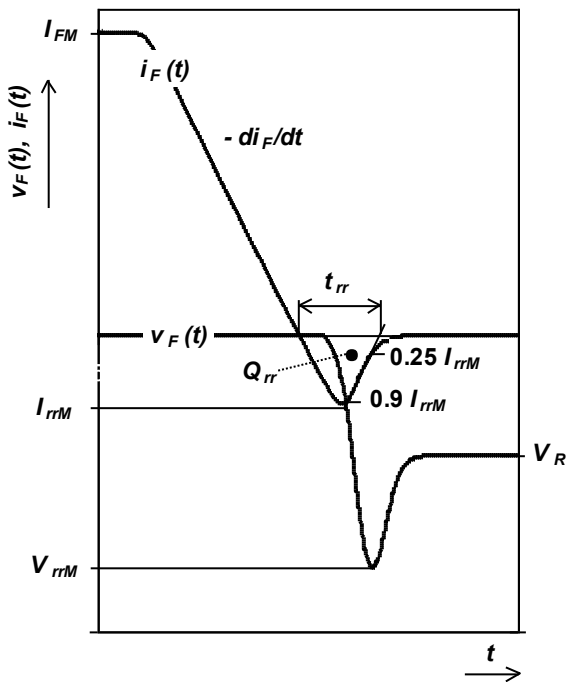

Fig. 12 Definition of reverse recovery parameters

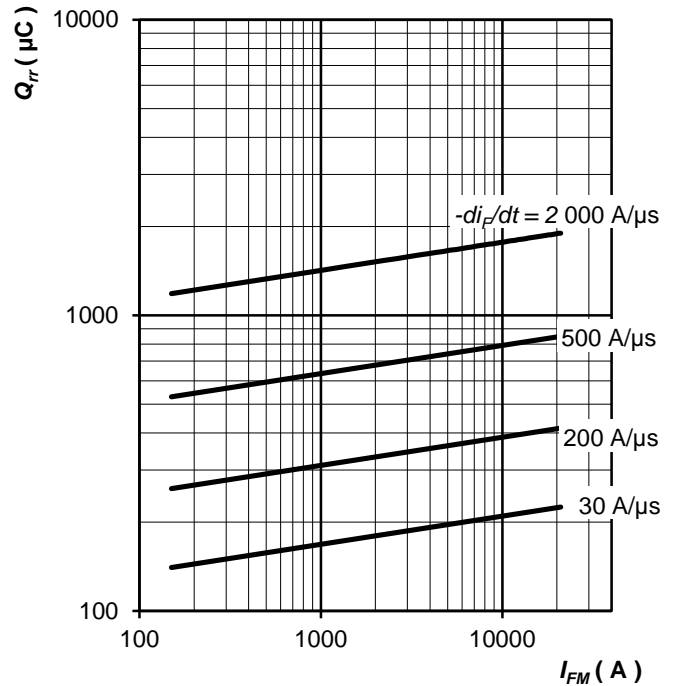

Fig. 13 Max. recovered charge vs. forward current, trapezoid pulse,  $T_j = T_{jmax}$

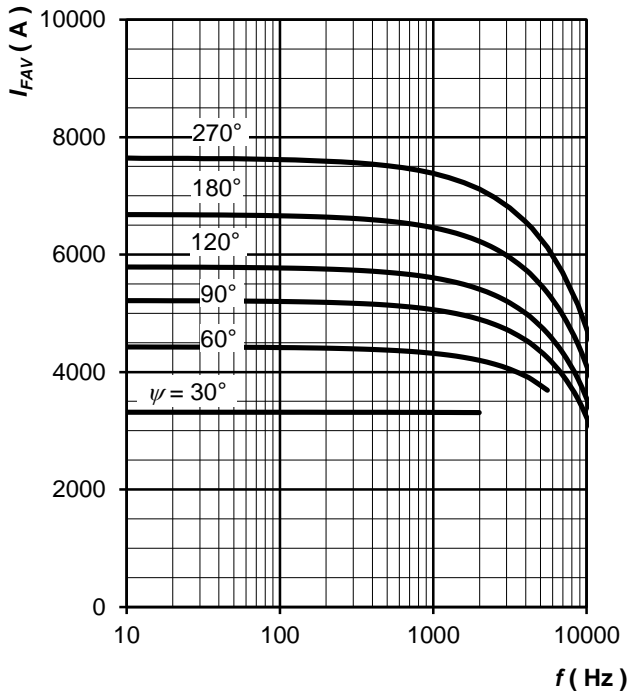

Fig. 14 Average forward current vs. frequency, trapezoid waveform,  $T_C = 85^\circ\text{C}$ ,  $di_F/dt = \pm 2\,000\text{ A}/\mu\text{s}$ ,  $V_R = 50\text{ V}$

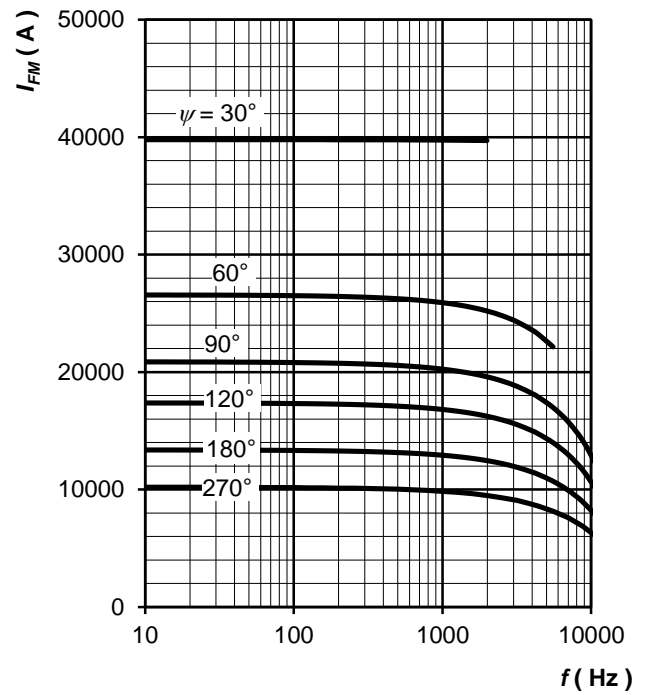

Fig. 15 Maximum forward current vs. frequency, trapezoid waveform,  $T_C = 85^\circ\text{C}$ ,  $di_F/dt = \pm 2\,000\text{ A}/\mu\text{s}$ ,  $V_R = 50\text{ V}$

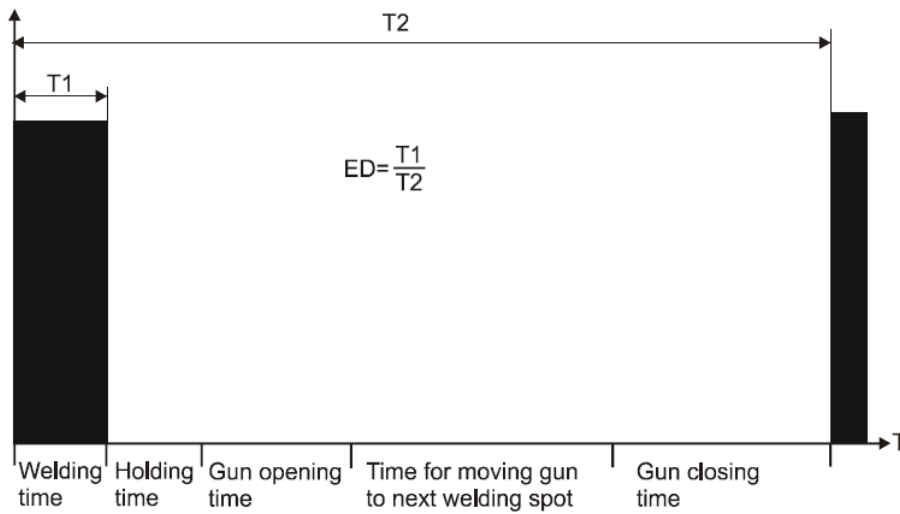

Fig. 16 Definition of ED for typical welding sequence

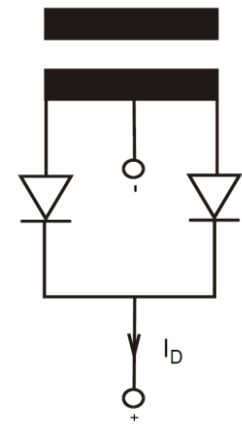

Fig. 17 Definition of  $I_D$  for single-phase centre tap

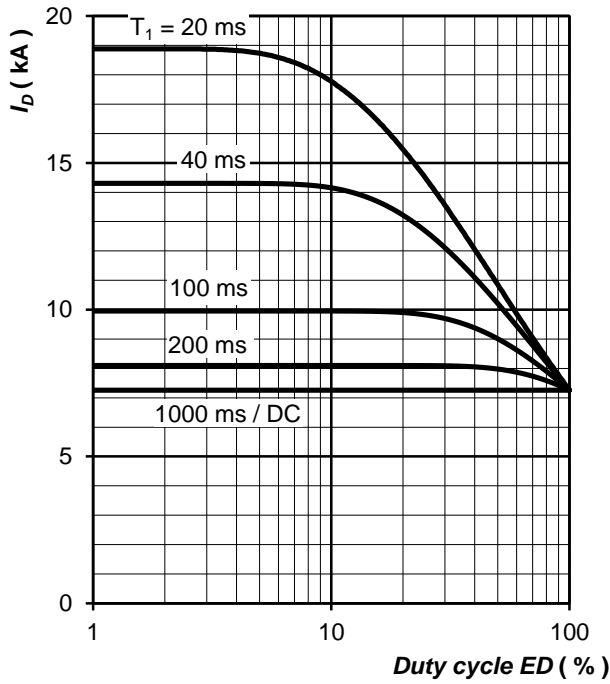

Fig. 18 Current load capacity, cont.,  
DC output welding current with single-phase  
centre tap vs. duty cycle  
 $f = 10 \text{ kHz}$ , square wave,  $\Delta T_j = 80 \text{ }^\circ\text{C}$

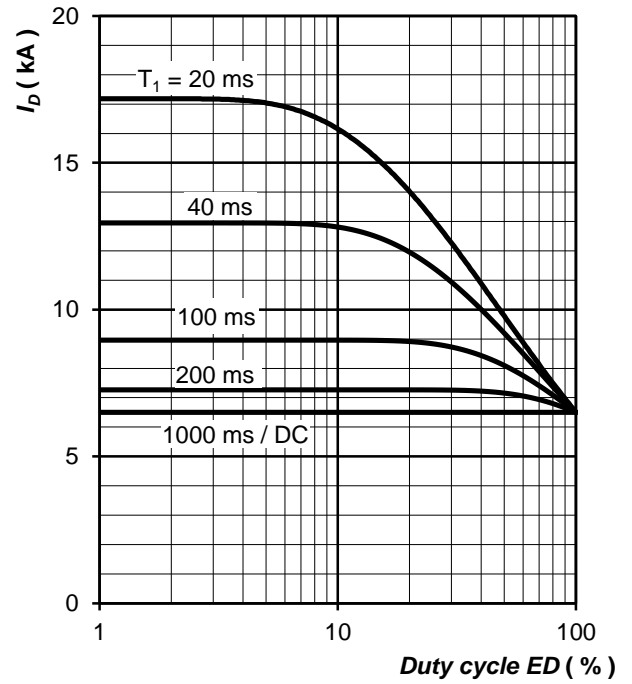

Fig. 19 Current load capacity, cont.,  
DC output welding current with single-phase  
centre tap vs. duty cycle  
 $f = 10 \text{ kHz}$ , square wave,  $\Delta T_j = 70 \text{ }^\circ\text{C}$

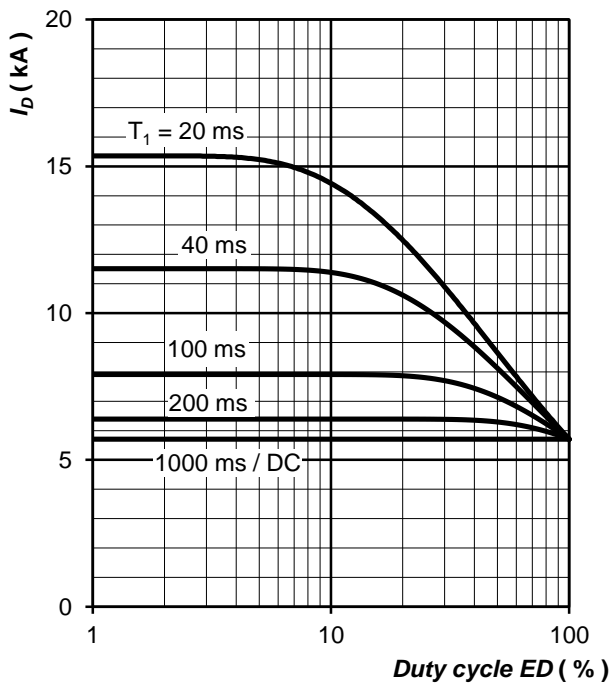

Fig. 20 Current load capacity, cont.,  
DC output welding current with single-phase  
centre tap vs. duty cycle  
 $f = 10 \text{ kHz}$ , square wave,  $\Delta T_j = 60 \text{ }^\circ\text{C}$

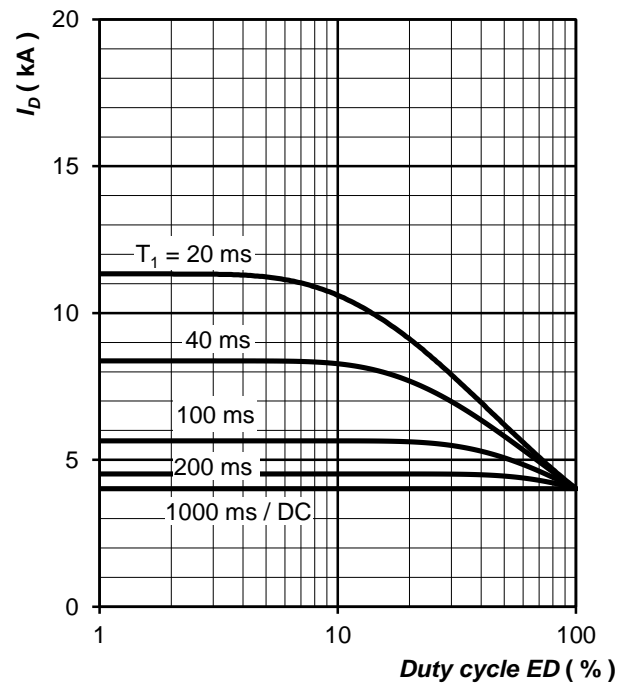

Fig. 21 Current load capacity, cont.,  
DC output welding current with single-phase  
centre tap vs. duty cycle  
 $f = 10 \text{ kHz}$ , square wave,  $\Delta T_j = 40 \text{ }^\circ\text{C}$

ABB s.r.o., Novodvorska 1768/138a, 142 21 Praha 4, Czech Republic



Notes:

ABB s.r.o., Novodvorska 1768/138a, 142 21 Praha 4, Czech Republic

## X-ON Electronics

Largest Supplier of Electrical and Electronic Components

*Click to view similar products for [Rectifiers](#) category:*

*Click to view products by [ABB](#) manufacturer:*

Other Similar products are found below :

[70HFR40](#) [RL252-TP](#) [1N5397](#) [NTE5841](#) [NTE6038](#) [SCF5000](#) [1N4002G](#) [1N4005-TR](#) [JANS1N6640US](#) [481235F](#) [RRE02VS6SGTR](#) [067907F](#)  
[MS306](#) [70HF40](#) [US2JFL-TP](#) [A1N5404G-G](#) [CRS04\(T5L,TEMQ\)](#) [ACGRA4007-HF](#) [ACGRB207-HF](#) [CLH03\(TE16L,Q\)](#) [ACGRC307-HF](#)  
[ACEFC304-HF](#) [NTE6356](#) [NTE6359](#) [NTE6002](#) [NTE6023](#) [NTE6039](#) [NTE6077](#) [85HFR60](#) [40HFR60](#) [1N1186RA](#) [70HF120](#) [85HFR80](#)  
[D126A45C](#) [SCF7500](#) [D251N08B](#) [SCHJ22.5K](#) [SM100](#) [SCPA2](#) [SDHD5K](#) [VS-12FL100S10](#) [ACGRA4001-HF](#) [D1821SH45T PR](#) [D1251S45T](#)  
[NTE5990](#) [NTE6358](#) [NTE6162](#) [NTE5850](#) [SKN20/08](#) [SKN300/16](#)