

Pilot devices Next generation pilot lights

Document ID 1SFC151054K0201 date March 2016



Taking ABB's compact pilot lights even further with the next generation design

Choosing an ABB compact pilot light means choosing the benefits of reliability, eco friendliness and optimized design. With the next generation of products, a new, more environmentally friendly polymer is used thus helping saving the natural resources. Additionally the protection against leakage current has been improved and the size has been reduced by 3 mm compared to the previous generation as the built-in depth has been optimized.

Similar to the rest of ABB's compact range, the new line of pilot lights has the highest IP ratings, both IP67 and IP69K, and is therefore functional in the toughest environments. These features combined make the new product offering very competitive on the global market.

Pilot light ordering



CL2-506R

CL2-506G



CL2-506Y

CL2-506L



CL2-506C

| Description | Rated current mA | Anti-inductive Voltage (Vpeak) | Wavelength nm | Illumination lx | Type | Order code | Pkg qty | Weight (1pc) Kg |
|--|------------------|--------------------------------|-----------------|-----------------|----------|-----------------|---------|-----------------|
| Rated voltage 6,3 V DC | | | | | | | | |
| Red | 16 | 2 | 625 | 70 | CL2-506R | 1SFA619403R5061 | 1x10 | 0,0185 |
| Green | 16 | 2 | 520 | 125 | CL2-506G | 1SFA619403R5062 | 1x10 | 0,0185 |
| Yellow | 16 | 2 | 590 | 75 | CL2-506Y | 1SFA619403R5063 | 1x10 | 0,0185 |
| Blue | 16 | 2 | 470 | 10 | CL2-506L | 1SFA619403R5064 | 1x10 | 0,0185 |
| Clear | 16 | 2 | (X=0.31,Y=0.32) | 290 | CL2-506C | 1SFA619403R5068 | 1x10 | 0,0185 |
| Rated voltage 12 V DC | | | | | | | | |
| Red | 16 | 2 | 625 | 110 | CL2-501R | 1SFA619403R5011 | 1x10 | 0,0185 |
| Green | 16 | 2.5 | 520 | 165 | CL2-501G | 1SFA619403R5012 | 1x10 | 0,0185 |
| Yellow | 16 | 2.5 | 590 | 85 | CL2-501Y | 1SFA619403R5013 | 1x10 | 0,0185 |
| Blue | 16 | 2.5 | 470 | 15 | CL2-501L | 1SFA619403R5014 | 1x10 | 0,0185 |
| Clear | 16 | 2.5 | (X=0.31,Y=0.32) | 320 | CL2-501C | 1SFA619403R5018 | 1x10 | 0,0185 |
| Rated voltage 24 V AC/DC | | | | | | | | |
| Red | 16 | 6 | 625 | 80 | CL2-502R | 1SFA619403R5021 | 1x10 | 0,0185 |
| Green | 16 | 6 | 520 | 135 | CL2-502G | 1SFA619403R5022 | 1x10 | 0,0185 |
| Yellow | 16 | 6 | 590 | 55 | CL2-502Y | 1SFA619403R5023 | 1x10 | 0,0185 |
| Blue | 16 | 6 | 470 | 10 | CL2-502L | 1SFA619403R5024 | 1x10 | 0,0185 |
| Clear | 16 | 6 | (X=0.31,Y=0.32) | 230 | CL2-502C | 1SFA619403R5028 | 1x10 | 0,0185 |
| Rated voltage 48-60 V AC/DC | | | | | | | | |
| Red | 13-17 | 7 | 625 | 75 | CL2-507R | 1SFA619403R5071 | 1x10 | 0,0185 |
| Green | 13-17 | 7 | 520 | 140 | CL2-507G | 1SFA619403R5072 | 1x10 | 0,0185 |
| Yellow | 13-17 | 7 | 590 | 80 | CL2-507Y | 1SFA619403R5073 | 1x10 | 0,0185 |
| Blue | 13-17 | 7 | 470 | 10 | CL2-507L | 1SFA619403R5074 | 1x10 | 0,0185 |
| Clear | 13-17 | 7 | (X=0.31,Y=0.32) | 260 | CL2-507C | 1SFA619403R5078 | 1x10 | 0,0185 |
| Rated voltage 110-130 V AC | | | | | | | | |
| Red | 15-17 | 20 | 625 | 85 | CL2-513R | 1SFA619403R5131 | 1x10 | 0,0185 |
| Green | 15-17 | 20 | 520 | 90 | CL2-513G | 1SFA619403R5132 | 1x10 | 0,0185 |
| Yellow | 15-17 | 20 | 590 | 85 | CL2-513Y | 1SFA619403R5133 | 1x10 | 0,0185 |
| Blue | 15-17 | 20 | 470 | 10 | CL2-513L | 1SFA619403R5134 | 1x10 | 0,0185 |
| Clear | 15-17 | 20 | (X=0.31,Y=0.32) | 340 | CL2-513C | 1SFA619403R5138 | 1x10 | 0,0185 |
| Rated voltage 110-130 V DC | | | | | | | | |
| Red | 8-9 | 20 | 625 | 55 | CL2-515R | 1SFA619403R5151 | 1x10 | 0,0185 |
| Green | 8-9 | 20 | 520 | 125 | CL2-515G | 1SFA619403R5152 | 1x10 | 0,0185 |
| Yellow | 8-9 | 20 | 590 | 50 | CL2-515Y | 1SFA619403R5153 | 1x10 | 0,0185 |
| Blue | 8-9 | 20 | 470 | 10 | CL2-515L | 1SFA619403R5154 | 1x10 | 0,0185 |
| Clear | 8-9 | 20 | (X=0.31,Y=0.32) | 210 | CL2-515C | 1SFA619403R5158 | 1x10 | 0,0185 |
| Rated voltage 220 V DC | | | | | | | | |
| Red | 6 | 20 | 625 | 40 | CL2-520R | 1SFA619403R5201 | 1x10 | 0,0185 |
| Green | 6 | 20 | 520 | 90 | CL2-520G | 1SFA619403R5202 | 1x10 | 0,0185 |
| Yellow | 6 | 20 | 590 | 30 | CL2-520Y | 1SFA619403R5203 | 1x10 | 0,0185 |
| Blue | 6 | 20 | 470 | 5 | CL2-520L | 1SFA619403R5204 | 1x10 | 0,0185 |
| Clear | 6 | 20 | (X=0.31,Y=0.32) | 120 | CL2-520C | 1SFA619403R5208 | 1x10 | 0,0185 |
| Rated voltage 230 V AC | | | | | | | | |
| Red | 17 | 30 | 625 | 95 | CL2-523R | 1SFA619403R5231 | 1x10 | 0,0185 |
| Green | 17 | 35 | 520 | 155 | CL2-523G | 1SFA619403R5232 | 1x10 | 0,0185 |
| Yellow | 17 | 35 | 590 | 70 | CL2-523Y | 1SFA619403R5233 | 1x10 | 0,0185 |
| Blue | 17 | 35 | 470 | 10 | CL2-523L | 1SFA619403R5234 | 1x10 | 0,0185 |
| Clear | 17 | 35 | (X=0.31,Y=0.32) | 225 | CL2-523C | 1SFA619403R5238 | 1x10 | 0,0185 |
| Rated voltage 230 V AC with 60 V anti-inductive voltage | | | | | | | | |
| Red | 17 | 60 | 625 | 75 | CL2-623R | 1SFA619403R6231 | 1x10 | 0,0185 |
| Green | 17 | 80 | 520 | 70 | CL2-623G | 1SFA619403R6232 | 1x10 | 0,0185 |
| Yellow | 17 | 70 | 590 | 50 | CL2-623Y | 1SFA619403R6233 | 1x10 | 0,0185 |
| Blue | 17 | 80 | 470 | 5 | CL2-623L | 1SFA619403R6234 | 1x10 | 0,0185 |
| Clear | 17 | 80 | (X=0.31,Y=0.32) | 155 | CL2-623C | 1SFA619403R6238 | 1x10 | 0,0185 |
| Rated voltage 380-415 V AC | | | | | | | | |
| Red | 15-17 | 55 | 625 | 85 | CL2-542R | 1SFA619403R5421 | 1x10 | 0,0185 |
| Green | 15-17 | 65 | 520 | 130 | CL2-542G | 1SFA619403R5422 | 1x10 | 0,0185 |
| Yellow | 15-17 | 65 | 590 | 60 | CL2-542Y | 1SFA619403R5423 | 1x10 | 0,0185 |
| Blue | 15-17 | 65 | 470 | 10 | CL2-542L | 1SFA619403R5424 | 1x10 | 0,0185 |
| Clear | 15-17 | 65 | (X=0.31,Y=0.32) | 395 | CL2-542C | 1SFA619403R5428 | 1x10 | 0,0185 |

Pilot light technical data

| Technical data | |
|---|---|
| Protection degree of panel front | IP66, IP67 and IP69K |
| Protection degree of terminals | IP20 |
| Service life | ≥50,000 hrs, operating at 25°C, 40-70%rh |
| UV stabilization | Yes |
| Connectable area | Min 1x0.5 mm ² , Max 2x2.5 mm ² |
| Approval | CCC, CE, UL |
| Operation temperature (°C) | -25 to +70 |
| Storage temperature (°C) | -40 to +85 |
| Flammability of material of current carrier | V2 (halogen and phosphorus free) |
| Voltage fluctuation range | Design for -30% to +10% |
| Panel thickness (mm) | 1 to 6 |
| Package | 10 pcs packed in 1 bag + print on bag, consider bulk package of 100 pcs |
| Text cap | Yes |
| Tightening torque of Nut | 2.0 to 2.3 N•m |
| Tightening torque of M3.5 cable clamp | 0.9 N•m |
| Screw terminal | PZ2 |

Drawing

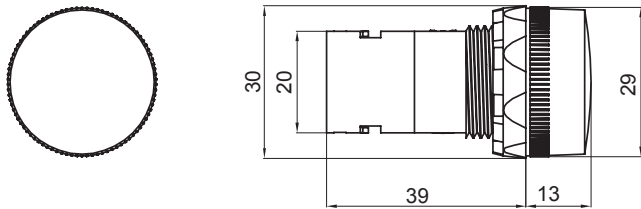

Contact us

ABB AB
Low Voltage Products
Motorgränd 20
S-72161 Västerås / Sweden

www.abb.com/lowvoltage

Note: We reserve the right to make technical changes or modify the contents of this document without prior notice. With regard to purchase orders, the agreed particulars shall prevail. ABB AG does not accept any responsibility whatsoever for potential errors or possible lack of information in this document.

We reserve all rights in this document and in the subject matter and illustrations contained therein. Any reproduction, disclosure to third parties or utilization of its contents – in whole or in parts – is forbidden without prior written consent of ABB AG.

Copyright © 2016 ABB
All rights reserved

X-ON Electronics

Largest Supplier of Electrical and Electronic Components

Click to view similar products for [ABB manufacturer:](#)

Other Similar products are found below :

[TY27MX](#) [TV10-516R](#) [017667013](#) [RF727](#) [2CMA100178R1000](#) [ACS150-01E-09A8-2](#) [ACS355-03E-15A6-4](#) [KS70-1104](#) [A75-30-11-230V-50HZ](#) [CP1-10Y-20](#) [10-100](#) [5SDD](#) [92Z0401](#) [ESV14-BS](#) [EZS-21-250](#) [F204AC-40/0.1](#) [F362-25/0.03](#) [A40-30-10-84](#) [AF09-30-01-11](#)
[AF460-30-11-68](#) [AF50-30-11-70](#) [1455](#) [EF45-30](#) [ERG297](#) [18RA-10](#) [HSC2-20](#) [1SAM201904R1001](#) [1SAM350000R1003](#) [1SAZ721201R1009](#)
[1SAZ721201R1014](#) [1SAZ721201R1025](#) [1SDA057197R1](#) [1SFA611101R1002](#) [1SFA611130R1103](#) [1SFA611143R1101](#) [1SFA611201R1006](#)
[1SFA611202R1001](#) [1SFA611202R1007](#) [1SFA611202R1103](#) [1SFA611202R1108](#) [1SFA611203R1108](#) [1SFA611204R1007](#)
[1SFA611205R1006](#) [1SFA611205R1103](#) [1SFA611205R1104](#) [1SFA611210R1101](#) [1SFA611210R1108](#) [1SFA611211R1001](#)
[1SFA611211R1006](#) [1SFA611211R1007](#) [1SFA611211R1102](#)