

Features

- Both continuous & fixed Vdd options available
- Output waveform clipped sinewave
- Hermetically seam-sealed ceramic package
- Low current consumption

STANDARD SPECIFICATIONS ¹	
PARAMETERS	MAX (Unless otherwise noted)
Frequency Range (F ₀)	10.000 ~ 52.000MHz
Temperature Range	
Operating (T _{OPR})	-40°C ~ +85°C (See part numbering guide below)
Storage (T _{STG})	-40°C ~ +85°C
Frequency Stability vs:	
Over Tolerance (Pre-reflow)	±1.0 PPM (Reference to fo, at 25°C±2°C)
Over Tolerance (24 hrs after reflow, 2x)	±2.0 PPM (Reference to fo, at 25°C±2°C)
Over Temperature Range ²	±2.5 PPM (See part numbering guide below)
Over Supply Voltage Change (V _{DD} ±5%)	±0.2 PPM (V _{DD} ± 5%)
Over Load Change [1kΩ//1pF]	±0.2 PPM (CL ± 1kΩ//±1pF)
Supply Voltage (V _{DD})	1.68V ~ 3.63V (See part numbering guide below)
Input Current (I _{DD})	
10.0 ~ 26.0MHz	2.0 mA
26.01 ~ 52.0MHz	2.5 mA
Start-up Time	2.0 ms
Output Voltage	0.8 Vp-p min
Output Waveform	Clipped Sine Wave, external DC-Cut capacitor required 1000 pF recommended
Output Load	(10kΩ//10pF)±10%
Phase Noise @10 MHz carrier	
@10 Hz offset	-96 dBc/Hz
@100 Hz offset	-121 dBc/Hz
@1 kHz offset	-134 dBc/Hz
@10 kHz offset	-146 dBc/Hz
@100 kHz offset	-155 dBc/Hz
@1 MHz offset	-156 dBc/Hz
@5 MHz offset	-156 dBc/Hz
Phase Noise @52 MHz carrier	
@10 Hz offset	-79 dBc/Hz
@100 Hz offset	-106 dBc/Hz
@1 kHz offset	-128 dBc/Hz
@10 kHz offset	-146 dBc/Hz
@100 kHz offset	-153 dBc/Hz
@1 MHz offset	-154 dBc/Hz
@10 MHz offset	-154 dBc/Hz
@20 MHz offset	-155 dBc/Hz
Aging	±1.0 PPM (First year @+25°C±2°)

¹All measurements made at 25°C ±2°C, nominal Vdd, unless otherwise specified

²Measurement referenced to frequency at 25°C ±2°C

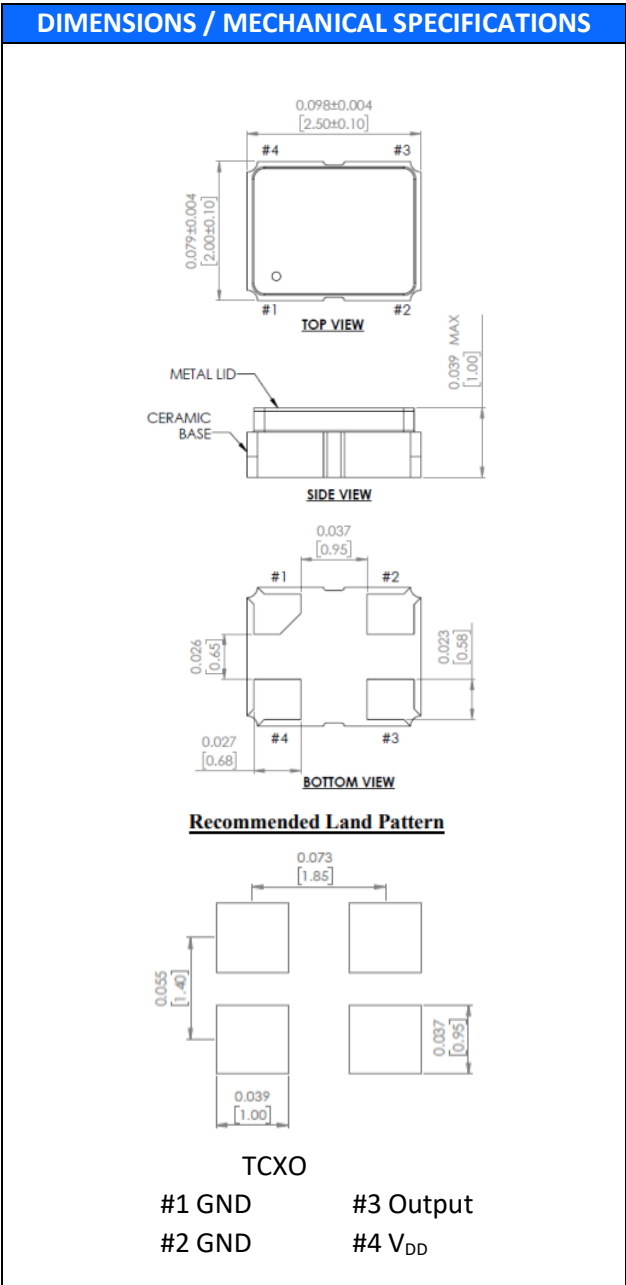

STANDARD SPECIFICATIONS	
PARAMETERS	MAX (Unless otherwise noted)
Maximum Soldering Temp / Time	260°C / 10 Seconds x 2
Moisture Sensitivity Level (MSL)	1
Termination Finish	Au over Ni
Seal Method	Seam
Lead (Pb) Free	Yes
ROHS/REACH Compliant	Yes

FT2MN

2.5mm x 2.0mm

TCXO



TAPE SPECIFICATIONS (mm)							REEL SPECIFICATIONS (mm)						
A	B	C	D	E	F	REEL QTY	G	H	I	J	K	L	M
ø1.5	4.0	4.0	3.5	8.0	0.95	-T3 = 3,000 -T1 = 1,000	2.5	ø13	ø21	ø60	ø178	9.0	1.5

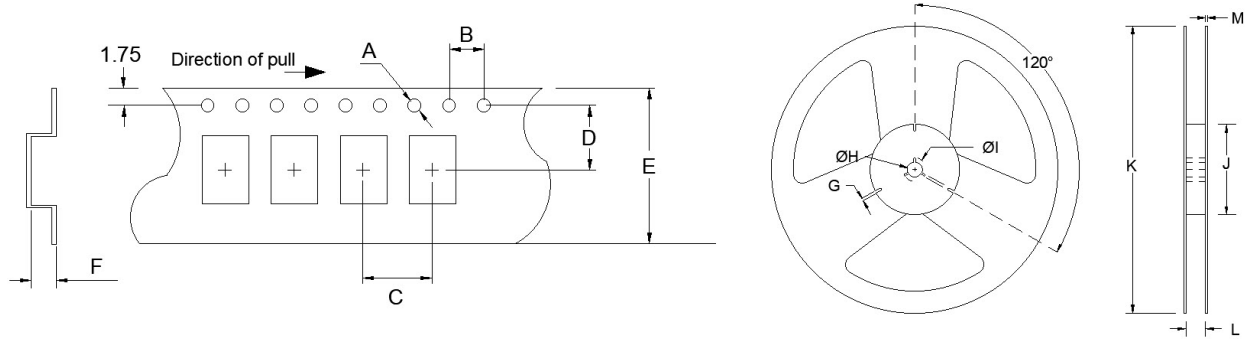

Available Options & Part Identification

Sample PN: **FT2MNKRK26.0-T3**

F	T2MN	K	R	K	26.0	-T3
Fox	Model Number T2MN = TCXO	Voltage B = 3.3V±5% D = 3.0V±5% H = 2.5V±5% K = 1.8V±5% Q = 2.8V±5% T = 1.68V – 3.63V	Stability U = ±0.5PPM T = ±1.0PPM S = ±1.5PPM R = ±2.0PPM P = ±2.5PPM	Operating Temperature C = 0 to +70°C D = -10 to +60°C F = -20 to +70°C H = -30 to +75°C K = -30 to +85°C M = -40 to +85°C	Frequency (MHz)	Values Added Options Blank = Bulk T1 = 1,000 pcs T3 = 3,000 pcs

Reliability Test Conditions

Please contact Abracon Quality Assurance department

X-ON Electronics

Largest Supplier of Electrical and Electronic Components

Click to view similar products for [TCXO Oscillators](#) category:

Click to view products by [Abracon](#) manufacturer:

Other Similar products are found below :

[SIT5000ACC8E-33VQ-19.200000X](#) [SiT5001AI-2E-33N0-48.000000X](#) [TG3225CEN 25.0000M-KFGNNAB](#) [SIT5001AI-2E-33N0-24.000000x](#)
[SIT1566AC-JV-18E-32.768E](#) [AST3TDATACJ5-10.0000MHz](#) [AST3TDATACJ5-20.0000MHz](#) [AST3TDA53TACJ2-19.2000MHz](#)
[AST3TDA53TACJ2-38.8800MHz](#) [AST3TDATACJ5-38.8800MHz](#) [NT0503CC3I287EN10](#) [NT0503CH3I287CN25](#) [NT0503CH3I287CN30.72](#)
[NT0503CC3I287DN20](#) [TG-3541CE 32.7680KXB0](#) [KT1612A26000AAW18TBL](#) [KT1612A26000AAW18NBL](#) [TG-5006CG-12H 26.0000M0](#)
[TG2520SMN 38.4000M-MCGNNM3](#) [X1G004131000900](#) [X1G0041310042](#) [1XXC26000PKA](#) [X1G005441030316](#) [X1G005441020616](#)
[X1G005441030416](#) [X1G005421020416](#) [X1G005441020316](#) [7L26002007](#) [1XTV12800MDA](#) [X1G005421031215](#) [X1G005421020516](#)
[SX1T19.200B010J020S](#) [T132S4-25000ML33DTL](#) [X1G0053710200](#) [NT0503CH3I287EN10](#) [8153H-50.000LH33DTL](#) [NT0503EH3I106EN10](#)
[NT0507BH3I107BN40](#) [NT0503CH3I207EN10](#) [NT0507BH3I507EA10](#) [NT0507BH3I106EA10](#) [BT0507BC3I287CN38.4B](#)
[NT0507BH3I106BA50](#) [NT0503CH3I507CN24.576](#) [OW2EL89CENUXFMYLC-16M](#) [OW2EL89CENUXFMYLC-32M](#)
[OW2EL89CENUXFMYLC-24M](#) [OW7EL89CENUYO3YLC-24M](#) [OW3EL89CENUNFAYLC-26M](#) [OW7EL89CENUYO3YLC-20M](#)