

#### Features

- Both continuous & fixed Vdd options available
- Output waveform clipped sinewave
- Hermetically seam-sealed ceramic package
- Low current consumption

| STANDARD SPECIFICATIONS <sup>1</sup>             |  |
|--|--|
| PARAMETERS                                       | MAX (Unless otherwise noted)   |
| Frequency Range (F <sub>0</sub> )                | 10.000 ~ 52.000MHz   |
| Temperature Range                                |  |
| Operating (T <sub>OPR</sub> )                    | -40°C ~ +85°C (See part numbering guide below)                               |
| Storage (T <sub>STG</sub> )                      | -40°C ~ +85°C  |
| Frequency Stability vs:                          |  |
| Over Tolerance (Pre-reflow)                      | ±1.0 PPM (Reference to fo, at 25°C±2°C)                                      |
| Over Tolerance (24 hrs after reflow, 2x)         | ±2.0 PPM (Reference to fo, at 25°C±2°C)                                      |
| Over Temperature Range <sup>2</sup>              | ±2.5 PPM (See part numbering guide below)                                    |
| Over Supply Voltage Change (V <sub>DD</sub> ±5%) | ±0.2 PPM (V <sub>DD</sub> ± 5%)  |
| Over Load Change [1kΩ//1pF]                      | ±0.2 PPM (CL ± 1kΩ//±1pF)  |
| Supply Voltage (V <sub>DD</sub> )                | 1.68V ~ 3.63V (See part numbering guide below)                               |
| Input Current (I <sub>DD</sub> )                 |  |
| 10.0 ~ 26.0MHz                                   | 2.0 mA   |
| 26.01 ~ 52.0MHz                                  | 2.5 mA   |
| Start-up Time                                    | 2.0 ms   |
| Output Voltage                                   | 0.8 Vp-p min   |
| Output Waveform                                  | Clipped Sine Wave, external DC-Cut capacitor required<br>1000 pF recommended |
| Output Load                                      | (10kΩ//10pF)±10%   |
| Phase Noise @10 MHz carrier                      |  |
| @10 Hz offset                                    | -96 dBc/Hz   |
| @100 Hz offset                                   | -121 dBc/Hz  |
| @1 kHz offset                                    | -134 dBc/Hz  |
| @10 kHz offset                                   | -146 dBc/Hz  |
| @100 kHz offset                                  | -155 dBc/Hz  |
| @1 MHz offset                                    | -156 dBc/Hz  |
| @5 MHz offset                                    | -156 dBc/Hz  |
| Phase Noise @52 MHz carrier                      |  |
| @10 Hz offset                                    | -79 dBc/Hz   |
| @100 Hz offset                                   | -106 dBc/Hz  |
| @1 kHz offset                                    | -128 dBc/Hz  |
| @10 kHz offset                                   | -146 dBc/Hz  |
| @100 kHz offset                                  | -153 dBc/Hz  |
| @1 MHz offset                                    | -154 dBc/Hz  |
| @10 MHz offset                                   | -154 dBc/Hz  |
| @20 MHz offset                                   | -155 dBc/Hz  |
| Aging  | ±1.0 PPM (First year @+25°C±2°)  |

<sup>1</sup>All measurements made at 25°C ±2°C, nominal Vdd, unless otherwise specified.

<sup>2</sup>Measurement referenced to frequency at 25°C ±2°C

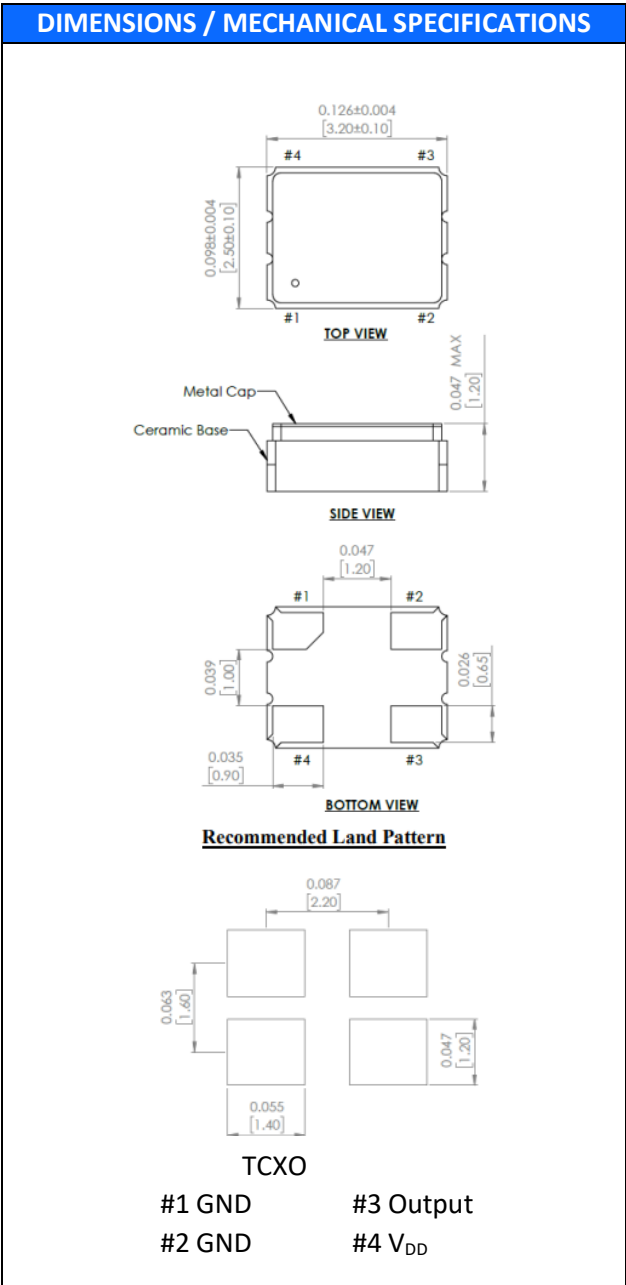

| STANDARD SPECIFICATIONS          |                              |
|----------------------------------|------------------------------|
| PARAMETERS                       | MAX (Unless otherwise noted) |
| Maximum Soldering Temp / Time    | 260°C / 10 Seconds x 2       |
| Moisture Sensitivity Level (MSL) | 1                            |
| Termination Finish               | Au over Ni                   |
| Seal Method                      | Seam                         |
| Lead (Pb) Free                   | Yes                          |
| ROHS/REACH Compliant             | Yes                          |

# FT3MN

3.2mm x 2.5mm

TCXO



| TAPE SPECIFICATIONS (mm) |     |     |     |     |      |                            | REEL SPECIFICATIONS (mm) |     |     |     |      |     |     |
|--------------------------|-----|-----|-----|-----|------|----------------------------|--------------------------|-----|-----|-----|------|-----|-----|
| A                        | B   | C   | D   | E   | F    | REEL QTY                   | G                        | H   | I   | J   | K    | L   | M   |
| ø1.5                     | 4.0 | 4.0 | 3.5 | 8.0 | 0.95 | -T3 = 3,000<br>-T1 = 1,000 | 2.5                      | ø13 | ø21 | ø60 | ø178 | 9.0 | 1.5 |

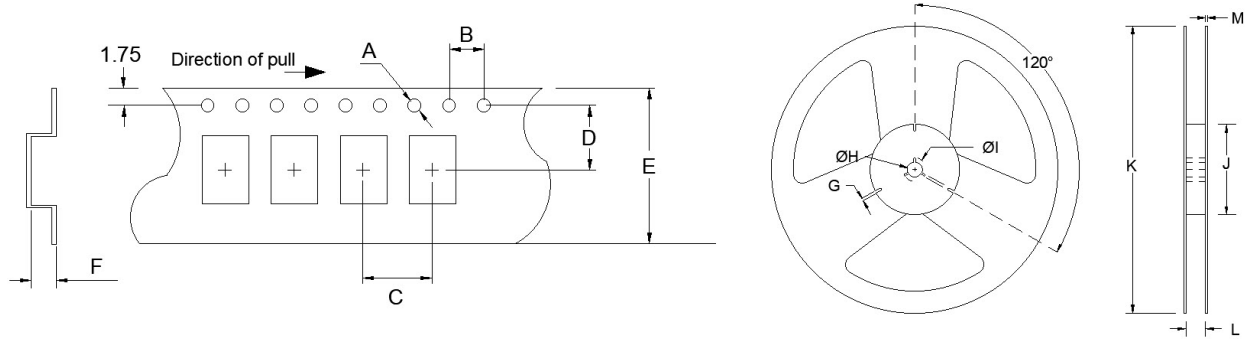

## Available Options & Part Identification

Sample PN: **FT3MNKRK26.0-T3**

| F          | T3MN                               | K   | R  | K   | 26.0                   | -T3  |
|------------|------------------------------------|---|--|---|------------------------|--|
| <b>Fox</b> | <b>Model Number</b><br>T3MN = TCXO | <b>Voltage</b><br>B = 3.3V±5%<br>D = 3.0V±5%<br>H = 2.5V±5%<br><b>K = 1.8V±5%</b><br>Q = 2.8V±5%<br>T = 1.68V – 3.63V | <b>Stability</b><br>U = ±0.5PPM<br>T = ±1.0PPM<br>S = ±1.5PPM<br><b>R = ±2.0PPM</b><br>P = ±2.5PPM | <b>Operating Temperature</b><br>C = 0 to +70°C<br>D = -10 to +60°C<br>F = -20 to +70°C<br>H = -30 to +75°C<br><b>K = -30 to +85°C</b><br>M = -40 to +85°C | <b>Frequency (MHz)</b> | <b>Values Added Options</b><br>Blank = Bulk<br>T1 = 1,000 pcs<br><b>T3 = 3,000 pcs</b> |

### Reliability Test Conditions

Please contact Abracon Quality Assurance department

## X-ON Electronics

Largest Supplier of Electrical and Electronic Components

*Click to view similar products for [TCXO Oscillators](#) category:*

*Click to view products by [Abracon](#) manufacturer:*

Other Similar products are found below :

[SIT5000ACC8E-33VQ-19.200000X](#) [SiT5001AI-2E-33N0-48.000000X](#) [TG3225CEN 25.0000M-KFGNNAB](#) [SIT5001AI-2E-33N0-24.000000x](#)  
[SIT1566AC-JV-18E-32.768E](#) [AST3TDATACJ5-10.0000MHz](#) [AST3TDATACJ5-20.0000MHz](#) [AST3TDA53TACJ2-19.2000MHz](#)  
[AST3TDA53TACJ2-38.8800MHz](#) [AST3TDATACJ5-38.8800MHz](#) [NT0503CC3I287EN10](#) [NT0503CH3I287CN25](#) [NT0503CH3I287CN30.72](#)  
[NT0503CC3I287DN20](#) [TG-3541CE 32.7680KXB0](#) [KT1612A26000AAW18TBL](#) [KT1612A26000AAW18NBL](#) [TG-5006CG-12H 26.0000M0](#)  
[TG2520SMN 38.4000M-MCGNNM3](#) [X1G004131000900](#) [X1G0041310042](#) [1XXC26000PKA](#) [X1G005441030316](#) [X1G005441020616](#)  
[X1G005441030416](#) [X1G005421020416](#) [X1G005441020316](#) [7L26002007](#) [1XTV12800MDA](#) [X1G005421031215](#) [X1G005421020516](#)  
[SX1T19.200B010J020S](#) [T132S4-25000ML33DTL](#) [X1G0053710200](#) [NT0503CH3I287EN10](#) [8153H-50.000LH33DTL](#) [NT0503EH3I106EN10](#)  
[NT0507BH3I107BN40](#) [NT0503CH3I207EN10](#) [NT0507BH3I507EA10](#) [NT0507BH3I106EA10](#) [BT0507BC3I287CN38.4B](#)  
[NT0507BH3I106BA50](#) [NT0503CH3I507CN24.576](#) [OW2EL89CENUXFMYLC-16M](#) [OW2EL89CENUXFMYLC-32M](#)  
[OW2EL89CENUXFMYLC-24M](#) [OW7EL89CENUYO3YLC-24M](#) [OW3EL89CENUNFAYLC-26M](#) [OW7EL89CENUYO3YLC-20M](#)