

RoHS Compliant

Specifications:

Material And Finish:

Insulator:PBT UL94V-0 Color:Black
 Contact:Phosphor Bronze
 Plated:See Ordering Information

Rating:

Current Rating:3.0 Amp
 Voltage Rating:250V AC/DC
 Operating Temperature Range:-40~+105°C

Electrical:

Contact resistance:20m Ohm Max
 Insulator resistance:1000M ohm min.
 Withstanding Voltage:500V AC/Minute

Ordering Information

CS25401-XXX-S85A-X

- A:In bag
- B:In Tube
- C:In Tray
- S:Straight Type
- G:Gold Flash
- S:Selective Gold Plated
- T:Tin Plated
- No. of Positions

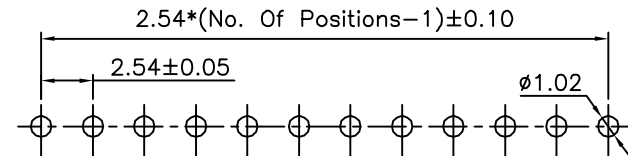
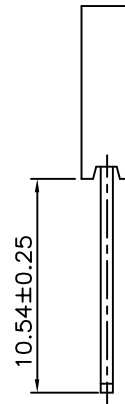
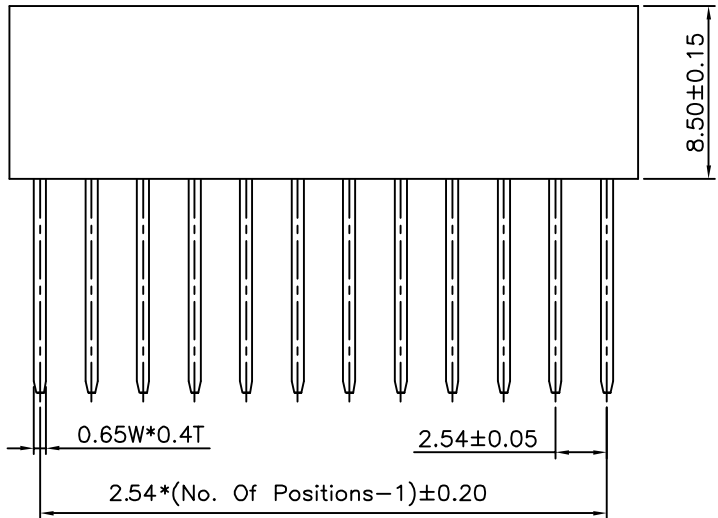
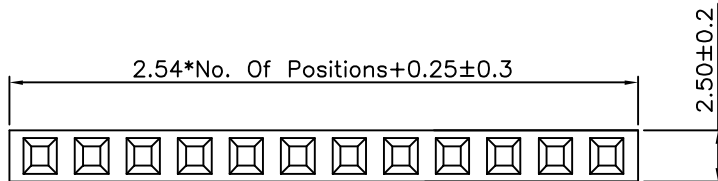

(Tolerance:0.05)
 Recommended PCB Layout

A5				DR.BY.: Tom Liu	TITLE : 2.54mm Pitch Socket Header Straight Type	GENERAL TOLERANCE:						
A4				CHKD.: Jack Wu		LINEAR	ANGLES					
A3					X.: ±0.30	X': ±5.0'						
A2				APPD.: Kane He	PART NO : CS25401-XXX-S85A-X	X.X: ±0.20	X.X': ±3.0'					
A1	ORIGINAL	Tom Liu	Jun-25-2012		DWG. NO.: CXRD120625-009A	X.XX: ±0.15	X.XX': ±2.0'					
REV.	ECN. NO.	DR.BY	DATE		DATE: Jun-25-2012	X.XXX: ±0.10	X.XXX': ±1.0'	UNIT: mm	SCALE: 1:1	SHEET: 1/1	THIRD ANGLE PROJECTION	A4

X-ON Electronics

Largest Supplier of Electrical and Electronic Components

Click to view similar products for [Adafruit Accessories](#) category:

Click to view products by [Adafruit](#) manufacturer:

Other Similar products are found below :

[3209](#) [3561](#) [3560](#) [3562](#) [2503](#) [3011](#) [3048](#) [2973](#) [2868](#) [2958](#) [2836](#) [2968](#) [3610](#) [3568](#) [3551](#) [2858](#) [3353](#) [3584](#) [3484](#) [2865](#) [3556](#) [3559](#) [3262](#)
[3348](#) [2499](#) [2878](#) [2963](#) [3219](#) [3005](#) [2882](#) [PGM1202](#) [02-LDR1](#) [02-LDR12](#) [02-LDR13](#) [02-LDR14](#) [02-LDR15](#) [02-LDR2](#) [02-LDR3](#) [02-LDR4](#)
[2194](#) [862](#) [460](#) [905](#) [02-LDR20](#) [02-LDR21](#) [02-LDR22](#) [02-LDR23](#) [1008](#) [1020](#) [1031](#)