

DESCRIPTION	MATERIAL	FINISH
BURREL	BRASS	GOLD
INSULATOR	PTFE	WHITE
RING	SUS 304	NATURAL
GASKET	SILICONE	RED
SHELL	BRASS	GOLD
CONTACT PIN	BRASS	GOLD
FERRULE	BRASS	GOLD

SPECIFICATIONS:

Electrical:
 Frequency range: DC-6 GHz
 Nominal Impedance: 50 Ohms
 Working Voltage: 250 VOLTS max
 Proof Voltage: 750 VOLTS
 VSWR : 1.3 Max @ 3 GHz
 Operating temperature: -65°C to +165°C
 Environmental:
 Lead free, RoHS compliant.



APPROVED	
CHECKED	SY
DRAWN	AY

APPROVALS	DATE
-----------	------

UNLESS OTHERWISE SPECIFIED
 ALL DIMENSIONS ARE INCHES [MM]
 TOLERANCES: EXCEPT AS NOTED
 INCHES
 X ± .10
 XX ± .020
 XXX ± .015
 ØX ± .10
 ØXXX ± .010

REF: S00277T	SCALE: NTS	SHEET 1 OF 1
SIZE X	PART NO. RF2-02B-T-02-50-G	REV. -
TITLE RF CONNECTOR, SMA STR PLUG, 50OHM RG-174/U, 316/U, LMR-100		

909 Rahway Avenue, Union, NJ 07083
 Phone: 908-687-5000 Fax: 908-687-5710
ADAM TECH

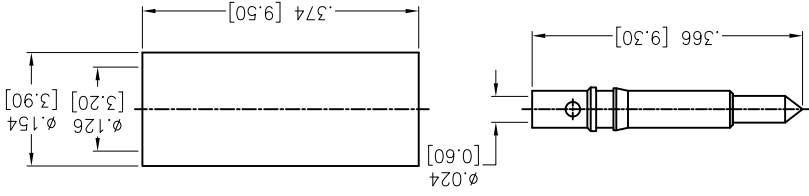
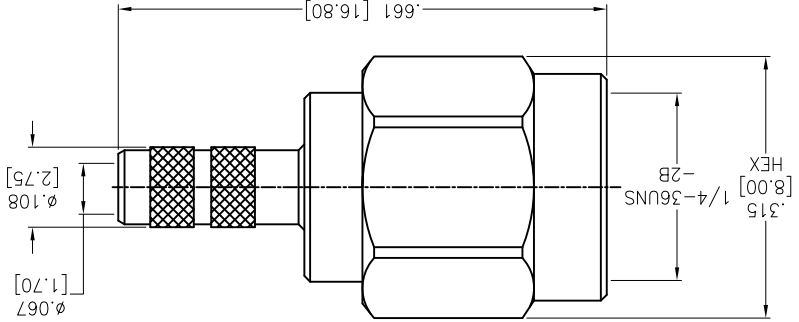

RECOMMENDED CABLE STRIPPING DIMS

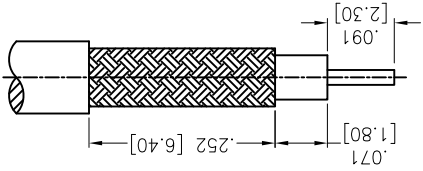

APPROVED: _____ DATE: _____
 TITLE: _____

Rev	AWO #	Description	Date	Appr
-		RELEASED	7/20/16	

X-ON Electronics

Largest Supplier of Electrical and Electronic Components

Click to view similar products for [RF Connectors / Coaxial Connectors](#) category:

Click to view products by [Adam](#) manufacturer:

Other Similar products are found below :

[R125315120](#) [8915-1511-000](#) [89674-0827](#) [5916-1103-603](#) [0106-001-000](#) [6-0001-3](#) [6001-7071-019](#) [6002-7051-003](#) [6002-7551-202](#) [6059674-1](#) [619550-1](#) [630059-000](#) [M39012/25-0021](#) [M39012/79-3008](#) [M39030/3-01N](#) [M39030/3-03N](#) [M3933/25-29N](#) [M3933/25-36N](#) [6500-7071-046](#) [6501-1071-002](#) [M83723/72W24576](#) [M83723/72W2457N](#) [6769](#) [CX050L2AQ](#) [7002-1541-010](#) [7003-1572-002](#) [7004-1512-000](#) [7009-1511-004](#) [7010-1511-000](#) [7029-1511-060](#) [7101-1541-010](#) [7101-1571-002](#) [7105-1521-002](#) [7145-1521-002](#) [7209-1511-011](#) [7210-1511-012](#) [7210-1511-015](#) [7210-1511-019](#) [7210-1511-040](#) [7225-1512-050](#) [7242-1511-000](#) [73137-5015](#) [73216-2241](#) [73251-0111](#) [73251-0672](#) [73276-1501](#) [73366-0013](#) [73404-2300](#) [73413-6080](#) [734151610](#)