

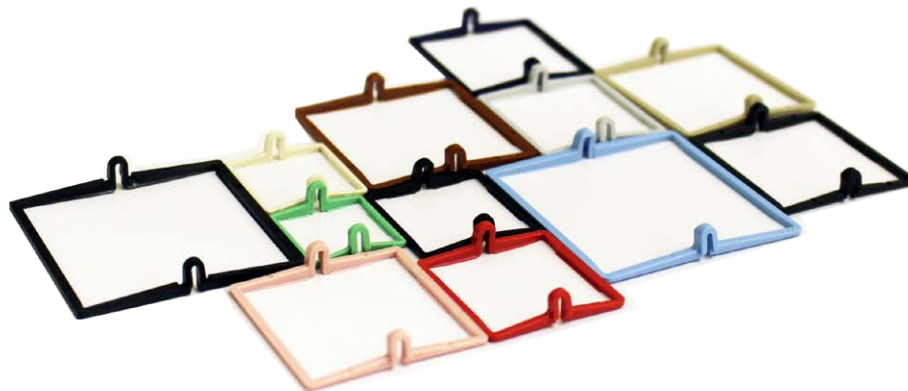

# clipKIT™

THE BEST HEAT SINK ATTACHMENT TECHNOLOGY ON THE MARKET

- Patented superGRIP™ and maxiGRIP™ technology available for straight fin, slant fin, cross cut and pin fin heat sinks
- To be used with heat sinks that have a 1.75 to 4mm base thickness
- Plastic frame and stainless steel spring clips available for 15mm to 45mm components
- Secure heat sink attachment system passes Telcordia Shock & Vibration standards
- Attachment force improves TIM performance by up to 20%
- Eliminates the need to drill holes in a PCB & allows the heat sink to be detached and reattached without damaging the component



Advanced Thermal Solutions, Inc., has introduced clipKIT™ the ultimate heat sink attachment system that can be used with straight fin, pin fin, cross cut or slant fin heat sinks. clipKIT™ is a line of patented, reliable heat sink attachment assemblies featuring the widely used maxiGRIP™ and superGRIP™ frame clip and spring clip. clipKIT™ is available for 15 – 45mm component packages and is designed for standard heat sinks that have a base thickness of 1.75 to 4mm.

Instead of relying on thermal tape or epoxy, which can damage the board or component during rework, the reliable clip attachment system provides a secure hold without the risk of damaging the component or PCB, saving time and cost. The ultra-thin plastic frame clip and stainless steel spring clip are corrosion-resistant, flame retardant and pass Telcordia shock and vibration standards, ensuring the heat sink will securely stay in place on the component in harsh conditions. clipKIT™ attachments eliminate the need to drill holes in a PCB, saving additional board and rework costs. The thin frame clip occupies minimal space around the components perimeter, compared to push pin attachments or stand-off hardware which leaves little space on already overcrowded PCBs. The two-part attachment system provides a uniform force which enhancing heat transfer and improves TIM performance by up to 20%.



maxiGRIP™ Spring (above) & Frame Clips (below)

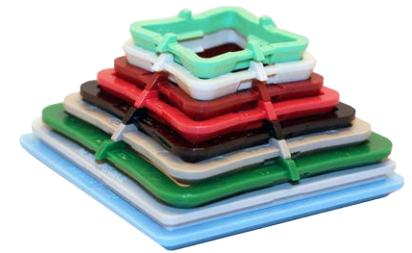

## COMPONENT SIZES

- 15 mm x 15 mm
- 17 mm x 17 mm
- 19 mm x 19 mm
- 21 mm x 21 mm
- 23 mm x 23 mm
- 25 mm x 25 mm
- 27 mm x 27 mm
- 29 mm x 29 mm
- 30 mm x 30 mm
- 31 mm x 31 mm
- 32.5 mm x 32.5 mm
- 33 mm x 33 mm
- 35 mm x 35 mm
- 37.5 mm x 37.5 mm
- 40 mm x 40 mm
- 42.5 mm x 42.5 mm
- 45 mm x 45 mm

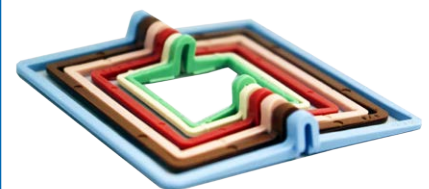

superGRIP™ Frame (above) & Spring Clips (below)





## maxiGRIP™ ASSEMBLY

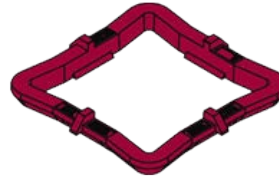
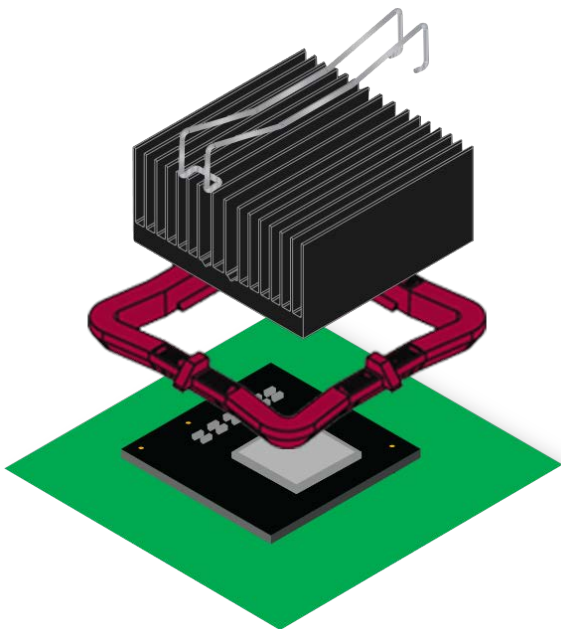

### FRAME CLIP

- High-strength, high-performance plastic meets stringent UL-94V-0 fire rating which has exceptional thermal stability
- Frame geometry has been optimized for strength and minimal space requirements
- Tapered wall provides clearance for adjacent components
- Hour glass shape provides additional room for metal spring clip
- Uniformity in design allows for omnidirectional frame clip orientation



### SPRING CLIP

- Metal spring clip, placed through the heat sink's fin field, locks securely to both ends to the plastic frame
- Double "M" shape provides steady, even pressure to the component, improving thermal performance and long-term reliability
- Spring clip is quickly installed with the maxiGRIP™ Installation Tool
- Specifically designed for different component heights.
- Imposes minimal restriction to air flow
- Accommodates varied fin-to-fin spacing

## superGRIP™ ASSEMBLY

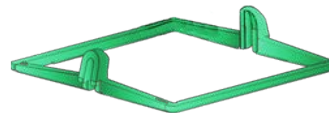
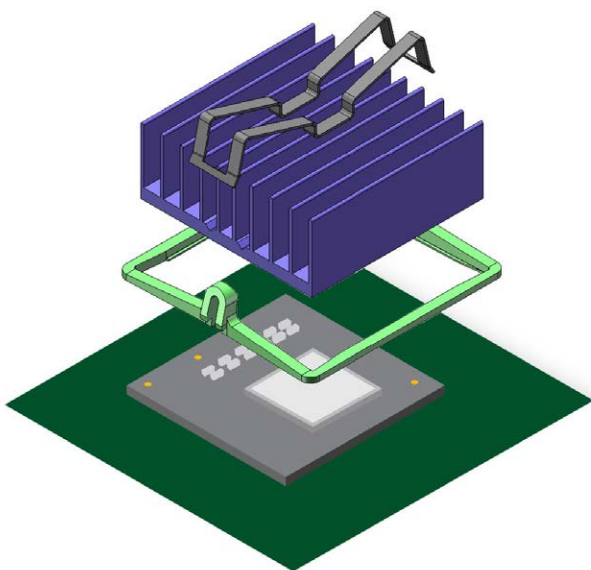

### FRAME CLIP

- Thin, yet strong plastic Frame Clip occupies minimal area around chip, allowing its use in densely populated PCBs
- No custom installation tooling required— mounts easily by hand.
- Interior frame profile locks securely around bottom edge and sides of component package
- Integral horseshoe tabs in clip lock in Spring Clip edges for tight, movement-free heat sink retention
- Frame Clip is easily and safely removed with a common hand tool



### SPRING CLIP

- Metal spring clip, placed through the heat sink's fin field, locks securely to both ends of the plastic frame
- Applies a steady, even pressure to the component, improving thermal performance and long-term reliability
- Spring Clip design is quickly installed or released using a common hand tool, such as a flat blade screwdriver
- Flat, twin-channel clip provides stronger retention forces and minimizes spring clip movement



## clipKIT™ Packages

COMPONENT SIZE	ASSEMBLY	PART NUMBER
15x15mm	superGRIP™	ATS-SG150-R0
17x17mm	maxiGRIP™	ATS-MG170-R0
17x17mm	superGRIP™	ATS-SG170-R0
19x19mm	maxiGRIP™	ATS-MG190-R0
19x19mm	superGRIP™	ATS-SG190-R0
21x21mm	maxiGRIP™	ATS-MG210-R0
21x21mm	superGRIP™	ATS-SG210-R0
23x23mm	maxiGRIP™	ATS-MG230-R0
23x23mm	superGRIP™	ATS-SG230-R0
25x25mm	maxiGRIP™	ATS-MG250-R0
25x25mm	superGRIP™	ATS-SG250-R0
27x27mm	maxiGRIP™	ATS-MG270-R0
27x27mm	superGRIP™	ATS-SG270-R0
29x29mm	maxiGRIP™	ATS-MG290-R0
29x29mm	superGRIP™	ATS-SG290-R0
30x30mm	maxiGRIP™	ATS-MG300-R0
30x30mm	superGRIP™	ATS-SG300-R0
31x31mm	maxiGRIP™	ATS-MG310-R0
31x31mm	superGRIP™	ATS-SG310-R0
32.5x32.5mm	maxiGRIP™	ATS-MG325-R0
32.5x32.5mm	superGRIP™	ATS-SG325-R0
33x33mm	maxiGRIP™	ATS-MG330-R0
33x33mm	superGRIP™	ATS-SG330-R0
35x35mm	maxiGRIP™	ATS-MG350-R0
35x35mm	superGRIP™	ATS-SG350-R0
37.5x37.5mm	maxiGRIP™	ATS-MG375-R0
37.5x37.5mm	superGRIP™	ATS-SG375-R0
40x40mm	maxiGRIP™	ATS-MG400-R0
40x40mm	superGRIP™	ATS-SG400-R0
42.5x42.5mm	maxiGRIP™	ATS-MG425-R0
42.5x42.5mm	superGRIP™	ATS-SG425-R0
45x45mm	maxiGRIP™	ATS-MG450-R0
45x45mm	superGRIP™	ATS-SG450-R0

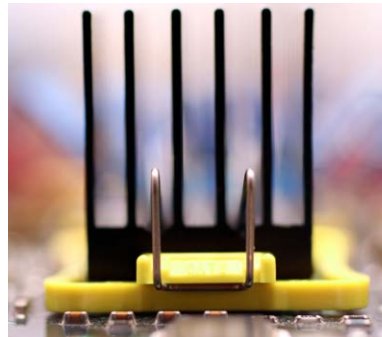

maxiGRIP™ Assembly

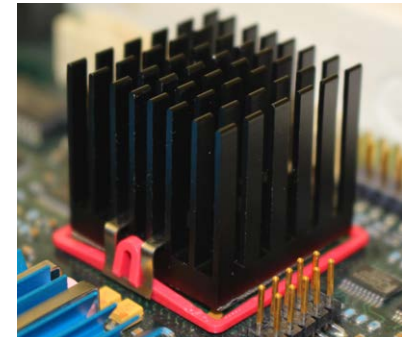
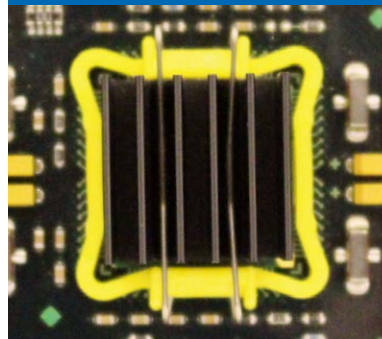

superGRIP™ Assembly

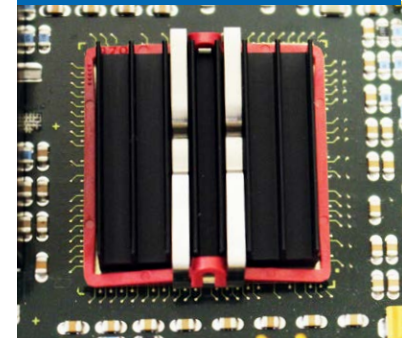

### GUIDELINES FOR DETERMINING HEAT SINK COMPATIBILITY WITH clipKIT™

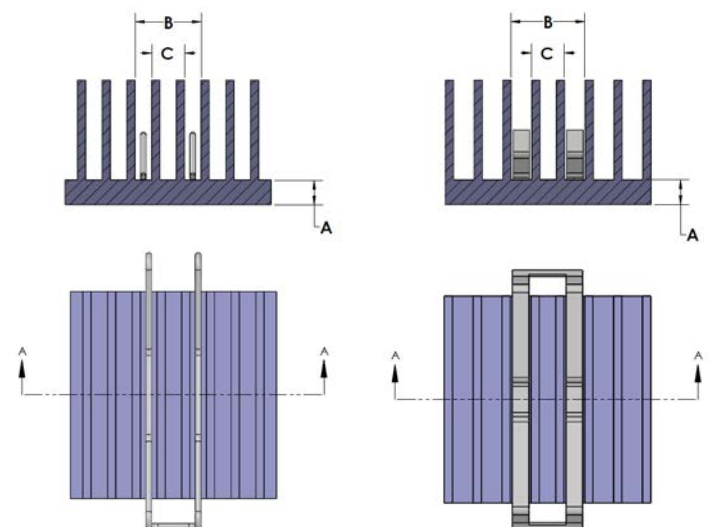

$A \geq 1.8\text{mm}$   
 $A \leq 4\text{mm}$

$C \leq 4.8\text{mm}$   
 $B \leq 7.3\text{mm}$





**ATS** ADVANCED  
THERMAL  
SOLUTIONS, INC.  
Innovations in Thermal Management®

# We Have Your PCB Covered

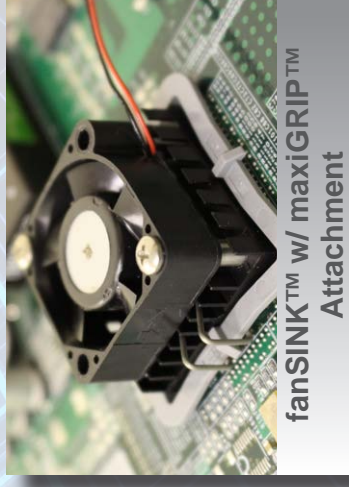

fanSINK™ w/ maxiGRIP™  
Attachment



maxiFLOW™ w/ superGRIP™  
Attachment



CPU Cooler



Power Brick Heat Sink

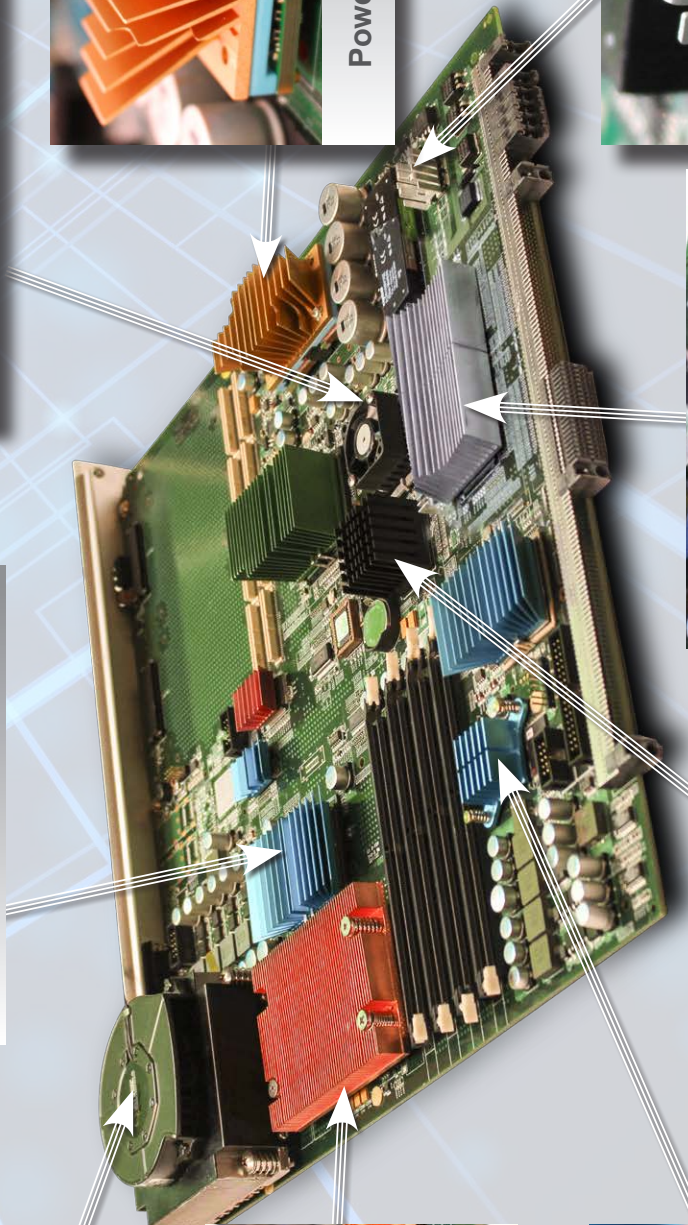

Ultra Low Profile w/  
Push Pin Attachment

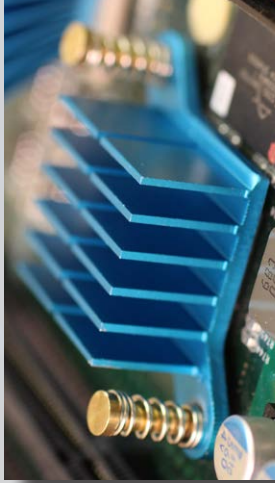

pushPIN™ Heat Sinks



Standard Board Level Heat Sink



Extrusion Profile Heat Sink

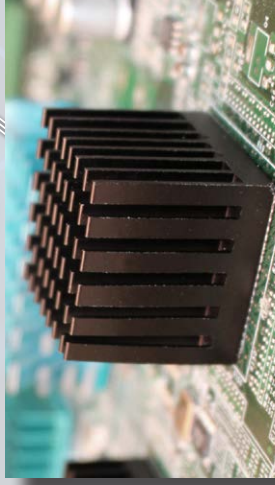

Cross Cut Heat Sink

## X-ON Electronics

Largest Supplier of Electrical and Electronic Components

*Click to view similar products for [Heat Sinks](#) category:*

*Click to view products by [Advanced Thermal Solutions](#) manufacturer:*

Other Similar products are found below :

[581102B00000G](#) [656-15ABPE](#) [657-20ABPNE](#) [7020B-TC12-MTG](#) [73452PPBA](#) [7G0011A](#) [PF720G](#) [A22-4026](#) [120-1873-007](#) [HAH10L](#)  
[HAH15L](#) [1542616-1](#) [HS-2506-F1](#) [HS-87M0-F2](#) [218-40CTE3](#) [231-69PAB-15V](#) [25-7520](#) [SW50-4G](#) [231-75PAB-13V](#) [231-75PAB-15V](#) [253-](#)  
[122ABE-22](#) [PSC22CB](#) [HAF10L](#) [HAQ10T](#) [D10100-28](#) [BDN183CBA01](#) [3-21053-4](#) [32438](#) [TX0506-1B](#) [TX1806B](#) [LAE66A3CB](#) [WA-DT2-](#)  
[101E](#) [511-3U](#) [73381PPBA](#) [73403PPBA](#) [7G0047C](#) [COMX-440-HSP](#) [510-12M](#) [D10650-40T5](#) [V8511 Y](#) [APF40-40-13CB/A01](#)  
[780653U04500G](#) [ATS-54310K-C2-R0](#) [FK 216 CB SA](#) [FK 231 SA 220](#) [648-51AB](#) [657-20ABPESC](#) [2341BG](#) [679-25AG](#) [FK 212 CB SA](#)