

# ARK-1123C

## Intel® Atom E3825 SoC with Dual GbE and Dual COM Fanless Box PC



### Features

- Intel® Atom™ E3825 Dual Core 1.33 GHz SoC
- 1 x 2.5" SATA HDD/SSD Bay & 1 x VGA
- 2 x GbE for Multiple Internet Transmission
- 2 x RS-232/422/485 (BIOS selection)
- 1 x Full-Size MiniPCle (ex. WLAN or WWAN module)
- 1 x Half-size mSATA
- Optional VESA / DIN Rail / Wall Mounting kits
- Threaded DC jack design
- Supports SUSIAccess and Embedded Software APIs



### Specifications

		ARK-1123C-S3A2E
Processor System	CPU	Intel Atom Processor E3825 Dual Core SoC
	Frequency	1.33 GHz
	L2 Cache	1 MB
	BIOS	AMI EFI 64 Mbit (Default BIOS is supported for 64-bit OS installation, BIOS for 32-bit OS is supported by project)
Memory	Technology	DDR3L 1066MHz
	Max. Capacity	8 GB
	Socket	1 x 204-pin SO-DIMM
Graphics	Chipset	Intel® Atom SoC integrated
	Graphic Engine	DirectX* 11.1, OGL 3.0, OCL 1.1, OGL ES 2.0 Encode: H264, MPEG2/4, VC1, WMV9 Decode: H264, MPEG2
	VGA	1 x VGA, support up to 1920 x 1200 at 60Hz
Audio	Main System	ALC-888S, High Definition Audio. Line-out & Line-in
Ethernet	LAN #1	10/100/1000 Mbps Intel I210 GbE, support Wake on LAN
	LAN #2	10/100/1000 Mbps Intel I210 GbE, support Wake on LAN
I/O Interface	Serial Ports	2 x RS-232/422/485 (BIOS selectable)
	USB Interface	2 x USB 2.0 & 1 x USB3.0
Other	Watchdog timer	255-level timer interval, setup by software
Expansion	Mini PCIe	1 x Full-size Mini PCIe, support WLAN or WWAN module
Storage	2.5" Drive Bay	1 x 2.5" SATA HDD Bay (Max Height 9.5mm)
	mSATA	1x Half-size mSATA (Suggest to assembly by CTOS or T-Part due to complex installation)
Software Support	Microsoft Windows	WE7, Windows 7, WE8S, Windows 8, Windows 10
	Linux	Support (by Project)
Power Requirement	Power Input Voltage	Single 12 V <sub>DC</sub>
	Power Adapter	AC to DC, DC12 V/3 A, 36 W with threaded design
Power Consumption	Typical	5.28W
	Max.	8.16W
Mechanical	Construction	Aluminum housing
	Mounting	VESA/DIN Rail/Wall Mounting Kits (Optional)
	Dimensions (W x H x D)	133.8 x 43.1 x 94.2 mm (5.27" x 1.7" x 3.71")
	Weight	0.8 kg
Environment	Operating Temperature	With extended temperature SSD/mSATA/RAM: -30 ~ 70° C with 0.7m/s air flow With standard temperature HDD/SSD/mSATA/RAM peripherals: 0 ~ 40° C with 0.7m/s air flow
	Storage Temperature	-40 ~ 85° C (-40-185° F)
	Relative Humidity	95% @ 40° C (non-condensing)
	Vibration During Operation	With mSATA/SSD: 3 Grms, IEC 60068-2-64, random, 5 ~ 500 Hz, 1 hr/axis With HDD: 0.5Grms, IEC 60068-2-64, random, 5~500Hz, 3 axes, 1hr/axis
	Shock During Operation	With mSATA/SSD: 30 G, IEC 60068-2-27, half sine, 11 ms duration With HDD: 10G, IEC 60068-2-27, half sine, 11 ms duration
Regulation	EMC	CE/FCC Class B, CCC, BSMI
	Safety	UL, CCC, BSMI, CB

## Dimensions

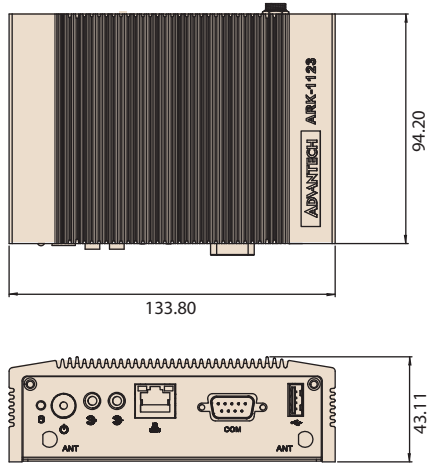

### DIN Rail

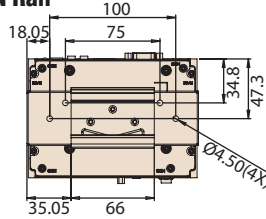

### VESA mount

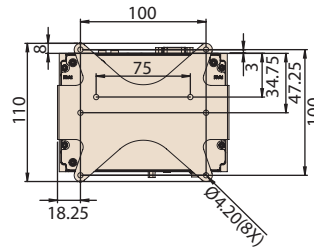

### Wall mount

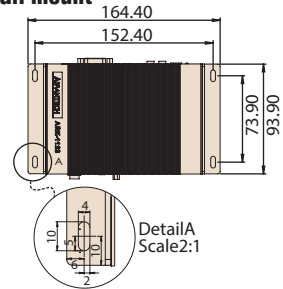

Unit: mm

## Front Panel External I/O Mechanical Layout/Drawing

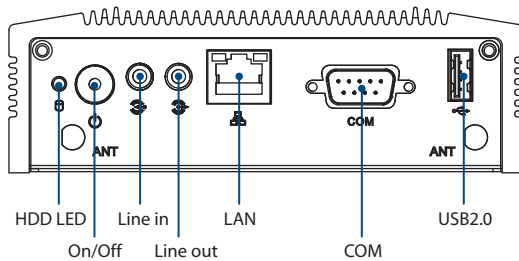

## Rear Panel External I/O Mechanical Layout/Drawing

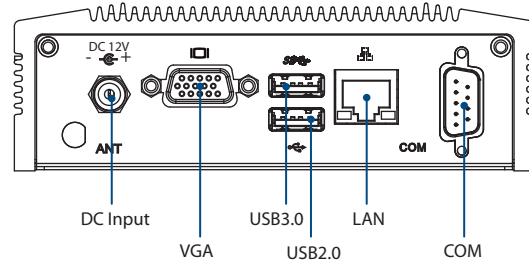

## Ordering Information

Part Number	CPU	RAM	VGA	GbE	USB 2.0	USB 3.0	RS-232/422/485	Audio	MiniPCIe	2.5" HDD bay	mSATA	Operating Temperature
ARK-1123C-S3A2E	Intel Atom E3825	Up to 8GB	1	2	2	1	2	Line in Line out	1 Full size	1	1 (H/S)	-30 ~ 70° C

Note: Memory, storage and operating system bundled by request.

## Packing List

Part Number	Description
-	1 x ARK-1123C Unit
-	1 x User Manual (Simplified Chinese)
96PSA-A36W12W7	1 x AC to DC adapter DC 12V/3A 36W, -20 ~ 60° C

## Embedded OS (Only available for T-Parts OEM, and CTOS service)

Part Number	Description
2070013032	WE7E 64-bit with EN/JP/TC/SC (OS size around 11G)
2070013370	WE8S 64-bit with EN/JP/TC/SC (OS size around 13G)
2070013712	WE7E 32-bit with EN/JP/TC/SC
2070014791	Win10 IoT Ent LTSB 2016 64bit, EN

## Optional Items

Part Number	Description
1700001524	Power Cable 3-pin 180cm, USA type
170203183C	Power Cable 3-pin 180cm, Europe type
170203180A	Power Cable 3-pin 180cm, UK type
1700008921	Power Cable 3-pin PSE Mark 183cm
AMK-V003E	ARK-112X series VESA mounting kit
AMK-R001E	ARK-112X series DIN-rail mounting kit
AMK-W001E	ARK-112X series Wall mounting kit

## X-ON Electronics

Largest Supplier of Electrical and Electronic Components

*Click to view similar products for [Embedded Box Computers](#) category:*

*Click to view products by [Advantech](#) manufacturer:*

Other Similar products are found below :

[tBOX312-870-FL-i7-DC](#) [tBOX313-835-FL-RJ-DC](#) [UPOS-3150-R0W0E](#) [ARK-20-S8A1E](#) [R2224WTTYSR](#) [BXNUC9i5QNX](#)  
[BXNUC9i5QNX1](#) [BKNUC9V7QNX](#) [BKNUC9V7QNX1](#) [2-A0DF-2001](#) [BKCMB1ABB](#) [BKCMB1ABA](#) [EM3000-3845-8-128-WL-U-1](#)  
[TANK-870AI-i5/8G/2A-R10](#) [PRFE21000038](#) [EM5000-I3-8-128-WL-W7-1](#) [EM3000-3845-8-128-WL-W7-1](#) [PRFE21000039](#) [AMOS-825-](#)  
[1Q10A1](#) [UPS-EDAI-X70864-U01-DC01](#) [UPX-EDGEI7-A10-1664-F01](#) [MXE-211/M8G](#) [PXIe-3985/M16G](#) [PXIe-3987/M16G/SSD](#)  
[ROScube-I, IntelR Core? i7, RQI-57](#) [AIMB-T1215DA-00Y0E](#) [AIMB-T1217DW-00Y0E](#) [AIMB-T12315A-00Y0E](#) [AMAX-5580-54000A](#)  
[APAX-5580-474AE](#) [ARK-6322-Q0A2E](#) [DS-100GF-S8A1E](#) [DS-100GL-S8A1E](#) [EPC-R4680CQ-XAA1E](#) [ESRP-CSS-UNO2484](#) [ITA-1611-](#)  
[10A1E](#) [ITA-1711-10A1E](#) [MIC-720AI-00A1](#) [UNO-247-J1N1AE](#) [UTX-3115FS-S6A2E](#) [AMI220AF-4L-7500](#) [ELIT-1200](#) [AIE100-903-FL](#)  
[EBOX671-517-FL-DC](#) [MVS900-511-FL](#) [AMS200](#) [SE-92-I7](#) [SI-606](#) [SI-60E](#) [ITG-100-AL-E1/2GB/S-R10](#)