

SERIES PPA ATTENUATORS

High Power – DC-4 GHz

**RoHS
Compliant**



The Aeroflex/Inmet PPA Series of attenuators utilize a Beryllium Oxide chip and thin film technology to provide devices which can dissipate up to 100 Watts of RF power. The PPA series must be thermally bonded to a heat sink, using the mounting holes provided, in order to operate within the temperature rating indicated. The flange temperatures must not exceed 100°C under rated power conditions.

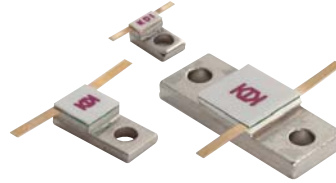

ORDERING INFORMATION

The Power Attenuators listed are available in 1 dB increments from 1 thru 20 dB. Specify by selecting any of the series listed and add the attenuation value desired to the basic series designation. (See Note 3)

EXAMPLE:



GENERAL SPECIFICATIONS

Impedance	50 Ohms
Operating Temp.	-55°C to +150°C
Attenuation Stability	0.0001 dB/dB/°C
Substrate	Beryllium Oxide Ceramic
Resistive Element	Proprietary Thin Film
Flange	Copper, Nickel Plated per QQ-N-290
Tabs	Beryllium Copper, Gold Plated per MIL-G-45204
Cover	Alumina Ceramic

PERFORMANCE SPECIFICATIONS

Model	Attenuation ⁽¹⁾ 1 dB Increments (dB)	Frequency ⁽¹⁾ Range	Input Power (Watts)	Attenuation Accuracy (1) (dB)			VSWR (Typical) ²	
				dB	DC-1 GHz	1-2.5 GHz		2.5-4 GHz
PPA 10 11-20	1-20	DC-4 GHz	10	1-10	±0.5 ±1.0	±0.5 ±2.0	±1.0 ±3.0	1.3:1
PPA 20 6-9 10-15 16-20	1-20	DC-4 GHz	20	1-5	±0.5 ±0.5 ±0.75 ±1.0	±0.5 ±0.5 ±1.0 ±2.0	±0.5 ±1.0 ±1.5 ±3.0	1.15:1 – DC-1.0 GHz 1.35:1 – 1.0-2.5 GHz 1.50:1 – 2.5-4.0 GHz
PPA 50	1-20	DC-1 GHz	50		±0.3 DC-500 MHz ±0.5 500 MHz-1 GHz			1.25:1 – DC-500 MHz 1.50:1 – 500 MHz-1 GHz
PPA 100	1-20	DC-500 MHz	100		±0.5			1.25:1 – DC-200 MHz 1.50:1 – 200-500 MHz

PHYSICAL DIMENSIONS

NOTES

- Custom products are available at higher frequencies with optimized VSWR and attenuation accuracy over narrow frequency bandwidths.
- VSWR as measured in a 0.125" ground plane stripline circuit.
- Standard values 1, 2, 3, 4, 5, 6, 10, 20 dB.
Non-std values available as special order.

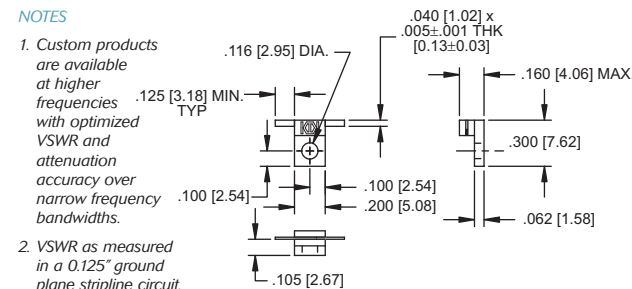

PPA10 OUTLINE

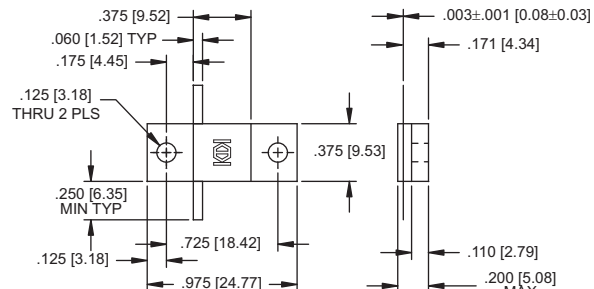

PPA50 OUTLINE

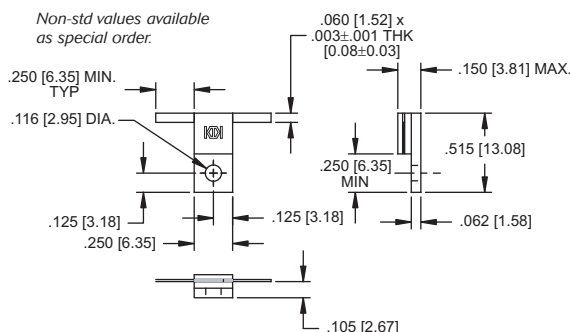

PPA20 OUTLINE

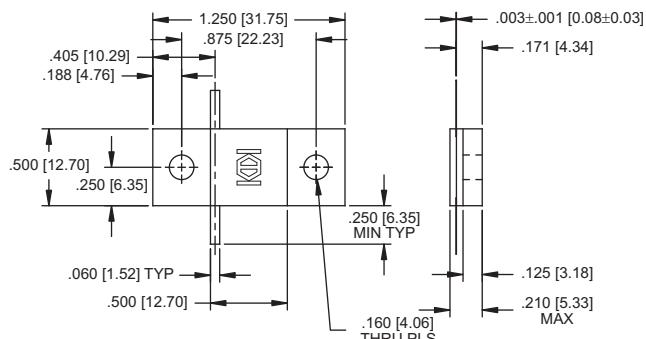

PPA100 OUTLINE

KEY: Inches [Millimeters] .XX ±.03 .XXX ±.010 LX ±0.8 .XX ±0.25]



300 Dino Drive, Ann Arbor, MI 48103
Tel: 888-244-6638 or 734-426-5553 • Fax: 734-426-5557
www.aeroflex.com/inmet • inmet-sales@eroflex.com

X-ON Electronics

Largest Supplier of Electrical and Electronic Components

Click to view similar products for [Signal Conditioning](#) category:

Click to view products by [Aeroflex](#) manufacturer:

Other Similar products are found below :

[MAPDCC0004](#) [PD0409J5050S2HF](#) [880157](#) [HHS-109-PIN](#) [DC1417J5005AHF](#) [DC4859J5005AHF](#) [AFS14A30-2185.00-T3](#) [AFS14A35-1591.50-T3](#) [DS-323-PIN](#) [DSS-313-PIN](#) [B39321R801H210](#) [B39321R821H210](#) [B39921B4317P810](#) [1A0220-3](#) [2089-6207-00](#) [JP510S](#) [LFB212G45SG8C341](#) [LFB322G45SN1A504](#) [LFL182G45TC3B746](#) [SF2159E](#) [30057](#) [1P510S](#) [CER0813B](#) [3A325](#) [40287](#) [41180](#) [ATB3225-75032NCT](#) [B69842N5807A150](#) [BD0810N50100AHF](#) [BD2326L50200AHF](#) [BD2425J50200AHF](#) [HMC189AMS8TR](#) [C5060J5003AHF](#) [JHS-114-PIN](#) [JP503AS](#) [DC0710J5005AHF](#) [DC2327J5005AHF](#) [DC3338J5005AHF](#) [43020](#) [LFB2H2G60BB1C106](#) [LFL15869MTC1B787](#) [X3C19F1-20S](#) [XC3500P-20S](#) [10013-20](#) [SF2081E](#) [SF2194E](#) [SF2238E](#) [CDBLB455KCAX39-B0](#) [RF1353C](#) [PD0922J5050D2HF](#)